

RIGHT-OF-WAY CROSS SECTION SELKIRK AVENUE
ARLINGTON STREET TO MCKENZIE STREET
N.T.S.

CB & CP TABLE - COMBINED SEWER				
DESCRIPTION	RIM ELEV.	INVERT		
		EAST	WEST	SOUTH
CB 9	231.315			229.715
CB 10	231.260	230.310	230.310	229.660
CB 11	231.400			229.800
CB 12	231.345	230.395	230.395	229.745
CP 5	231.260			230.260
CP 6	231.345			230.345

- REFERENCE NOTES**
- PAVEMENT DIMENSIONS ARE TO BACK OF CURB
 - BASELINE IS CENTRELINE OF RIGHT-OF-WAY
 - PROPERTY LINES OBTAINED FROM THE CITY OF WINNIPEG L.B.I.S., AND NO SCALE FACTOR WAS APPLIED
 - REFER TO AECOM FIELD BOOK NO. 4703
 - REFER TO DWGS CT-12 TO CT-14 FOR STREETSCAPING ELEMENTS.

- CONSTRUCTION NOTES**
- REMOVE EXISTING PAVEMENT, INCLUDING CONCRETE STREET CAR BEDDING AND WOOD TIES, AND CONSTRUCT NEW 230mm PLAIN DOWELED CONCRETE PAVEMENT c/w 180mm BARRIER CURB (SEPARATE)
 - CONSTRUCT NEW 200mm REINFORCED CONCRETE PAVEMENT
 - REMOVE EXISTING CONCRETE SIDEWALK/PAVER STONE SIDEWALK AND CONSTRUCT NEW 100mm SIDEWALK c/w PAVING STONE BAND (REFER TO DETAIL 1, CT-14) CONTRACTOR TO SAW CUT AT PROPERTY LINE FULL LENGTH OF PROJECT
 - INSTALL NEW CURB AND GUTTER INLET c/w CATCHBASIN (SD024) ON SOUTH SIDE (AP-008 & AP-009), AND A NEW CATCHBASIN (SD-025) ON NORTH SIDE c/w SOLID COVER (AP-004 & AP-005). CONNECT NEW 250mm LEAD TO EXISTING COMBINED SEWER /MANHOLE
 - INSTALL NEW CURB AND GUTTER INLET c/w CATCHPIT(SD023) AND CONNECT NEW 250mm LEAD TO NEW CATCHBASIN
 - REMOVE EXISTING CATCHBASIN AND ABANDON EXISTING LEAD
 - REMOVE EXISTING FRAME AND COVER AND INSTALL NEW FRAME AND SOLID COVER (AP-004 & AP-005)
 - CONSTRUCT NEW MONOLITHIC CURB RAMP (10mm HT. INTEGRAL)
 - CONSTRUCT NEW MODIFIED BARRIER CURB (180mm HT. INTEGRAL)
 - REMOVE EXISTING CURB AND GUTTER INLET AND LEAD
 - ADJUST EXISTING CATCHBASIN/MANHOLE FRAME AND COVER
 - ADJUST EXISTING WATERMAIN VALVE BOX TO GRADE
 - INSTALL NEW 50mm CAST IRON RISER RING
 - INSTALL 150mm SUBDRAIN 12m ON EACH SIDE OF CATCHBASIN
 - ADJUST EXISTING CURB STOP TO GRADE
 - INSTALL NEW DETECTABLE SURFACE WARNING TILES
 - PLACE 50mm ASPHALT PAVEMENT (TYPE 1A)
 - EXISTING TRAFFIC SIGNALS POLE TO BE RELOCATED (BY OTHERS)
 - EXISTING STREET LIGHT POLE TO BE RELOCATED (BY OTHERS)
 - INSTALL FLOW RESTRICTOR PIPE 150mm PVC SDR 35 CENTER RESTRICTOR PIPE IN CB LEAD (SD-122)
 - CONTRACTOR TO SALVAGE AND RE-INSTALL ALL GAS METER BOLLARDS DURING SIDEWALK REPLACEMENT.
 - SUPPLY & INSTALL ORNAMENTAL POSTS w/ BRACKETS AND HANGING BASKETS (REFER TO CT-14)

CAUTION: SHALLOW GAS SERVICES

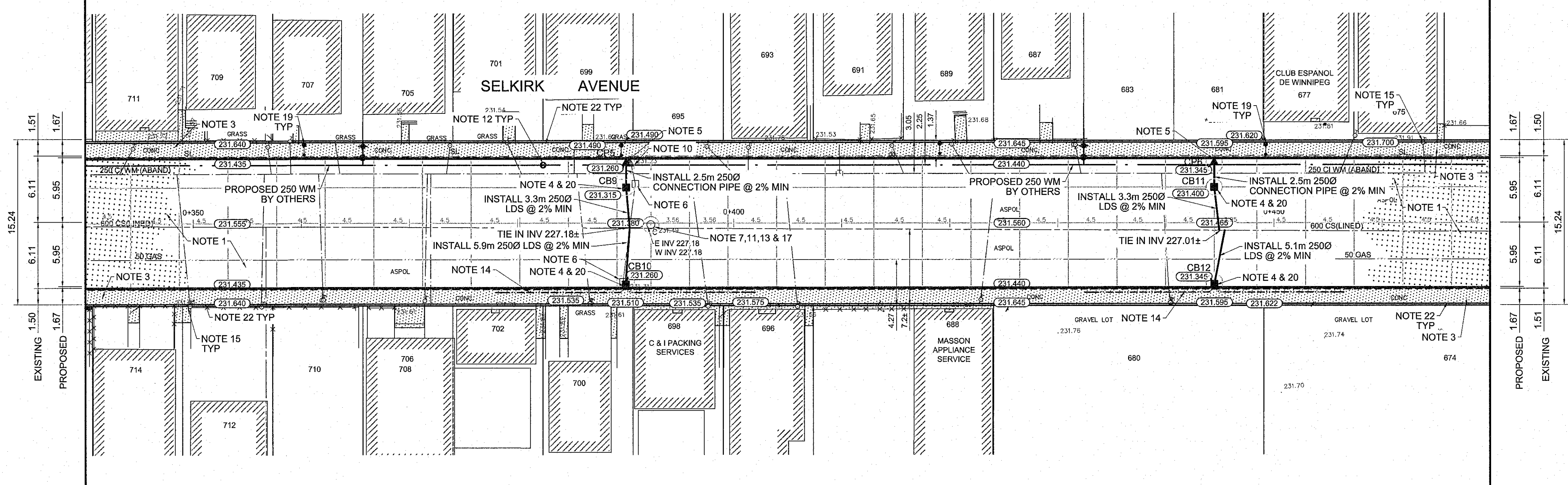
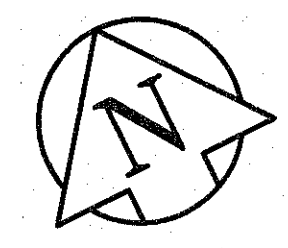

EXISTING	LEGEND - PLAN	PROPOSED	EXISTING	LEGEND - PLAN	PROPOSED	EXISTING	LEGEND - PROFILE	PROPOSED
150 mm W.M.	WATERMAIN	150 mm W.M.	HYDRO	M.T.S.	CONCRETE	—X—	C PROFILE	NORTH/WEST GUTTER
300mm L.D.S.	LAND DRAINAGE SEWER	300mm L.D.S.	CONCRETE	CONCRETE	—X—	—X—	—X—	SOUTH/EAST GUTTER
250mm W.W.S.	WASTEWATER SEWER	250mm W.W.S.	ASPHALT	PROPERTY LINE	—X—	—X—	—X—	N/W PROPERTY LINE
MANHOLE	MANHOLE	MANHOLE	SURVEY LINE	SURVEY LINE	—X—	—X—	—X—	S/E PROPERTY LINE
CATCH BASIN	CATCH BASIN	CATCH BASIN	ELEVATION	ELEVATION	—X—	—X—	—X—	
CATCH PIT	CATCH PIT	CATCH PIT	TREE	TREE	—X—	—X—	—X—	
JUNCTIONS	JUNCTIONS	JUNCTIONS	SIDEWALK RAMP	SIDEWALK RAMP	—X—	—X—	—X—	
CULVERT	CULVERT	CULVERT	CONCRETE SIDEWALK	CONCRETE SIDEWALK	—X—	—X—	—X—	
GAS	GAS	GAS	FENCE	FENCE	—X—	—X—	—X—	

LOCATION APPROVED UNDERGROUND STRUCTURES
 APPROVE RECID 2016/02/17
 SUPV. DIG STRUCTURES COMMITTEE
 DATE

NOTE:
 LOCATION OF UNDERGROUND STRUCTURES AS SHOWN ARE BASED ON THE BEST INFORMATION AVAILABLE. BUT NO GUARANTEE IS GIVEN THAT ALL EXISTING UTILITIES ARE SHOWN OR THAT THE GIVEN LOCATIONS ARE EXACT. CONFIRMATION OF EXISTENCE AND EXACT LOCATION OF ALL SERVICES MUST BE OBTAINED FROM THE INDIVIDUAL UTILITIES BEFORE PROCEEDING WITH CONSTRUCTION.

NO.	REVISIONS	DATE	BY
0	ISSUED FOR TENDER	02/26/2016	KR
A	ISSUED FOR REVIEW	01/25/2016	BC

DESIGNED BY: KWR/BC
 CHECKED BY: KWR
 DRAWN BY: PP/PB
 APPROVED BY:
 HOR. SCALE: 1:250
 VERTICAL: 1:10
 RELEASED FOR CONSTRUCTION BY:
 DATE: 12/03/2015

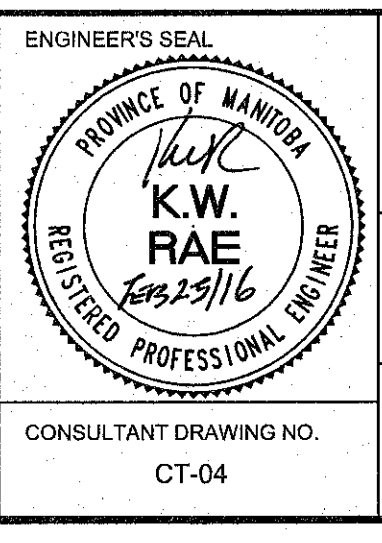

AECOM
 Certificate of Authorization
 AECOM Canada Ltd.
 No. 4671 Date: Feb 25/16

METRIC
 WHOLE NUMBERS INDICATE MILLIMETRES
 DECIMALIZED NUMBERS INDICATE METRES

THE CITY OF WINNIPEG
 PUBLIC WORKS DEPARTMENT
 ENGINEERING DIVISION

SELKIRK AVENUE PAVEMENT RECONSTRUCTION
 ARLINGTON STREET TO SALTER STREET

PLAN/PROFILE
 STATION 0+340 TO STATION 0+470

CITY DRAWING NUMBER: P-3471-04
 SHEET: 04 OF 20