

MATCHLINE 0+470

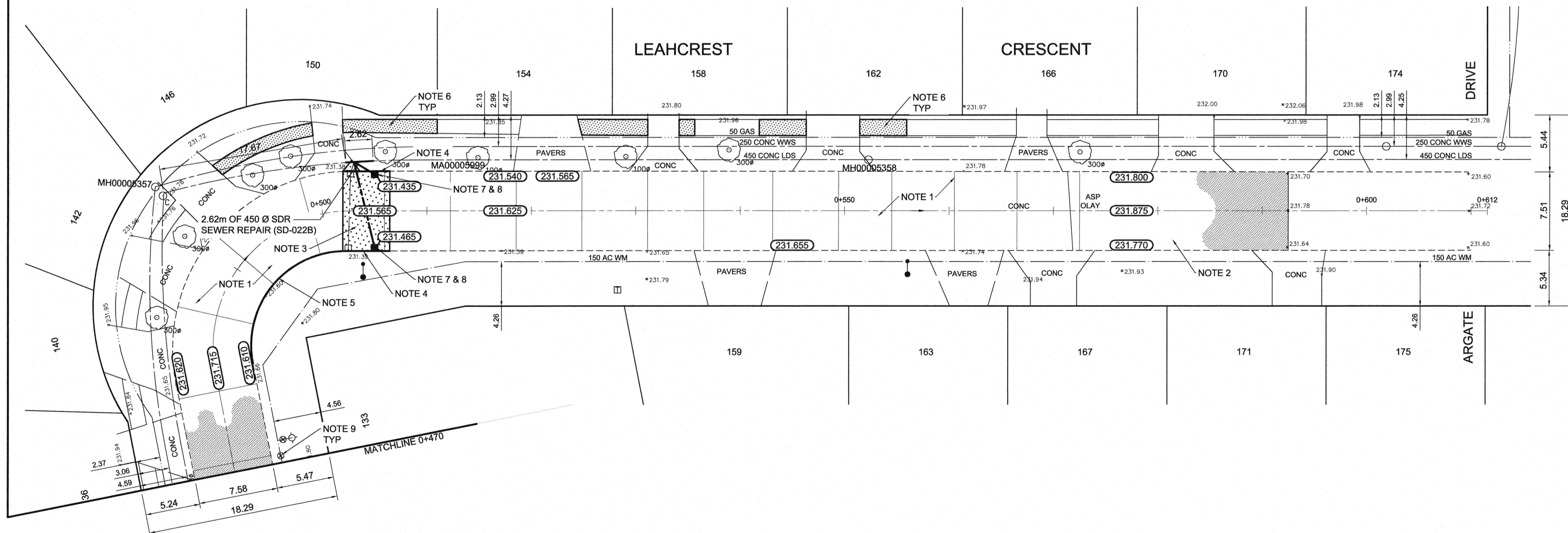

- REFERENCE NOTES**
- PAVEMENT DIMENSIONS ARE TO BACK OF CURB
  - BASELINE IS CENTRE LINE RIGHT-OF-WAY
  - PROPERTY LINES OBTAINED FROM CITY OF WINNIPEG L.B.I.S., AND NO SCALE FACTOR WAS APPLIED
  - REFER TO AECOM FIELD BOOK NO. 4914

- CONSTRUCTION NOTES**
- PLACE NEW ASPHALTIC PAVEMENT TYPE 1A (AVG. THICKNESS 85mm)
  - REMOVE EXISTING ASPHALT AND CONSTRUCT NEW ASPHALTIC OVERLAY TYPE 1A
  - REMOVE EXISTING CONCRETE PAVEMENT AND CONSTRUCT NEW 150mm REINFORCED CONCRETE PAVEMENT c/w 85mm ASPHALT OVERLAY
  - CONSTRUCT NEW CONCRETE MOUNTABLE LIP CURB (120mm HT. INTEGRAL)
  - RENEW MOUNTABLE LIP CURB (120mm HT. DOWELLED)
  - RENEW EXISTING 100mm CONCRETE SIDEWALK
  - REMOVE EXISTING CATCHBASIN
  - INSTALL NEW MOUNTABLE CURB AND GUTTER INLET c/w CATCHBASIN (SD-024) AND CONNECT NEW LEAD TO EXISTING 450 LDS SEWER
  - ADJUST EXISTING WATER VALVE TO GRADE



**METRIC**  
WHOLE NUMBERS INDICATE MILLIMETRES  
DECIMALIZED NUMBERS INDICATE METRES

EXISTING		PROPOSED		EXISTING		PROPOSED	
	WATERMAIN		WATERMAIN		HYDRO M.T.S.		OUTSIDE GUTTER
	VALVE		VALVE		CONCRETE		INSIDE GUTTER
	LAND DRAINAGE SEWER		LAND DRAINAGE SEWER		ASPHALT		N/W PROPERTY LINE
	WASTEWATER SEWER		WASTEWATER SEWER		PROPERTY LINE		SURVEY BAR
	MANHOLE		MANHOLE		ELEVATION (35.750)		TREE
	CATCH BASIN		CATCH BASIN		SIDEWALK RAMP		CONCRETE SIDEWALK
	CATCH PIT		CATCH PIT		FENCE		
	JUNCTIONS		JUNCTIONS				
	CULVERT		CULVERT				
	GAS		GAS				

**LOCATION APPROVED UNDERGROUND STRUCTURES**

SUPV. U/G STRUCTURES COMMITTEE DATE

**NOTE:**  
LOCATION OF UNDERGROUND STRUCTURES AS SHOWN ARE BASED ON THE BEST INFORMATION AVAILABLE. BUT NO GUARANTEE IS GIVEN THAT ALL EXISTING UTILITIES ARE SHOWN OR THAT THE GIVEN LOCATIONS ARE EXACT. CONFIRMATION OF EXISTENCE AND EXACT LOCATION OF ALL SERVICES MUST BE OBTAINED FROM THE INDIVIDUAL UTILITIES BEFORE PROCEEDING WITH CONSTRUCTION.

B.M. 04-013 86R382 N.W. Cor. Jefferson Ave. & Ritchie St. 10ft on top of ELEV. 231.781  
0.05m dia. x 2.4m iron tube, 7.6m S. of N.L. of Jefferson Ave.  
produced from the W. & 5.5m E. of W.L. of Ritchie St.

NO.	REVISIONS	DATE	BY
0	ISSUED FOR TENDER	04/06/2016	BC
A	ISSUED FOR REVIEW	03/30/2016	BC

**AECOM**

DESIGNED BY: SS  
DRAWN BY: JC/SS

CHECKED BY: BC/KWR  
APPROVED BY:

HOR. SCALE: 1:250  
VERTICAL: 1:10

RELEASED FOR CONSTRUCTION BY:

DATE: APRIL 11/16

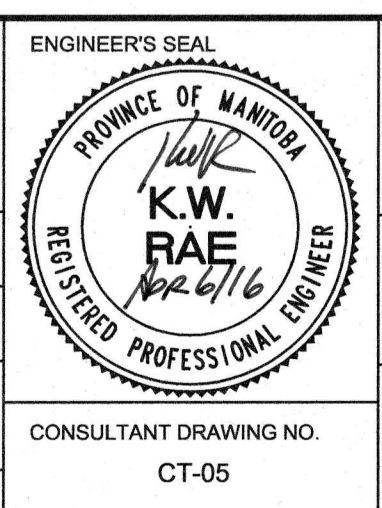

**THE CITY OF WINNIPEG**  
PUBLIC WORKS DEPARTMENT  
ENGINEERING DIVISION

2016 LOCAL STREET RENEWAL PROGRAM

LEAHCREST CRESCENT WEST - SCARFE ST. TO ARGATE DRIVE  
REHABILITATION  
STATION 0+470 TO ARGATE DRIVE

CITY DRAWING NUMBER  
SHEET 05 OF 14

CONSULTANT DRAWING NO. CT-05