

File Name: P:\Projects\2011\11-0107-18\Doc\Control\ToBeIssued\DWG\LD-8046\_Rev 0.dwg - Tab: LD-8046 Plotted By: Jminkevich 17/01/04 [Wed 10:03am]

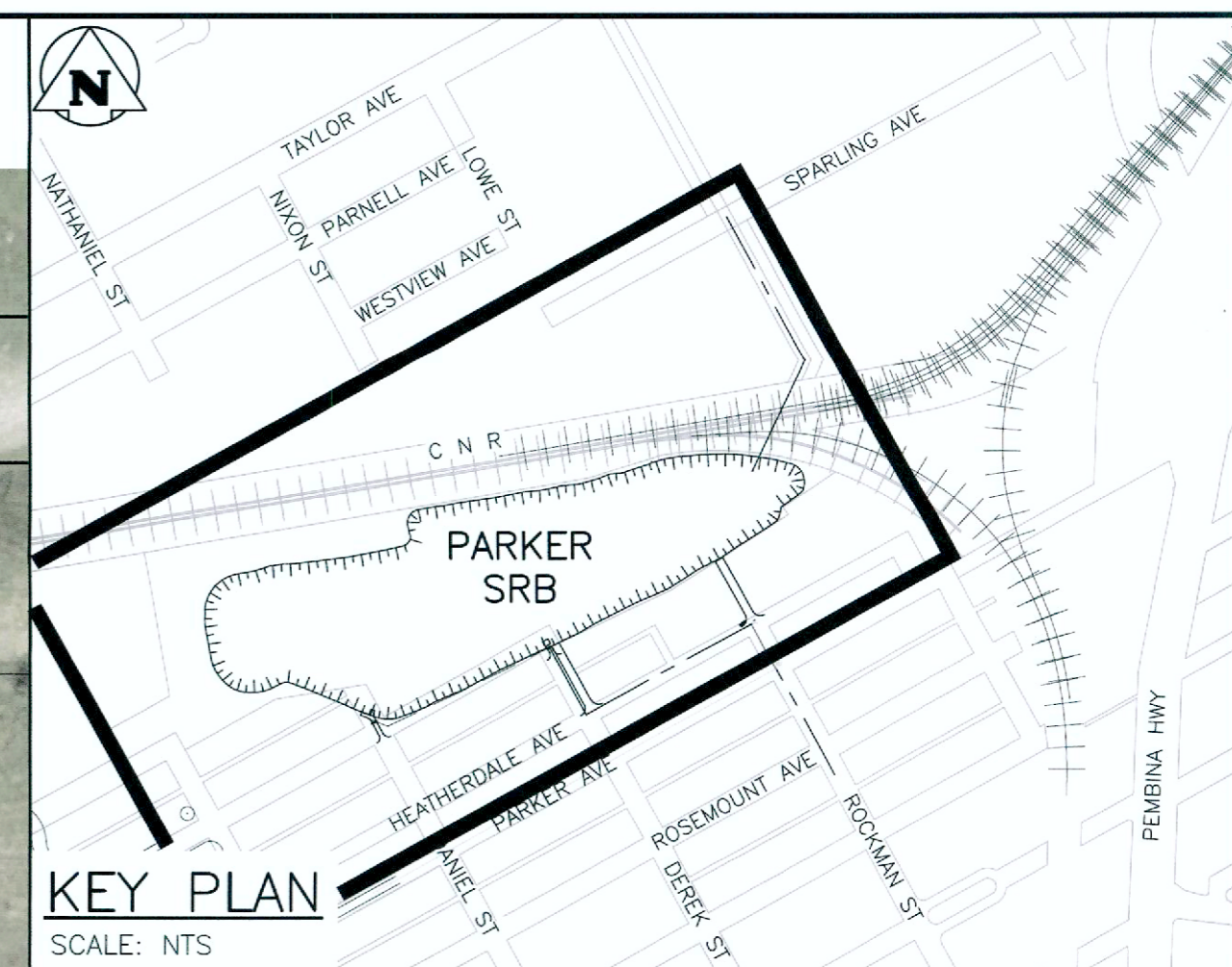

CAUTION: CONTRACTOR TO TAKE EXTREME CARE WHEN WORKING NEAR OVERHEAD AND UNDERGROUND HYDRO AND TELECOMMUNICATION LINES

APPROX 0.17 ha OF FORESTED AREA TO BE REMOVED

EXTENTS OF FUTURE STORMWATER RETENTION BASIN (BY OTHERS)

APPROX. 2.24 ha OF FORESTED AREA TO BE REMOVED

APPROX 0.01 ha OF FORESTED AREA TO BE REMOVED

FUTURE ROADWAY (BY OTHERS)

FUTURE ROADWAY (BY OTHERS)

PLAN  
SCALE: 1:1000

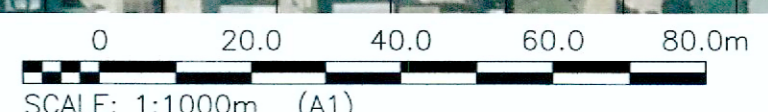

**APEGM**  
Certificate of Authorization  
KGS Group  
No. 245

**WARNING**  
1. NOTIFY THE GAS COMPANY OF THE PROPOSED LOCATION OF EXCAVATION.  
2. TAKE PRECAUTION TO AVOID DAMAGE TO GAS COMPANY INSTALLATIONS.  
3. SEE PROVINCIAL REGULATION 210/72 FOR DETAILS.

**PROPERTY LIMITS DELINEATION**  
DELINEATION OF PROPERTY LIMITS AS SHOWN ON THIS DWG DOES NOT REPRESENT A "LEGAL SURVEY". KGS GROUP MAKES NO REPRESENTATION OR WARRANTY AS TO THE ACCURACY OF PROPERTY LIMITS DELINEATED ON THIS DWG, NOR ON THE DIMENSIONAL ACCURACY OF DWG FEATURES RELATIVE TO THOSE PROPERTY LIMITS.

**METRIC**  
WHOLE NUMBERS INDICATE MILLIMETRES  
DECIMALIZED NUMBERS INDICATE METRES

150 WM	WATER MAIN	150 WM	HYDRANT VALVE	150 WM	WATER MAIN
300 LDS	LAND DRAINAGE SEWER	300 LDS	MANHOLE	300 LDS	LAND DRAINAGE SEWER
250 WWS	WASTE WATER SEWER	250 WWS	CATCH BASIN	250 WWS	WASTE WATER SEWER
	HYDRO M.T.S.		CURB INLET		CENTRELINE
	GAS		RAILWAY TRACKS		NORTH/WEST GUTTER
	CONCRETE		DITCH		SOUTH/EAST GUTTER
	ASPHALT		FENCE		N/W, S/E P'S
	SIDEWALK		HYDRO POLE		
	TURF STONE		HYDRO TOWER		
	PROPERTY LINE		TEST HOLE		
EXISTING	LEGEND-PLAN	PROPOSED	EXISTING	LEGEND-PLAN	PROPOSED

LOCATION APPROVED UNDERGROUND STRUCTURES		B.M. ELEV.	
SUPV. U/G STRUCTURES COMMITTEE	DATE		
NOTE: LOCATION OF UNDERGROUND STRUCTURES AS SHOWN ARE BASED ON THE BEST INFORMATION AVAILABLE. BUT NO GUARANTEE IS GIVEN THAT ALL EXISTING UTILITIES ARE SHOWN OR THAT THE GIVEN LOCATIONS ARE EXACT. CONFIRMATION OF EXISTENCE AND EXACT LOCATION OF ALL SERVICES MUST BE OBTAINED FROM THE INDIVIDUAL UTILITIES BEFORE PROCEEDING WITH CONSTRUCTION.			
NO.	REVISIONS	DATE	BY

<b>KGS GROUP</b> CONSULTING ENGINEERS		DESIGNED BY: JMM	CHECKED BY: RBO
		DRAWN BY: GEL	APPROVED BY:
		HOR. SCALE: 1:1000	RELEASED FOR CONSTRUCTION:
		VERTICAL: -	DATE: 16/06/10
		ISSUED FOR CONSTRUCTION: 17/01/05	DATE: 16/06/10

ENGINEER'S SEAL  
**J.M. MINKEVICH**  
Member 22769  
Jan 4 2017  
CONSULTANT DRAWING NO. 11-0107-18\_V301

**THE CITY OF WINNIPEG**  
WATER AND WASTE DEPARTMENT

PROJECT TITLE: **COCKBURN/CALROSSIE COMBINED SEWER RELIEF WORKS**  
STORMWATER RETENTION BASIN TREE REMOVAL - SITE PLAN

SHEET OF 1 OF 2  
COMPUTER FILE NAME: 11-0107-18\_V301  
CITY DRAWING NUMBER: LD-8046