

SUTHERLAND AVENUE

MEADE ST

100.7 OF 600 BRICK CS TO BE LINED
S-MA00013960 (PARTIALLY DETERIORATED)

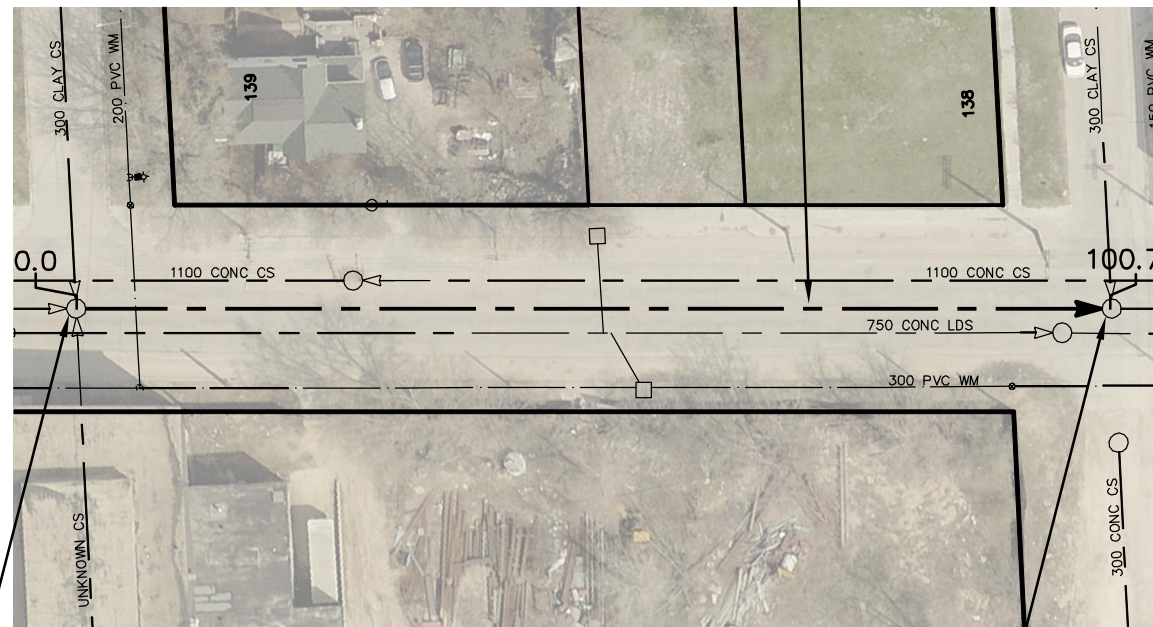

| SEWER JUNCTION INFORMATION FROM SEWER VIDEO INSPECTION | | |
|--|----------|-------|
| SEWER ID S-MA00013960 | | |
| DISTANCE FROM MH ID S-MH00012451 | | |
| DISTANCE | DIAMETER | CLOCK |
| 5.9 | 150 | 10 |
| 16.6 | 150 | 9 |
| 16.8 | 150 | 3 |
| 24.6 | 150 | 3 |
| 24.8 | 150 | 9 |
| 32.2 | 150 | 3 |
| 32.4 | 150 | 9 |
| 32.6 | 150 | 3 |
| ***REVERSAL REQUIRED*** | | |

| SEWER JUNCTION INFORMATION FROM SEWER VIDEO INSPECTION | | |
|--|----------|-------|
| SEWER ID S-MA00013960 | | |
| DISTANCE FROM MH ID S-MH00012459 | | |
| DISTANCE | DIAMETER | CLOCK |
| 7.1 | 150 | 2 |
| 15.5 | 150 | 3 |
| 15.7 | 150 | 9 |
| 23.2 | 150 | 3 |
| 23.3 | 150 | 9 |
| 30.9 | 150 | 3 |
| 31.0 | 150 | 9 |
| 38.6 | 150 | 3 |
| 38.6 | 150 | 9 |
| 45.0 | 150 | 3 |
| 45.2 | 150 | 9 |
| 46.2 | 150 | 9 |
| 46.4 | 150 | 3 |
| 47.7 | 150 | 3 |
| 53.8 | 150 | 9 |
| 54.0 | 150 | 3 |
| ***REVERSAL REQUIRED*** | | |

S-MH00012451
RIM 231.53
INV W 226.95
INV E 226.95
INV N 227.09

S-MH00012459
RIM 231.28
INV W 226.59
INV E 226.59
INV N 226.59

ARGYLE ST N

WARNING

IF POWER EQUIPMENT OR EXPLOSIVES ARE TO BE USED FOR EXCAVATION ON THIS PROJECT THE CONTRACTOR MUST:

- 1) NOTIFY THE GAS COMPANY OF THE PROPOSED LOCATION OF EXCAVATION.
- 2) TAKE PRECAUTION TO AVOID DAMAGE TO GAS COMPANY INSTALLATIONS.

SEE PROVINCIAL REGULATION 210/72 FOR DETAILS

FOR INDEX SEE
11020

METRIC

WHOLE NUMBERS INDICATE MILLIMETRES
DECIMALIZED NUMBERS INDICATE METRES



LOCATION APPROVED
UNDERGROUND STRUCTURES

SUPV. U/G STRUCTURES COMMITTEE DATE

NOTE:

LOCATION OF UNDERGROUND STRUCTURES AS SHOWN ARE BASED ON THE BEST INFORMATION AVAILABLE BUT NO GUARANTEE IS GIVEN THAT ALL EXISTING UTILITIES ARE SHOWN OR THAT THE GIVEN LOCATIONS ARE EXACT. CONFIRMATION OF EXISTENCE AND EXACT LOCATION OF ALL SERVICES MUST BE OBTAINED FROM THE INDIVIDUAL UTILITIES BEFORE PROCEEDING WITH CONSTRUCTION.

| B.M. ELEV. | | | |
|--|-----------|------|----|
| CONSTRUCTION COMPLETION DATE: YYYY MM DD | | | |
| NO. | REVISIONS | DATE | BY |
| | | | |
| | | | |
| | | | |
| | | | |
| | | | |
| | | | |
| | | | |
| | | | |
| | | | |
| | | | |

| | | | |
|-------------|------------|---------------------------|-----------|
| DESIGNED BY | NC | CHECKED BY | SC |
| DRAWN BY | RJ | APPROVED BY | KZ |
| SCALE: | 1:750 | RELEASED FOR CONSTRUCTION | KAS ZUREK |
| HORIZONTAL | | | |
| VERTICAL | | | |
| DATE | 2016 01 29 | DATE | |

ENGINEER'S SEAL
ORIGINAL
SIGNED BY
N.M.
CONTI
16/01/28

CONSULTANT DRAWING NUMBER



THE CITY OF WINNIPEG
WATER AND WASTE DEPARTMENT
ENGINEERING DIVISION

2015 SEWER RENEWALS
BY CIPP LINING
SUTHERLAND AVENUE
MH AT MEADE STREET TO
MH AT ARGYLE STREET

SHEET 53 OF 56

CITY DRAWING NUMBER

11069

PLOT DATE: 2016 01 29

BID OPPORTUNITY: 960-2015
CONTRACT NUMBER: 1

FILE PATH: R:\DRAWINGS\SEWER\2015 RENEWALS\RENEWALS & ASSOCIATED WORKS\Contract 1\Construction Dwg\
FILE NAME: SUTHERLAND_S-MA00013960.dwg