

**1** ENTRY PAVING  
L4.1 SCALE : 1:20

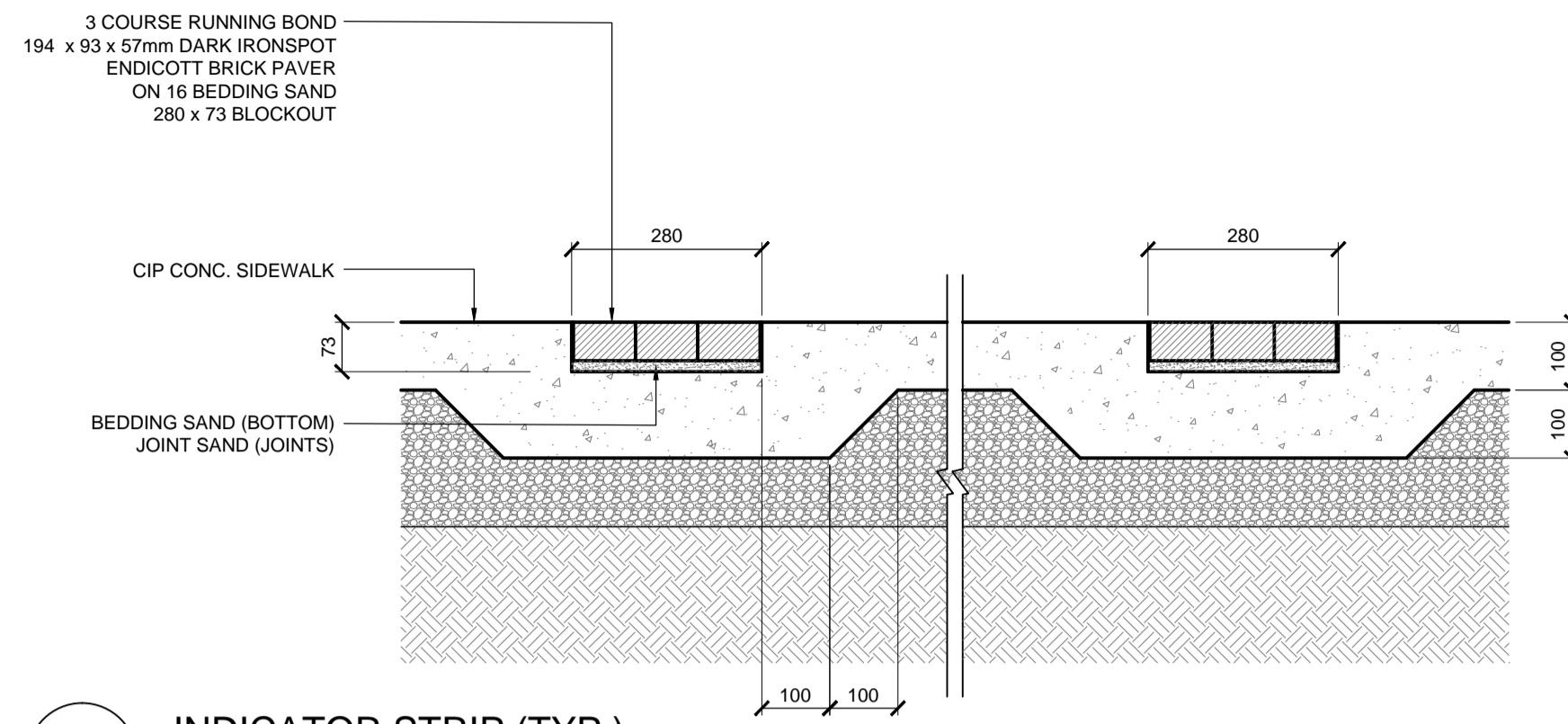

**2** INDICATOR STRIP (TYP.)  
L4.1 SCALE : 1:10

NOTES:  
1. PERMEABLE PAVERS SUPPLIED BY BARKMAN.  
2. NO. 8 AGGREGATE, NO. 75 STONE & NO. 2 STONE SIEVE SIZE (PERCENTAGE PASSING) DOCUMENTATION TO BE SUPPLIED BY BARKMAN. STRICT ADHERANCE TO THE SIEVE SIZE SHALL BE REQUIRED TO ENSURE THAT WATER WILL PASS THRU THE GRANULAR TO THE SUB-SOIL BELOW.

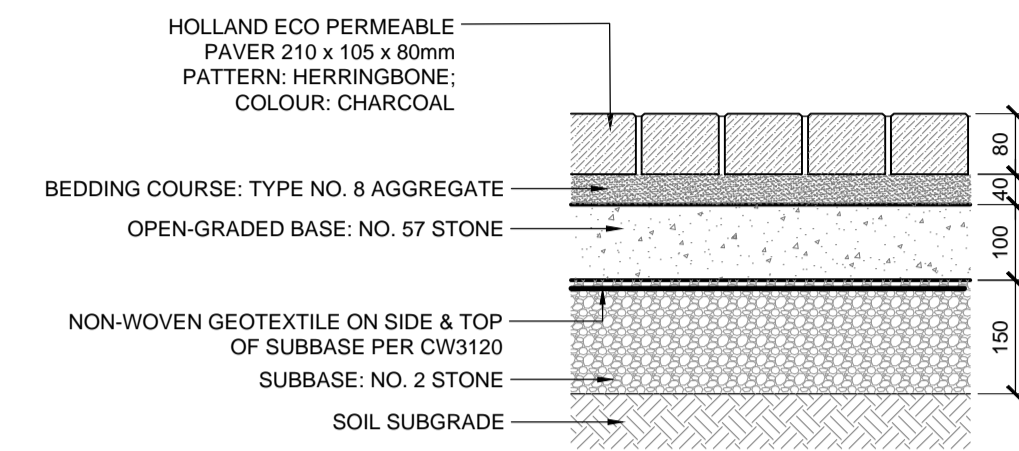

**3** PERMEABLE UNIT PAVERS  
L4.1 SCALE 1:10

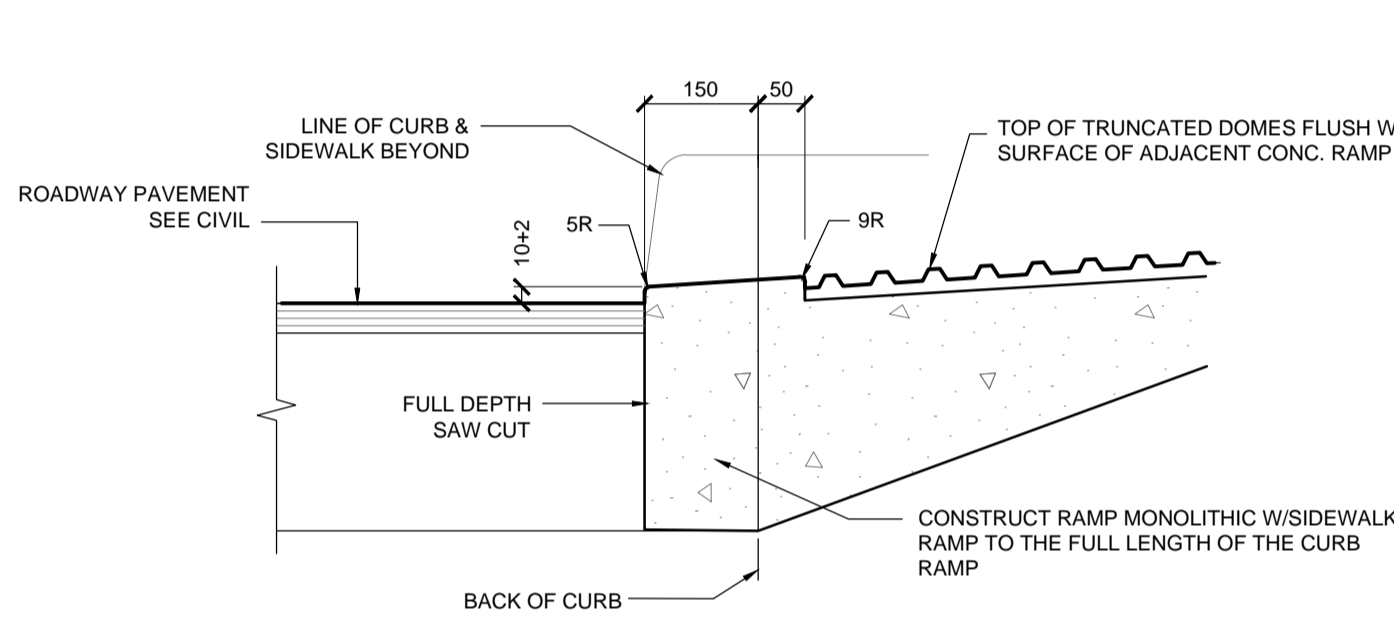

**4** CURB RAMP W/ TACTILE WARNING TILE  
L4.1 SCALE : NTS

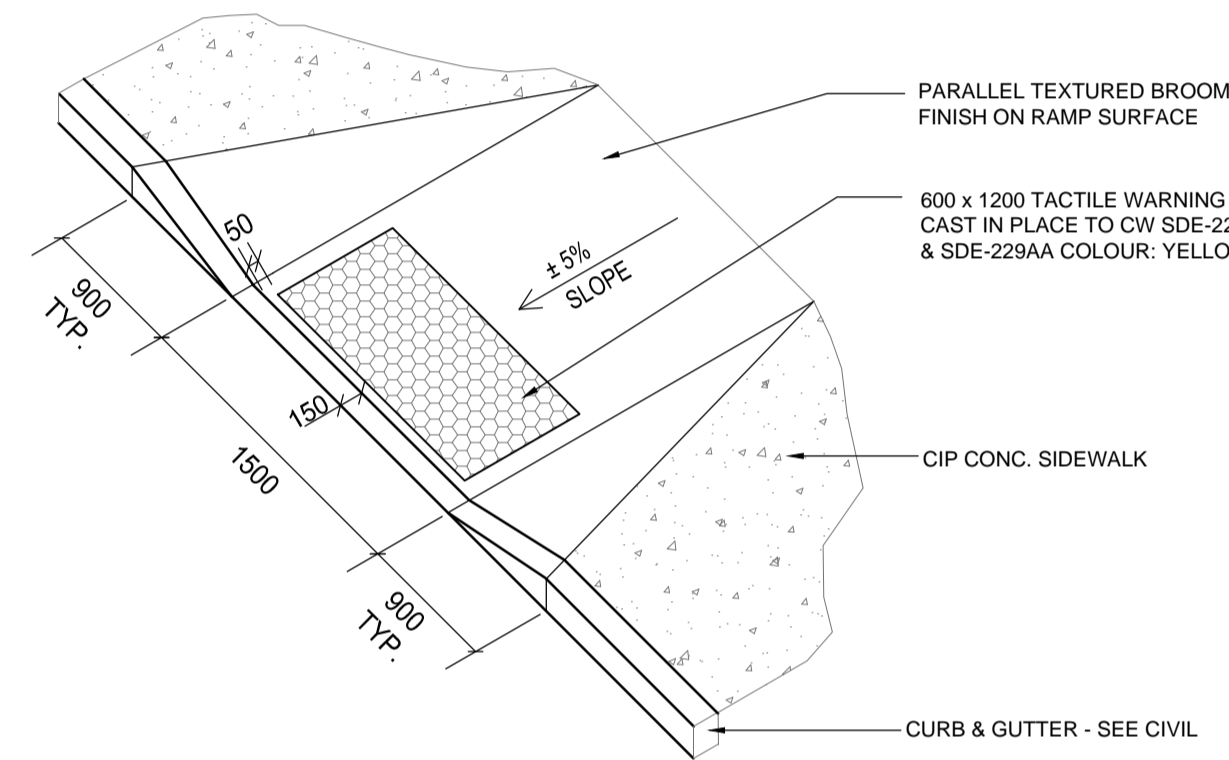

**5** BENCH - SURFACE MOUNTED  
L4.1 SCALE 1:10

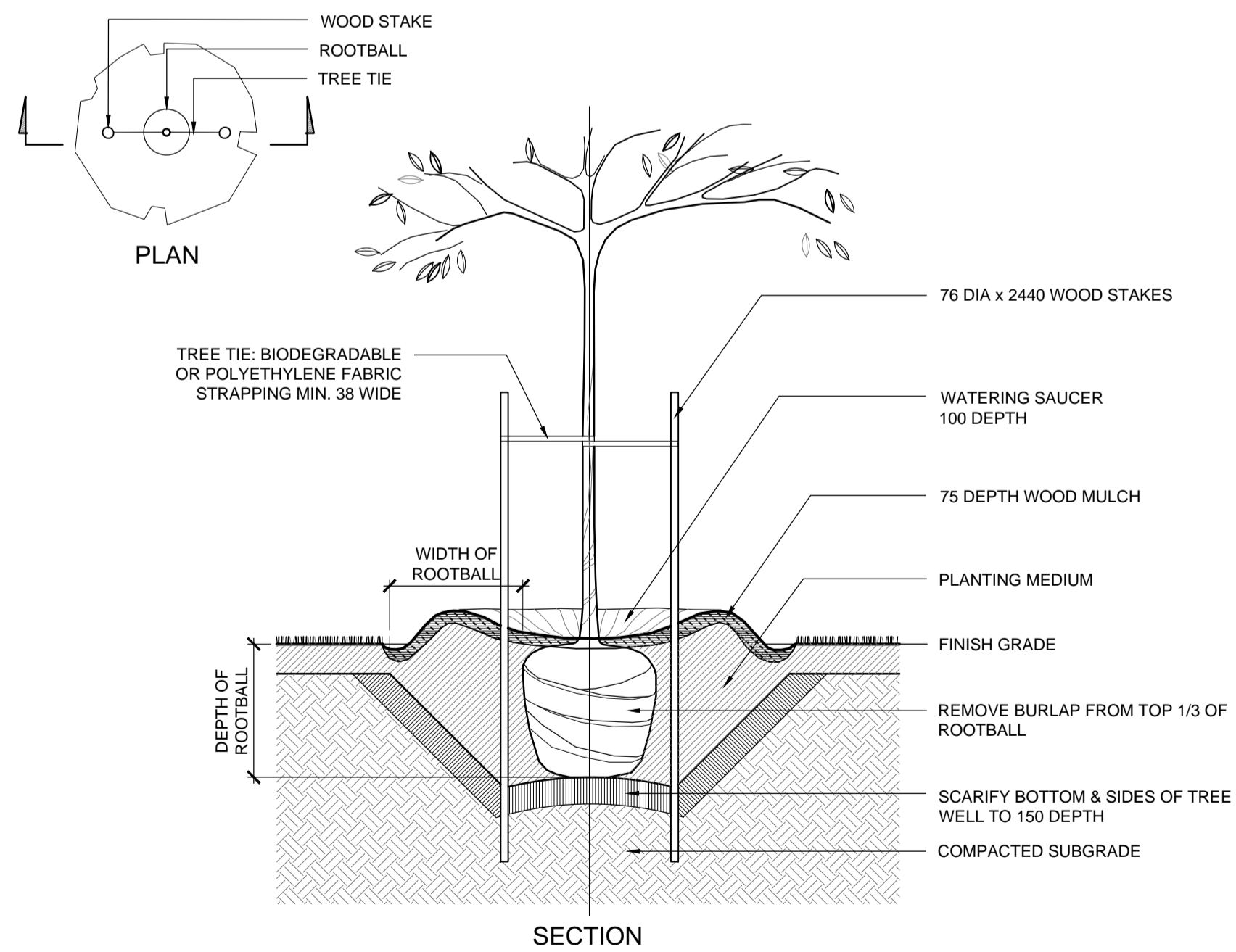
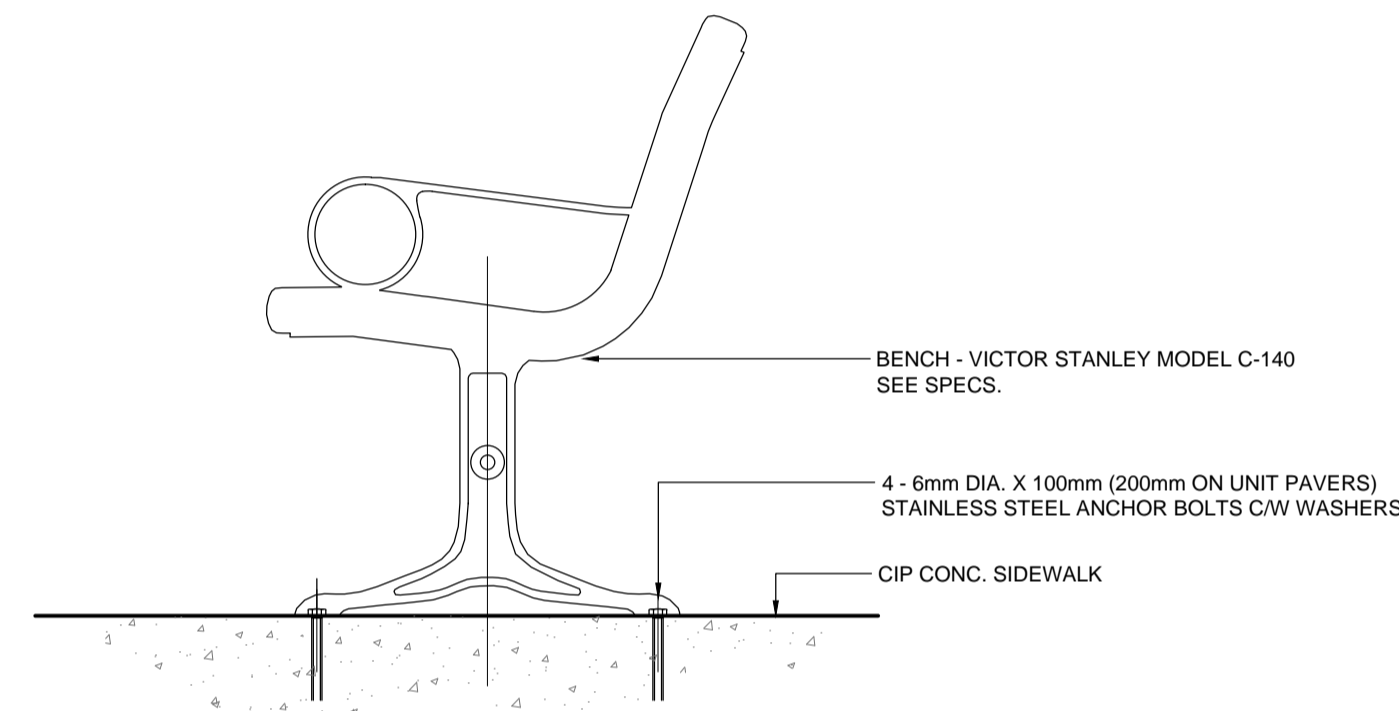

**6** TYP. DECIDUOUS TREE PLANTING DETAIL  
L4.1 SCALE : NTS

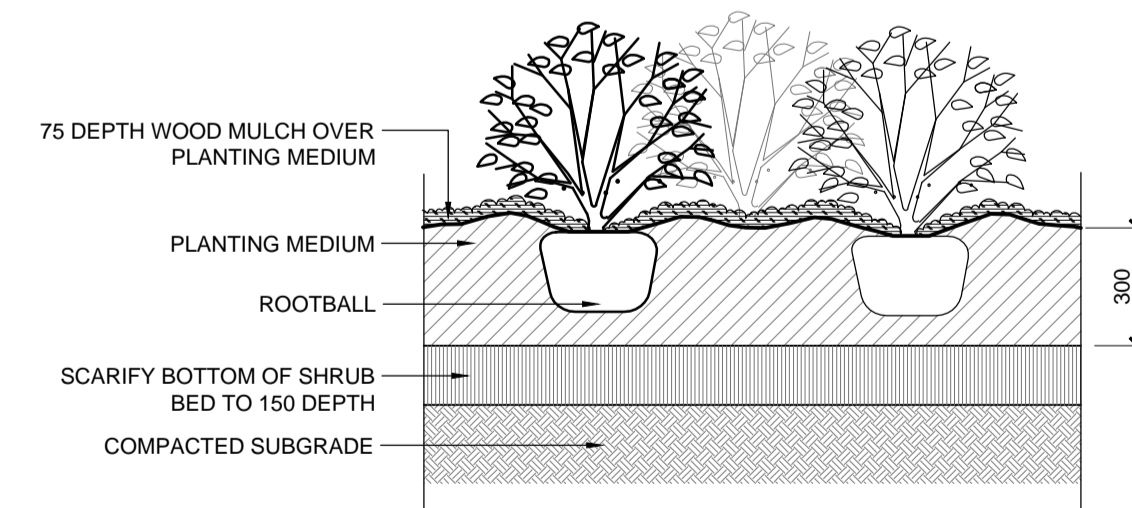

**7** TYP. SHRUB PLANTING DETAIL  
L4.1 SCALE : NTS

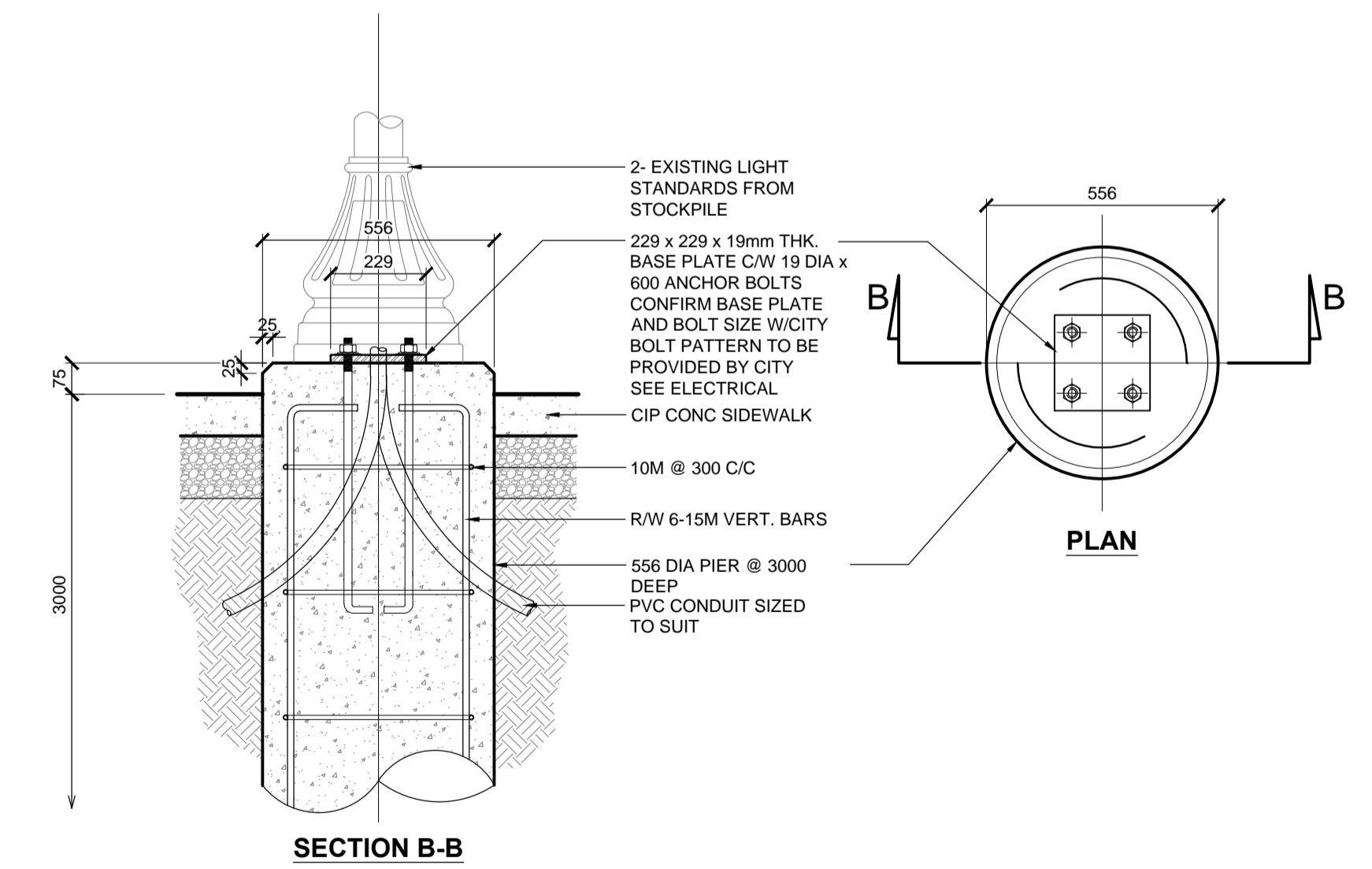

**8** LIGHT STANDARD FOUNDATION  
L4.1 SCALE 1:15

NOTE: These design documents are prepared solely for the use by the party with whom the design professional has entered into a contract and these are not representations of any kind made by the design professional to any party with whom the design professional has not entered into a contract.

JUL 27 2015 5:09pm \\ps\HTFC\FILE\_SERVER\2015\15-043\_Extst\_Exchange\_Phase\_3\ACAD\Details\15-043\_Details.dwg - tab: L4.1

LOCATIONS APPROVED UNDERGROUND STRUCTURES				G.S.M. ELEV.																					
SIGNED BY:	DATE																								
SUPV U/G STRUCTURES																									
LOCATION OF UNDERGROUND STRUCTURES AS SHOWN ARE BASED ON THE BEST INFORMATION AVAILABLE BUT NO GUARANTEE IS GIVEN THAT ALL EXISTING UTILITIES ARE SHOWN OR THAT THE GIVEN LOCATIONS ARE EXACT CONFIRMATION OF EXISTANCE AND EXACT LOCATION OF ALL SERVICES MUST BE OBTAINED FROM THE INDIVIDUAL UTILITIES BEFORE PROCEEDING																									
NO.	REVISIONS	DATE	BY	DATE	DATE																				
B	ISSUED FOR TENDER	28/07/15	JH																						
A	ISSUED TO U/G STRUCTURES FOR REVIEW	21/7/15	JH																						
<table border="1"> <tr> <td>DESIGNED BY</td> <td>JH</td> <td>CHECKED BY</td> <td>GM</td> </tr> <tr> <td>DRAWN BY</td> <td>JH</td> <td>APPROVED BY</td> <td>GM</td> </tr> <tr> <td>HOR. SCALE</td> <td>AS NOTED</td> <td>RELEASED FOR CONSTRUCTION</td> <td></td> </tr> <tr> <td>VERTICAL</td> <td>AS NOTED</td> <td></td> <td></td> </tr> <tr> <td>DATE</td> <td>JULY 21, 2015</td> <td>DATE</td> <td></td> </tr> </table>						DESIGNED BY	JH	CHECKED BY	GM	DRAWN BY	JH	APPROVED BY	GM	HOR. SCALE	AS NOTED	RELEASED FOR CONSTRUCTION		VERTICAL	AS NOTED			DATE	JULY 21, 2015	DATE	
DESIGNED BY	JH	CHECKED BY	GM																						
DRAWN BY	JH	APPROVED BY	GM																						
HOR. SCALE	AS NOTED	RELEASED FOR CONSTRUCTION																							
VERTICAL	AS NOTED																								
DATE	JULY 21, 2015	DATE																							

 HTFC PLANNING & DESIGN 200-115 St. James Avenue East, Winnipeg, MB R2B 0P5 PHONE: 204-541-1907	ENGINEER'S SEAL  CONSULTANT ACAD DWG. NO. L4.1	<b>THE CITY OF WINNIPEG</b> PUBLIC WORKS DEPARTMENT ENGINEERING SERVICES DIVISION	CITY DRAWING NUMBER
		<b>CITY OF WINNIPEG</b> HARDSCAPE & SOFTSCAPE DETAILS	SHEET 14 OF 15 BID NO. 669-2015