

**PROFILE**  
SCALE: HOR 1:250  
VER 1:100

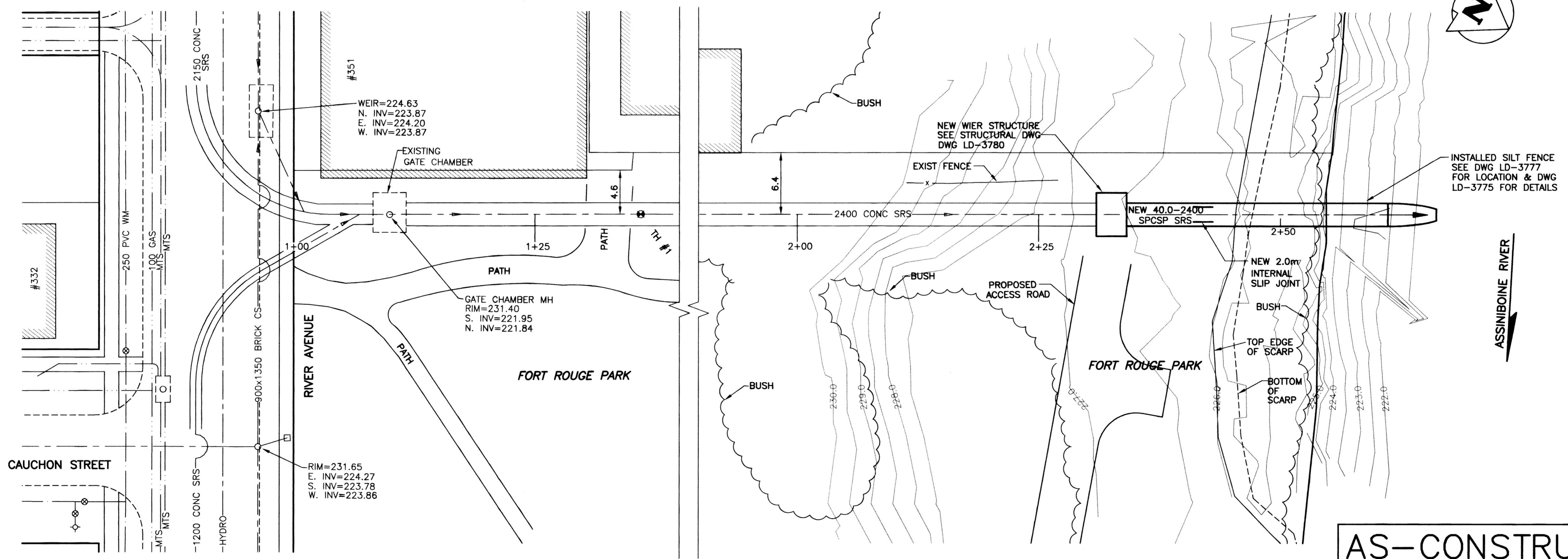

**PLAN**  
SCALE: HOR 1:250

**FORT ROUGE PARK OUTFALL AS-92**

MATERIAL LIST		
2400 # CSP	ARMTEC	MULTI PLATE
SLIP JOINT	ARMTEC	
DEBRIS GRATE	ARMTEC	

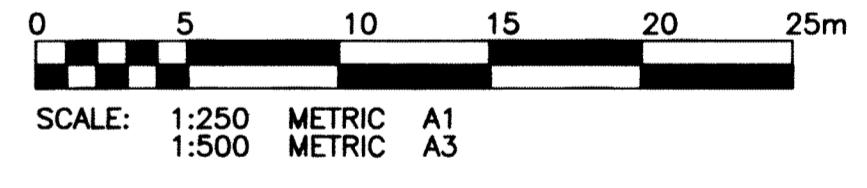
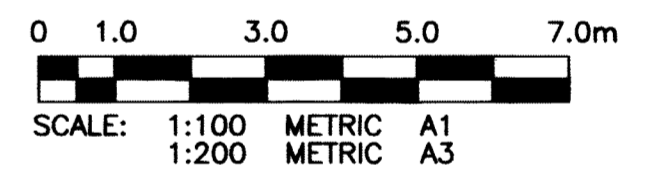

**WARNING**

IF POWER EQUIPMENT OR EXPLOSIVES ARE TO BE USED FOR EXCAVATION ON THIS PROJECT THE CONTRACTOR MUST:  
1) NOTIFY THE GAS COMPANY OF THE PROPOSED LOCATION OF EXCAVATION.  
2) TAKE PRECAUTION TO AVOID DAMAGE TO GAS COMPANY INSTALLATIONS.  
SEE PROVINCIAL REGULATION 210/72 FOR DETAILS.

**METRIC**

WHOLE NUMBERS INDICATE MILLIMETRES  
DECIMALIZED NUMBERS INDICATE METRES

**AS-CONSTRUCTED**  
WATER & WASTE DEPARTMENT

PROJECT COMPLETION DATE MARCH 31, 2008

**APEGN**  
Certificate of Authorization  
KGS Group  
No. 245 Date: 04/12/09

P:\Projects\2007\07-0107-08\Admin\DocControl\Issued\SOURCE\Drawings\LD-3774-R2.dwg - Tab: 01 Plotted By: DDerocoe 12/04/2009 [Fri 9:51am] PLOT 1:1 A1

EXISTING	LEGEND-PLAN	PROPOSED	EXISTING	LEGEND-PLAN	PROPOSED
150 WM	WATERMAIN	150 WM	HYDRO	HYDRO	HYDRO
300 LBS	LAND DRAINAGE SEWER	300 LBS	M.T.S.	PROPERTY LINE	PROPERTY LINE
250 WWS	WASTE WATER SEWER	250 WWS	PROPERTY LINE	SURVEY BAR	SURVEY BAR
MANHOLE	MANHOLE	MANHOLE	PROPERTY LINE	LIGHT STANDARD	LIGHT STANDARD
CATCH BASIN	CATCH BASIN	CATCH BASIN	PROPERTY LINE	HYDRO POLE	HYDRO POLE
CURB INLET	CURB INLET	CURB INLET	PROPERTY LINE	GUY WIRE	GUY WIRE
JUNCTIONS	JUNCTIONS	JUNCTIONS	PROPERTY LINE	SIGN	SIGN
CULVERT	CULVERT	CULVERT	PROPERTY LINE	BUSH LINE	BUSH LINE
GAS	GAS	GAS	PROPERTY LINE	FENCE	FENCE
			PROPERTY LINE	ELEVATION	ELEVATION

LOCATION APPROVED UNDERGROUND STRUCTURES	
SUPV. U/G STRUCTURES COMMITTEE	DATE
NOTE:	
LOCATION OF UNDERGROUND STRUCTURES AS SHOWN ARE BASED ON THE BEST INFORMATION AVAILABLE BUT NO GUARANTEE IS GIVEN THAT ALL EXISTING UTILITIES ARE SHOWN OR THAT THE GIVEN LOCATIONS ARE EXACT. CONFIRMATION OF EXISTENCE AND EXACT LOCATION OF ALL SERVICES MUST BE OBTAINED FROM THE INDIVIDUAL UTILITIES BEFORE PROCEEDING WITH CONSTRUCTION.	

B.M. 53-006	ELEV. 232.225 m	S.W. COR. OF LANE BTWN SCOTT ST. & CAUCHON ST., TBLT. IN E. CONC. FOUNDATION OF NO. 344 RIVER AVE., 1.0 m S. & 0.2 m BELOW BRICK FROM N.E. COR. OF BLDG.
2	AS CONSTRUCTED	04/12/09
1	AS-BUILT	16/06/09
0	ISSUED FOR TENDER	03/12/07
NO.	REVISIONS	DATE BY

**KGS GROUP**  
CONSULTING ENGINEERS & PROJECT MANAGERS  
WINNIPEG THUNDER BAY (204) 896-1208 (204) 345-2233

DESIGNED BY: RJH	CHECKED BY: RJH
DRAWN BY: DW	APPROVED BY:
HOR. SCALE: 1:250	RELEASED FOR CONSTRUCTION:
VERTICAL: 1:100	DATE: 05/06/07

ENGINEER'S SEAL  
PROVINCE OF MANITOBA  
**R.J. HOUSTON**  
Member  
REGISTERED PROFESSIONAL ENGINEER

**THE CITY OF WINNIPEG**  
WATER & WASTE DEPARTMENT  
Winnipeg

**FORT ROUGE PARK OUTFALL PIPE REPLACEMENT**

**FORT ROUGE PARK OUTFALL (AS-92)**

SHEET 01 OF 10  
CAD FILE DRAWING NUMBER FT ROUGE PARK-PLOT  
CITY DRAWING NUMBER LD-3774

CONSULTANT DRAWING NO. 07-0107-08 01