

TYPICAL CROSS SECTION

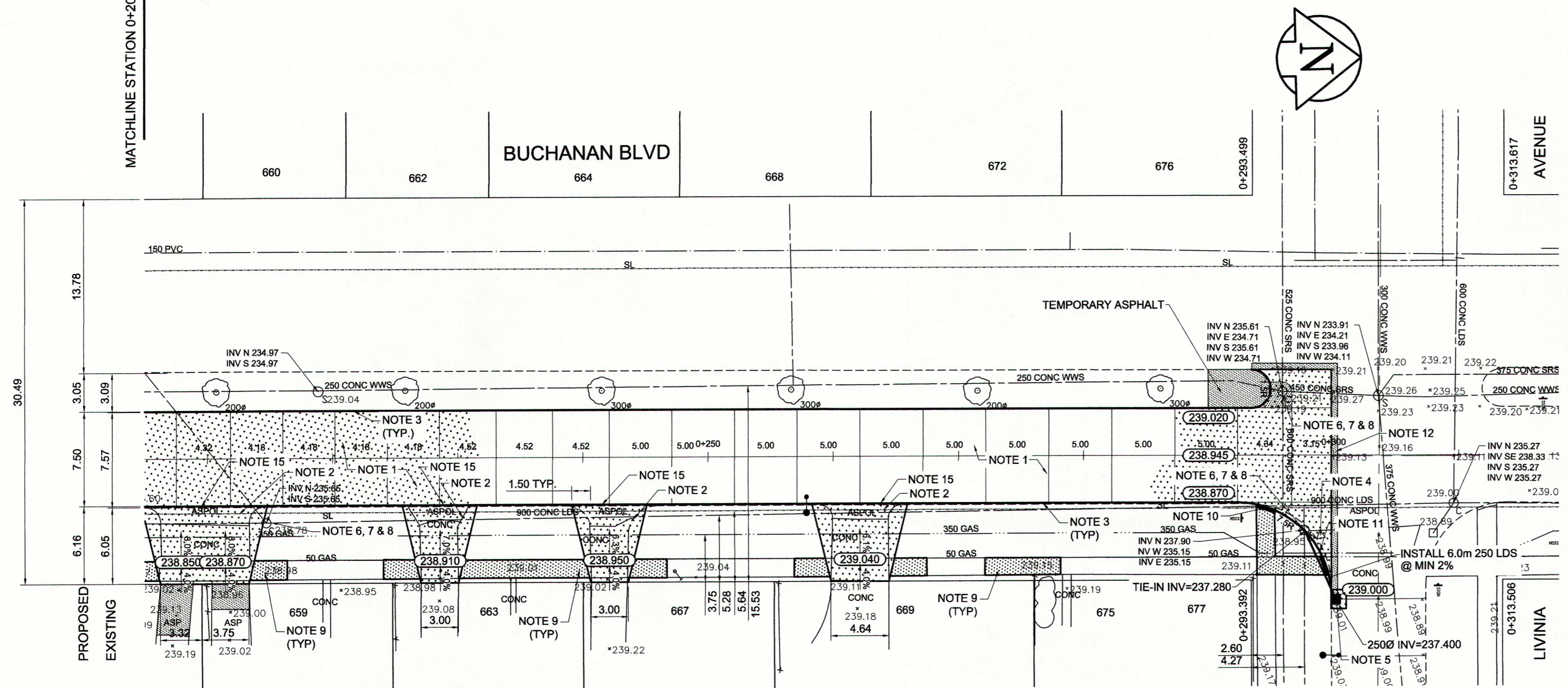

- REFERENCE NOTES**
- PAVEMENT DIMENSIONS ARE TO BACK OF CURB
 - BASELINE IS CENTRE LINE RIGHT-OF-WAY
 - PROPERTY LINES OBTAINED FROM CITY OF WINNIPEG L.B.I.S., AND NO SCALE FACTOR WAS APPLIED
 - REFER TO AECOM FIELD BOOK NO. 4846
- CONSTRUCTION NOTES**
- REMOVE EXISTING CONCRETE PAVEMENT AND CONSTRUCT NEW 200mm REINFORCED CONCRETE PAVEMENT
 - REMOVE EXISTING CONCRETE PAVEMENT AND CONSTRUCT NEW 150mm REINFORCED CONCRETE PAVEMENT
 - CONSTRUCT NEW BARRIER CURB (180mm HT. SEPARATE)
 - REMOVE EXISTING CATCH PIT AND PLUG EXISTING LEAD
 - INSTALL NEW CURB AND GUTTER INLET c/w CATCH BASIN (SD-024) AND CONNECT TO EXISTING MANHOLE
 - REMOVE EXISTING FRAME AND COVER AND PLACE NEW FRAME AND SOLID COVER (AP-004/AP-005)
 - ADJUST EXISTING MANHOLE TO GRADE
 - INSTALL NEW CAST IRON RING
 - RENEW EXISTING 100mm CONCRETE SIDEWALK
 - INSTALL NEW CURB RAMP (10mm HT. INTEGRAL)
 - CONSTRUCT NEW MODIFIED BARRIER CURB (180mm HT. INTEGRAL)
 - REMOVE EXISTING ASPHALTIC PAVEMENT AND CONSTRUCT NEW ASPHALTIC PAVEMENT TYPE 1A
 - ADJUST EXISTING WATER VALVE TO GRADE
 - ADJUST EXISTING CURB STOP TO GRADE
 - CONSTRUCT NEW LIP CURB (40mm HT. INTEGRAL)



METRIC
WHOLE NUMBERS INDICATE MILLIMETRES
DECIMALIZED NUMBERS INDICATE METRES

EXISTING	LEGEND - PLAN	PROPOSED	EXISTING	LEGEND - PLAN	PROPOSED	EXISTING	LEGEND - PROFILE	PROPOSED
150 mm W.M.	WATERMAIN	150 mm W.M.	HYDRO	M.T.S.	X	C PROFILE	WEST MEDIAN	
300mm L.D.S.	LAND DRAINAGE SEWER	300mm L.D.S.	CONCRETE	ASPHALT	○		SOUTH/EAST GUTTER	
250mm W.W.S.	WASTEWATER SEWER	250mm W.W.S.	PROPERTY LINE	SURVEY BAR	○		N/W PROPERTY LINE	
○	MANHOLE	●	ELEVATION	(35.750)	○		S/E PROPERTY LINE	
□	CATCH BASIN	●	TREE	SIDEWALK RAMP	—			
▽	CATCH PIT	●	CONCRETE SIDEWALK	FENCE	—			
—	JUNCTIONS	—						
—	CULVERT	—						
—	GAS	—						

LOCATION APPROVED UNDERGROUND STRUCTURES

SUPV. / U/G STRUCTURES COMMITTEE DATE

NOTE:
LOCATION OF UNDERGROUND STRUCTURES AS SHOWN ARE BASED ON THE BEST INFORMATION AVAILABLE. BUT NO GUARANTEE IS GIVEN THAT ALL EXISTING UTILITIES ARE SHOWN OR THAT THE GIVEN LOCATIONS ARE EXACT. CONFIRMATION OF EXISTENCE AND EXACT LOCATION OF ALL SERVICES MUST BE OBTAINED FROM THE INDIVIDUAL UTILITIES BEFORE PROCEEDING WITH CONSTRUCTION.

B.M. 14 - 35
ELEV. 239.659

N.W. Cor. Buchanan Blvd. & Fairlane Ave.,
Tilt on top of 0.05 m dia. x 2.4 m iron pipe on W.L.

NO.	REVISIONS	DATE	BY
0	ISSUED FOR TENDER	04/21/2015	BC
A	ISSUED FOR REVIEW	04/14/2015	BC

AECOM

DESIGNED BY: BC/SS
CHECKED BY: KWR

DRAWN BY: PB/RT
APPROVED BY: [Signature]

HOR. SCALE: 1:250
VERTICAL: 1:10

DATE: APRIL 21, 2015

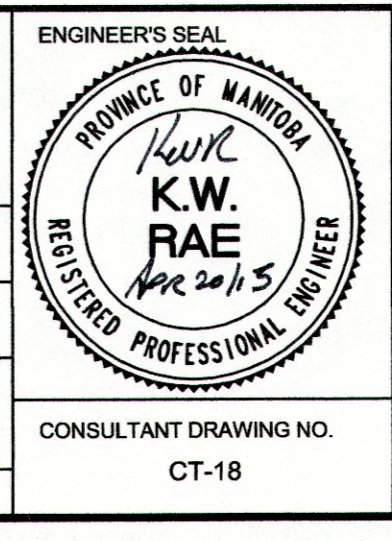

THE CITY OF WINNIPEG
PUBLIC WORKS DEPARTMENT
ENGINEERING DIVISION

2015 LOCAL STREET RENEWAL PROGRAM

BUCHANAN Blvd. PORTAGE AVENUE TO LIVINIA AVENUE
CONCRETE RECONSTRUCTION
STATION 0+205 TO LIVINIA AVENUE

CITY DRAWING NUMBER: SHEET 18 OF 20