

THIS DRAWING MUST NOT BE SCALED.  
 THE GENERAL CONTRACTOR SHALL VERIFY ALL DIMENSIONS, QUANTITIES, AND LEVELS PRIOR TO COMMENCEMENT OF WORK. ALL ERRORS AND OMISSIONS TO BE REPORTED TO NUMBER TEN ARCHITECTURAL GROUP BEFORE PROCEEDING.  
 VARIATIONS AND MODIFICATIONS TO WORK SHOWN ON THESE DRAWINGS SHALL NOT BE CARRIED OUT WITHOUT WRITTEN PERMISSION OF NUMBER TEN ARCHITECTURAL GROUP.  
 THIS DRAWING IS THE EXCLUSIVE PROPERTY OF NUMBER TEN ARCHITECTURAL GROUP AND THE COPYRIGHT IN THE SAME BEING RESERVED TO THEM. IT MAY BE REPRODUCED ONLY WITH THE PERMISSION OF NUMBER TEN ARCHITECTURAL GROUP, IN WHICH CASE THE REPRODUCTION MUST BEAR THEIR NAME.

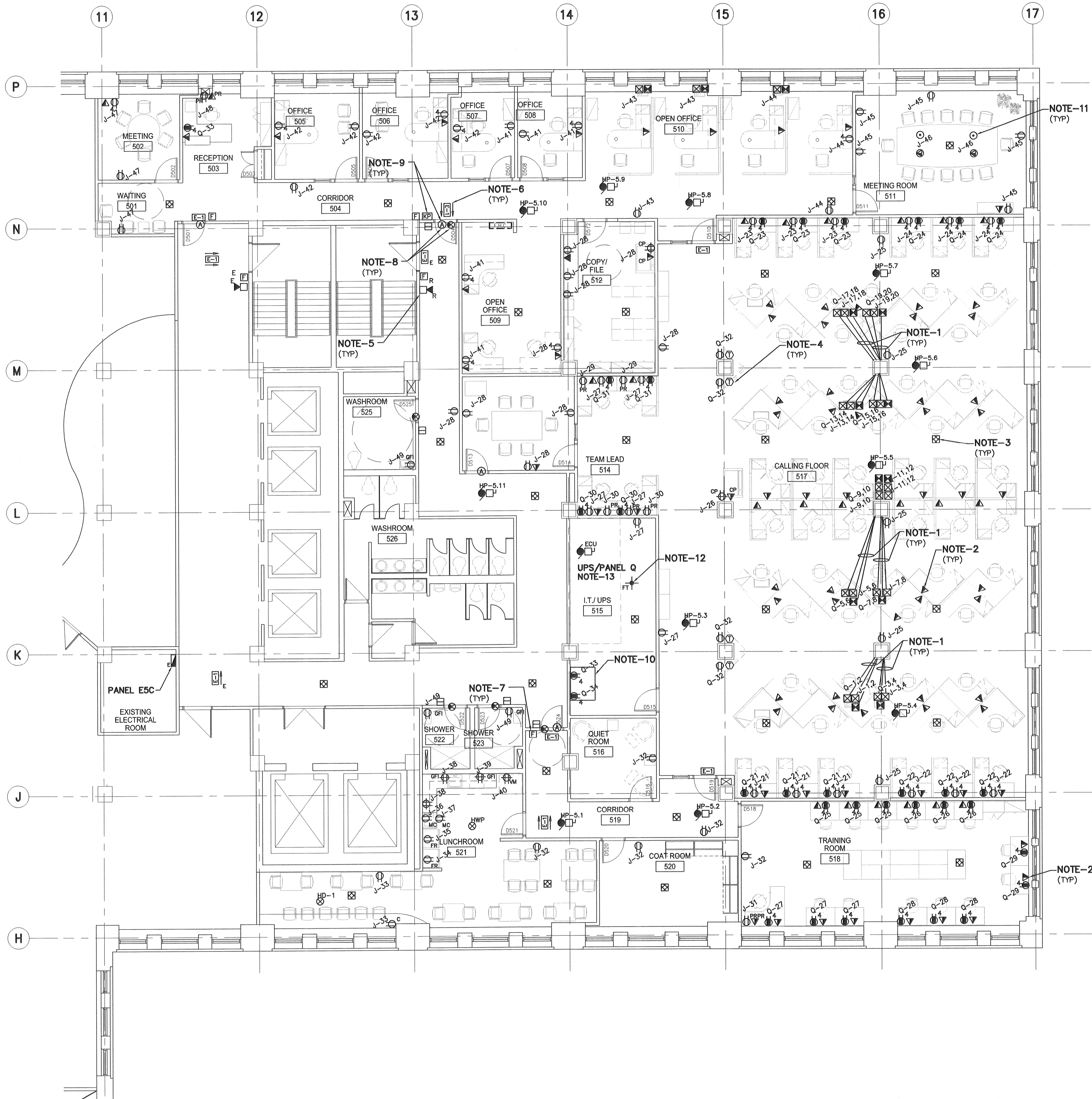

- NOTES:**
1. PROVIDE POWER AND DATA TRENCHED INTO SLAB FROM COLUMN TO FEED POWERED FURNITURE. ELECTRICAL CONTRACTOR SHALL PROVIDE FLOOR PEDESTAL. POWERED FURNITURE SUPPLIER SHALL PROVIDE WHIP. EC SHALL MAKE ALL FINAL CONNECTIONS.
  2. EC SHALL PROVIDE VOICE/DATA OUTLETS IN ALL WALLS AND POWERED FURNITURE. EACH DVO SHALL BE C/W 3 JACK AND 3 CAT6 CABLES, ONE FOR VOICE AND 2 FOR DATA C/W FINAL CONNECTIONS.
  3. DISCONNECT AND REMOVE ALL EXISTING FIRE ALARM BELLS AND SPEAKERS, PROVIDE NEW FIRE ALARM SPEAKERS AND MODIFY SYSTEM AS REQUIRED TO ACCOMMODATE NEW TENANT SPACE.
  4. COORDINATE MOUNTING HEIGHT OF TV OUTLETS WITH ARCHITECT PRIOR TO ROUGH IN.
  5. DISCONNECT AND RELOCATE EXISTING FIRE ALARM DEVICES AS REQUIRED TO ACCOMMODATE NEW DOOR.
  6. PROVIDE NEW LED EXIT SIGN, WIRED AND CONNECTED TO EXISTING EXIT SIGN SYSTEM(S).
  7. PROVIDE NEW FIRE ALARM DEVICE, WIRED AND CONNECTED TO EXISTING FIRE ALARM SYSTEM.
  8. PROVIDE THREE (3) CARD READERS TO MATCH EXISTING BASE BUILDING SYSTEM IN LOCATIONS AS SHOWN. PROVIDE 120V EMERGENCY POWER FOR ELECTRIC STRIKE. WIRE AND CONNECT TO EXISTING BASE BUILDING SYSTEM AS REQUIRED.
  9. PROVIDE DOOR ALARM CONTACT AND KEY PAD. WIRE AND CONNECT TO EXISTING BASE BUILDING SYSTEM.
  10. COMMUNICATION RACK SHALL BE PROVIDED BY TENANT. ELECTRICAL CONTRACTOR SHALL PROVIDE ALL DATA OUTLETS, CABLING AND MAKE ALL FINAL CONNECTIONS.
  11. PROVIDE FLUSH POKE THROUGH OUTLETS IN MEETING ROOM.
  12. PROVIDE HEAT DETECTOR, WIRE & CONNECT COMPRESSOR & CONTROL PANEL AS REQUIRED TO PROVIDE AN OPERATIONAL PRE-ACTION SYSTEM.
  13. RELOCATE UPS/PANEL Q TO NEW LOCATION AS SHOWN. WIRE AND CONNECT TO EXISTING SYSTEM. EXTEND/MODIFY/REPLACE WIRING AS REQUIRED FOR SAME.

No.	REVISED/ ISSUED/ PLOTTED	DATE
1	ISSUED FOR 90% REVIEW	MAY 3, 2008
2	ISSUED FOR CONSTRUCTION	MAY 5, 2008
3		
4		
5		
6		

1 FLOOR PLAN - POWER & SYSTEMS  
 E2.2 SCALE: 1/8"=1'-0"

**numberTEN**  
 architectural group

204 942.0981 victoria BC 250 360.2106

architecture • interior design • graphic design

CITY OF WINNIPEG  
 311 CONTACT CENTRE  
 500 - 234 DONALD ST.  
 WINNIPEG, MB.

project  
 FLOOR PLAN  
 POWER & SYSTEMS LAYOUT

sheet title

**MCW / AGE**  
 Consulting Professional Engineers  
 215-101 Wellington Avenue  
 Winnipeg, Manitoba R2W 0G4  
 Phone: (204) 779-2000 Fax: (204) 779-1119  
 E-Mail: mcw\_age@mcw.com

consultant

**APEGN**  
 Certificate of Authorization  
 MCW/AGE Consulting  
 Professional Engineers  
 No. 589 Expiry: April 30, 2008

PROVINCE OF MANITOBA  
 MAY 5, 2008  
 K.E. ISAAK  
 REGISTERED PROFESSIONAL ENGINEER

scale: 1/8"=1'-0"  
 date: MAY 5, 2008  
 drawn by: PCS/AJ  
 checked by: DG  
 project no. 2007128  
 sheet no. E2.2