

- REFERENCE NOTES**
- A. PAVEMENT DIMENSIONS ARE TO BACK OF CURB
 - B. BASELINE IS CENTRE LINE RIGHT-OF-WAY
 - C. PROPERTY LINES OBTAINED FROM CITY OF WINNIPEG L.B.I.S., AND NO SCALE FACTOR WAS APPLIED
 - D. REFER TO AECOM FIELD BOOK NO. 4810

- CONSTRUCTION NOTES**
1. REMOVE EXISTING CONCRETE PAVEMENT AND CONSTRUCT NEW ASPHALTIC PAVEMENT TYPE 1A (100mm)
 2. REMOVE EXISTING CONCRETE PAVEMENT AND CONSTRUCT NEW 150mm REINFORCED CONCRETE PAVEMENT
 3. REMOVE EXISTING FRAME AND COVER AND INSTALL NEW FRAME AND COVER (AP-005 AND AP-004)
 4. ADJUST EXISTING MANHOLE/CATCH BASIN TO GRADE
 5. INSTALL NEW CAST IRON RISER RING
 6. CONSTRUCT NEW BARRIER CURB AND GUTTER (180mm HT.)
 7. CONSTRUCT NEW MODIFIED BARRIER CURB AND GUTTER (180mm HT.)
 8. CONSTRUCT NEW CURB RAMP AND GUTTER (10mm HT.)
 9. CONSTRUCT NEW LIP CURB AND GUTTER (40mm HT. INTEGRAL)
 10. ADJUST EXISTING WATER VALVE TO GRADE
 11. RENEW EXISTING 100mm CONCRETE SIDEWALK
 12. ADJUST EXISTING CURB STOP
 13. REMOVE EXISTING CATCHBASIN AND ABANDON LEAD
 14. INSTALL NEW CURB AND GUTTER INLET c/w CATCHBASIN (SD-024) AND CONNECT TO EXISTING 750 CS
 15. INSTALL 150mm SUBDRAIN

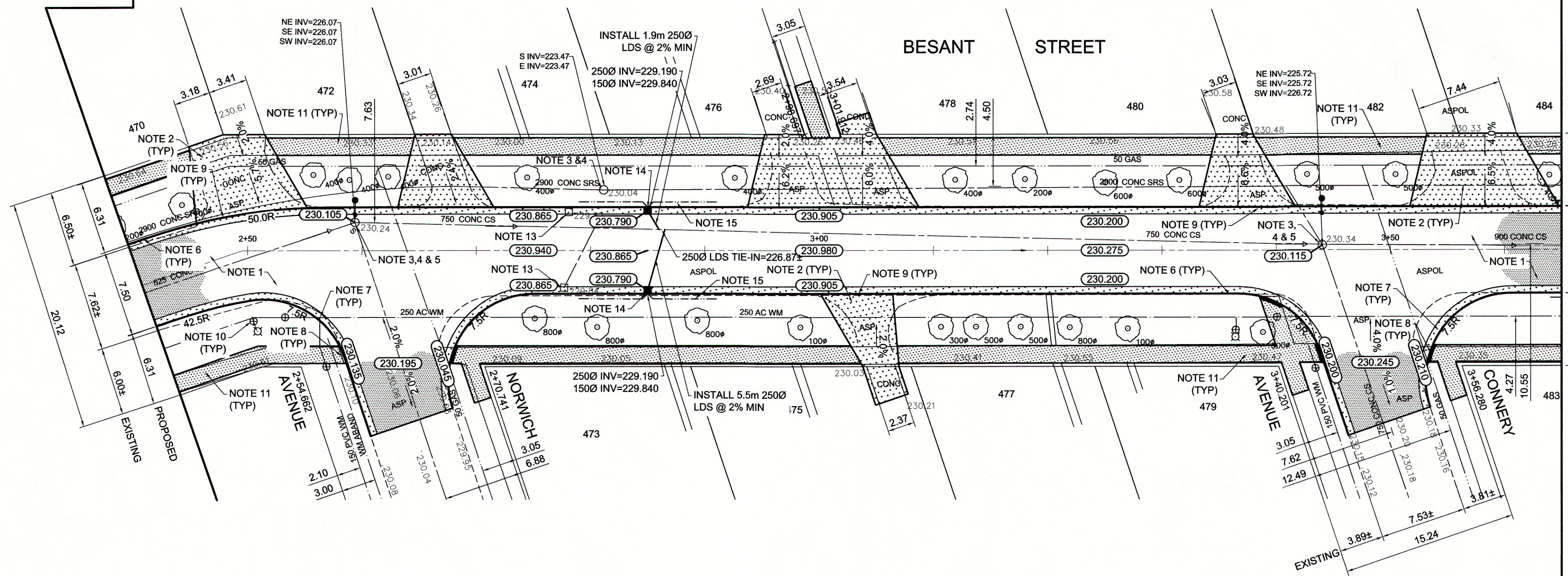

METRIC
WHOLE NUMBERS INDICATE MILLIMETRES
DECIMALIZED NUMBERS INDICATE METRES

EXISTING	LEGEND - PLAN	PROPOSED	EXISTING	LEGEND - PLAN	PROPOSED	EXISTING	LEGEND - PROFILE	PROPOSED
150mm W.M.	WATERMAIN	150mm W.M.	---	HYDRO	---	---	C PROFILE	---
300mm L.D.S.	LAND DRAINAGE SEWER	300mm L.D.S.	---	CONCRETE	---	---	NORTH/WEST GUTTER	---
250mm W.W.S.	WASTEWATER SEWER	250mm W.W.S.	---	ASPHALT	---	---	SOUTH/EAST GUTTER	---
○	MANHOLE	●	---	PROPERTY LINE	---	---	N/W PROPERTY LINE	---
□	CATCH BASIN	■	---	SURVEY BAR	---	---	S/E PROPERTY LINE	---
▽	CATCH PIT	▼	---	ELEVATION	(35.750)	---		
---	JUNCTIONS	---	---	TREE	---	---		
---	CULVERT	---	---	SIDEWALK RAMP	---	---		
---	GAS	---	---	CONCRETE SIDEWALK	---	---		
---		---	---	FENCE	---	---		

LOCATION APPROVED UNDERGROUND STRUCTURES

SUPV. U/G STRUCTURES COMMITTEE DATE

NOTE:
LOCATION OF UNDERGROUND STRUCTURES AS SHOWN ARE BASED ON THE BEST INFORMATION AVAILABLE. BUT NO GUARANTEE IS GIVEN THAT ALL EXISTING UTILITIES ARE SHOWN OR THAT THE GIVEN LOCATIONS ARE EXACT. CONFIRMATION OF EXISTENCE AND EXACT LOCATION OF ALL SERVICES MUST BE OBTAINED FROM THE INDIVIDUAL UTILITIES BEFORE PROCEEDING WITH CONSTRUCTION.

NO.	REVISIONS	DATE	BY
0	ISSUED FOR TENDER	03/04/2014	BC
A	ISSUED FOR REVIEW	02/07/2014	BC

B.M. ELEV. 85R599 231.031	In CPR Kewatin Subd. ROW & Nottingham Ave. Tibl on pipe, 11.6m S of Nl. Nottingham Ave & 5.2m E of Wl. of CPR ROW		
DESIGNED BY	BC/SS	CHECKED BY	KWR
DRAWN BY	PB/RT	APPROVED BY	
HOR. SCALE:	1:250	RELEASED FOR CONSTRUCTION BY:	
VERTICAL:	1:10	DATE	Mar 4/14

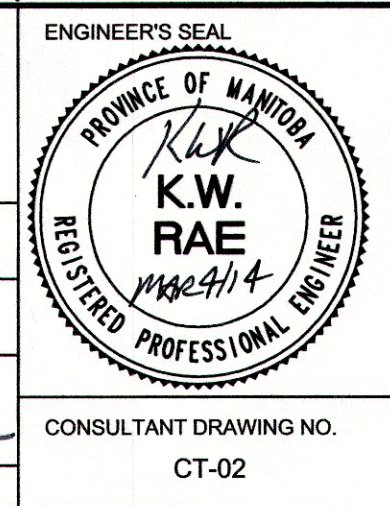

THE CITY OF WINNIPEG
PUBLIC WORKS DEPARTMENT
ENGINEERING DIVISION

2014 LOCAL STREET RENEWAL PROGRAM

BESANT STREET-MOLSON STREET-HAMPSTEAD AVENUE ASPHALT RECONSTRUCTION STATION 2+40 TO STATION 3+65

CITY DRAWING NUMBER SHEET 02 OF 27

CONSULTANT DRAWING NO. CT-02