

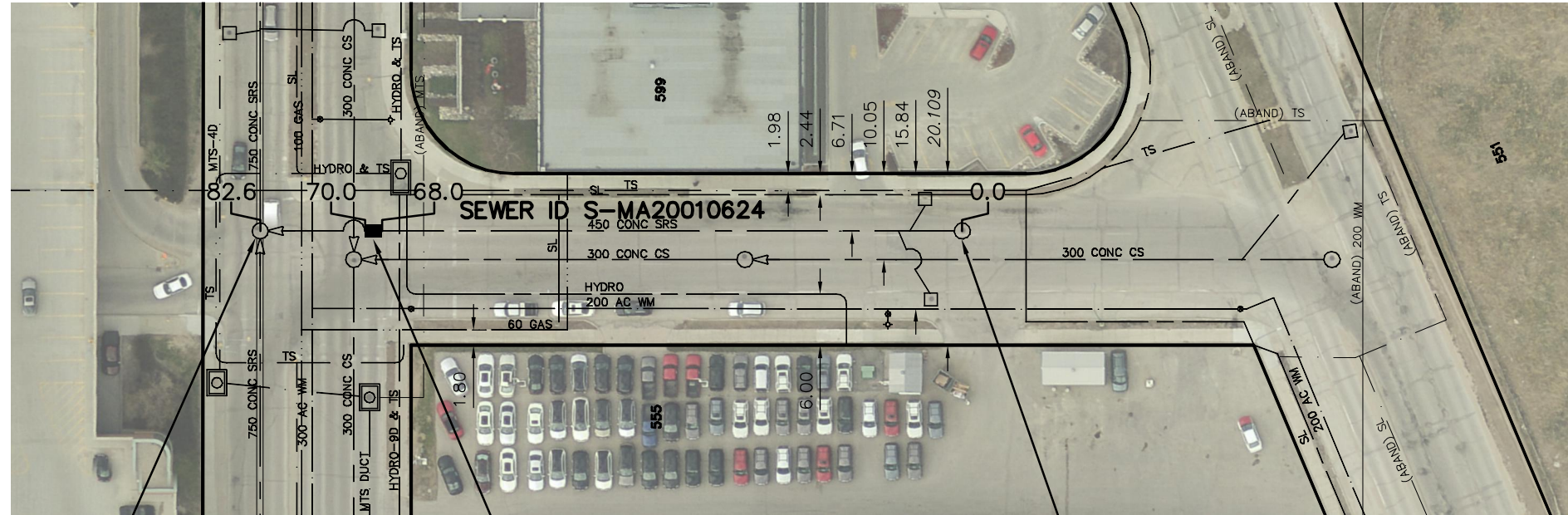

24.400
25.92
23.18
17.69
12.81
11.58
10.97
6.71
1.98

WESTWAY

25.253
28.30
11.36
2.28



SEWER JUNCTION INFORMATION FROM SEWER VIDEO INSPECTION
SEWER ID S-MA20010624

DISTANCE FROM MH ID S-MH20009740		
DISTANCE	DIAMETER	CLOCK
5.6	200	3
7.1	150	9
7.1	150	3
12.8	200	3
16.4	200	9
33.8	200	9
43.7	200	9
49.2	200	3

S-MH20009702
RIM 233.26
INV N 231.15
INV E 231.23
INV S 231.15

2.0 OF 450 SDR35 PVC
SEWER REPAIR (SD-022A).
RE-ROUTE CONDUIT ABOVE
SEWER.

S-MH20009740
RIM 233.18
INV W 231.82

6.71
10.98
11.58
12.81
17.69
19.52
23.03
24.395

EMPRESS ST

EMPRESS ST E

2.13
4.05
4.27
10.97
24.389

WARNING

IF POWER EQUIPMENT OR EXPLOSIVES ARE TO BE USED FOR EXCAVATION ON THIS PROJECT THE CONTRACTOR MUST:

- 1) NOTIFY THE GAS COMPANY OF THE PROPOSED LOCATION OF EXCAVATION.
- 2) TAKE PRECAUTION TO AVOID DAMAGE TO GAS COMPANY INSTALLATIONS.

SEE PROVINCIAL REGULATION 210/72 FOR DETAILS

METRIC

WHOLE NUMBERS INDICATE MILLIMETRES
DECIMALIZED NUMBERS INDICATE METRES



LOCATION APPROVED
UNDERGROUND STRUCTURES

B.M.
ELEV.

CONSTRUCTION COMPLETION DATE: YYYY MM DD

NO.	REVISIONS	DATE	BY

DESIGNED BY TS	CHECKED BY SC
DRAWN BY MA	APPROVED BY KZ
SCALE: HORIZONTAL 1:750 VERTICAL	RELEASED FOR CONSTRUCTION
DATE 2014 12 16	DATE
PLOT DATE: 2014 12 16	

ENGINEER'S SEAL

ORIGINAL
SIGNED BY
S.R.J.
COURNOYER
14/12/12

CONSULTANT DRAWING NUMBER

DATE



THE CITY OF WINNIPEG
WATER AND WASTE DEPARTMENT
ENGINEERING DIVISION

2014 SEWER RENEWALS
AND REPAIRS
WESTWAY
1ST MH WEST OF EMPRESS STREET EAST TO
MH @ EMPRESS STREET

SHEET 28 OF 30

CITY DRAWING NUMBER

10955

SUPV. U/G STRUCTURES COMMITTEE DATE

NOTE:
LOCATION OF UNDERGROUND STRUCTURES AS SHOWN ARE BASED ON THE BEST INFORMATION AVAILABLE BUT NO GUARANTEE IS GIVEN THAT ALL EXISTING UTILITIES ARE SHOWN OR THAT THE GIVEN LOCATIONS ARE EXACT. CONFIRMATION OF EXISTENCE AND EXACT LOCATION OF ALL SERVICES MUST BE OBTAINED FROM THE INDIVIDUAL UTILITIES BEFORE PROCEEDING WITH CONSTRUCTION.