

DUGALD ROAD

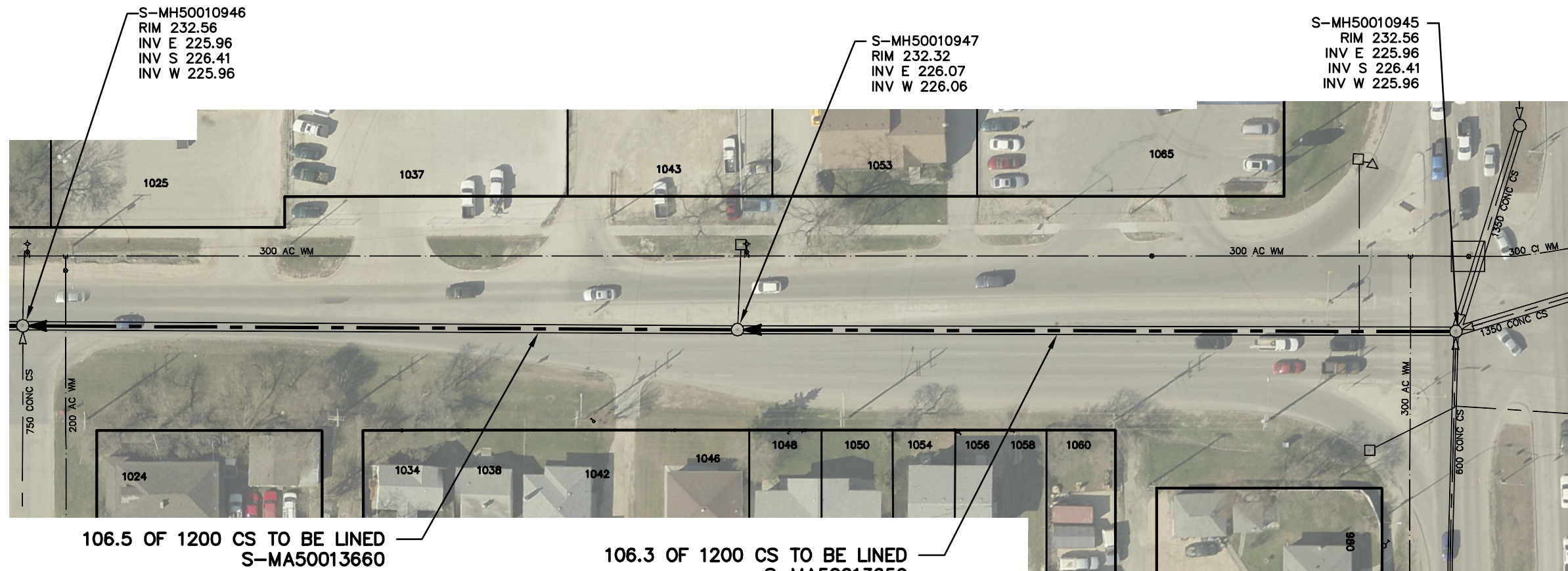

106.5 OF 1200 CS TO BE LINED
S-MA50013660

106.3 OF 1200 CS TO BE LINED
S-MA50013659

SEWER JUNCTION INFORMATION FROM SEWER VIDEO INSPECTION SEWER ID S-MA50013660		
DISTANCE FROM MH ID S-MH50010947		
DISTANCE	DIAMETER	CLOCK
0.3	100	1
4.7	100	10
7.6	100	2
7.6	50	11
12.9	100	2
23.3	100	10
24.7	100	11
42.0	100	10
42.5	100	2
49.9	100	10
87.7	100	10
96.5	100	2

SEWER JUNCTION INFORMATION FROM SEWER VIDEO INSPECTION SEWER ID S-MA50013659		
DISTANCE FROM MH ID S-MH50010945		
DISTANCE	DIAMETER	CLOCK
.10	100	1
14.9	100	2
34.5	100	12
40.2	100	2
57.5	100	12
73.8	100	12
78.0	100	2
82.5	100	10
86.0	100	2
94.8	100	2
99.2	100	1

WARNING

IF POWER EQUIPMENT OR EXPLOSIVES ARE TO BE USED FOR EXCAVATION ON THIS PROJECT THE CONTRACTOR MUST:

- 1) NOTIFY THE GAS COMPANY OF THE PROPOSED LOCATION OF EXCAVATION.
- 2) TAKE PRECAUTION TO AVOID DAMAGE TO GAS COMPANY INSTALLATIONS.

SEE PROVINCIAL REGULATION 210/72 FOR DETAILS

METRIC

WHOLE NUMBERS INDICATE MILLIMETRES
DECIMALIZED NUMBERS INDICATE METRES



LOCATION APPROVED
UNDERGROUND STRUCTURES

SUPV. U/G STRUCTURES COMMITTEE DATE

NOTE:

LOCATION OF UNDERGROUND STRUCTURES AS SHOWN ARE BASED ON THE BEST INFORMATION AVAILABLE BUT NO GUARANTEE IS GIVEN THAT ALL EXISTING UTILITIES ARE SHOWN OR THAT THE GIVEN LOCATIONS ARE EXACT. CONFIRMATION OF EXISTENCE AND EXACT LOCATION OF ALL SERVICES MUST BE OBTAINED FROM THE INDIVIDUAL UTILITIES BEFORE PROCEEDING WITH CONSTRUCTION.

B.M.
ELEV.

NO.	REVISIONS	DATE	BY

DESIGNED BY	SC	CHECKED BY	SC
DRAWN BY	RS	APPROVED BY	KZ
SCALE:	1: 750	RELEASED FOR CONSTRUCTION	
HORIZONTAL			
VERTICAL			
DATE	2014 12 17	DATE	

ENGINEER'S SEAL

ORIGINAL
SIGNED BY
S.R.J.
COURNOYER
14/12/17

CONSULTANT DRAWING NUMBER

BID OPPORTUNITY: 1071-2014
CONTRACT NUMBER: 13



THE CITY OF WINNIPEG
WATER AND WASTE DEPARTMENT
ENGINEERING DIVISION

2014 SEWER RENEWALS
BY CIPP LINING - CONTRACT NO.13
DUGALD ROAD
MH AT HOLDEN STREET TO
MH AT LAGIMODIERE BOULEVARD (R)

SHEET 12 OF 22

CITY DRAWING NUMBER

10890

FILE PATH: R:\DRAWINGS\SEWER\2014 RENEWALS\EPR AND TPR\Contract 13 (CONTRACT 3)\
FILE NAME: 10890.dwg

PLOT DATE: 2014 12 17