

**NOTES:**

1. SEE CONSULTANT DRAWING No. WB-E0512 MCC #1A & #1B SINGLE LINE DIAGRAM FOR 600V POWER DISTRIBUTION.
2. ALL 120V AND 208V LOADS ARE FED FROM LP-M11.
3. PROVIDE TRANSFORMER GROUNDING TO THE REQUIREMENT OF MANITOBA HYDRO. REFER TO DETAIL WB-E0456 FOR MINIMUM REQUIREMENT.
4. SEE CBD-M-4 FOR MISCELLANEOUS COMMUNICATION NET WORK WIRING BETWEEN SWITCHGEAR, MCC'S, AND LCP'S.
5. NEW MCC SECTIONS AND LCP-H10B SUPPLIED BY CITY. INSTALLATION BY CONTRACTOR.

6

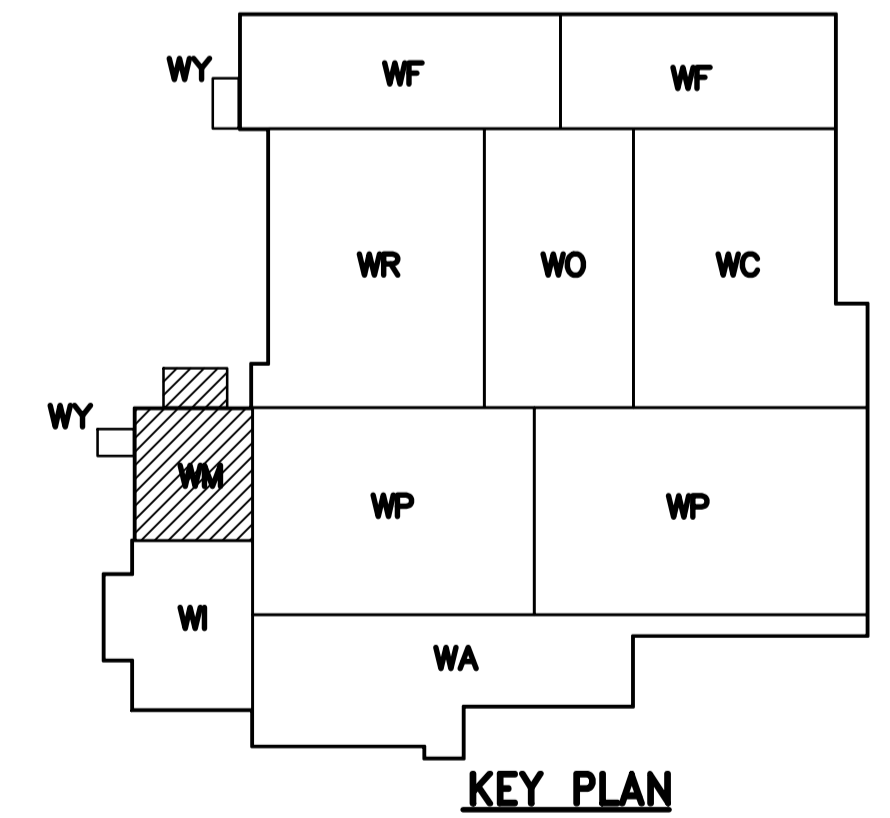

FIRST FLOOR PROCESS PLAN

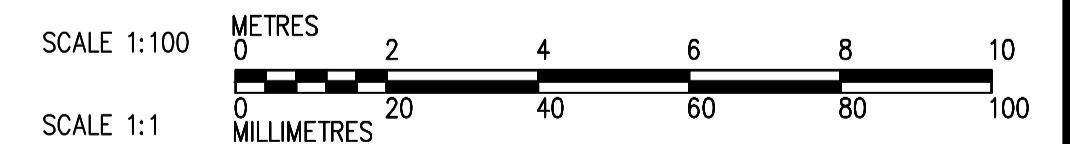

 Certificate of Authorization Dillon Consulting Limited (MB) No. 1789 Date: 2015-01-26	B.M. ELEV.	 EarthTech	ENGINEER'S SEAL  B. L. MOORE Jan 26/18 REGISTERED PROFESSIONAL ENGINEER	THE CITY OF WINNIPEG WATER AND WASTE DEPARTMENT ENGINEERING DIVISION	CITY FILE NUMBER																															
	<table border="1" style="width: 100%; border-collapse: collapse;"> <thead> <tr> <th>NO.</th> <th>REVISIONS</th> <th>DATE</th> <th>BY</th> </tr> </thead> <tbody> <tr> <td>06</td> <td>ISSUED FOR BID OP. 1068-2014</td> <td>15/01/23</td> <td>BLM</td> </tr> <tr> <td>05</td> <td>ISSUED FOR TENDER</td> <td>14/06/13</td> <td>BLM</td> </tr> <tr> <td>04</td> <td>AS CONSTRUCTED</td> <td>09/11/04</td> <td>ACL</td> </tr> <tr> <td>03</td> <td>ISSUED FOR CONSTRUCTION</td> <td>06/07/28</td> <td>LL</td> </tr> <tr> <td>02</td> <td>742-2005 ADDENDUM 4</td> <td>06/05/12</td> <td>LL</td> </tr> <tr> <td>01</td> <td>742-2005-ADDENDUM 3</td> <td>06/05/05</td> <td>LL</td> </tr> <tr> <td>00</td> <td>ISSUED FOR TENDER</td> <td>06/03/28</td> <td>LL</td> </tr> </tbody> </table>		NO.	REVISIONS	DATE	BY	06	ISSUED FOR BID OP. 1068-2014	15/01/23	BLM	05	ISSUED FOR TENDER	14/06/13	BLM	04	AS CONSTRUCTED	09/11/04	ACL	03	ISSUED FOR CONSTRUCTION	06/07/28	LL	02	742-2005 ADDENDUM 4	06/05/12	LL	01	742-2005-ADDENDUM 3	06/05/05	LL	00	ISSUED FOR TENDER	06/03/28	LL	DESIGNED BY: JT CHECKED BY: ND DRAWN BY: KJ APPROVED BY: SCALE: 1:100 RELEASED FOR CONSTRUCTION BY:	CONSULTANT DRAWING NO. WM-E0112
NO.	REVISIONS	DATE	BY																																	
06	ISSUED FOR BID OP. 1068-2014	15/01/23	BLM																																	
05	ISSUED FOR TENDER	14/06/13	BLM																																	
04	AS CONSTRUCTED	09/11/04	ACL																																	
03	ISSUED FOR CONSTRUCTION	06/07/28	LL																																	
02	742-2005 ADDENDUM 4	06/05/12	LL																																	
01	742-2005-ADDENDUM 3	06/05/05	LL																																	
00	ISSUED FOR TENDER	06/03/28	LL																																	
	ELECTRICAL ELECTRICAL ROOM AREA FIRST FLOOR PROCESS PLAN			CITY DRAWING NUMBER 1-0601M-ED019-001-06																																