

- CONSTRUCTION NOTES:**
- EACH CATCH BASIN (CB) AND CATCH PIT (CP) INSTALLED IN PAVEMENT TO HAVE AP-011 FRAME AND COVER.
 - EACH DITCH INLET CATCH BASIN TO HAVE A DITCH INLET GRATE AS PER DETAIL SHEET 52.
 - CONTRACTOR TO EXPOSE AND VERIFY INVERTS OF ALL JUNCTIONS OR CONNECTIONS TO MAINLINE LDS PRIOR TO INSTALLATION OF CATCH BASINS.
 - CLASS 3 BACKFILL TO BE USED WITHIN 1.0m OF PAVEMENT FOR ALL UNDERGROUND INSTALLATIONS.
 - EXISTING MANHOLES AND CATCH BASINS TO BE ADJUSTED TO DESIGN ELEVATION.
 - INSTALL 200mm CONCRETE TRANSITION SLABS C/W ASPHALT OVERLAY WHERE ASPHALT PAVEMENT MATCHES CONCRETE PAVEMENT.
 - ADD 200.00m TO ABBREVIATED ELEVATION TO OBTAIN GEODETIC ELEVATION.

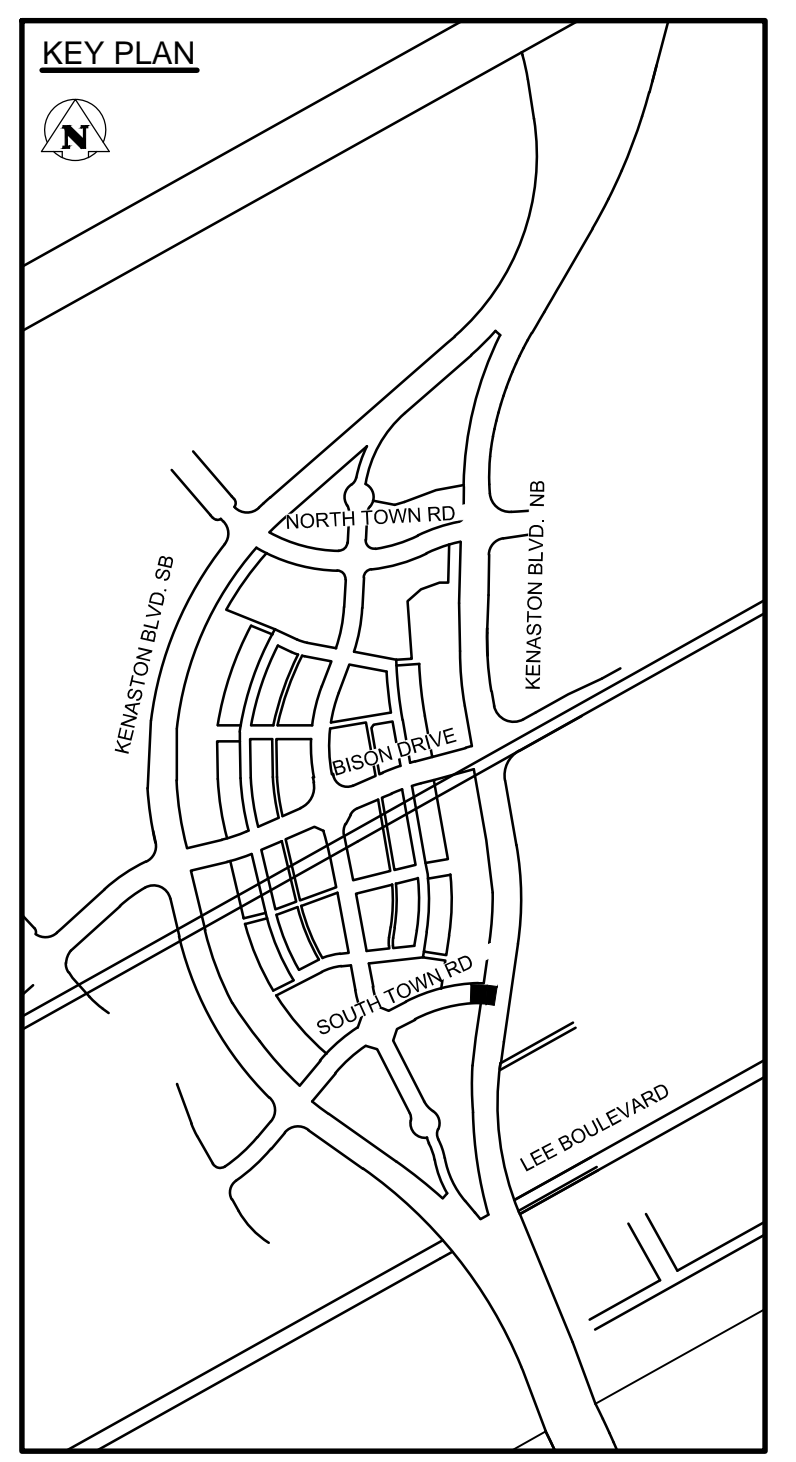
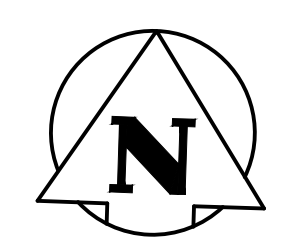
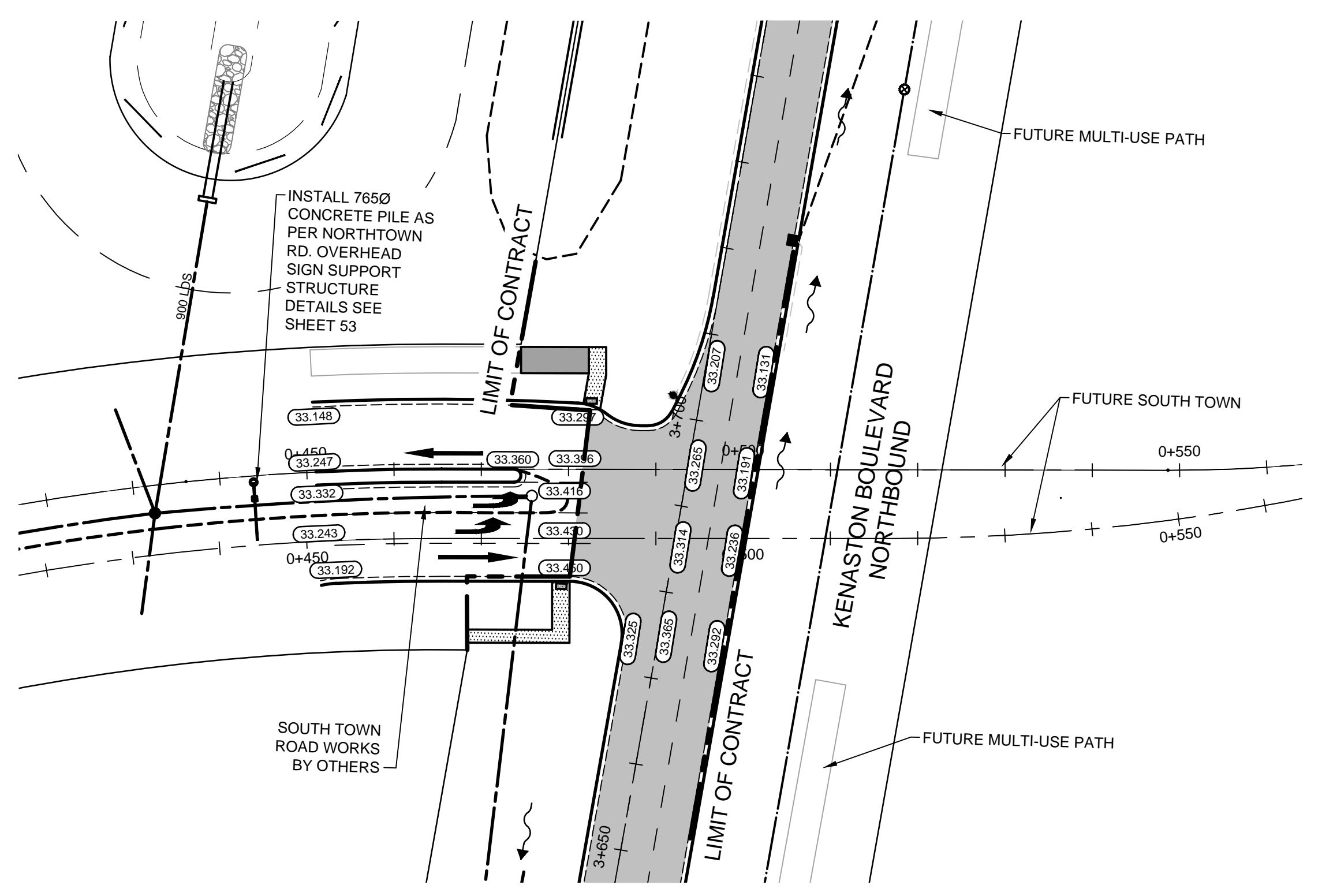

METRIC

WHOLE NUMBERS INDICATE MILLIMETRES
DECIMALIZED NUMBERS INDICATE METRES

WARNING

- IF POWER EQUIPMENT OR EXPLOSIVES ARE TO BE USED FOR EXCAVATION ON THIS PROJECT THE CONTRACTOR MUST:
- NOTIFY THE GAS COMPANY OF THE PROPOSED LOCATION OF EXCAVATION.
 - TAKE PRECAUTION TO AVOID DAMAGE TO GAS COMPANY INSTALLATIONS SEE PROVINCIAL REGULATION 210/72 FOR DETAILS.
 - OBTAIN EXCAVATION PERMITS PRIOR TO CONSTRUCTION.

84R635 - Lake Crest Rd. & Waverley St., Tbt on top of 0.05m dia. x 2.4m iron pipe, 14.2m N. of S.L. of Lake Crest Rd. & 0.6m E. of E.L. of Waverley St.

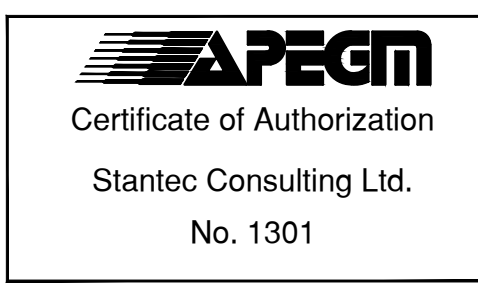

150 WM	WATERMAIN	150 WM	MTS	M.T.S.	MTS	150 mm W.M.	WATERMAIN	150 mm W.M.
+	HYDRANT VALVE	+	MTS	CONCRETE ASPHALT	MTS	+	HYDRANT VALVE	+
300 LDS	LAND DRAINAGE SEWER	300 LDS	MTS	PLANNING	300 mm L.D.S.	300	LAND DRAINAGE SEWER	300 mm L.D.S.
250 WWS	WASTE WATER SEWER	250 WWS	MTS	SIDEWALK	250 mm W.W.S.	250	WASTE WATER SEWER	250 mm W.W.S.
○	MANHOLE	●	MTS	PAVING STONES	---	---	MANHOLE	---
□	CATCH BASIN	■	MTS	PROPERTY LINE	---	---	NORTH/WEST GUTTER	---
⊕	TEST HOLES	⊕	MTS	SURVEY BAR	---	---	SOUTH/EAST GUTTER	---
⊖	CULVERT	⊖	MTS	CURB RAMP	---	---	NORTH/WEST T/LANE	---
100 GAS	GAS	100 GAS	MTS	DITCH	---	---	SOUTH/EAST T/LANE	---
HYDRO	HYDRO	HYDRO	MTS	SWALE	---	---		
EXISTING	LEGEND-PLAN	PROPOSED	EXISTING	LEGEND-PLAN	PROPOSED	EXISTING	LEGEND-PROFILE	PROPOSED

UNDERGROUND STRUCTURES

B.M. 76-030
ELEV. 232.457m

DESIGNED BY R.T.F., J.D.P.
DRAWN BY J.D.P.
CHECKED BY S.B.C.
APPROVED BY V.M.M.

DESIGN TEAM
Stantec

ENGINEER'S SEAL
PROVINCE OF MANITOBA
REGISTERED PROFESSIONAL ENGINEER
V.M. MAROTI
MEMBER 30809

THE CITY OF WINNIPEG
PUBLIC WORKS DEPARTMENT

WWARP PART 3 - CONTRACT 1
STA 2+922.4 TO STA 5+935

CITY DRAWING NUMBER P-3345-42
SHEET 42 OF 64
CONSULTANT DRAWING NUMBER C-235

KENASTON BOULEVARD EXTENSION - NB LANES
PAVING & GRADING - SOUTH TOWN RD
STA 0+480 TO STA 0+501.72

CONSULTANT PROJECT NUMBER 113705751

REVISIONS
NO. REVISIONS DATE BY DATE

1 ISSUED FOR TENDER 3/04/08 V.M.M.
1 ISSUED FOR REVIEW 3/03/27 V.M.M.
0 ISSUED FOR 90% REVIEW 13/02/22 V.M.M.

13/02/22

VA:1137\active\113705751\drawing\404_working\sheet_files_nb\05751_c-235-xx.dwg