

CONSTRUCTION NOTES:

- EACH CATCH BASIN (CB) AND CATCH PIT (CP) INSTALLED IN PAVEMENT TO HAVE AP-011 FRAME AND COVER.
- EACH DITCH INLET CATCH BASIN TO HAVE A DITCH INLET GRATE AS PER DETAIL SHEET 52.
- CONTRACTOR TO EXPOSE AND VERIFY INVERTS OF ALL JUNCTIONS OR CONNECTIONS TO MAINLINE LDS PRIOR TO INSTALLATION OF CATCH BASINS.
- CLASS 3 BACKFILL TO BE USED WITHIN 1.0m OF PAVEMENT FOR ALL UNDERGROUND INSTALLATIONS.
- EXISTING MANHOLES AND CATCH BASINS TO BE ADJUSTED TO DESIGN ELEVATION.
- INSTALL 200mm CONCRETE TRANSITION SLABS C/W ASPHALT OVERLAY WHERE ASPHALT PAVEMENT MATCHES CONCRETE PAVEMENT.
- ADD 200.00m TO ABBREVIATED ELEVATION TO OBTAIN GEODETIC ELEVATION.

CATCH BASIN, CATCH PIT, DITCH INLET & MANHOLES STRUCTURE AND LOCATION SCHEDULE							
TYPE	STATION	O/S FROM CONTROL	RIM ELEV	BOT. ELEV	LEAD INV	MAIN INV	PIPE LEAD
CP 32	4+467.741	11.503 R	232.282	231.382	N 231.382	-	2.0m - 250mm
CB 47	4+469.740	11.574 R	232.272	230.022	W 230.622	228.250	26.3m - 300mm/GR=9.01%
CP 33	4+471.766	11.724 R	232.277	231.377	S 231.377	-	2.0m - 250mm
CB 48	4+469.679	6.917 L	232.101	230.851	W 230.451	228.250	8.0m - 300mm/RISER 1.5m GR=8.76%

CP- SD-023, AP-011
DITCH CB - SD-025, DITCH INLET GRATE
ROAD CB - SD-024, AP-011
MH - SD-010, AP-004, AP-005

KENASTON BOULEVARD NORTHBOUND

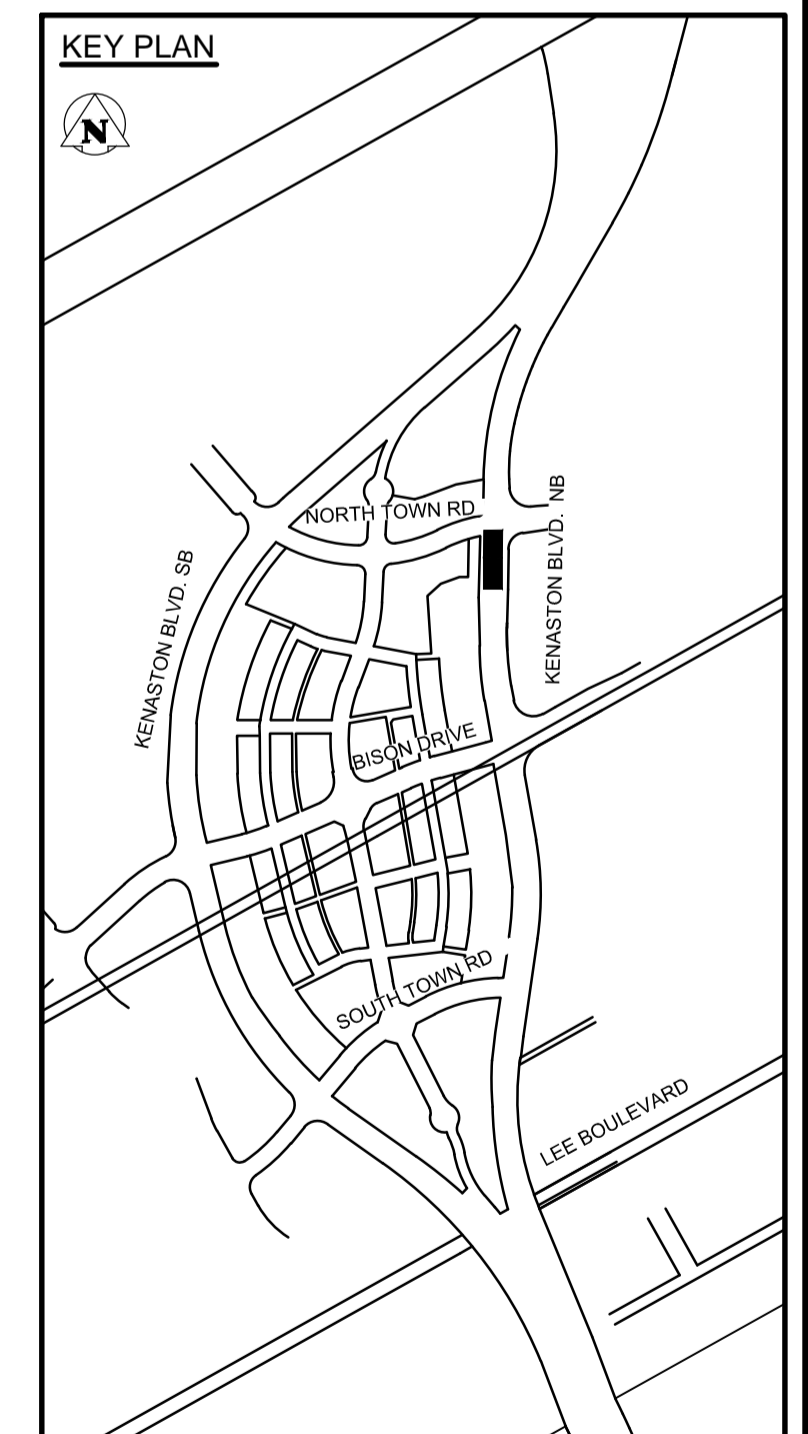
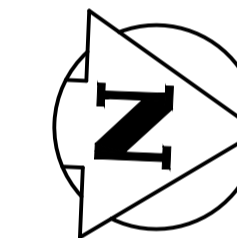
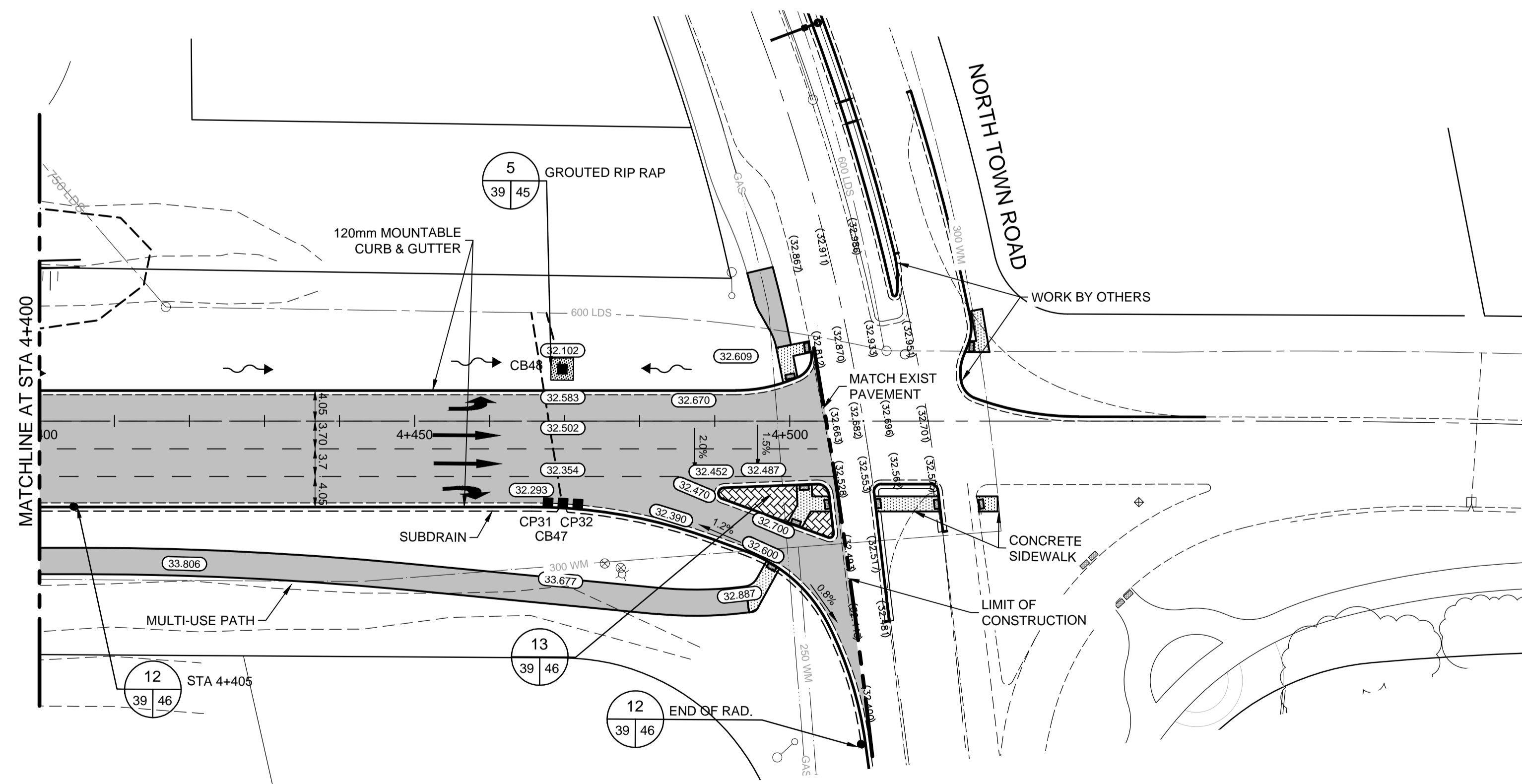

METRIC

WHOLE NUMBERS INDICATE MILLIMETRES
DECIMALIZED NUMBERS INDICATE METRES

WARNING

- IF POWER EQUIPMENT OR EXPLOSIVES ARE TO BE USED FOR EXCAVATION ON THIS PROJECT THE CONTRACTOR MUST:
- NOTIFY THE GAS COMPANY OF THE PROPOSED LOCATION OF EXCAVATION.
 - TAKE PRECAUTION TO AVOID DAMAGE TO GAS COMPANY INSTALLATIONS SEE PROVINCIAL REGULATION 210/72 FOR DETAILS.
 - OBTAIN EXCAVATION PERMITS PRIOR TO CONSTRUCTION.

84R635 - Lake Crest Rd. & Waverley St. Tblt on top of 0.05m dia. x 2.4m iron pipe, 14.2m N. of S.L. of Lake Crest Rd. & 0.6m E. of E.L. of Waverley St.



<table border="1"> <tr> <th>150 WM</th> <th>WATERMAIN</th> <th>150 WM</th> <th>M.T.S.</th> <th>M.T.S.</th> <th>150 mm W.M.</th> <th>WATERMAIN</th> <th>150 mm W.M.</th> </tr> <tr> <td></td> <td>HYDRANT VALVE</td> <td></td> <td>LAND DRAINAGE SEWER</td> <td></td> <td>CONCRETE ASPHALT</td> <td></td> <td>HYDRANT VALVE</td> </tr> <tr> <td></td> <td>WASTE WATER SEWER</td> <td></td> <td>MANHOLE</td> <td></td> <td>PAVING STONES</td> <td></td> <td>LAND DRAINAGE SEWER</td> </tr> <tr> <td></td> <td>CATCH BASIN</td> <td></td> <td>TEST HOLES</td> <td></td> <td>PROPERTY LINE</td> <td></td> <td>WASTE WATER SEWER</td> </tr> <tr> <td></td> <td>CULVERT</td> <td></td> <td>GAS</td> <td></td> <td>SURVEY BAR</td> <td></td> <td>NORTH/WEST GUTTER</td> </tr> <tr> <td></td> <td>HYDRO</td> <td></td> <td>GAS</td> <td></td> <td>CURB RAMP</td> <td></td> <td>NORTH/WEST T/LANE</td> </tr> <tr> <td></td> <td>EXISTING LEGEND-PLAN</td> <td></td> <td>PROPOSED LEGEND-PLAN</td> <td></td> <td>DITCH</td> <td></td> <td>SOUTH/EAST GUTTER</td> </tr> <tr> <td></td> <td>EXISTING LEGEND-PROFILE</td> <td></td> <td>PROPOSED LEGEND-PROFILE</td> <td></td> <td>SWALE</td> <td></td> <td>NORTH/WEST T/LANE</td> </tr> <tr> <td></td> <td>EXISTING LEGEND-PLAN</td> <td></td> <td>PROPOSED LEGEND-PLAN</td> <td></td> <td>SWALE</td> <td></td> <td>SOUTH/EAST T/LANE</td> </tr> <tr> <td></td> <td>EXISTING LEGEND-PROFILE</td> <td></td> <td>PROPOSED LEGEND-PROFILE</td> <td></td> <td>SWALE</td> <td></td> <td>SOUTH/EAST T/LANE</td> </tr> </table>	150 WM	WATERMAIN	150 WM	M.T.S.	M.T.S.	150 mm W.M.	WATERMAIN	150 mm W.M.		HYDRANT VALVE		LAND DRAINAGE SEWER		CONCRETE ASPHALT		HYDRANT VALVE		WASTE WATER SEWER		MANHOLE		PAVING STONES		LAND DRAINAGE SEWER		CATCH BASIN		TEST HOLES		PROPERTY LINE		WASTE WATER SEWER		CULVERT		GAS		SURVEY BAR		NORTH/WEST GUTTER		HYDRO		GAS		CURB RAMP		NORTH/WEST T/LANE		EXISTING LEGEND-PLAN		PROPOSED LEGEND-PLAN		DITCH		SOUTH/EAST GUTTER		EXISTING LEGEND-PROFILE		PROPOSED LEGEND-PROFILE		SWALE		NORTH/WEST T/LANE		EXISTING LEGEND-PLAN		PROPOSED LEGEND-PLAN		SWALE		SOUTH/EAST T/LANE		EXISTING LEGEND-PROFILE		PROPOSED LEGEND-PROFILE		SWALE		SOUTH/EAST T/LANE	<p>UNDERGROUND STRUCTURES</p> <p>SUPV. U/G STRUCTURES COMMITTEE DATE</p> <p>NOTE: LOCATION OF UNDERGROUND STRUCTURES AS SHOWN ARE BASED ON THE BEST INFORMATION AVAILABLE, BUT NO GUARANTEE IS GIVEN THAT ALL EXISTING UTILITIES ARE SHOWN OR THAT THE GIVEN LOCATIONS ARE EXACT. CONFIRMATION OF EXISTENCE AND EXACT LOCATION OF ALL SERVICES MUST BE OBTAINED FROM THE INDIVIDUAL UTILITIES BEFORE PROCEEDING WITH CONSTRUCTION.</p>	<p>B.M. 76-030 ELEV. 232.457m</p> <p>DESIGNED BY R.T.F., J.D.P.</p> <p>DRAWN BY J.D.P.</p> <p>CHECKED BY S.B.C.</p> <p>APPROVED BY V.M.M.</p> <p>DESIGN TEAM</p> <p>ENGINEER'S SEAL</p> <p>PROVINCE OF MANITOBA REGISTERED PROFESSIONAL ENGINEER</p> <p>V.M. MAROTI MEMBER 30809</p> <p>CONSULTANT PROJECT NUMBER 113705751</p>	<p>THE CITY OF WINNIPEG PUBLIC WORKS DEPARTMENT</p> <p>WWARP PART 3 - CONTRACT 1 STA 2+922.4 TO STA 5+935</p> <p>KENASTON BOULEVARD EXTENSION - NB LANES PAVING & GRADING - KENASTON BLVD. NB STA 4+400 TO STA 4+506</p> <p>CITY DRAWING NUMBER P-3345-39</p> <p>SHEET 39 OF 64</p> <p>CONSULTANT DRAWING NUMBER C-228</p>
150 WM	WATERMAIN	150 WM	M.T.S.	M.T.S.	150 mm W.M.	WATERMAIN	150 mm W.M.																																																																												
	HYDRANT VALVE		LAND DRAINAGE SEWER		CONCRETE ASPHALT		HYDRANT VALVE																																																																												
	WASTE WATER SEWER		MANHOLE		PAVING STONES		LAND DRAINAGE SEWER																																																																												
	CATCH BASIN		TEST HOLES		PROPERTY LINE		WASTE WATER SEWER																																																																												
	CULVERT		GAS		SURVEY BAR		NORTH/WEST GUTTER																																																																												
	HYDRO		GAS		CURB RAMP		NORTH/WEST T/LANE																																																																												
	EXISTING LEGEND-PLAN		PROPOSED LEGEND-PLAN		DITCH		SOUTH/EAST GUTTER																																																																												
	EXISTING LEGEND-PROFILE		PROPOSED LEGEND-PROFILE		SWALE		NORTH/WEST T/LANE																																																																												
	EXISTING LEGEND-PLAN		PROPOSED LEGEND-PLAN		SWALE		SOUTH/EAST T/LANE																																																																												
	EXISTING LEGEND-PROFILE		PROPOSED LEGEND-PROFILE		SWALE		SOUTH/EAST T/LANE																																																																												
<p>2 ISSUED FOR TENDER 3/04/08 V.M.M.</p> <p>1 ISSUED FOR REVIEW 3/03/27 V.M.M.</p> <p>0 ISSUED FOR 90% REVIEW 13/02/22 V.M.M.</p>		<p>HOR. SCALE 1:500</p> <p>VERTICAL 1:20</p> <p>RELEASED FOR CONSTRUCTION</p> <p>DATE 13/02/22</p>																																																																																	

VA 1137 (revise) 113705751.dwg (drawing) sheet_files (0575) c-221-xxx.dwg