

- CONSTRUCTION NOTES:**
- EACH CATCH BASIN (CB) AND CATCH PIT (CP) INSTALLED IN PAVEMENT TO HAVE AP-011 FRAME AND COVER.
 - EACH DITCH INLET CATCH BASIN TO HAVE A DITCH INLET GRATE AS PER DETAIL SHEET 62.
 - CONTRACTOR TO EXPOSE AND VERIFY INVERTS OF ALL JUNCTIONS OR CONNECTIONS TO MAINLINE LDS PRIOR TO INSTALLATION OF CATCH BASINS.
 - CLASS 3 BACKFILL TO BE USED WITHIN 1.0m OF PAVEMENT FOR ALL UNDERGROUND INSTALLATIONS.
 - EXISTING MANHOLES AND CATCH BASINS TO BE ADJUSTED TO DESIGN ELEVATION.
 - INSTALL 200mm CONCRETE TRANSITION SLABS C/W ASPHALT OVERLAY WHERE ASPHALT PAVEMENT MATCHES CONCRETE PAVEMENT.
 - ADD 200.00m TO ABBREVIATED ELEVATION TO OBTAIN GEODETIC ELEVATION.

CATCH BASIN, CATCH PIT, DITCH INLET & MANHOLES STRUCTURE AND LOCATION SCHEDULE						
TYPE	STATION	O/S FROM CONTROL	RIM ELEV	BOT. ELEV	LEAD INV	PIPE LEAD
CP 28	3+914.245	3.187 L	232.521	231.621	N 231.621	-
CB 42	3+916.253	3.916 L	232.506	230.256	W 230.856	7.3m - 300mm/GR=16.00%
CP 29	3+918.260	3.515 L	232.521	231.621	S 231.621	-
CB 43	3+910.687	10.896 R	232.344	230.094	W 230.694	-
CB 44	3+916.285	6.861 R	232.126	229.876	S 230.476	229.572
						6.4m - 300mm/GR=14.12%

CP - SD-023, AP-011
 DITCH CB - SD-025, DITCH INLET GRATE

ROAD CB - SD-024, AP-011
 MH - SD-010, AP-004, AP-005

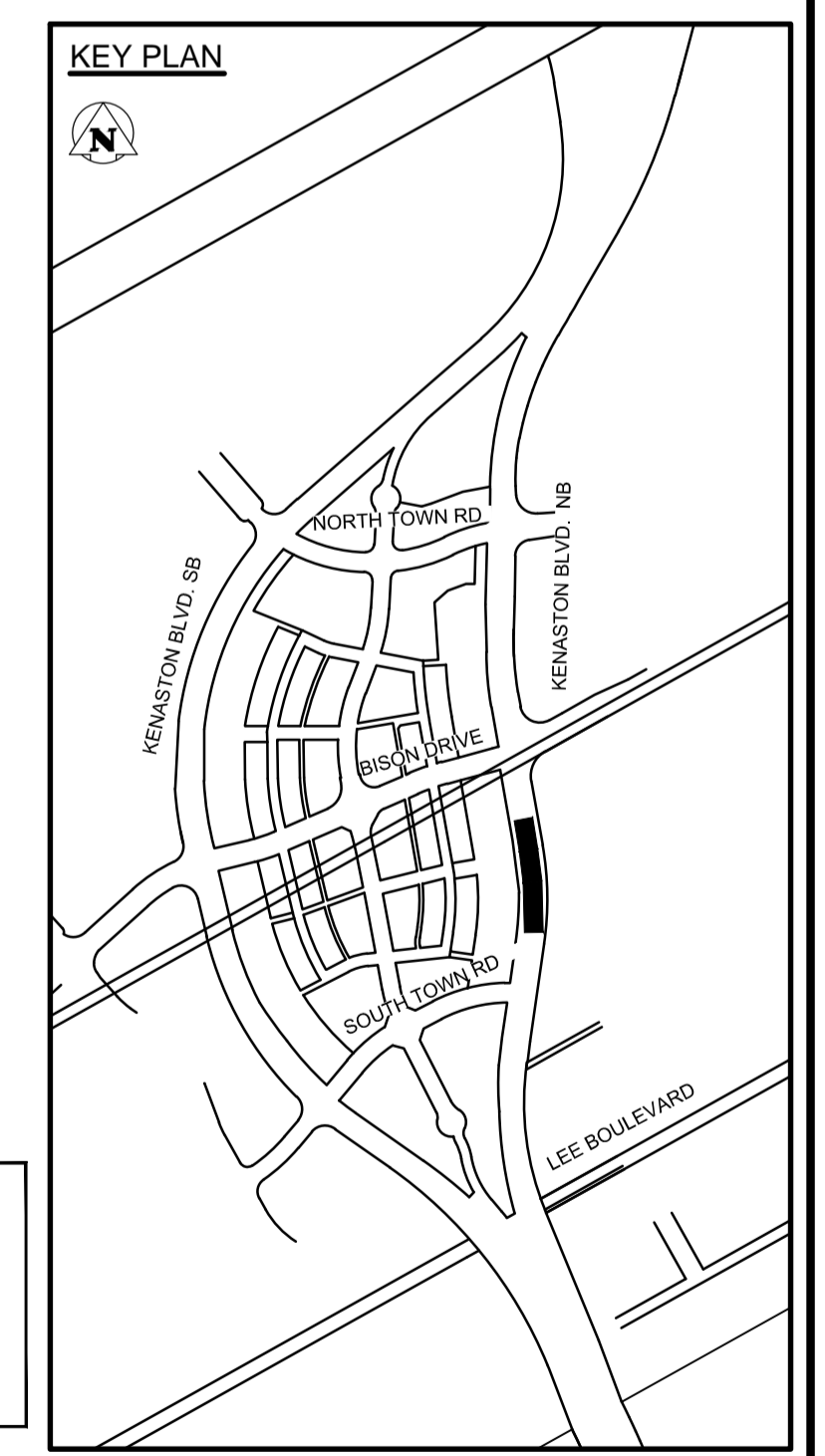
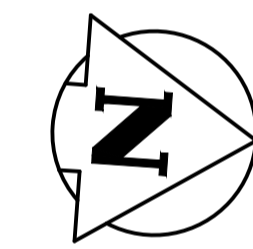
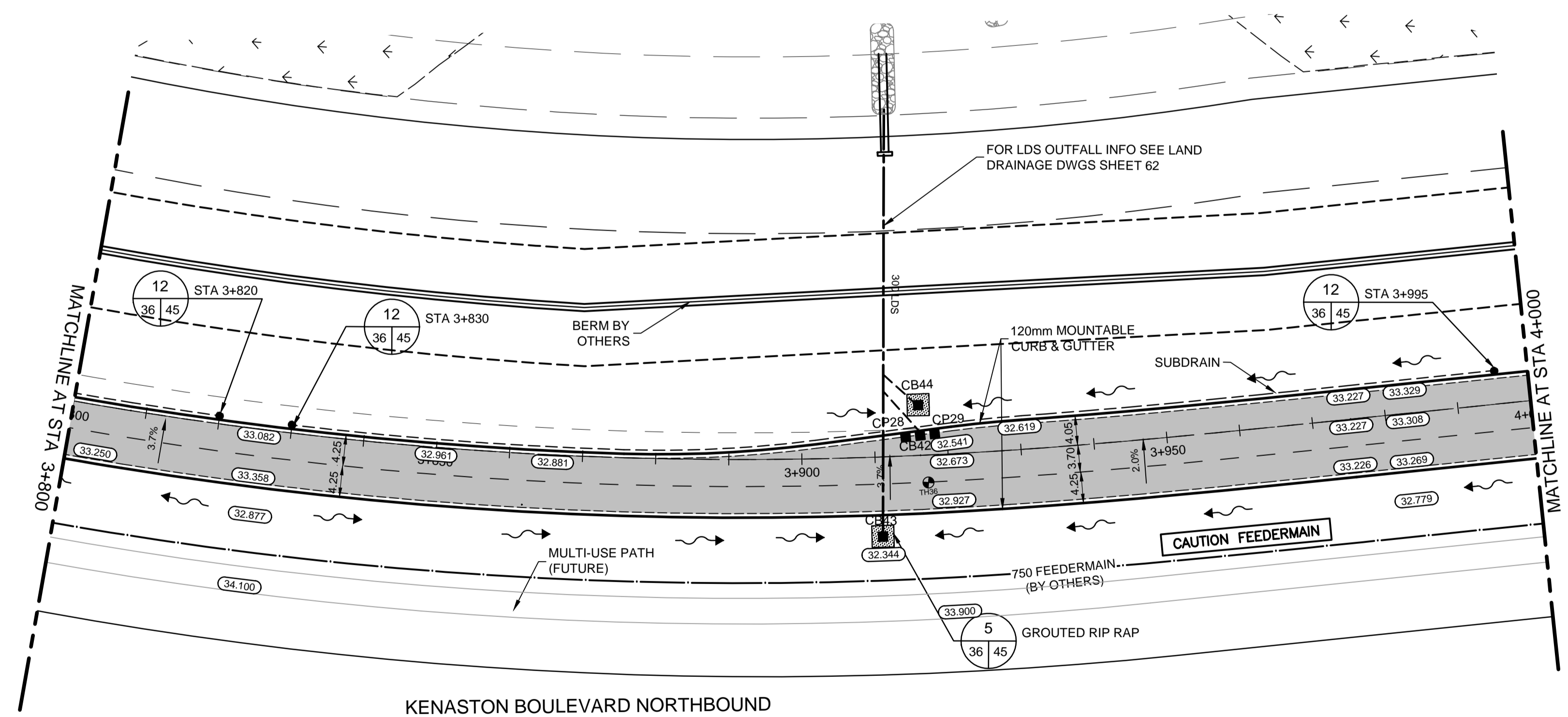

METRIC

WHOLE NUMBERS INDICATE MILLIMETRES
 DECIMALIZED NUMBERS INDICATE METRES

WARNING

- IF POWER EQUIPMENT OR EXPLOSIVES ARE TO BE USED FOR EXCAVATION ON THIS PROJECT THE CONTRACTOR MUST:
- NOTIFY THE GAS COMPANY OF THE PROPOSED LOCATION OF EXCAVATION.
 - TAKE PRECAUTION TO AVOID DAMAGE TO GAS COMPANY INSTALLATIONS SEE PROVINCIAL REGULATION 210/72 FOR DETAILS.
 - OBTAIN EXCAVATION PERMITS PRIOR TO CONSTRUCTION.

KENASTON BOULEVARD NORTHBOUND

84R635 - Lake Crest Rd. & Waverley St., Tblt on top of 0.05m dia. x 2.4m iron pipe, 14.2m N. of S.L. of Lake Crest Rd. & 0.6m E. of E.L. of Waverley St.

150 WM	150 WM	MTS	M.T.S.	MTS	150 mm W.M.	150 mm W.M.	150 mm W.M.
HYDRANT VALVE	HYDRANT VALVE		CONCRETE ASPHALT		HYDRANT VALVE		HYDRANT VALVE
300 LDS LAND DRAINAGE SEWER	300 LDS LAND DRAINAGE SEWER		PLANNING SIDEWALK		300 mm L.D.S. LAND DRAINAGE SEWER		300 mm L.D.S. LAND DRAINAGE SEWER
250 WWS WASTE WATER SEWER	250 WWS WASTE WATER SEWER		PAVING STONES		250 mm W.W.S. WASTE WATER SEWER		250 mm W.W.S. WASTE WATER SEWER
MANHOLE	MANHOLE		PROPERTY LINE		Q PROFILE		Q PROFILE
CATCH BASIN	CATCH BASIN		SURVEY BAR		NORTH/WEST GUTTER		NORTH/WEST T/LANE
TEST HOLES	TEST HOLES		CURB RAMP		SOUTH/EAST GUTTER		SOUTH/EAST T/LANE
CULVERT	CULVERT		DITCH				
100 GAS	100 GAS		SWALE				
HYDRO	HYDRO						
EXISTING	LEGEND-PLAN	PROPOSED	EXISTING	LEGEND-PLAN	PROPOSED	EXISTING	LEGEND-PROFILE

UNDERGROUND STRUCTURES

SUPV. U/G STRUCTURES COMMITTEE DATE

NOTE:
 LOCATION OF UNDERGROUND STRUCTURES AS SHOWN ARE BASED ON THE BEST INFORMATION AVAILABLE, BUT NO GUARANTEE IS GIVEN THAT ALL EXISTING UTILITIES ARE SHOWN OR THAT THE GIVEN LOCATIONS ARE EXACT. CONFIRMATION OF EXISTENCE AND EXACT LOCATION OF ALL SERVICES MUST BE OBTAINED FROM THE INDIVIDUAL UTILITIES BEFORE PROCEEDING WITH CONSTRUCTION.

B.M.	ELEV.	DATE	BY
76-030	232.457m		
1	ISSUED FOR TENDER	3/04/08	V.M.M.
1	ISSUED FOR REVIEW	3/03/27	V.M.M.
0	ISSUED FOR 90% REVIEW	13/02/22	V.M.M.
NO.	REVISIONS	DATE	BY

DESIGNED BY: R.T.F., J.D.P.
 DRAWN BY: J.D.P.
 CHECKED BY: S.B.C.
 APPROVED BY: V.M.M.

DESIGN TEAM

RELEASED FOR CONSTRUCTION

DATE: 13/02/22

ENGINEER'S SEAL

CONSULTANT PROJECT NUMBER: 113705751

THE CITY OF WINNIPEG PUBLIC WORKS DEPARTMENT

WWARP PART 3 - CONTRACT 1
 STA 2+922.4 TO STA 5+935

KENASTON BOULEVARD EXTENSION - NB LANES
 PAVING & GRADING - KENASTON BLVD. NB
 STA 3+800 TO STA 4+000

CITY DRAWING NUMBER: P-3345-36
 SHEET: 36 OF 64
 CONSULTANT DRAWING NUMBER: C-225

VA 1137 (rev 05/15) drawing 404_woridng sheet_files\05751 c-221-xxx.dwg