

- CONSTRUCTION NOTES:**
- EACH CATCH BASIN (CB) AND CATCH PIT (CP) INSTALLED IN PAVEMENT TO HAVE AP-011 FRAME AND COVER.
 - EACH DITCH INLET CATCH BASIN TO HAVE A DITCH INLET GRATE AS PER DETAIL SHEET 45.
 - CONTRACTOR TO EXPOSE AND VERIFY INVERTS OF ALL JUNCTIONS OR CONNECTIONS TO MAINLINE LDS PRIOR TO INSTALLATION OF CATCH BASINS.
 - CLASS 3 BACKFILL TO BE USED WITHIN 1.0m OF PAVEMENT FOR ALL UNDERGROUND INSTALLATIONS.
 - EXISTING MANHOLES AND CATCH BASINS TO BE ADJUSTED TO DESIGN ELEVATION.
 - 200mm CONCRETE TRANSITION SLABS C/W ASPHALT OVERLAY TO BE INSTALLED WHERE ASPHALT PAVEMENT MATCHES CONCRETE PAVEMENT.
 - ADD 200.00m TO ABBREVIATED ELEVATION TO OBTAIN GEODETIC ELEVATION.

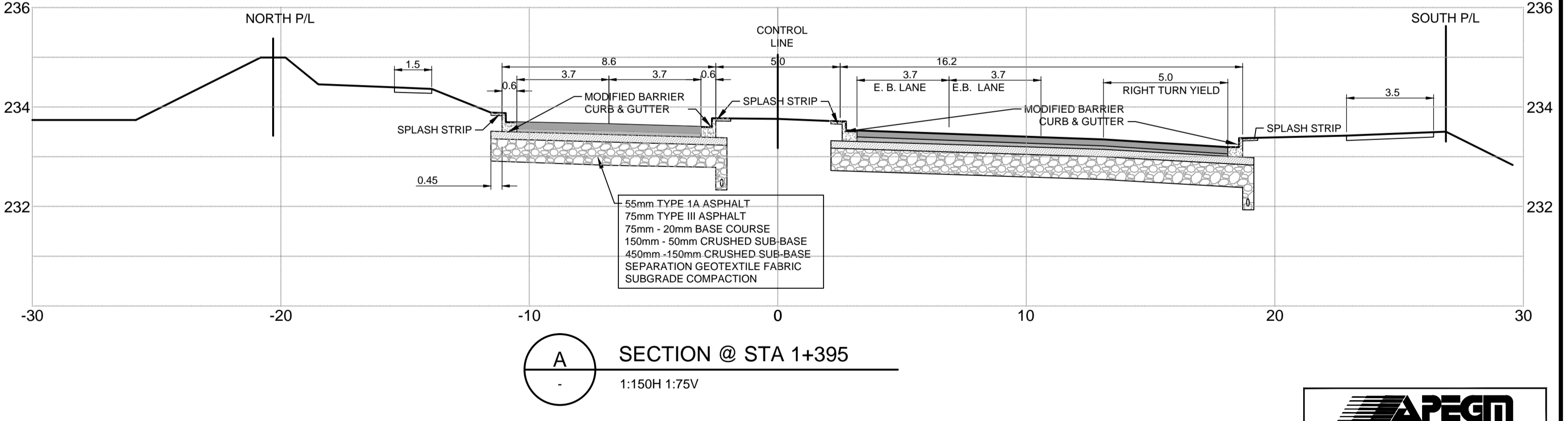
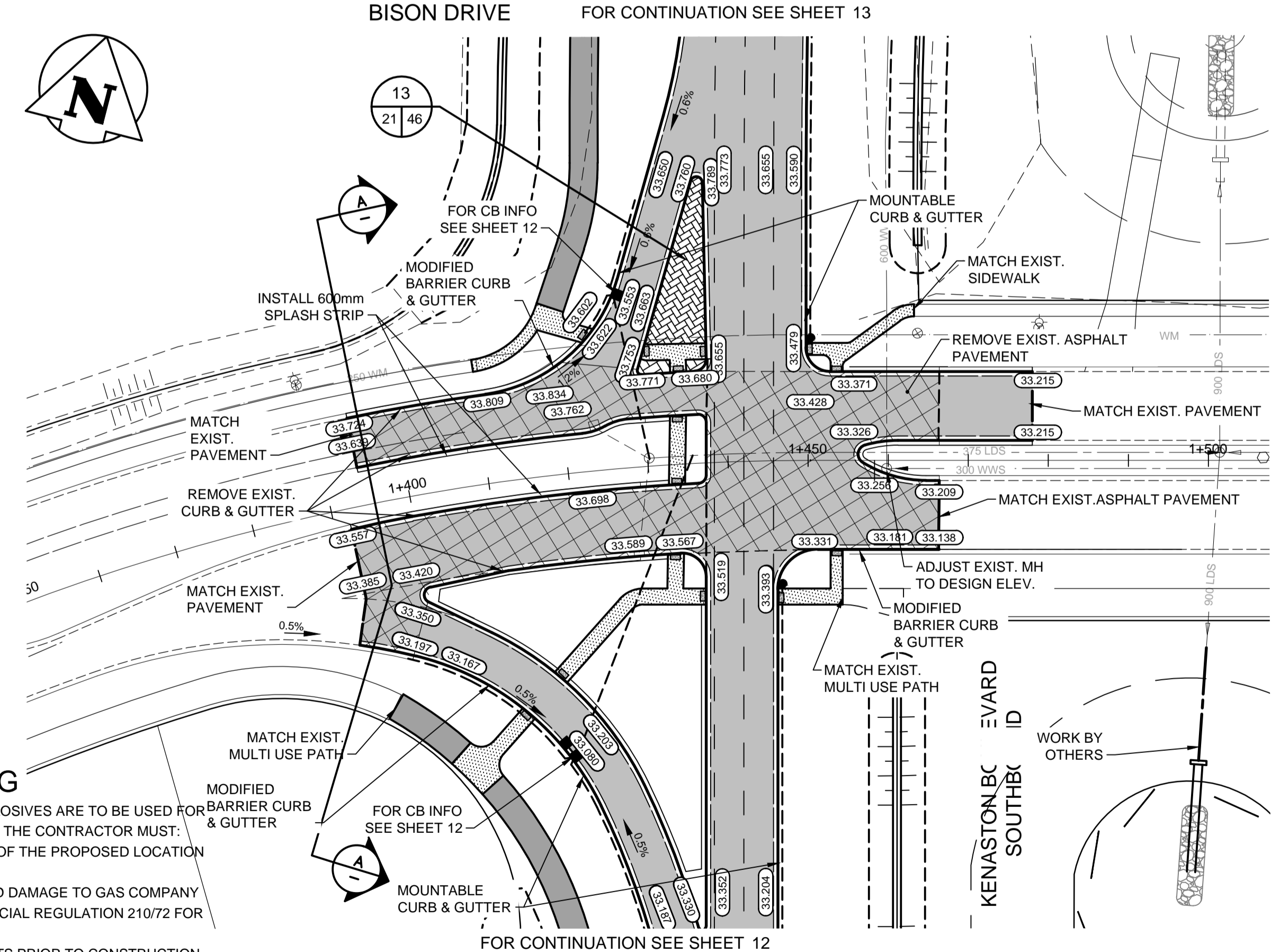
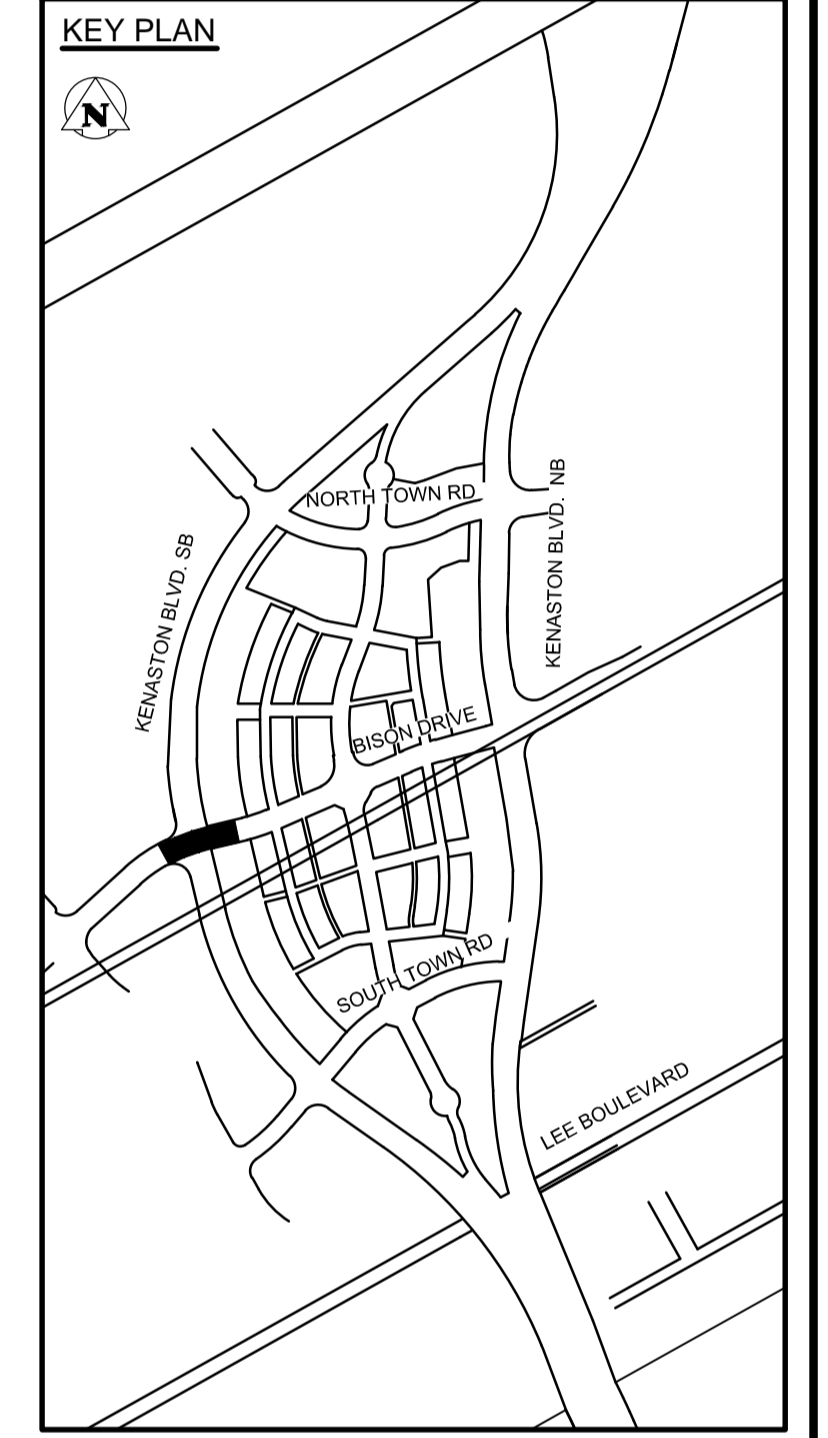

84R635 - Lake Crest Rd. & Waverley St., Tilt on top of 0.05m dia. x 2.4m iron pipe, 14.2m N. of S.L. of Lake Crest Rd. & 0.6m E. of E.L. of Waverley St.

WHOLE NUMBERS INDICATE MILLIMETRES
DECIMALIZED NUMBERS INDICATE METRES

METRIC

SECTION @ STA 1+395
1:150H 1:75V



WARNING
IF POWER EQUIPMENT OR EXPLOSIVES ARE TO BE USED FOR EXCAVATION ON THIS PROJECT THE CONTRACTOR MUST:
1. NOTIFY THE GAS COMPANY OF THE PROPOSED LOCATION OF EXCAVATION.
2. TAKE PRECAUTION TO AVOID DAMAGE TO GAS COMPANY INSTALLATIONS SEE PROVINCIAL REGULATION 210/72 FOR DETAILS
3. OBTAIN EXCAVATION PERMITS PRIOR TO CONSTRUCTION.

150 WM	WATERMAIN	150 WM	M.T.S.	M.T.S.	150 mm W.M.	WATERMAIN	150 mm W.M.
	HYDRANT VALVE			CONCRETE ASPHALT PLANING SIDEWALK		HYDRANT VALVE	
	LAND DRAINAGE SEWER			PAVING STONES		LAND DRAINAGE SEWER	
	WASTE WATER SEWER			PROPERTY LINE		WASTE WATER SEWER	
	MANHOLE			SURVEY BAR		MANHOLE	
	CATCH BASIN			CURB RAMP		CATCH BASIN	
	TEST HOLES			DITCH		TEST HOLES	
	CULVERT			SWALE		CULVERT	
	GAS					GAS	
	HYDRO					HYDRO	
	EXISTING		PROPOSED			EXISTING	

UNDERGROUND STRUCTURES
SUPV. U/G STRUCTURES COMMITTEE DATE
NOTE:
LOCATION OF UNDERGROUND STRUCTURES AS SHOWN ARE BASED ON THE BEST INFORMATION AVAILABLE, BUT NO GUARANTEE IS GIVEN THAT ALL EXISTING UTILITIES ARE SHOWN OR THAT THE GIVEN LOCATIONS ARE EXACT. CONFIRMATION OF EXISTENCE AND EXACT LOCATION OF ALL SERVICES MUST BE OBTAINED FROM THE INDIVIDUAL UTILITIES BEFORE PROCEEDING WITH CONSTRUCTION.

B.M.	76-030	ELEV.	232.457m
DESIGNED BY	V.M.M., T.G.		
DRAWN BY	T.G.		
CHECKED BY	S.B.C.		
APPROVED BY	V.M.M.		
HOR. SCALE	1:500		
VERTICAL	1:20		
RELEASER FOR CONSTRUCTION	DATE		
CONSULTANT PROJECT NUMBER	113705751		
NO.	REVISIONS	DATE	BY
2	ISSUED FOR TENDER	3/04/08	V.M.M.
1	ISSUED FOR REVIEW	3/03/27	V.M.M.
0	ISSUED FOR 90% REVIEW	13/02/22	V.M.M.
NO.	REVISIONS	DATE	BY
		12/11/14	

DESIGN TEAM

ENGINEER'S SEAL

CONSULTANT PROJECT NUMBER: 113705751

THE CITY OF WINNIPEG
PUBLIC WORKS DEPARTMENT

WWARP PART 3 - CONTRACT 1
STA 2+922.4 TO STA 5+935

KENASTON BOULEVARD EXTENSION - SB LANES
PAVING & GRADING - BISON DRIVE
STA 1+350 TO STA 1+425

CITY DRAWING NUMBER: P-3345-21
SHEET: 21 OF 64
CONSULTANT DRAWING NUMBER: C-214

VA:113705751.drawing\404_working\sheet_files\05751c-213-xxx.dwg