

- CONSTRUCTION NOTES:**
1. EACH CATCH BASIN (CB) AND CATCH PIT (CP) INSTALLED IN PAVEMENT TO HAVE AP-011 FRAME AND COVER.
 2. EACH DITCH INLET CATCH BASIN TO HAVE A DITCH INLET GRATE AS PER DETAIL SHEET 45.
 3. CONTRACTOR TO EXPOSE AND VERIFY INVERTS OF ALL JUNCTIONS OR CONNECTIONS TO MAINLINE LDS PRIOR TO INSTALLATION OF CATCH BASINS.
 4. CLASS 3 BACKFILL TO BE USED WITHIN 1.0M OF PAVEMENT FOR ALL UNDERGROUND INSTALLATIONS.
 5. EXISTING MANHOLES AND CATCH BASINS TO BE ADJUSTED TO DESIGN ELEVATION.
 6. INSTALL 200mm PLAIN DOWELED CONCRETE TRANSITION SLABS C/W ASPHALT OVERLAY WHERE ASPHALT PAVEMENT MATCHES CONCRETE PAVEMENT.
 7. ADD 200.00 m TO ABBREVIATED ELEVATION TO OBTAIN GEODETIC ELEVATION.

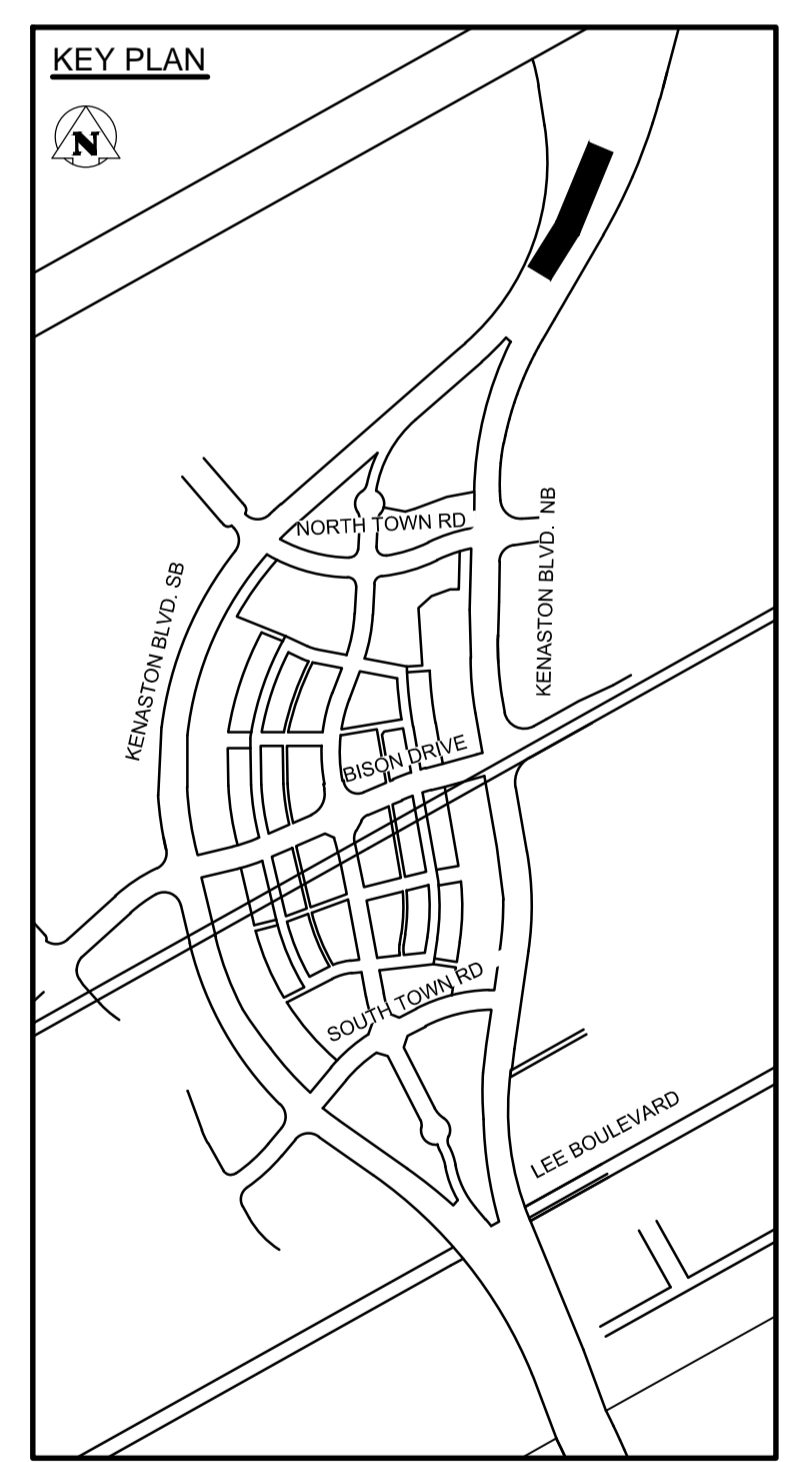
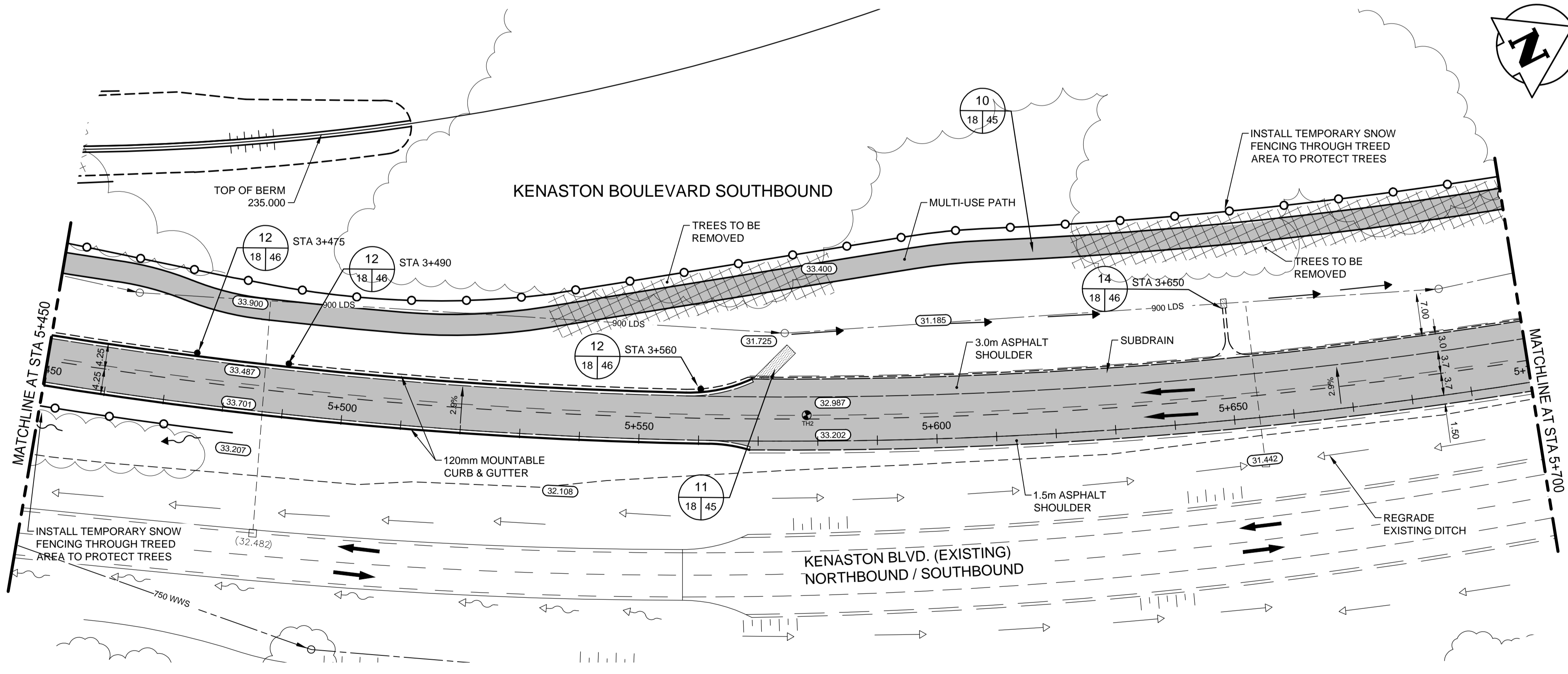

WARNING

- IF POWER EQUIPMENT OR EXPLOSIVES ARE TO BE USED FOR EXCAVATION ON THIS PROJECT THE CONTRACTOR MUST:
1. NOTIFY THE GAS COMPANY OF THE PROPOSED LOCATION OF EXCAVATION.
 2. TAKE PRECAUTION TO AVOID DAMAGE TO GAS COMPANY INSTALLATIONS SEE PROVINCIAL REGULATION 210/72 FOR DETAILS.
 3. OBTAIN EXCAVATION PERMITS PRIOR TO CONSTRUCTION.

METRIC

WHOLE NUMBERS INDICATE MILLIMETRES
DECIMALIZED NUMBERS INDICATE METRES

150 WM	WATERMAIN	150 WM	MTS	M.T.S.	150 mm W.M.	WATERMAIN	150 mm W.M.
+	HYDRANT	+	MTS	CONCRETE	+	HYDRANT	+
+	VALVE	+	MTS	ASPHALT	+	VALVE	+
300 LDS	LAND DRAINAGE SEWER	300 LDS	MTS	PLANNING	300 mm L.D.S.	LAND DRAINAGE SEWER	300 mm L.D.S.
250 WWS	WASTE WATER SEWER	250 WWS	MTS	SIDEWALK	250 mm W.W.S.	WASTE WATER SEWER	250 mm W.W.S.
○	MANHOLE	●	MTS	PAVING STONES	○	MANHOLE	●
○	CATCH BASIN	■	MTS	PROPERTY LINE	○	NORTH/WEST GUTTER	---
○	TEST HOLES	⊕	MTS	SURVEY BAR	○	SOUTH/EAST GUTTER	---
○	CULVERT	○	MTS	CURB RAMP	○	NORTH/WEST T/LANE	---
100 GAS	GAS	100 GAS	MTS	DITCH	○	SOUTH/EAST T/LANE	---
HYDRO	HYDRO	HYDRO	MTS	SWALE	○		
EXISTING	LEGEND-PLAN	PROPOSED	EXISTING	LEGEND-PLAN	PROPOSED	EXISTING	LEGEND-PROFILE

UNDERGROUND STRUCTURES

SUPV. U/G STRUCTURES COMMITTEE DATE

NOTE:
LOCATION OF UNDERGROUND STRUCTURES AS SHOWN ARE BASED ON THE BEST INFORMATION AVAILABLE. BUT NO GUARANTEE IS GIVEN THAT ALL EXISTING UTILITIES ARE SHOWN OR THAT THE GIVEN LOCATIONS ARE EXACT. CONFIRMATION OF EXISTENCE AND EXACT LOCATION OF ALL SERVICES MUST BE OBTAINED FROM THE INDIVIDUAL UTILITIES BEFORE PROCEEDING WITH CONSTRUCTION.

84R635 - Lake Crest Rd. & Waverley St., Tbt on top of 0.05m dia. x 2.4m iron pipe, 14.2m N. of S.L. of Lake Crest Rd. & 0.6m E. of E.L. of Waverley St.

B.M. 76-030 ELEV. 232.457m	DESIGNED BY V.M.M., T.G.	DESIGN TEAM
	DRAWN BY T.G.	
	CHECKED BY S.B.C.	
	APPROVED BY V.M.M.	
2 ISSUED FOR TENDER 3/04/08 V.M.M.	HOR. SCALE 1:500	RELEASED FOR CONSTRUCTION
1 ISSUED FOR REVIEW 3/03/27 V.M.M.	VERTICAL 1:20	
0 ISSUED FOR 90% REVIEW 13/02/22 V.M.M.		
NO. REVISIONS	DATE	DATE 12/11/06

ENGINEER'S SEAL

PROVINCE OF MANITOBA
REGISTERED PROFESSIONAL ENGINEER

V.M. MAROTI
MEMBER 30809

CONSULTANT PROJECT NUMBER
113705751

THE CITY OF WINNIPEG
PUBLIC WORKS DEPARTMENT

WWARP PART 3 - CONTRACT 1
STA 2+922.4 TO STA 5+935

KENASTON BOULEVARD EXTENSION - SB LANES
PAVING & GRADING - KENASTON BLVD. SB
STA 5+450 TO STA 5+700

CITY DRAWING NUMBER
P-3345-11

SHEET 18 OF 64

CONSULTANT DRAWING NUMBER
C-211

VA:1137\active\113705751\drawing\404_working\sheet_files\05751c-208-xxx.dwg