

- CONSTRUCTION NOTES:**
1. EACH CATCH BASIN (CB) AND CATCH PIT (CP) INSTALLED IN PAVEMENT TO HAVE AP-011 FRAME AND COVER.
 2. EACH DITCH INLET CATCH BASIN TO HAVE A DITCH INLET GRATE AS PER DETAIL SHEET 45.
 3. CONTRACTOR TO EXPOSE AND VERIFY INVERTS OF ALL JUNCTIONS OR CONNECTIONS TO MAINLINE LDS PRIOR TO INSTALLATION OF CATCH BASINS.
 4. CLASS 3 BACKFILL TO BE USED WITHIN 1.0M OF PAVEMENT FOR ALL UNDERGROUND INSTALLATIONS.
 5. EXISTING MANHOLES AND CATCH BASINS TO BE ADJUSTED TO DESIGN ELEVATION.
 6. INSTALL 200mm PLAIN DOWELLED CONCRETE TRANSITION SLABS C/W ASPHALT OVERLAY WHERE ASPHALT PAVEMENT MATCHES CONCRETE PAVEMENT.
 7. ADD 200.00 m TO ABBREVIATED ELEVATION TO OBTAIN GEODETIC ELEVATION.

CATCH BASIN, CATCH PIT, DITCH INLET & MANHOLES STRUCTURE AND LOCATION SCHEDULE

TYPE	STATION	O/S FROM CONTROL	RIM ELEV	BOT. ELEV	LEAD INV	MAIN INV	PIPE LEAD
CB 26	5+142.627	11.559 R	232.772	230.522	W 231.122	E 229.050	30.0m - 300mm/GR=6.90%
CB 27	5+142.580	4.212 R	233.057	230.807	W 231.407	E 229.050	18.6m - 300mm/GR=12.67%
CP 17	5+140.580	4.279 R	233.031	232.131	E 232.131	-	2.0m - 250mm
CB 28	5+142.580	8.950 L	233.021	230.771	W 231.561	E 229.050	5.9m - 300mm/2.0m RISER GR=8.66%
CP 18	5+140.580	8.950 L	233.031	232.131	N 232.131	-	2.0m - 250mm
CP 19	5+144.580	8.950 L	233.036	232.136	S 232.136	-	2.0m - 250mm

CP- SD-023, AP-011
DITCH CB - SD-025, DITCH INLET GRATE

ROAD CB - SD-024, AP-011
MH - SD-010, AP-004, AP-005

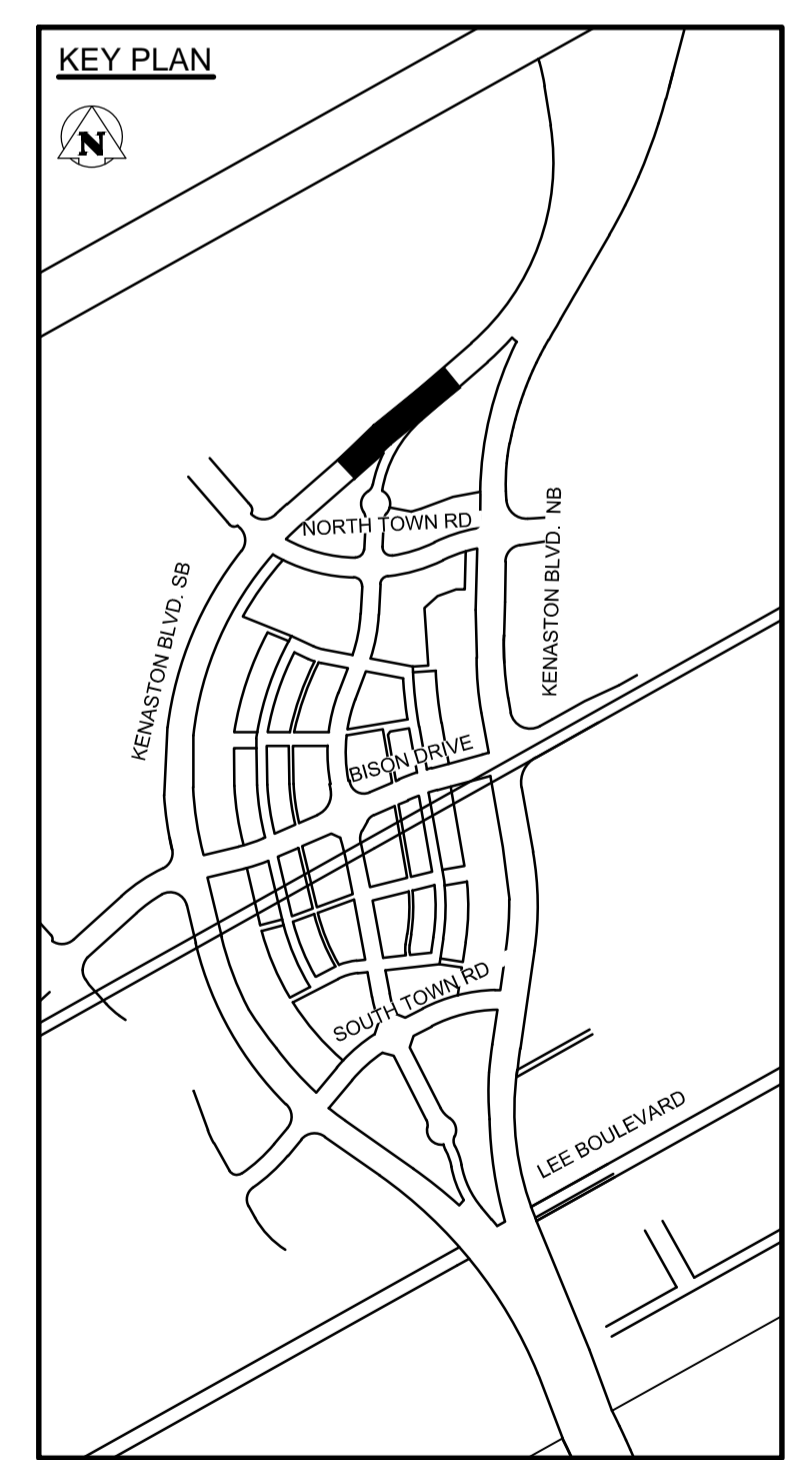
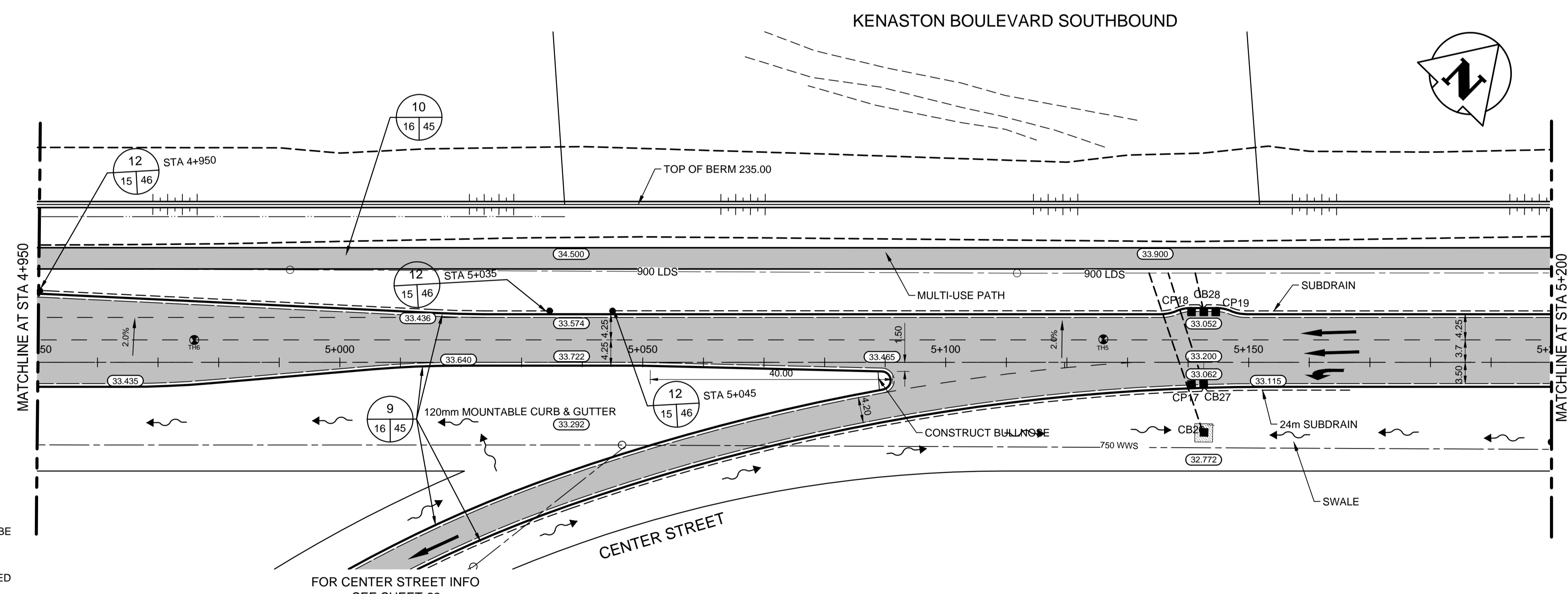

WARNING

- IF POWER EQUIPMENT OR EXPLOSIVES ARE TO BE USED FOR EXCAVATION ON THIS PROJECT THE CONTRACTOR MUST:
1. NOTIFY THE GAS COMPANY OF THE PROPOSED LOCATION OF EXCAVATION.
 2. TAKE PRECAUTION TO AVOID DAMAGE TO GAS COMPANY INSTALLATIONS SEE PROVINCIAL REGULATION 210/72 FOR DETAILS.
 3. OBTAIN EXCAVATION PERMITS PRIOR TO CONSTRUCTION.

METRIC

WHOLE NUMBERS INDICATE MILLIMETRES
DECIMALIZED NUMBERS INDICATE METRES

150 WM	WATERMAIN	150 MTS	M.T.S.	150 mm W.M.	WATERMAIN	150 mm W.M.
⊕	HYDRANT VALVE	⊕	CONCRETE ASPHALT PLANING	+	HYDRANT VALVE	+
300 LDS	LAND DRAINAGE SEWER	300 LDS	SIDEWALK PAVING STONES	300 mm L.D.S.	LAND DRAINAGE SEWER	300 mm L.D.S.
250 WWS	WASTE WATER SEWER	250 WWS	PROPERTY LINE SURVEY BAR	250 mm W.W.S.	WASTE WATER SEWER	250 mm W.W.S.
○	MANHOLE	●	CURB RAMP	---	○	MANHOLE
⊕	CATCH BASIN	⊕	DITCH	---	⊕	CATCH BASIN
⊕	TEST HOLES	⊕	SWALE	---	⊕	TEST HOLES
---	CULVERT	---		---	---	CULVERT
100 GAS	GAS	100 GAS		---	100 GAS	GAS
HYDRO	HYDRO	HYDRO		---	HYDRO	HYDRO
---	EXISTING	---	LEGEND-PLAN	---	---	EXISTING
---	PROPOSED	---	LEGEND-PROFILE	---	---	PROPOSED

UNDERGROUND STRUCTURES

SUPV. U/G STRUCTURES COMMITTEE DATE

NOTE:
LOCATION OF UNDERGROUND STRUCTURES AS SHOWN ARE BASED ON THE BEST INFORMATION AVAILABLE. BUT NO GUARANTEE IS GIVEN THAT ALL EXISTING UTILITIES ARE SHOWN OR THAT THE GIVEN LOCATIONS ARE EXACT. CONFIRMATION OF EXISTENCE AND EXACT LOCATION OF ALL SERVICES MUST BE OBTAINED FROM THE INDIVIDUAL UTILITIES BEFORE PROCEEDING WITH CONSTRUCTION.

84R635 - Lake Crest Rd. & Waverley St., Tblt on top of 0.05m dia. x 2.4m iron pipe, 14.2m N. of S.L. of Lake Crest Rd. & 0.6m E. of E.L. of Waverley St.



B.M. 76-030 ELEV. 232.457m	DESIGNED BY V.M.M., T.G.	DESIGN TEAM	ENGINEER'S SEAL V.M. MAROTI MEMBER 30809 REGISTERED PROFESSIONAL ENGINEER
	DRAWN BY T.G.		
	CHECKED BY S.B.C.		
	APPROVED BY V.M.M.		
2 ISSUED FOR TENDER 3/04/08 V.M.M.	HOR. SCALE 1:500	RELEASED FOR CONSTRUCTION	CONSULTANT PROJECT NUMBER 113705751
1 ISSUED FOR REVIEW 3/03/27 V.M.M.	VERTICAL 1:20		
0 ISSUED FOR 90% REVIEW 13/02/22 V.M.M.			
NO. REVISIONS	DATE	DATE	DATE
		12/11/06	

THE CITY OF WINNIPEG PUBLIC WORKS DEPARTMENT

WWARP PART 3 - CONTRACT 1
STA 2+922.4 TO STA 5+935

KENASTON BOULEVARD EXTENSION - SB LANES
PAVING & GRADING - KENASTON BLVD. SB
STA 4+950 TO STA 5+200

CITY DRAWING NUMBER P-3345-16
SHEET 16 OF 64
CONSULTANT DRAWING NUMBER C-209

V:\113705751\drawing\404_working\sheet_files\05751c-208-xxx.dwg