

- CONSTRUCTION NOTES:**
- EACH CATCH BASIN (CB) AND CATCH PIT (CP) INSTALLED IN PAVEMENT TO HAVE AP-011 FRAME AND COVER.
 - EACH DITCH INLET CATCH BASIN TO HAVE A DITCH INLET GRATE AS PER DETAIL SHEET 45.
 - CONTRACTOR TO EXPOSE AND VERIFY INVERTS OF ALL JUNCTIONS OR CONNECTIONS TO MAINLINE LDS PRIOR TO INSTALLATION OF CATCH BASINS.
 - CLASS 3 BACKFILL TO BE USED WITHIN 1.0M OF PAVEMENT FOR ALL UNDERGROUND INSTALLATIONS.
 - EXISTING MANHOLES AND CATCH BASINS TO BE ADJUSTED TO DESIGN ELEVATION.
 - INSTALL 200mm PLAIN DOWELLED CONCRETE TRANSITION SLABS C/W ASPHALT OVERLAY WHERE ASPHALT PAVEMENT MATCHES CONCRETE PAVEMENT.
 - ADD 200.00 m TO ABBREVIATED ELEVATION TO OBTAIN GEODETIC ELEVATION.

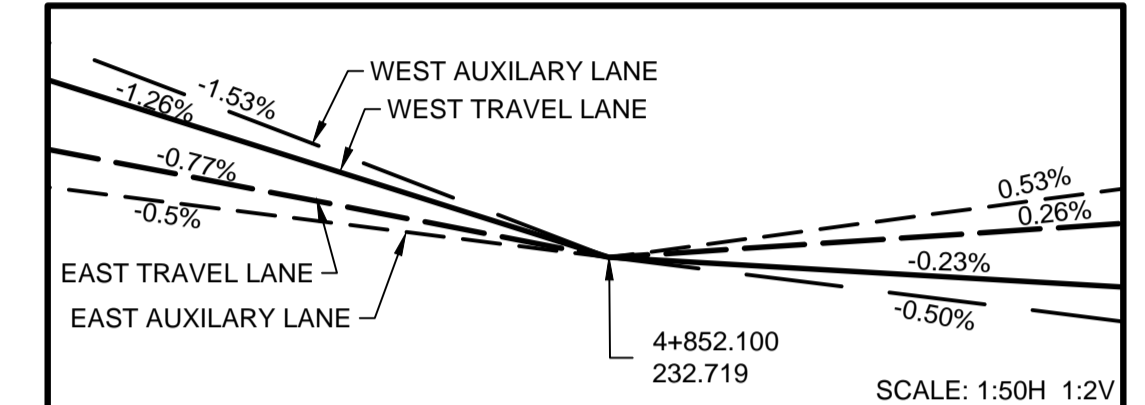

1 PROFILE GRADES DETAIL
1:50H 1:2V

CATCH BASIN, CATCH PIT, DITCH INLET & MANHOLES STRUCTURE AND LOCATION SCHEDULE

TYPE	STATION	O/S FROM CONTROL	RIM ELEV	BOT. ELEV	LEAD INV	MAIN INV	PIPE LEAD
CB 20	4+740.759	18.839 L	232.923	230.673	231.273	228.240	3.0m - 250mm/2.5m RISER GR=17.77%
CP 13	4+738.000	1.556 R	232.833	232.933	N 232.933	-	2.0m - 250mm
CB 21	4+740.000	1.556 R	232.823	230.573	W 231.173	228.690	16.2m - 300mm/GR=15.32%
CP 14	4+742.000	1.556 R	232.833	232.933	S 232.933	-	2.0m-250mm
CB 22	4+773.721	34.735 L	232.955	230.705	W 231.305	228.800	20.2m - 250mm/GR=12.40%
CB 23	4+846.240	4.050 R	232.761	230.511	W 231.111	228.900	19.0m - 250mm/GR=11.63%
CB 24	4+852.075	10.543 R	232.361	230.111	W 230.711	228.900	25.6m-300/GR=7.07%
CP 15	4+865.742	11.450 L	232.650	231.750	S 231.750	-	2.0m - 250mm
CB 25	4+867.742	11.450 L	232.640	230.390	W 230.990	228.473	4.5m - 300mm RISER/GR=12.65%
CP 16	4+869.742	11.450 L	232.650	231.750	S 231.750	-	2.0m - 250mm

CP - SD-023, AP-011
DITCH CB - SD-025, DITCH INLET GRATE

ROAD CB - SD-024, AP-011
MH - SD-010, AP-004, AP-005

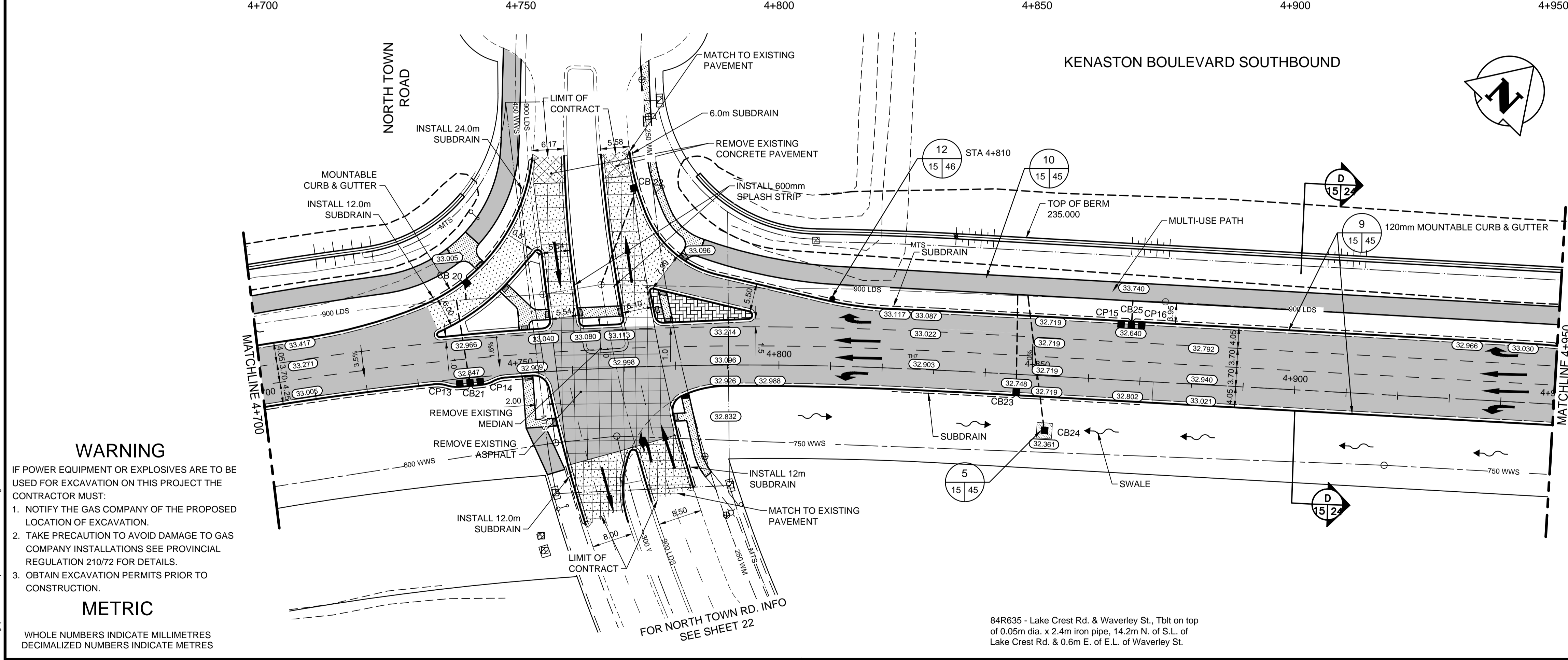

WARNING
IF POWER EQUIPMENT OR EXPLOSIVES ARE TO BE USED FOR EXCAVATION ON THIS PROJECT THE CONTRACTOR MUST:
1. NOTIFY THE GAS COMPANY OF THE PROPOSED LOCATION OF EXCAVATION.
2. TAKE PRECAUTION TO AVOID DAMAGE TO GAS COMPANY INSTALLATIONS SEE PROVINCIAL REGULATION 210/72 FOR DETAILS.
3. OBTAIN EXCAVATION PERMITS PRIOR TO CONSTRUCTION.

METRIC
WHOLE NUMBERS INDICATE MILLIMETRES
DECIMALIZED NUMBERS INDICATE METRES

150 W.M.	WATERMAIN	150 W.M.	M.T.S.	M.T.S.	150 mm W.M.	WATERMAIN	150 mm W.M.
+	HYDRANT VALVE	+	CONCRETE ASPHALT PLANING SIDEWALK	+	HYDRANT VALVE	+	CONCRETE ASPHALT PLANING SIDEWALK
300 LDS	LAND DRAINAGE SEWER	300 LDS	PAVING STONES	300 mm L.D.S.	LAND DRAINAGE SEWER	300 mm L.D.S.	PAVING STONES
250 WWS	WASTE WATER SEWER	250 WWS	PROPERTY LINE SURVEY BAR	250 mm W.W.S.	WASTE WATER SEWER	250 mm W.W.S.	PROPERTY LINE SURVEY BAR
○	MANHOLE	○	CURB RAMP	○	MANHOLE	○	CURB RAMP
□	CATCH BASIN	□	DITCH	□	CATCH BASIN	□	DITCH
⊕	TEST HOLES	⊕	SWALE	⊕	TEST HOLES	⊕	SWALE
○	CULVERT	○	EXISTING	○	CULVERT	○	EXISTING
100 GAS	GAS	100 GAS	PROPOSED	100 GAS	GAS	100 GAS	PROPOSED
HYDRO	HYDRO	HYDRO	EXISTING	HYDRO	HYDRO	HYDRO	EXISTING
EXISTING	LEGEND-PLAN	PROPOSED	EXISTING	LEGEND-PLAN	PROPOSED	EXISTING	LEGEND-PROFILE

UNDERGROUND STRUCTURES

84R635 - Lake Crest Rd. & Waverley St., Tblt on top of 0.05m dia. x 2.4m iron pipe, 14.2m N. of S.L. of Lake Crest Rd. & 0.6m E. of E.L. of Waverley St.

NO.	REVISIONS	DATE	BY	DATE
2	ISSUED FOR TENDER	13/04/08	V.M.M.	
1	ISSUED FOR REVIEW	13/03/27	V.M.M.	
0	ISSUED FOR 90% REVIEW	13/02/22	V.M.M.	

DESIGNED BY	DESIGN TEAM	ENGINEER'S SIGNATURE
V.M.M., T.G.		V.M. MAROTI
DRAWN BY		MEMBER 30809
T.G.		REGISTERED PROFESSIONAL ENGINEER
CHECKED BY		
S.B.C.		
APPROVED BY		
V.M.M.		
HOR. SCALE 1:500	RELEASED FOR CONSTRUCTION	CONSULTANT PROJECT NUMBER
VERTICAL 1:20		113705751
DATE 12/11/06		

APEGN
Certificate of Authorization
Stantec Consulting Ltd.
No. 1301

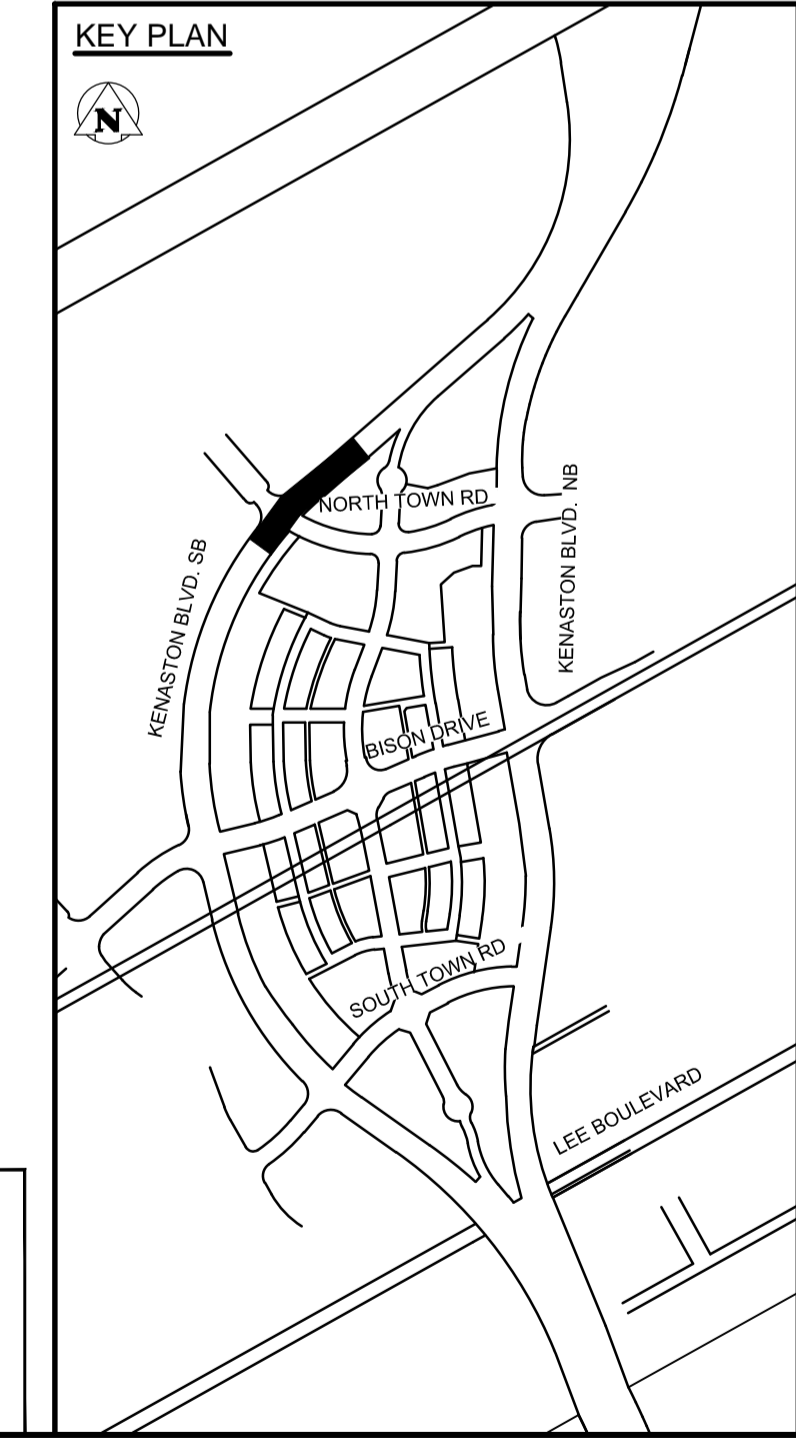

THE CITY OF WINNIPEG PUBLIC WORKS DEPARTMENT

WWARP PART 3 - CONTRACT 1
STA 2+922.4 TO STA 5+935

CITY DRAWING NUMBER: P-3345-15
SHEET: 15 OF 64
CONSULTANT DRAWING NUMBER: C-208

VA 1137\active\113705751\drawing\404_working\sheet_files\05751c-208-xxx.dwg