

- CONSTRUCTION NOTES:**
- EACH CATCH BASIN (CB) AND CATCH PIT (CP) INSTALLED IN PAVEMENT TO HAVE AP-011 FRAME AND COVER.
 - EACH DITCH INLET CATCH BASIN TO HAVE A DITCH INLET GRATE AS PER DETAIL SHEET 45.
 - CONTRACTOR TO EXPOSE AND VERIFY INVERTS OF ALL JUNCTIONS OR CONNECTIONS TO MAINLINE LDS PRIOR TO INSTALLATION OF CATCH BASINS.
 - CLASS 3 BACKFILL TO BE USED WITHIN 1.0m OF PAVEMENT FOR ALL UNDERGROUND INSTALLATIONS.
 - EXISTING MANHOLES AND CATCH BASINS TO BE ADJUSTED TO DESIGN ELEVATION.
 - INSTALL 200mm PLAIN DOWELED CONCRETE TRANSITION SLABS C/W ASPHALT OVERLAY WHERE ASPHALT PAVEMENT MATCHES CONCRETE PAVEMENT.
 - ADD 200.00 M TO ABBREVIATED ELEVATION TO OBTAIN GEODETIC ELEVATION.

TYPE	STATION	O/S FROM CONTROL	RIM ELEV.	BOT. ELEV.	LEAD INV.	MAIN INV.	PIPE LEAD
CB 5	3+549.000	7.872R	231.980	229.730	N 230.330	229.000	5.6m - 300mm 1.0m RISER/GR=5.88%
CP 2	3+547.000	11.450 L	232.839	231.939	W 231.939	-	2.0m - 250mm
CP 3	3+551.000	11.450 L	232.839	231.939	E 231.939	-	2.0m - 250mm
CB 6	3+549.000	11.450 L	232.829	230.579	N 231.179	229.000	23.3m - 300mm/GR=9.35%
CB 7	3+628.157	14.848 L	233.331	231.081	W 231.681	229.300	36.0m - 250mm/GR=6.68%
CB 8	3+648.223	0.537 R	233.303	231.053	W 231.653	228.900	11.9m - 250mm/GR=23.05%
CB 9	3+690.409	14.701 L	233.118	230.868	E 231.468	229.300	35.3m - 250mm/GR=6.14%

CP- SD-023, AP-011
DITCH CB - SD-025, DITCH INLET GRATE
*SEE LAND DRAINAGE DRAWINGS FOR MH INFORMATION

ROAD CB - SD-024, AP-011
MH - SD-010, AP-004, AP-005

KENASTON BOULEVARD SOUTHBOUND

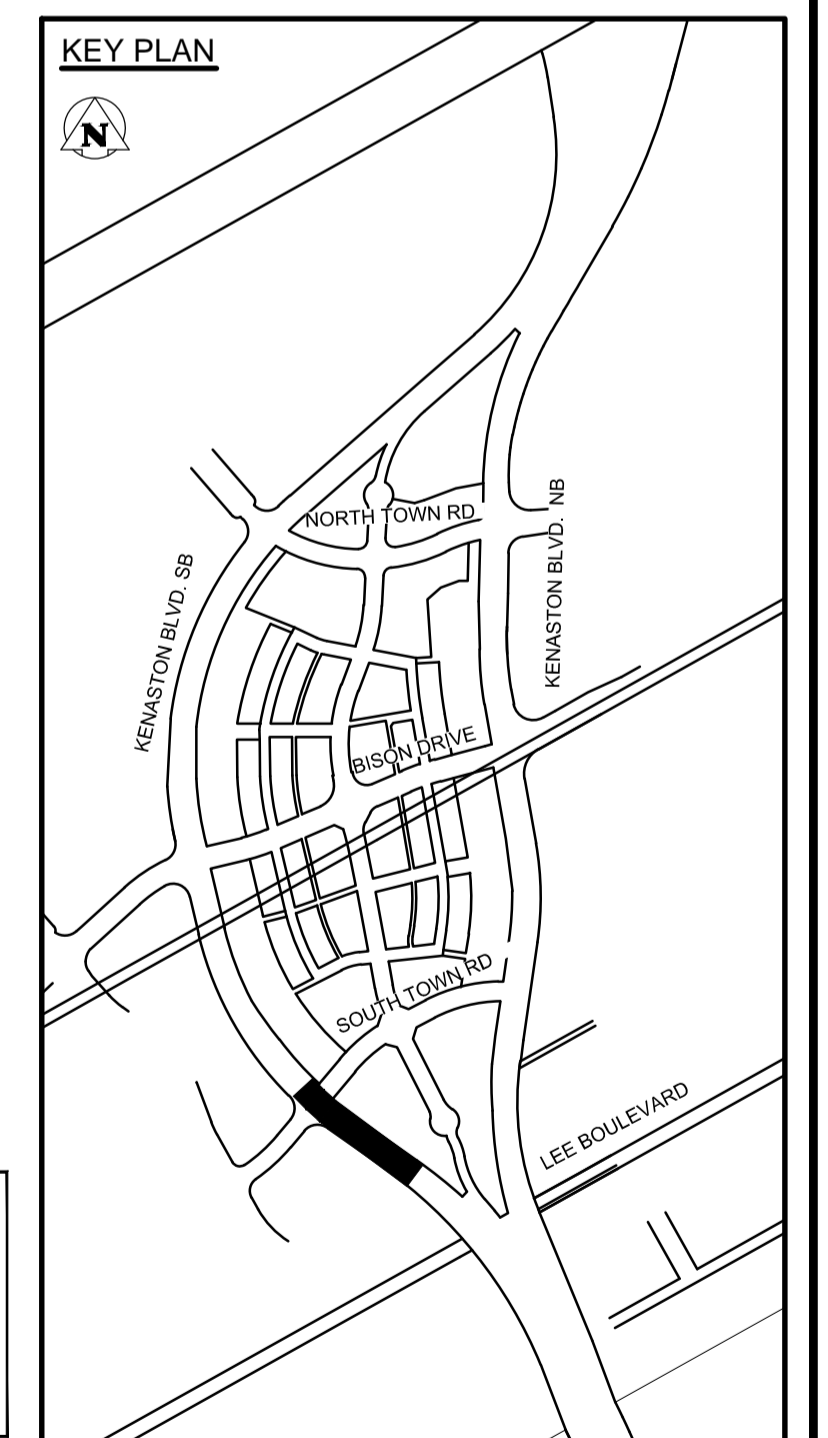
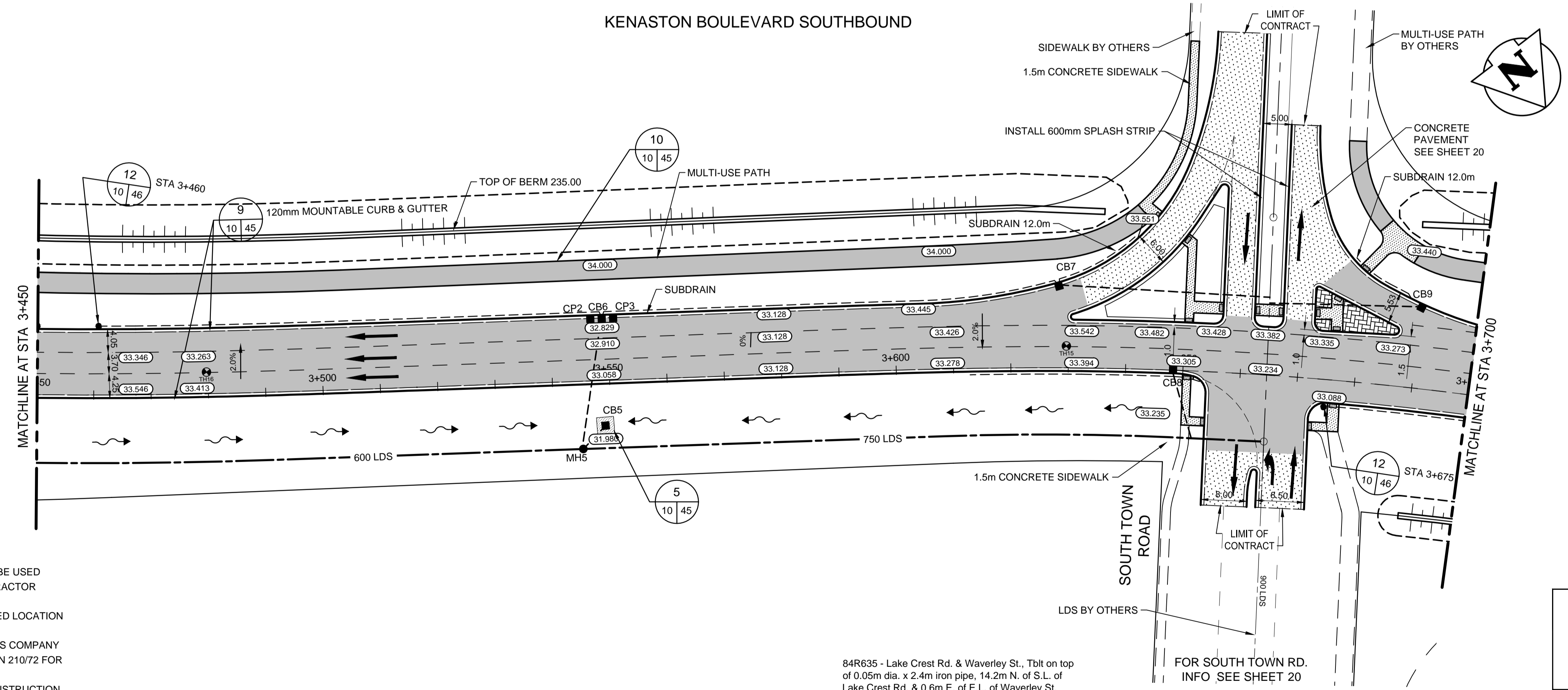

METRIC

WHOLE NUMBERS INDICATE MILLIMETRES
DECIMALIZED NUMBERS INDICATE METRES

WARNING

- IF POWER EQUIPMENT OR EXPLOSIVES ARE TO BE USED FOR EXCAVATION ON THIS PROJECT THE CONTRACTOR MUST:
- NOTIFY THE GAS COMPANY OF THE PROPOSED LOCATION OF EXCAVATION.
 - TAKE PRECAUTION TO AVOID DAMAGE TO GAS COMPANY INSTALLATIONS SEE PROVINCIAL REGULATION 210/72 FOR DETAILS.
 - OBTAIN EXCAVATION PERMITS PRIOR TO CONSTRUCTION.

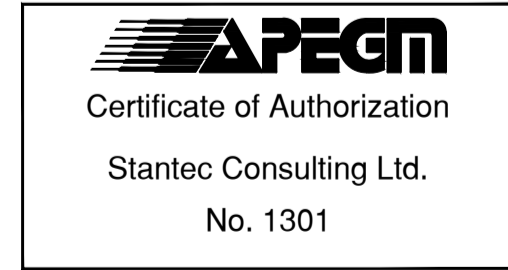

150 MM	WATERMAIN	150 MM	M.T.S.	M.T.S.	150 mm W.W.	WATERMAIN	150 mm W.W.
+	HYDRANT VALVE	+	CONCRETE ASPHALT PLANING	+	300 mm L.D.S.	+	HYDRANT VALVE
+	LAND DRAINAGE SEWER	+	SIDEWALK	+	250 mm W.W.S.	+	LAND DRAINAGE SEWER
+	WASTE WATER SEWER	+	PAVING STONES	+	300 mm L.D.S.	+	WASTE WATER SEWER
+	MANHOLE	+	PROPERTY LINE	+	250 mm W.W.S.	+	MANHOLE
+	CATCH BASIN	+	SURVEY BAR	+	300 mm L.D.S.	+	CATCH BASIN
+	TEST HOLES	+	CURB RAMP	+	250 mm W.W.S.	+	TEST HOLES
+	CULVERT	+	DITCH	+	300 mm L.D.S.	+	CULVERT
+	GAS	+	SWALE	+	250 mm W.W.S.	+	GAS
+	HYDRO	+		+	300 mm L.D.S.	+	HYDRO
+	EXISTING	+	LEGEND-PLAN	+	300 mm L.D.S.	+	EXISTING
+	PROPOSED	+	LEGEND-PROFILE	+	250 mm W.W.S.	+	PROPOSED

UNDERGROUND STRUCTURES		B.M. 76-030 ELEV. 232.457m	
DESIGNED BY	V.M.M., T.G.	DESIGN TEAM	
DRAWN BY	T.G.	CHECKED BY	S.B.C.
APPROVED BY	V.M.M.	FOR SOUTH TOWN RD. INFO SEE SHEET 20	
ISSUED FOR TENDER	3/04/08 V.M.M.	ISSUED FOR REVIEW	3/03/27 V.M.M.
ISSUED FOR 90% REVIEW	13/02/22 V.M.M.	NO. REVISIONS	DATE
		DATE	12/11/06

84R635 - Lake Crest Rd. & Waverley St. Tblt on top of 0.05m dia. x 2.4m iron pipe, 14.2m N. of S.L. of Lake Crest Rd. & 0.6m E. of E.L. of Waverley St.

FOR SOUTH TOWN RD.
INFO SEE SHEET 20

DESIGNED BY: V.M.M., T.G.
DRAWN BY: T.G.
CHECKED BY: S.B.C.
APPROVED BY: V.M.M.

DESIGN TEAM:

ENGINEER'S SEAL:

RELEASED FOR CONSTRUCTION:

CONSULTANT PROJECT NUMBER: 113705751

THE CITY OF WINNIPEG
PUBLIC WORKS DEPARTMENT

WWARP PART 3 - CONTRACT 1
STA 2+922.4 TO STA 5+935

CITY DRAWING NUMBER: P-3345-10
SHEET 10 OF 64
CONSULTANT DRAWING NUMBER: C-203

VA 1137 (rev 05/15) drawing 113705751-001 - xxx.dwg