

3+600 3+650 3+700

KENASTON BOULEVARD NORTHBOUND

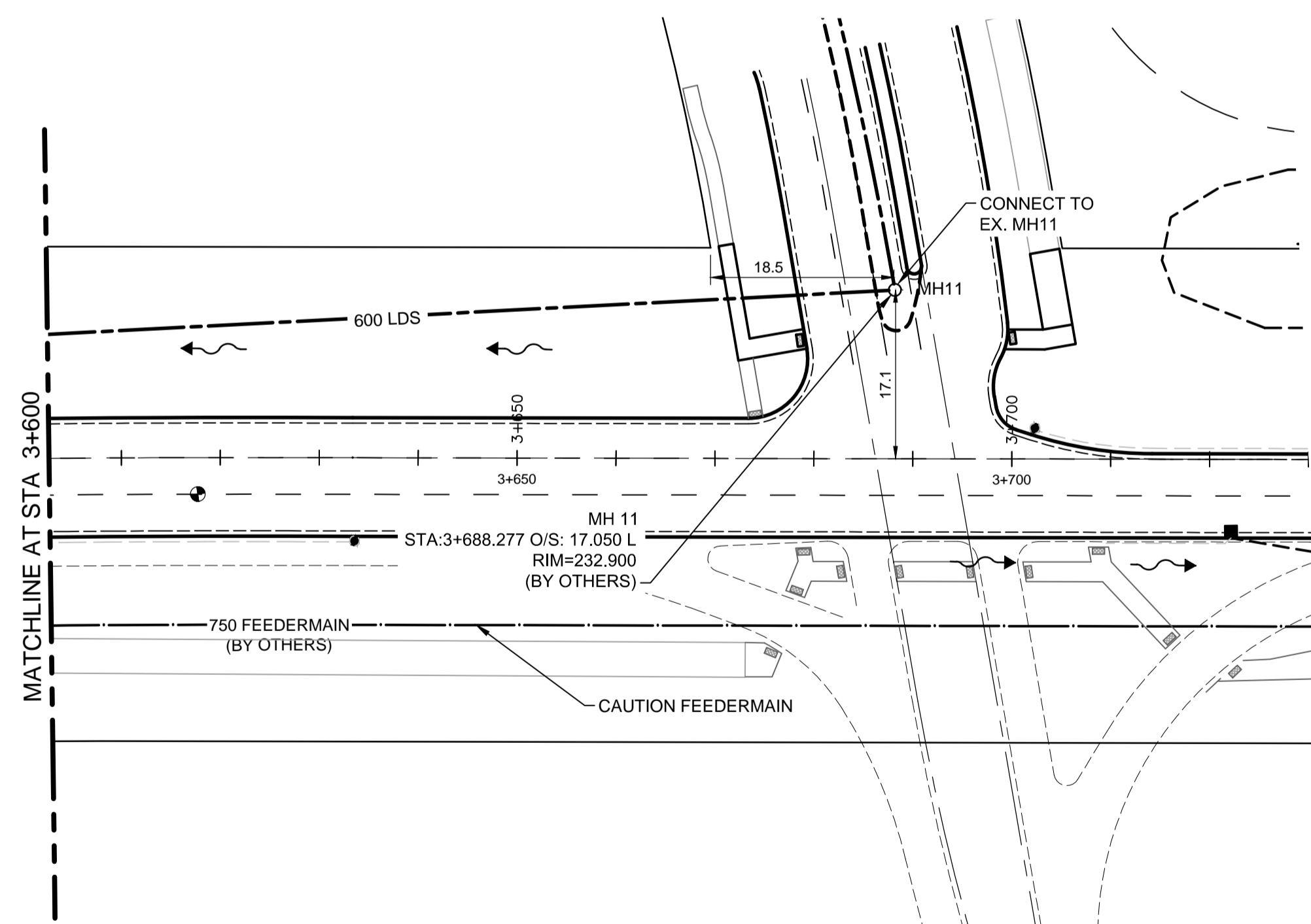
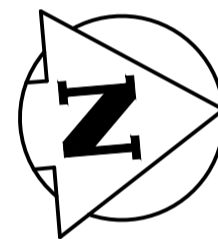

84R635 - Lake Crest Rd. & Waverley St. Tblt top of 0.05m dia. x 2.4m iron pipe, 14.2m N. of S.L. of Lake Crest Rd. & 0.6m E. of E.L. of Waverley St.

METRIC

WHOLE NUMBERS INDICATE MILLIMETRES  
DECIMALIZED NUMBERS INDICATE METRES

WARNING

IF POWER EQUIPMENT OR EXPLOSIVES ARE TO BE USED FOR EXCAVATION ON THIS PROJECT THE CONTRACTOR MUST:

1. NOTIFY THE GAS COMPANY OF THE PROPOSED LOCATION OF EXCAVATION.
2. TAKE PRECAUTION TO AVOID DAMAGE TO GAS COMPANY INSTALLATIONS SEE PROVINCIAL REGULATION 210/72 FOR DETAILS.
3. OBTAIN EXCAVATION PERMITS PRIOR TO CONSTRUCTION.

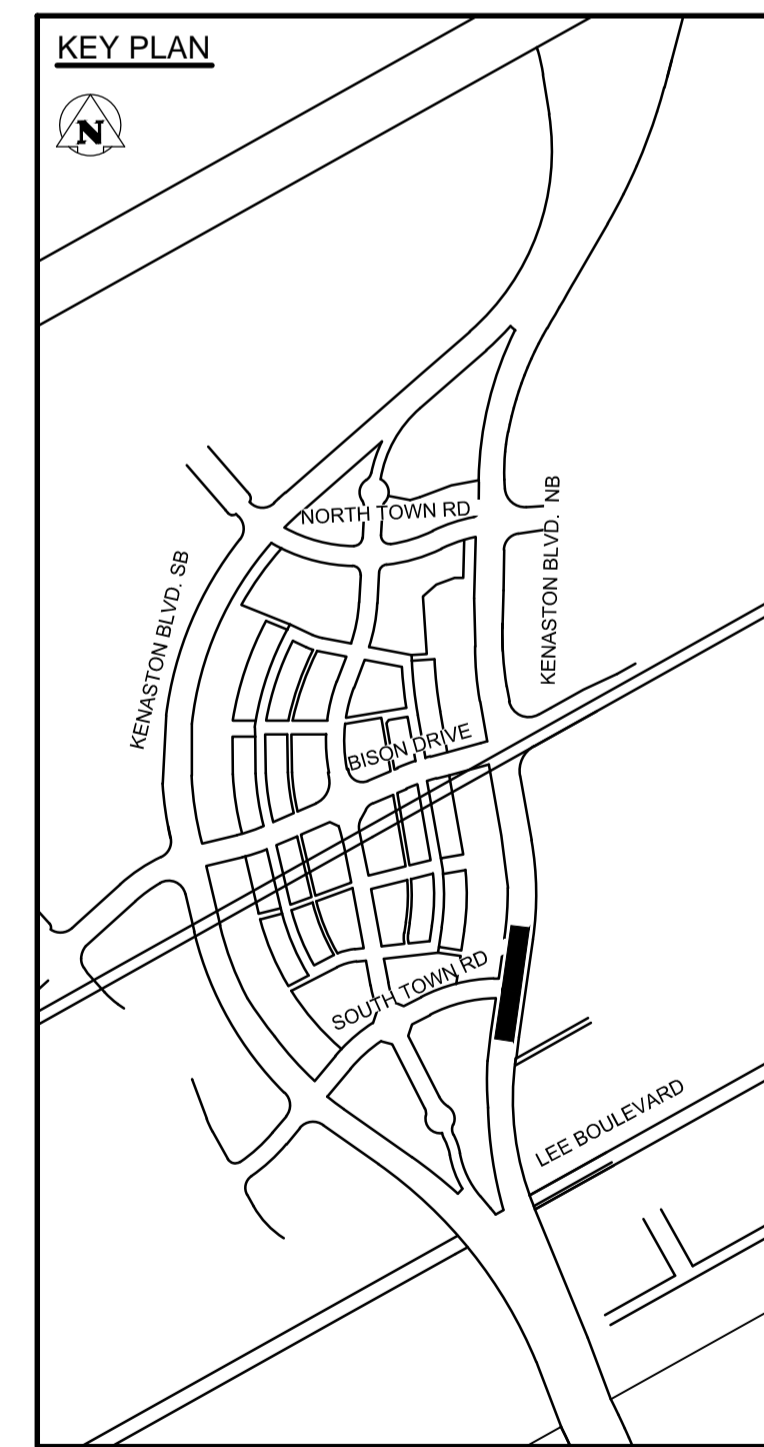

**APEGM**  
Certificate of Authorization  
Stantec Consulting Ltd.  
No. 1301

150 WM	150 WM	MTS	M.T.S.	MTS	150 mm W.M.	150 mm W.M.	150 mm W.M.
HYDRANT	HYDRANT	CONCRETE	CONCRETE	HYDRANT	HYDRANT	HYDRANT	HYDRANT
VALVE	VALVE	ASPHALT	ASPHALT	VALVE	VALVE	VALVE	VALVE
300 LDS LAND DRAINAGE SEWER	300 LDS LAND DRAINAGE SEWER	PLANNING	PLANNING	300 mm L.D.S. LAND DRAINAGE SEWER	300 mm L.D.S. LAND DRAINAGE SEWER	300 mm L.D.S. LAND DRAINAGE SEWER	300 mm L.D.S. LAND DRAINAGE SEWER
250 WWS WASTE WATER SEWER	250 WWS WASTE WATER SEWER	SIDEWALK	SIDEWALK	250 mm W.W.S. WASTE WATER SEWER	250 mm W.W.S. WASTE WATER SEWER	250 mm W.W.S. WASTE WATER SEWER	250 mm W.W.S. WASTE WATER SEWER
MANHOLE	MANHOLE	PAVING STONES	PAVING STONES	Q PROFILE	Q PROFILE	Q PROFILE	Q PROFILE
CATCH BASIN	CATCH BASIN	PROPERTY LINE	PROPERTY LINE	NORTH/WEST GUTTER	NORTH/WEST GUTTER	NORTH/WEST GUTTER	NORTH/WEST GUTTER
TEST HOLES	TEST HOLES	SURVEY BAR	SURVEY BAR	SOUTH/EAST GUTTER	SOUTH/EAST GUTTER	SOUTH/EAST GUTTER	SOUTH/EAST GUTTER
CULVERT	CULVERT	CURB RAMP	CURB RAMP	NORTH/WEST T/LANE	NORTH/WEST T/LANE	NORTH/WEST T/LANE	NORTH/WEST T/LANE
100 GAS	100 GAS	DITCH	DITCH	SOUTH/EAST T/LANE	SOUTH/EAST T/LANE	SOUTH/EAST T/LANE	SOUTH/EAST T/LANE
HYDRO	HYDRO	SWALE	SWALE				
EXISTING	LEGEND-PLAN	PROPOSED	EXISTING	LEGEND-PLAN	PROPOSED	EXISTING	LEGEND-PROFILE

UNDERGROUND STRUCTURES

SUPV. U/G STRUCTURES COMMITTEE DATE

NOTE:  
LOCATION OF UNDERGROUND STRUCTURES AS SHOWN ARE BASED ON THE BEST INFORMATION AVAILABLE. BUT NO GUARANTEE IS GIVEN THAT ALL EXISTING UTILITIES ARE SHOWN OR THAT THE GIVEN LOCATIONS ARE EXACT. CONFIRMATION OF EXISTENCE AND EXACT LOCATION OF ALL SERVICES MUST BE OBTAINED FROM THE INDIVIDUAL UTILITIES BEFORE PROCEEDING WITH CONSTRUCTION.

B.M. 76-030	ELEV. 232.457m
DESIGNED BY	D.P.M., D.J.M.
DRAWN BY	T.G., D.J.M.
CHECKED BY	D.J.M.
APPROVED BY	D.P.M.
HOR. SCALE	1:500
VERTICAL	1:20
REVISIONS	DATE BY DATE
1	ISSUED FOR TENDER 13/04/08 D.P.M.
2	ISSUED FOR REVIEW 13/03/27 D.P.M.
0	ISSUED FOR 90% REVIEW 13/02/22 D.P.M.
NO.	REVISIONS DATE BY DATE
	13/02/04

DESIGN TEAM

ENGINEER'S SEAL

PROVINCE OF MANITOBA REGISTERED PROFESSIONAL ENGINEER

D.P. MAGES MEMBER 23458

CONSULTANT PROJECT NUMBER 113705751

THE CITY OF WINNIPEG PUBLIC WORKS DEPARTMENT

WWARP PART 3 - CONTRACT 1

STA 2+922.4 TO STA 5+935

KENASTON BOULEVARD EXTENSION - NB. LANES

LAND DRAINAGE SEWER

STA 3+600 TO STA 3+730

CITY DRAWING NUMBER	LD-7082
SHEET	62 OF 64
CONSULTANT DRAWING NUMBER	C-240

VA 113705751.drawing\404\_working\sheet\_files\05751c-238-xxx.dwg