

ZONING - M1
 MIN FRONT YARD = 25 FT.
 MIN REAR YARD = 0 FT.
 MIN INTERIOR SIDE YARD = 0 FT.
 MIN CORNER SIDE YARD = 15 FT.
 BUILDING AREA = 125 S.F. (177 S.F. COVERAGE)
 SITE AREA = 11,758 S.F.
 MAX FAR = 2 PROVIDED = 0.015
 MAX BLDG HT = 50 FT. PROVIDED = 11'-2"



SA-1
 Rev. 0

COMFORT STATION FOR WINNIPEG TRANSIT
 McPHILLIPS LOOP AND CAMBRIDGE LOOP
 WINNIPEG, MANITOBA

SITE PLAN - McPHILLIPS LOOP

REV. 0 13/11/29 ISSUED FOR TENDER & CONSTRUCTION

SCALE: 1/16" = 1'-0"
 DATE: 2013/11/29

Victor Suen Architect

23 Stormont Drive, Winnipeg, MB R3V 1L9
 email: victorsuenarchitect@mts.net
 Ph (204) 228-0230 Fax (204) 261-6341

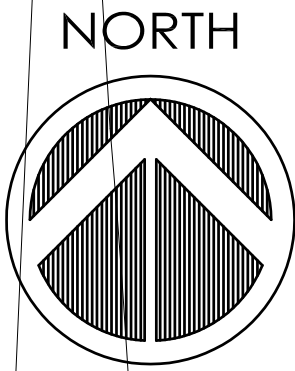

McPHILLIPS STREET

SELKIRK AVE.

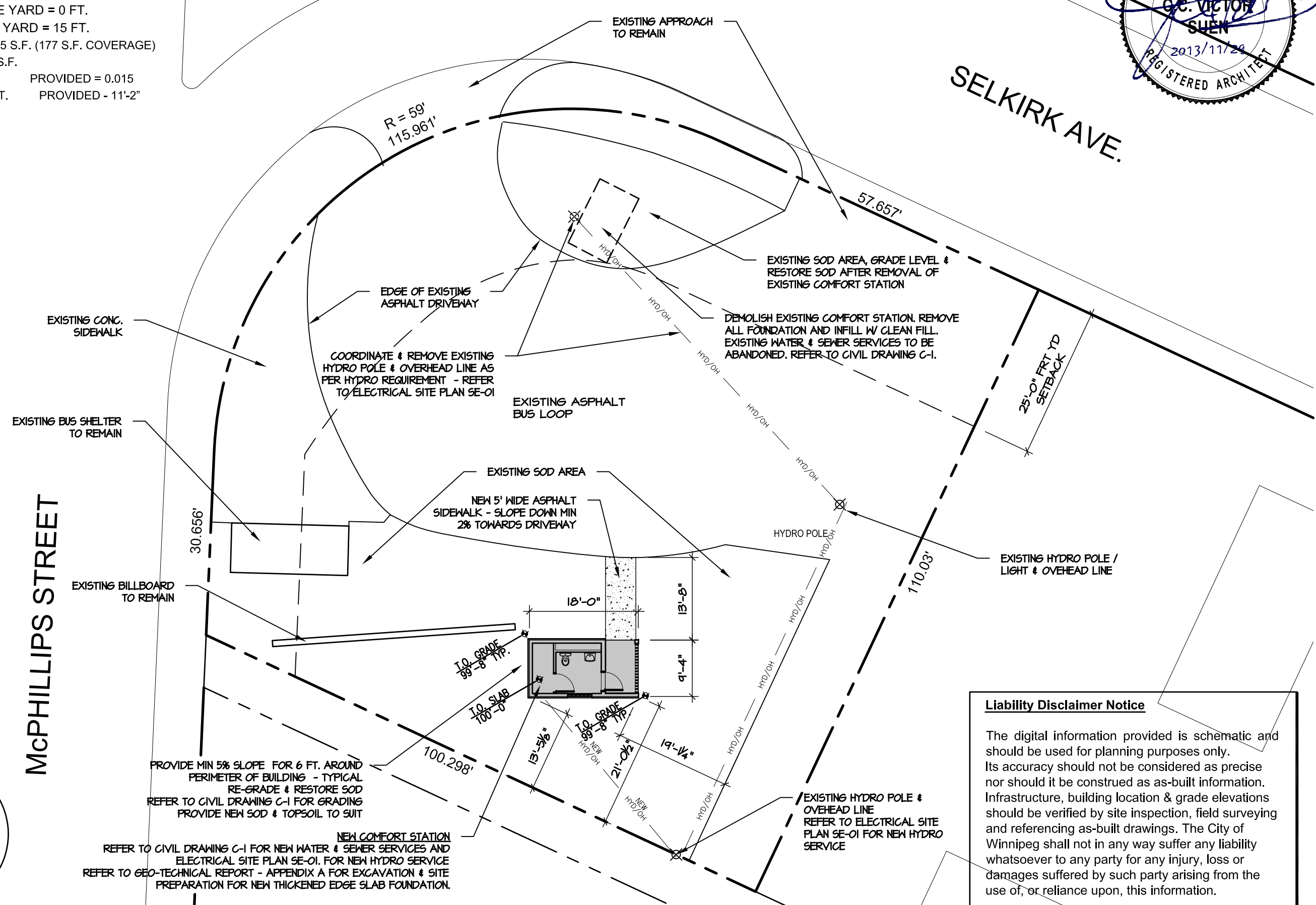

PROVIDE MIN 5% SLOPE FOR 6 FT. AROUND PERIMETER OF BUILDING - TYPICAL RE-GRADE & RESTORE SOD REFER TO CIVIL DRAWING C-1 FOR GRADING PROVIDE NEW SOD & TOPSOIL TO SUIT

NEW COMFORT STATION
 REFER TO CIVIL DRAWING C-1 FOR NEW WATER & SEWER SERVICES AND ELECTRICAL SITE PLAN SE-01. FOR NEW HYDRO SERVICE REFER TO GEO-TECHNICAL REPORT - APPENDIX A FOR EXCAVATION & SITE PREPARATION FOR NEW THICKENED EDGE SLAB FOUNDATION.

EXISTING SOD AREA, GRADE LEVEL & RESTORE SOD AFTER REMOVAL OF EXISTING COMFORT STATION
 DEMOLISH EXISTING COMFORT STATION. REMOVE ALL FOUNDATION AND INFILL W/ CLEAN FILL. EXISTING WATER & SEWER SERVICES TO BE ABANDONED. REFER TO CIVIL DRAWING C-1.

Liability Disclaimer Notice

The digital information provided is schematic and should be used for planning purposes only. Its accuracy should not be considered as precise nor should it be construed as as-built information. Infrastructure, building location & grade elevations should be verified by site inspection, field surveying and referencing as-built drawings. The City of Winnipeg shall not in any way suffer any liability whatsoever to any party for any injury, loss or damages suffered by such party arising from the use of, or reliance upon, this information.