

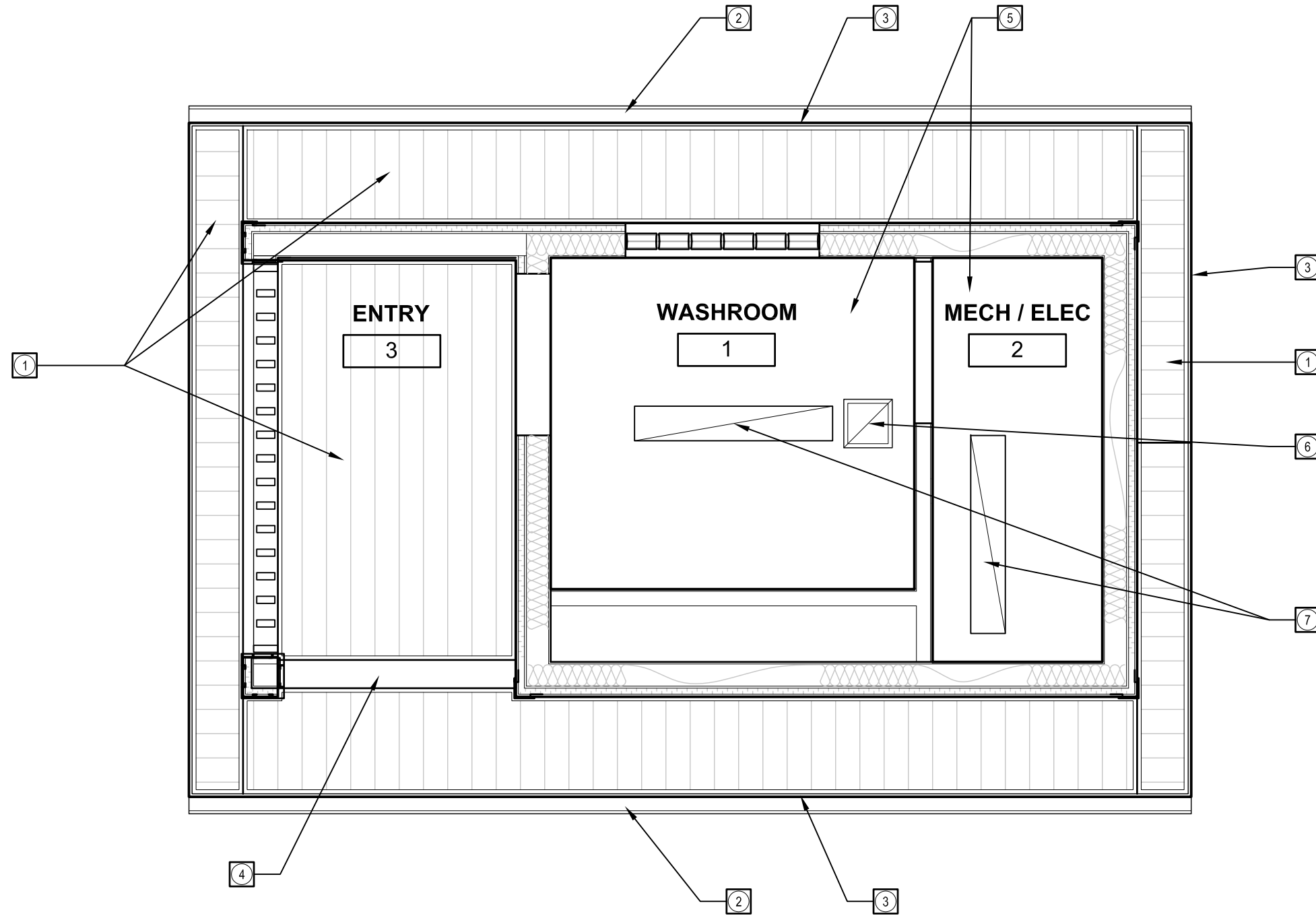

A-3
Rev. 0



CONSTRUCTION NOTES:

- ① PRE-FIN PERFORATED METAL SOFFIT
- ② PRE-FIN METAL EAVETROUGH
- ③ PRE-FIN METAL CLAD FASCIA W/ DRIP
- ④ PRE-FIN METAL CLAD LINTEL
- ⑤ GWB CEILING (PTD)
- ⑥ EXHAUST FAN - SEE MECH
- ⑦ LIGHT FIXTURE - SEE ELEC

1
A-3 REFLECTED CEILING PLAN
SCALE 3/8" = 1'-0"

COMFORT STATION FOR WINNIPEG TRANSIT

REFLECTED CEILING PLAN

SCALE: 3/8" = 1'-0"
DATE: 2013/06/20

REV. 0 13/11/29 ISSUED FOR TENDER & CONSTRUCTION

Victor Suen Architect

23 Stormont Drive, Winnipeg, MB R3V 1L9
email: victorsuenarchitect@mts.net
Ph (204) 228-0230 Fax (204) 261-6341