

# WORDSWORTH WAY (WEST LEG)

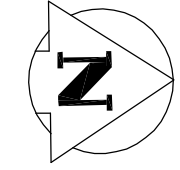
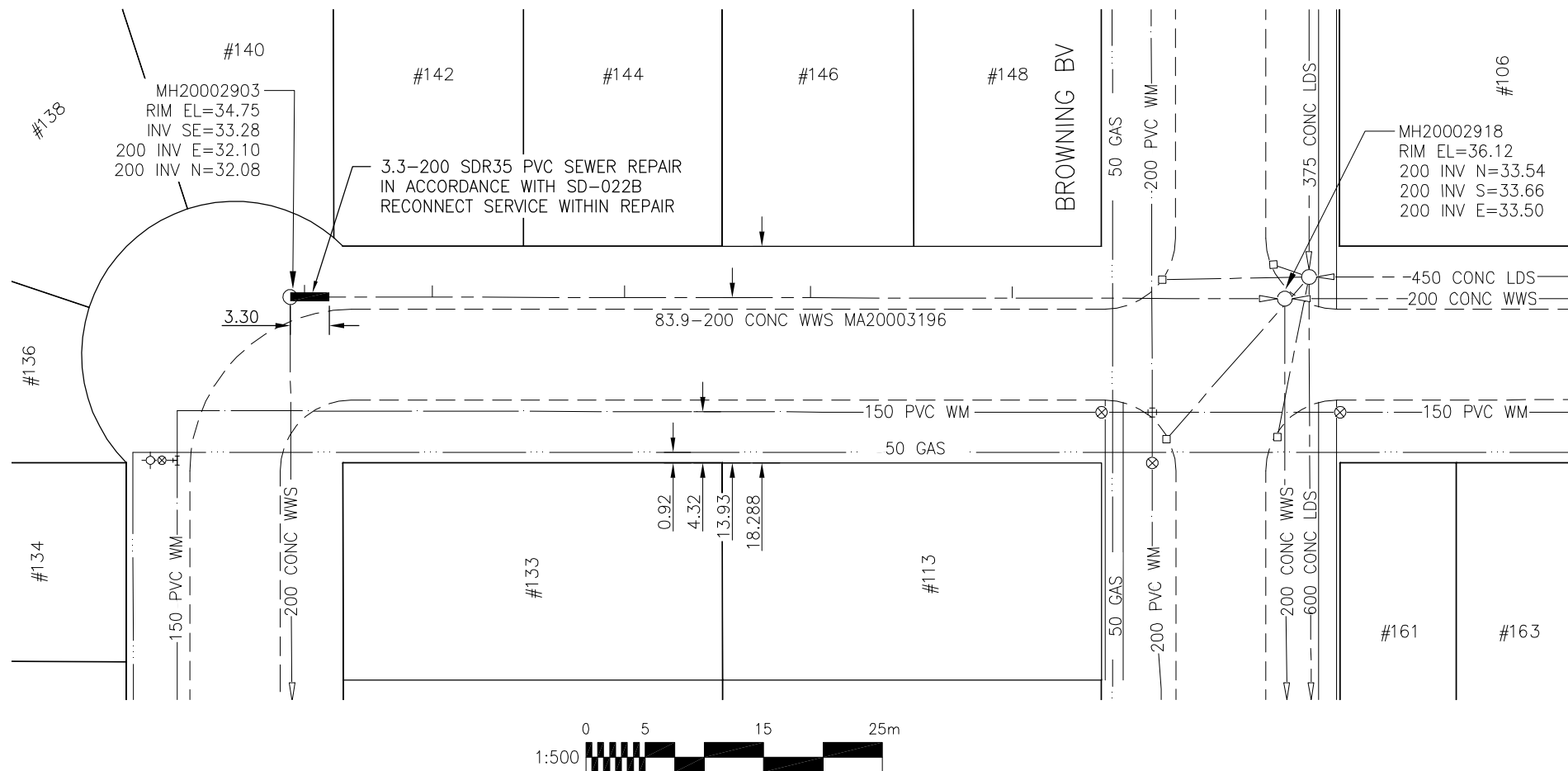

SEWER JUNCTION INFORMATION  
 FOR SEWER ID MA20003196  
 REFERENCE-METERS NORTH OF MANHOLE MH20002903

DIST. FROM REF. MH	JUNCTION DIA.	CLOCK REF.	SERVICE TYPE	DESCRIPTION
1.2	100	09	CNI	LIVE
12.0	100	10	CXI	LIVE
28.2	100	10	CNI	
43.9	100	11	CNI	LIVE
60.9	100	10	CNI	LIVE

ALL JUNCTION INFORMATION  
 BASED ON CCTV INSPECTION

## METRIC

WHOLE NUMBERS INDICATE MILLIMETRES  
 DECIMALIZED NUMBERS INDICATE METRES

BENCH MARK: N. side Browning Blvd., E. of of  
 Wordsworth Way, Tblt. in W. Conc. foundation of Robert  
 Browning School, No. 130 Browning Blvd., 0.3 m N. & 0.1 m  
 below brick of S.W. Cor. of school.



Certificate of Authorization  
 Stantec Consulting Ltd.  
 No. 1301 Date: \_\_\_\_\_

BID OPPORTUNITY 911-2011

LOCATION APPROVED  
 UNDERGROUND STRUCTURES

SUPV. U/G STRUCTURES COMMITTEE DATE

NOTE:  
 LOCATION OF UNDERGROUND STRUCTURES AS SHOWN ARE BASED ON THE BEST INFORMATION AVAILABLE BUT NO GUARANTEE IS GIVEN THAT ALL EXISTING UTILITIES ARE SHOWN OR THAT THE GIVEN LOCATIONS ARE EXACT. CONFIRMATION OF EXISTENCE AND EXACT LOCATION OF ALL SERVICES MUST BE OBTAINED FROM THE INDIVIDUAL UTILITIES BEFORE PROCEEDING WITH CONSTRUCTION.

B.M.	41-17		
ELEV.	237.555m		
NO.	REVISIONS	DATE	BY



**Stantec Consulting Ltd.**

905 Waverley Street, Winnipeg, Manitoba  
 Tel 204-489-5900 Fax 204-453-9012

DESIGNED BY	J.C	CHECKED BY	W.A.B.
DRAWN BY	D.L.	APPROVED BY	H.A.K.
HOR. SCALE:	1:500	RELEASED FOR CONSTRUCTION:	
VERTICAL:	N/A	DATE	
DATE	11.09.01	DATE	

ENGINEER'S SEAL

CONSULTANT DRAWING NO.  
 C-150



**THE CITY OF WINNIPEG**  
**WATER AND WASTE DEPARTMENT**

2011 SEWER RENEWALS  
 AND EXTERNAL POINT REPAIRS  
 CONTRACT NO. 18

WORDSWORTH WAY (WEST LEG)  
 1ST MH S OF BROWNING BV TO MH AT BROWNING BV  
 200 WWS POINT REPAIR

SHEET	OF
57	58
CAD FILE DRAWING NUMBER 13090c-150-768.dwg	
CITY DRAWING NUMBER 9764	

V:\1112\active\111213090\drawing\402\_design\sheet\_files\13090c-150-768-Wordsworth.dwg  
 2011 December 07, 9:24 a.m.