

RIEL AVENUE

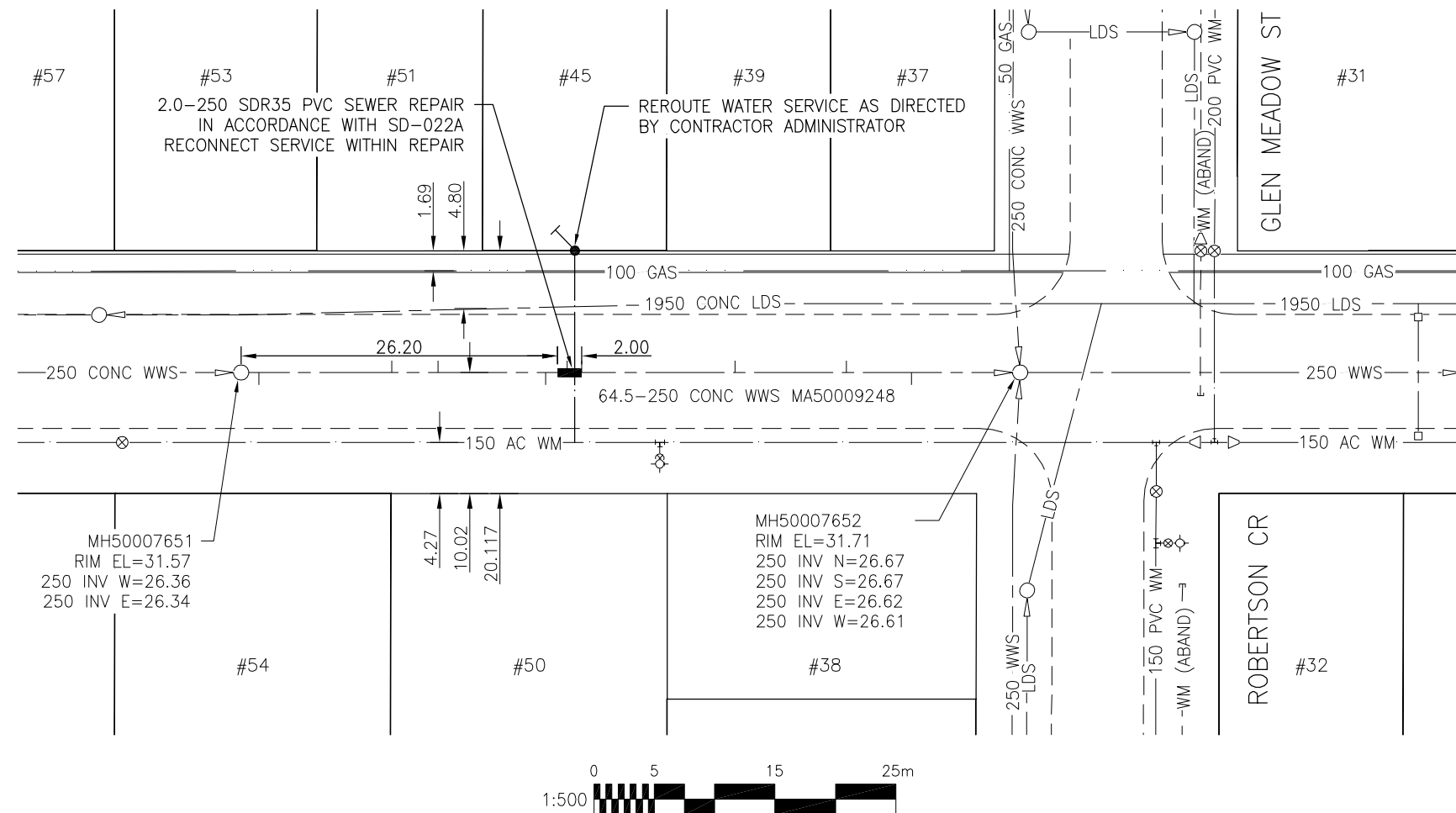

SEWER JUNCTION INFORMATION
FOR SEWER ID MA50009248
REFERENCE—METERS EAST OF MANHOLE MH50007651

DIST. FROM REF. MH	JUNCTION DIA.	CLOCK REF.	SERVICE TYPE	DESCRIPTION
1.5	150	01	CN	
12.5	150	11	CN	
16.3	150	12	CNI	
25.2	150	01	CN	
27.0	150	10	JN	
28.2	150	12	JN	CAPPED
40.9	150	11	JN	
50.1	150	11	JN	
55.5	150	01	CNI	

ALL JUNCTION INFORMATION
BASED ON CCTV INSPECTION

MH50007651
RIM EL=31.57
250 INV W=26.36
250 INV E=26.34

MH50007652
RIM EL=31.71
250 INV N=26.67
250 INV S=26.67
250 INV E=26.62
250 INV W=26.61

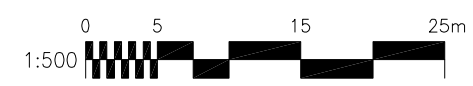

WATER SERVICE INFORMATION

ADDRESS	SIZE & TYPE STREET	SIZE & TYPE PROPERTY	STOP COCK LOCATION SHORT & LONG	CORP LOCATION FROM STOP COCK	REMARKS
#45 RIEL AV RESIDENTIAL			5.5 WEL HOUSE		

METRIC

WHOLE NUMBERS INDICATE MILLIMETRES
DECIMALIZED NUMBERS INDICATE METRES

BENCH MARK: N.W. Cor. St. Mary's Rd. & Riel Ave., Tbit.
on top of 0.05 m dia. x 2.4 m iron pipe, 0.6 m W. of
W.L. of St. Mary's Rd. & 3.2 m S. of N.L. of Riel Ave.

APEGM
Certificate of Authorization
Stantec Consulting Ltd.
No. 1301 Date: _____

BID OPPORTUNITY 911-2011

LOCATION APPROVED UNDERGROUND STRUCTURES

SUPV. U/G STRUCTURES COMMITTEE DATE

NOTE:
LOCATION OF UNDERGROUND STRUCTURES AS SHOWN ARE BASED ON THE BEST INFORMATION AVAILABLE BUT NO GUARANTEE IS GIVEN THAT ALL EXISTING UTILITIES ARE SHOWN OR THAT THE GIVEN LOCATIONS ARE EXACT. CONFIRMATION OF EXISTENCE AND EXACT LOCATION OF ALL SERVICES MUST BE OBTAINED FROM THE INDIVIDUAL UTILITIES BEFORE PROCEEDING WITH CONSTRUCTION.

B.M. ELEV.	63-20 232.016m		
NO.	REVISIONS	DATE	BY

Stantec Consulting Ltd.
905 Waverley Street, Winnipeg, Manitoba
Tel 204-489-5900 Fax 204-453-9012

DESIGNED BY	J.C	CHECKED BY	W.A.B.
DRAWN BY	D.L.	APPROVED BY	H.A.K.
HOR. SCALE:	1:500	RELEASED FOR CONSTRUCTION:	
VERTICAL:	N/A	DATE	
NO.	REVISIONS	DATE	BY
		11.09.01	

ENGINEER'S SEAL

CONSULTANT DRAWING NO.
C-132

THE CITY OF WINNIPEG
WATER AND WASTE DEPARTMENT

2011 SEWER RENEWALS AND EXTERNAL POINT REPAIRS CONTRACT NO. 18
RIEL AVENUE
1ST MH W OF ROBERTSON CR TO MH AT ROBERTSON CR
250 WWS POINT REPAIR

SHEET OF	39 OF 58
CAD FILE DRAWING NUMBER	13090c-132-768.dwg
CITY DRAWING NUMBER	9747

V:\1112\active\111213090\drawing\402_design\sheet_files\13090c-132-768-Riel.dwg
2011 December 07, 9:19 a.m.