

ELM PARK ROAD

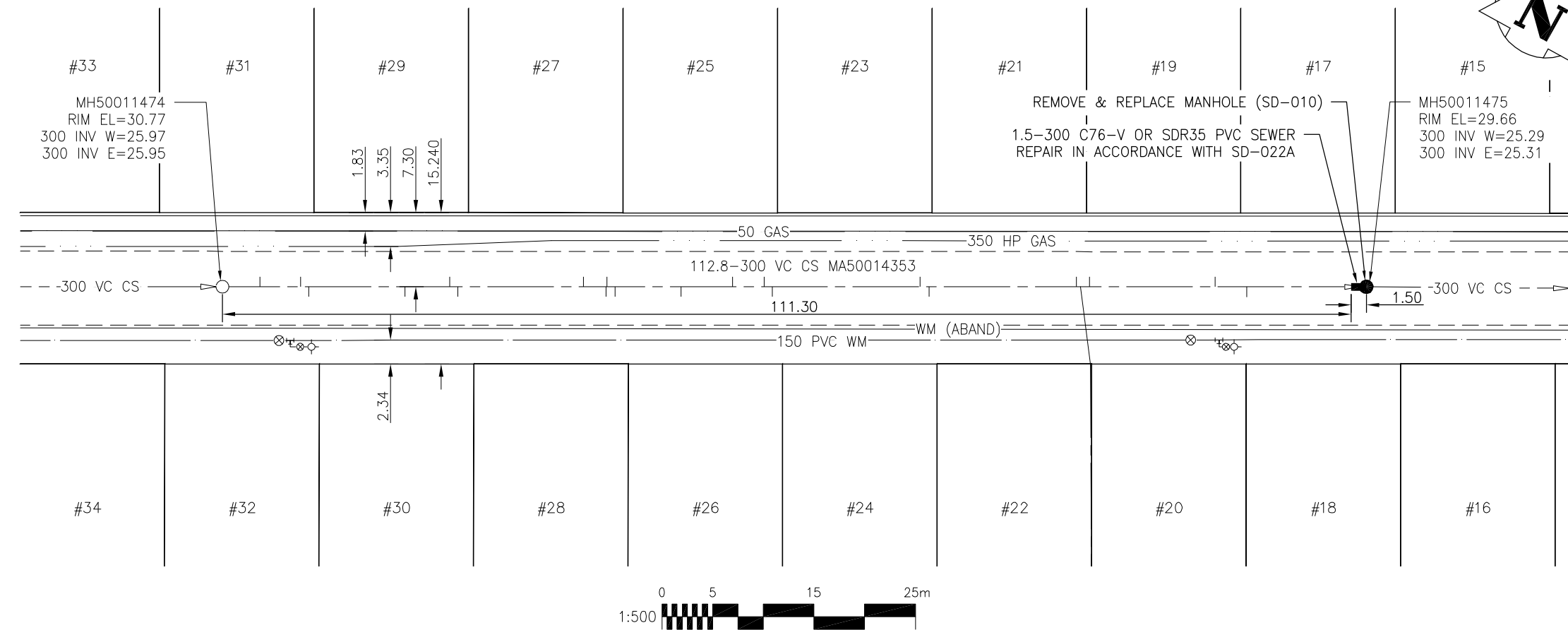

SEWER JUNCTION INFORMATION
FOR SEWER ID MA50014353
REFERENCE—METERS WEST OF MANHOLE MH50011475

DIST. FROM REF. MH	JUNCTION DIA.	CLOCK REF.	SERVICE TYPE	DESCRIPTION
11.8	150	10	JN	
14.9	150	02	JN	CAPPED
26.5	150	11	CN	
27.3	150	03	JN	CAPPED
28.2	150	09	CNI	LIVE

SEWER JUNCTION INFORMATION
FOR SEWER ID MA50014353
REFERENCE—METERS EAST OF MANHOLE MH50011474

DIST. FROM REF. MH	JUNCTION DIA.	CLOCK REF.	SERVICE TYPE	DESCRIPTION
3.7	150	10	CNI	LIVE
7.7	150	09	JN	CAPPED
8.5	150	02	CXI	LIVE
18.0	150	01	CXI	LIVE
22.4	150	10	JN	
23.2	150	02	JN	CAPPED
35.6	150	10	CXI	LIVE
37.8	150	01	CXI	LIVE
37.9	150	09	JN	CAPPED
38.7	150	02	JN	CAPPED
45.2	150	02	CXI	LIVE
50.3	150	10	CNI	LIVE
53.4	150	10	JN	CAPPED
54.2	150	01	JN	CAPPED
68.8	150	09	JN	
69.7	150	02	JN	
84.2	150	10	CNI	LIVE
84.3	200	03	CNI	LIVE

ALL JUNCTION INFORMATION
BASED ON CCTV INSPECTION



METRIC

WHOLE NUMBERS INDICATE MILLIMETRES
DECIMALIZED NUMBERS INDICATE METRES

BENCH MARK: S.W. Cor. Kingston Row & Killarney St., Tblt. on top of 0.05 m dia. x 2.4 m iron pipe, 1.4 m N. of S.L. Kingston Row & 11.6 m W. of E.L. Killarney St.



Certificate of Authorization
Stantec Consulting Ltd.
No. 1301 Date: _____

BID OPPORTUNITY 911-2011

LOCATION APPROVED
UNDERGROUND STRUCTURES

SUPV. U/G STRUCTURES COMMITTEE DATE

NOTE:
LOCATION OF UNDERGROUND STRUCTURES AS SHOWN ARE BASED ON THE BEST INFORMATION AVAILABLE BUT NO GUARANTEE IS GIVEN THAT ALL EXISTING UTILITIES ARE SHOWN OR THAT THE GIVEN LOCATIONS ARE EXACT. CONFIRMATION OF EXISTENCE AND EXACT LOCATION OF ALL SERVICES MUST BE OBTAINED FROM THE INDIVIDUAL UTILITIES BEFORE PROCEEDING WITH CONSTRUCTION.

B.M. ELEV.	54-21 230.874m		
NO.	REVISIONS	DATE	BY



Stantec Consulting Ltd.

905 Waverley Street, Winnipeg, Manitoba
Tel 204-489-5900 Fax 204-453-9012

DESIGNED BY	J.C	CHECKED BY	W.A.B.
DRAWN BY	D.L.	APPROVED BY	H.A.K.
HOR. SCALE:	1:500	RELEASED FOR CONSTRUCTION:	
VERTICAL:	N/A	DATE	
NO.	REVISIONS	DATE	BY
		11.09.01	

ENGINEER'S SEAL

CONSULTANT DRAWING NO.
C-110



THE CITY OF WINNIPEG WATER AND WASTE DEPARTMENT

2011 SEWER RENEWALS
AND EXTERNAL POINT REPAIRS
CONTRACT NO. 18
ELM PARK ROAD
3RD MH E OF KILLARNEY ST TO 1ST MH W OF ST MARY'S RD
300 CS POINT REPAIR

SHEET	OF
17	58
CAD FILE DRAWING NUMBER 13090c-110-768.dwg	
CITY DRAWING NUMBER 9727	

V:\1112\active\111213090\drawing\402_design\sheet_files\13090c-110-768-Elm_Park.dwg
2011 December 07, 9:12 a.m.