

ADDRESS	SIZE	PROPERTY LINE LOCATION	JUNCTION LOCATION
746 VICTOR RESIDENTIAL	NO INFO AVAILABLE	NO INFO AVAILABLE	NO INFO AVAILABLE
748 & 752 VICTOR RESIDENTIAL	NO INFO AVAILABLE	NO INFO AVAILABLE	NO INFO AVAILABLE
754 VICTOR RESIDENTIAL	NO INFO AVAILABLE	NO INFO AVAILABLE	NO INFO AVAILABLE
758 VICTOR RESIDENTIAL	NO INFO AVAILABLE	NO INFO AVAILABLE	NO INFO AVAILABLE
762 VICTOR RESIDENTIAL	NO INFO AVAILABLE	NO INFO AVAILABLE	NO INFO AVAILABLE
740 VICTOR RESIDENTIAL	NO INFO AVAILABLE	NO INFO AVAILABLE	NO INFO AVAILABLE

ADDRESS	SIZE (mm) & TYPE (STREET)	DIST TO PROP	SHORT & LONG MEASUREMENT	CRP MEASUREMENT
746 VICTOR RESIDENTIAL	19 COPPER	NO INFO AVAILABLE	2.1 SNL HSE 31.1>NNL WELLINGTON	OPP. S/C
748 & 752 VICTOR RESIDENTIAL	16 LEAD	NO INFO AVAILABLE	4.1 NSL HSE	OPP. S/C
754 VICTOR RESIDENTIAL	16 LEAD	NO INFO AVAILABLE	2.7 WM. FRONT DOOR 60.4>NNL WELLINGTON	1.1 N S/C
758 VICTOR RESIDENTIAL	19 COPPER	NO INFO AVAILABLE	1.8 S/NNL	OPP. S/C
762 VICTOR RESIDENTIAL	19 COPPER	NO INFO AVAILABLE	2.1>NNL HSE 84.1>NNL WELLINGTON	1.5 N S/C
740 VICTOR RESIDENTIAL	19 COPPER	NO INFO AVAILABLE	0.15 N N/BL 0.0 N N/LL	OPP. S/C

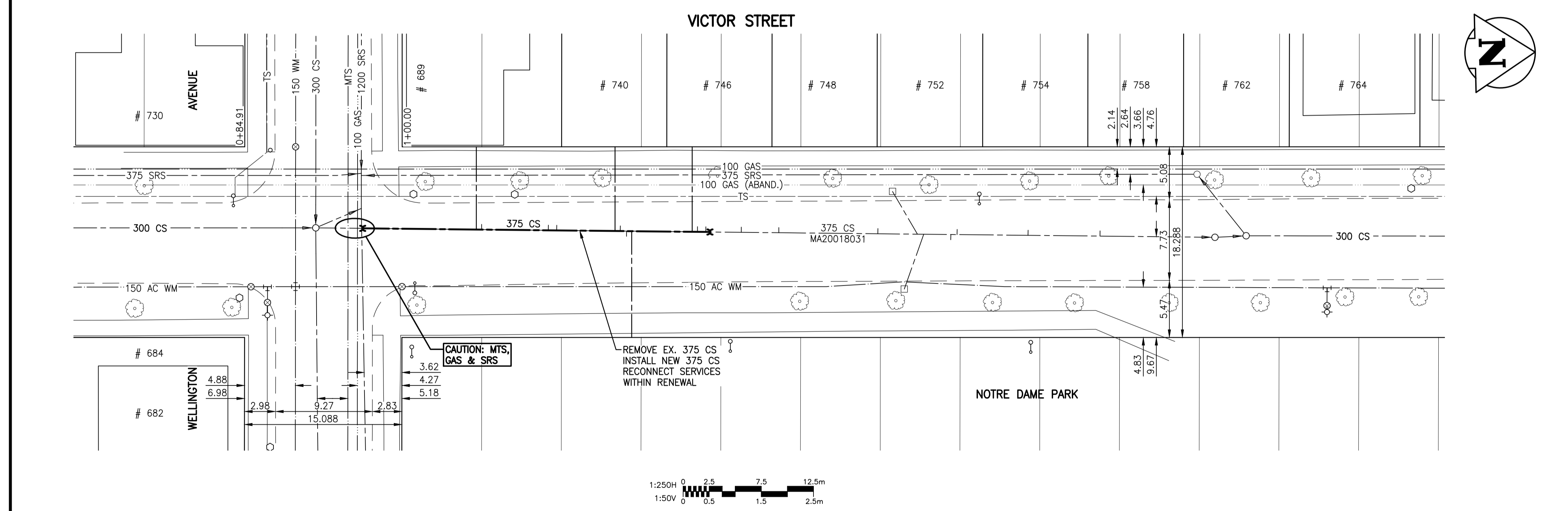

WARNING
IF POWER EQUIPMENT OR EXPLOSIVES ARE TO BE USED FOR EXCAVATION ON THIS PROJECT THE CONTRACTOR MUST:
1) NOTIFY THE GAS COMPANY OF THE PROPOSED LOCATION OF EXCAVATION.
2) TAKE PRECAUTION TO AVOID DAMAGE TO GAS COMPANY INSTALLATIONS.
SEE PROVINCIAL REGULATION 140/92 FOR DETAILS

METRIC
WHOLE NUMBERS INDICATE MILLIMETRES
DECIMALIZED NUMBERS INDICATE METRES

BENCH MARK: N. side Notre Dame Ave. Btwn. Sherbrook St. & Pearl St., Tblt. in Wly. wing wall on production Sly. of W. wall of No. 677 Notre Dame Ave. (Health Sciences Power House), 0.2 m E. & 0.25 m below precast stone finish of wing wall.

150 WM	WATERMAIN	150 WM	CONNECTION	150 WM	WATERMAIN	150 WM	LOCATION APPROVED UNDERGROUND STRUCTURES
+	HYDRANT	+	JUNCTIONS	+	HYDRANT, VALVE	+	SUPV. U/G STRUCTURES COMMITTEE DATE _____ NOTE: LOCATION OF UNDERGROUND STRUCTURES AS SHOWN ARE BASED ON THE BEST INFORMATION AVAILABLE BUT NO GUARANTEE IS GIVEN THAT ALL EXISTING UTILITIES ARE SHOWN OR THAT THE GIVEN LOCATIONS ARE EXACT. CONFIRMATION OF EXISTENCE AND EXACT LOCATION OF ALL SERVICES MUST BE OBTAINED FROM THE INDIVIDUAL UTILITIES BEFORE PROCEEDING WITH CONSTRUCTION.
⊙	VALVE	⊙	GAS	⊙	LAND DRAINAGE SEWER	⊙	
-	LAND DRAINAGE SEWER	-	HYDRO	-	STORM RELIEF SEWER	-	
⊖	STORM RELIEF SEWER	⊖	M.T.S.	⊖	COMBINED SEWER	⊖	
⊕	COMBINED SEWER	⊕	TRAFFIC SIGNALS	⊕	WASTE WATER SEWER	⊕	
⊗	WASTE WATER SEWER	⊗	PROPERTY LINE	⊗	WASTE WATER SEWER	⊗	
○	MANHOLE	○	SURVEY BAR	○	Q PROFILE	○	
□	CATCH BASIN	□	STREET LIGHT	□		□	
▽	CURB INLET	▽	REDUCER	▽		▽	
⊔	PLUG	⊔	SIGN	⊔		⊔	
—	EXISTING	—	LEGEND-PLAN	—	PROPOSED	—	
- - -	LEGEND-PLAN	- - -	EXISTING	- - -	LEGEND-PROFILE	- - -	
---	PROPOSED	---	EXISTING	---	PROPOSED	---	

B.M.	35-054	ENGINEER'S SEAL	
ELEV.	232.783m	DATE	
DESIGNED BY	J.C.	CHECKED BY	W.W.B.
DRAWN BY	W.A.	APPROVED BY	H.A.K.
HOR. SCALE:	1:250	RELEASED FOR CONSTRUCTION:	
VERTICAL:	1:50	DATE	11.09.20
NO. REVISIONS		DATE	
		BY	

Stantec Consulting Ltd.
905 Waverley Street, Winnipeg, Manitoba
Tel 204-489-5900 Fax 204-453-9012

CONSULTANT DRAWING NO. **C-205**

THE CITY OF WINNIPEG
WATER AND WASTE DEPARTMENT
ENGINEERING DIVISION

2011 SEWER RENEWALS AND EXTERNAL POINT REPAIRS CONTRACT 18
VICTOR STREET (CL) - MH AT WELLINGTON AV TO 1ST MH N OF WELLINGTON AV
375 CS RENEWAL

SHEET **7** OF **58**
CAD FILE DRAWING NUMBER **13090c-205-768.dwg**
CITY DRAWING NUMBER **9717**

APEGM
Certificate of Authorization
Stantec Consulting Ltd.
No. 1301 Date: _____

BID OPPORTUNITY NO. 911-2011

\\s11\2\proj\11111308\dwg\11111308.dwg; \\s11\2\proj\11111308\design\11111308.dwg; \\s11\2\proj\11111308\11111308.dwg; \\s11\2\proj\11111308\11111308.dwg