

1 PHASE 2A AM

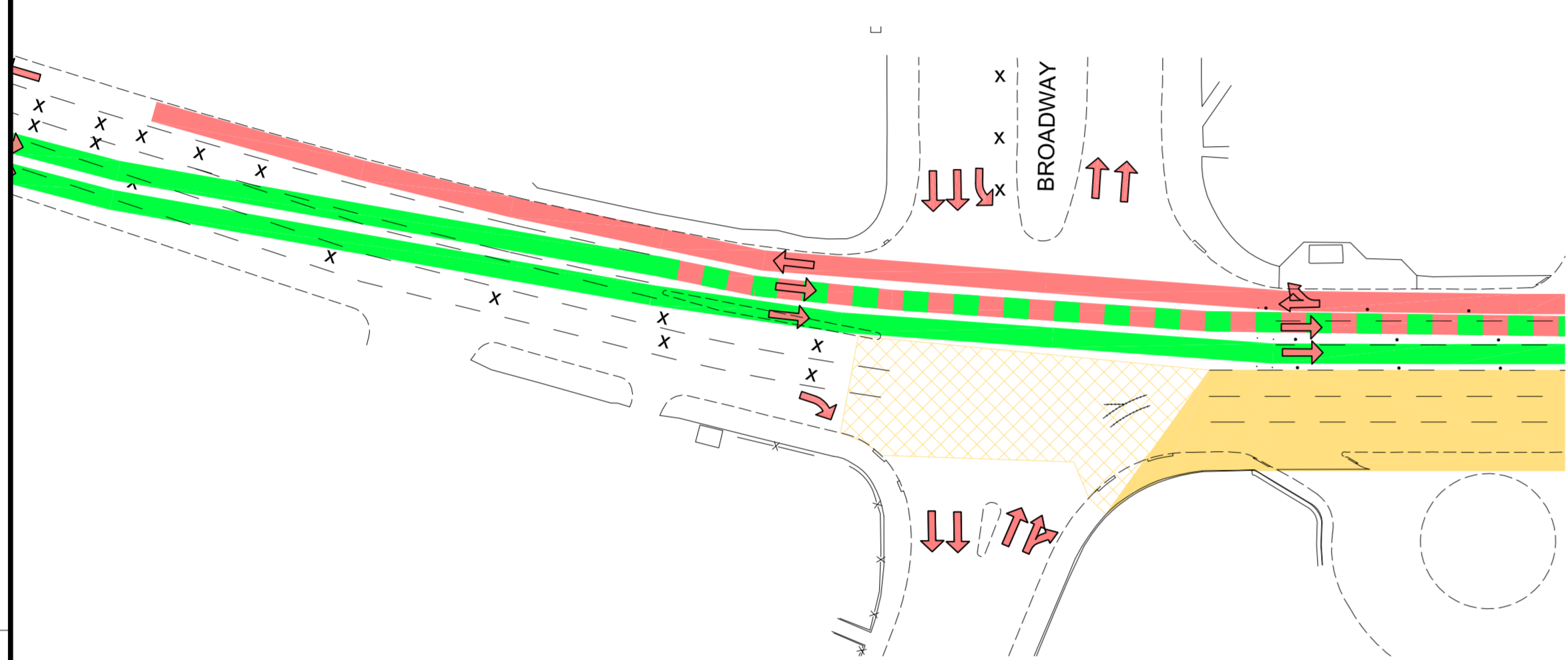

2 PHASE 2A AM

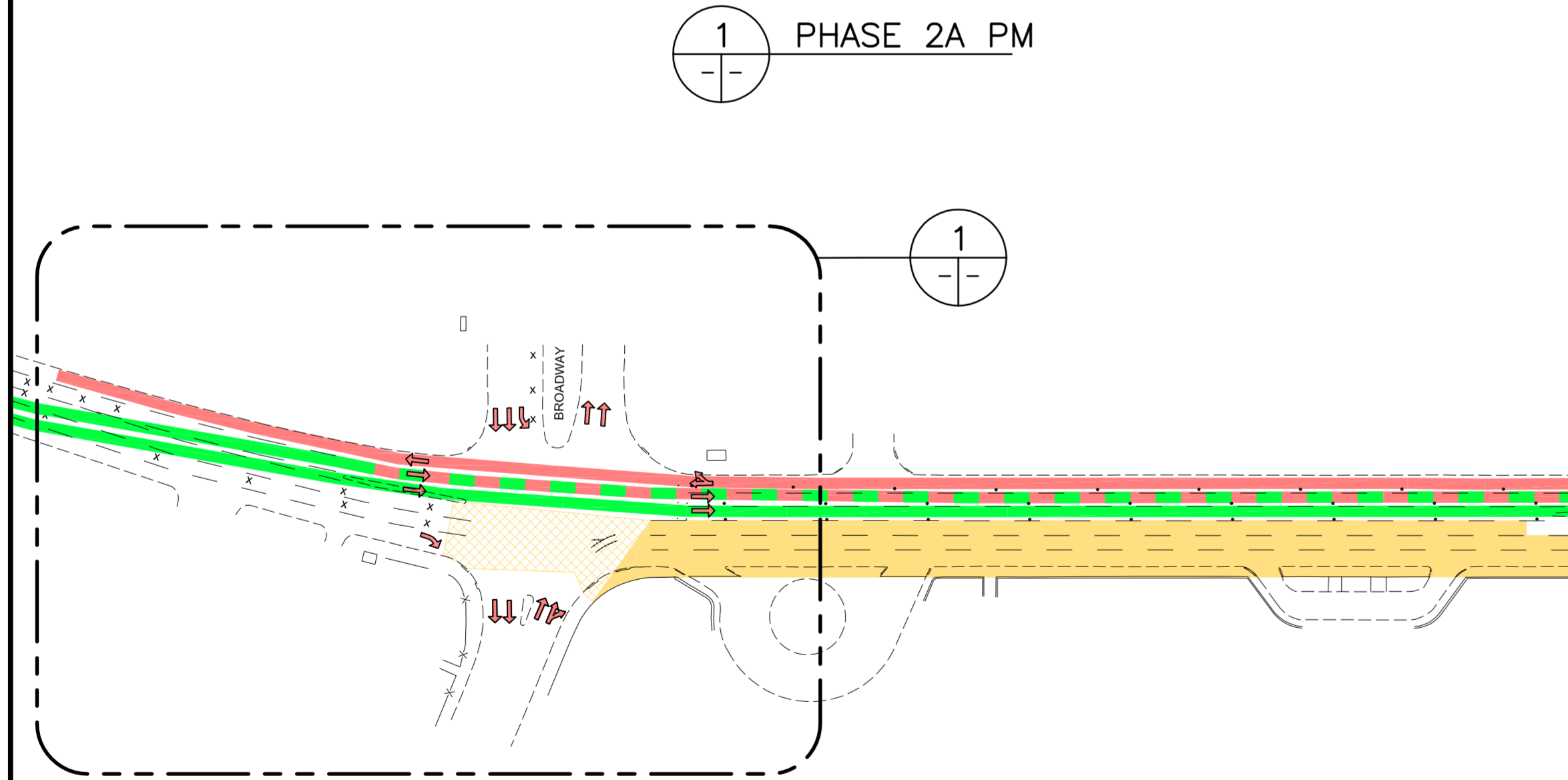

1 PHASE 2A PM



2 PHASE 2A PM

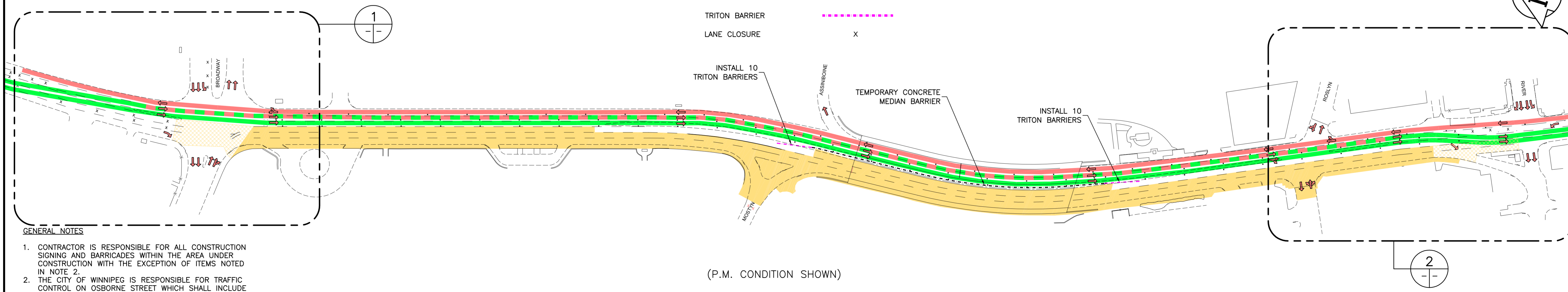

(P.M. CONDITION SHOWN)

TRAFFIC CONTROL AND CONSTRUCTION
PHASE 2A: SPRING, SUMMER & FALL 2012

TRAFFIC CONTROL

- A. CLOSURES AND RESTRICTIONS:
 - CLOSURE OSBORNE SOUTHBOUND LANES FROM BROADWAY TO JUST NORTH OF RIVER. (SEE NOTE 3 BELOW)
- B. -OSBORNE NORTHBOUND LEFT TURN LANE AT BROADWAY - TURN NOT PERMITTED.
 - BROADWAY WESTBOUND DOUBLE LEFT AT BROADWAY REDUCED TO ONE LANE
 - OSBORNE SOUTHBOUND AND NORTHBOUND LEFT TURN TO ROSLYN - NOT PERMITTED.
 - ROSLYN WESTBOUND LEFT TURN MOVEMENT ONTO OSBORNE NOT PERMITTED
- C. OSBORNE TRAFFIC REDUCED TO THREE LANES WITH CENTER LANE REVERSING BETWEEN A.M. AND P.M. PEAK.
 - A.M. PEAK PERIOD APPROX. 6:00 A.M. TO 10:00 A.M., TWO LANES NORTHBOUND ONE LANE SOUTHBOUND
 - P.M. PEAK PERIOD APPROX. 10:00 A.M. TO 6:00 A.M., TWO LANES SOUTHBOUND ONE LANE NORTHBOUND.
- D. PEDESTRIAN TRAFFIC OPEN EAST SIDEWALK, CLOSED WEST SIDEWALK
- E. PATH UNDER BRIDGE OPEN
- F. TRANSIT DIAMOND LANE AND RIGHT LANE MUST TURN RIGHT RESTRICTIONS ON SOUTHBOUND OSBORNE BETWEEN AND INCLUDING ST. MARY AVENUE TO BROADWAY AVENUE TEMPORARILY RESCINDED
- G. PARKING AND LOADING TEMPORARILY RESCINDED ON SB OSBORNE BETWEEN YORK AND BROADWAY AND REPLACED WITH NO STOPPING ANYTIME

MAJOR CONSTRUCTION ACTIVITIES

1. SOUTHBOUND BRIDGE DEMOLITION AND REHABILITATION
2. REHABILITATION OF OSBORNE SOUTHBOUND LANES AND SIDEWALK FROM BROADWAY TO RIVER AVENUE WITH EXCEPTION OF MEDIAN LANE BETWEEN MOSTYN AND RIVER. THIS SECTION WHICH WILL BE COMPLETED IN NEXT PHASE. REHABILITATION OF OSBORNE JUST NORTH OF RIVER AVENUE AND WITHIN BROADWAY INTERSECTION TO BE CARRIED OUT LANE AT A TIME IN ORDER TO MAINTAIN TWO LANES OF TRAFFIC NORTHBOUND DURING A.M. PEAK AND MIN. ONE LANE NORTHBOUND AND SOUTHBOUND THROUGH BROADWAY INTERSECTION.
3. CONSTRUCTION OF LANE AT A TIME REPAIRS LOCATED JUST NORTH OF RIVER AVE TO BE COMPLETED WITHIN A TWO WEEK TIME FRAME AND MUST BE UNDERTAKEN WITHIN THE MONTHS OF JULY OR AUGUST.

LEGEND

NORTHBOUND TRAVEL LANE	
SOUTHBOUND TRAVEL LANE	
NORTHBOUND AM SOUTHBOUND PM TRAVEL LANE	
CONSTRUCTION AREA	
LANE AT A TIME CONSTRUCTION	
POLY POSTS	
TEMPORARY CONCRETE MEDIAN BARRIER	
TRITON BARRIER	
LANE CLOSURE	X

GENERAL NOTES

1. CONTRACTOR IS RESPONSIBLE FOR ALL CONSTRUCTION SIGNING AND BARRICADES WITHIN THE AREA UNDER CONSTRUCTION WITH THE EXCEPTION OF ITEMS NOTED IN NOTE 2.
2. THE CITY OF WINNIPEG IS RESPONSIBLE FOR TRAFFIC CONTROL ON OSBORNE STREET WHICH SHALL INCLUDE INSTALLATION OF POLY POST LANE DELINEATION BETWEEN NORTHBOUND AND SOUTHBOUND LANES, CLOSURE OF LANES NORTH OF BROADWAY AND SOUTH OF RIVER, TURNING RESTRICTIONS ON BROADWAY, ROSLYN AND RIVER, ALL REGULATORY SIGNAGE, TRAFFIC SIGNAL MODIFICATIONS (TEMPORARY SIGNAL POLES AND INDICATORS), AND SWITCHING OF REVERSIBLE LANES SIGNAGE AND LANE DELINEATION ON OSBORNE FOR A.M. P.M. RECONFIGURATION.
3. MAINTAIN ACCESS FOR EMERGENCY VEHICLES TO MOSTYN PL.
4. MAINTAIN ACCESS TO ALL BUS STOPS.
5. MAINTAIN AT LEAST ONE PEDESTRIAN CROSSING OF OSBORNE AT EACH SIDE STREET (BROADWAY, ROSLYN AND RIVER).
6. QUADGUARD (MODEL NUMBER CZ 2403P) TO BE SUPPLIED AND INSTALLED BY CONTRACTOR ACCORDING TO MANUFACTURERS SPECIFICATIONS. THE CONTRACTOR SHALL REMOVE THE QUADGUARD AFTER PHASE 1C AND DELIVER TO CITY OF WINNIPEG YARDS.



B.M. 35-076 (N: 5527196 E: 633022.129) ELEV. 232.401	
DESIGNED BY: RTP	CHECKED BY: DBW
DRAWN BY: PMW	APPROVED BY: DPK
HOR. SCALE: NTS	RELEASED FOR CONSTRUCTION ORIGINAL DATE: 11.02.16
VERTICAL:	SIGNED: MAY 09 2011 P.M. ENGINEER
00 ISSUED FOR TENDER	11.02.18 DBW
NO. REVISIONS	DATE BY
	DATE 2011.02.18

DILLON CONSULTING

DESIGNED BY: RTP
CHECKED BY: DBW
DRAWN BY: PMW
APPROVED BY: DPK
HOR. SCALE: NTS
RELEASED FOR CONSTRUCTION ORIGINAL DATE: 11.02.16
VERTICAL: MAY 09 2011 P.M. ENGINEER



THE CITY OF WINNIPEG
PUBLIC WORKS DEPARTMENT
ENGINEERING DIVISION

OSBORNE STREET BRIDGE
REHABILITATION & RELATED WORKS

TRAFFIC STAGING - PHASE 2A

CITY DRAWING NUMBER: B109-11-135
SHEET 130 OF 131

CONSULTANT DRAWING NO.: 092530

130