

TRAFFIC CONTROL AND CONSTRUCTION
PHASE 1B: SUMMER 2011

TRAFFIC CONTROL

- A. CLOSURES AND RESTRICTIONS:
 -CLOSURE OSBORNE NORTHBOUND LANES FROM BROADWAY TO RIVER.
 -OSBORNE NORTHBOUND LEFT TURN LANE AT BROADWAY - TURN NOT PERMITTED.
 -BROADWAY WESTBOUND DOUBLE LEFT AT BROADWAY REDUCED TO ONE LANE
 -OSBORNE SOUTHBOUND AND NORTHBOUND LEFT TURN TO ROSLYN - NOT PERMITTED.
 -ROSLYN WESTBOUND LEFT TURN MOVEMENTS ONTO OSBORNE NOT PERMITTED
 -TRANSIT DIAMOND LANE AND RIGHT LANE MUST TURN RIGHT
 RESTRICTIONS ON SOUTHBOUND OSBORNE BETWEEN AND INCLUDING ST. MARY'S AVENUE AND ROSLYN ROAD TEMPORARILY RESCINDED
 -PARKING AND LOADING TEMPORARILY RESCINDED ON SOUTHBOUND OSBORNE BETWEEN YORK AND BROADWAY AND REPLACED WITH NO STOPPING ANYTIME
 B. OSBORNE TRAFFIC REDUCED TO THREE LANES WITH CENTER LANE REVERSING BETWEEN A.M. AND P.M. PEAK.
 -A.M. PEAK PERIOD APPROX. 6:00 A.M. TO 10:00 A.M., TWO LANES NORTHBOUND ONE LANE SOUTHBOUND
 -P.M. PEAK PERIOD APPROX. 10:00 A.M. TO 6:00 A.M., TWO LANES SOUTHBOUND ONE LANE NORTHBOUND.
 C. PEDESTRIAN TRAFFIC OPEN WEST SIDEWALK, CLOSED EAST SIDEWALK
 D. PATH UNDER BRIDGE OPEN.
 E. TRANSIT DIAMOND LANE AND RIGHT LANE MUST TURN RIGHT
 RESTRICTIONS ON SOUTHBOUND OSBORNE BETWEEN AND INCLUDING ST. MARY AVENUE AND ROSLYN ROAD TEMPORARILY RESCINDED
 F. PARKING AND LOADING TEMPORARILY RESCINDED ON SB OSBORNE BETWEEN YORK AND BROADWAY AND REPLACED WITH NO STOPPING ANYTIME

MAJOR CONSTRUCTION ACTIVITIES

1. NORTHBOUND BRIDGE DEMOLITION AND REHABILITATION
2. REHABILITATION OF NORTHBOUND OSBORNE LANES AND SIDEWALK FROM BROADWAY TO RIVER AVENUE. REHABILITATION OF OSBORNE JUST NORTH OF RIVER AVENUE AND WITHIN BROADWAY INTERSECTION TO BE CARRIED OUT LANE AT A TIME IN ORDER TO MAINTAIN TWO LANES OF TRAFFIC NORTHBOUND DURING A.M. PEAK AND MIN. ONE LANE NORTHBOUND AND SOUTHBOUND THROUGH BROADWAY INTERSECTION.
3. PLACEMENT OF ASPHALT OVERLAY FOR NORTHBOUND LANES INCLUDES TEMPORARY ASPHALT IN MEDIAN (IF NOT DONE IN PHASE 1A) AND IN BROADWAY INTERSECTION

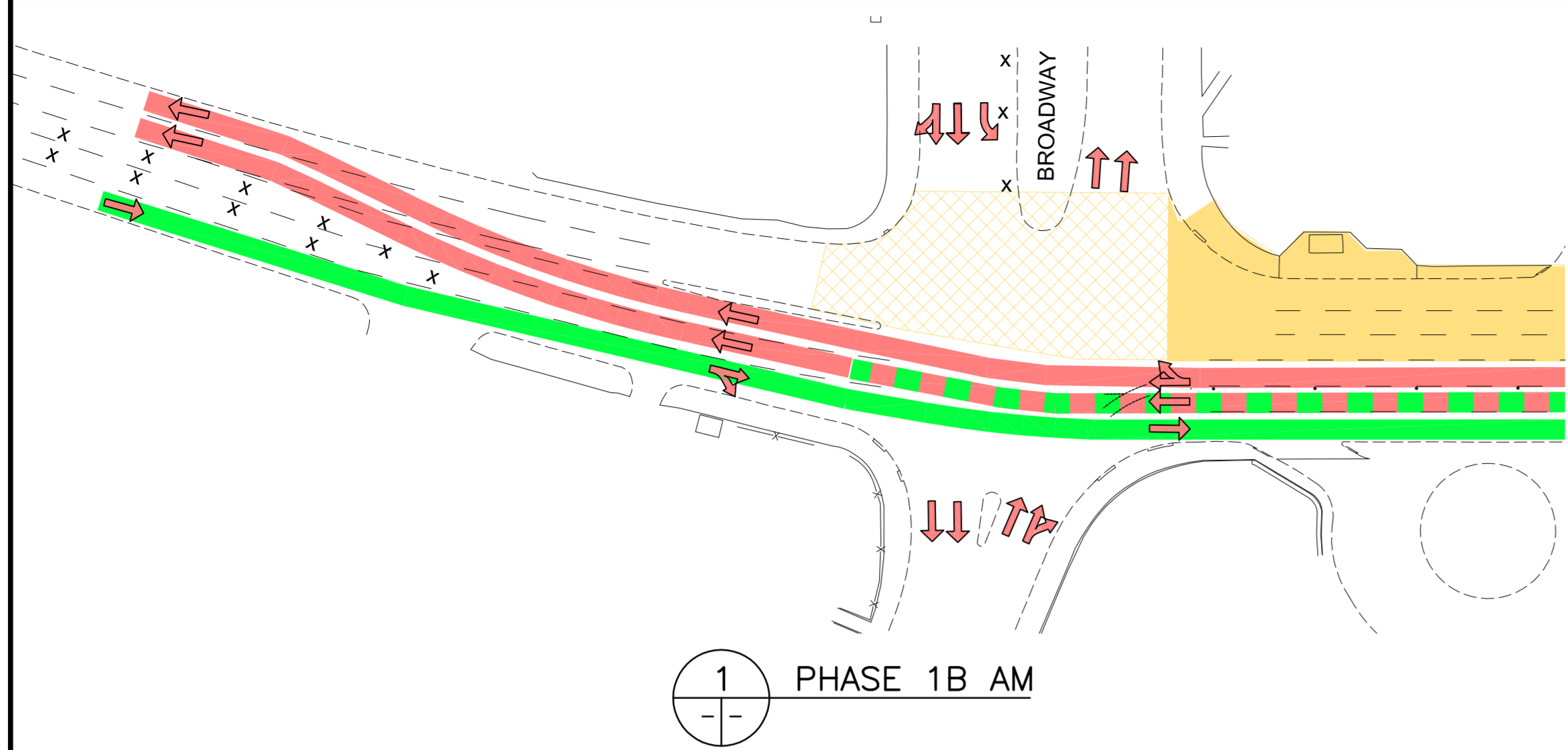

1 PHASE 1B AM

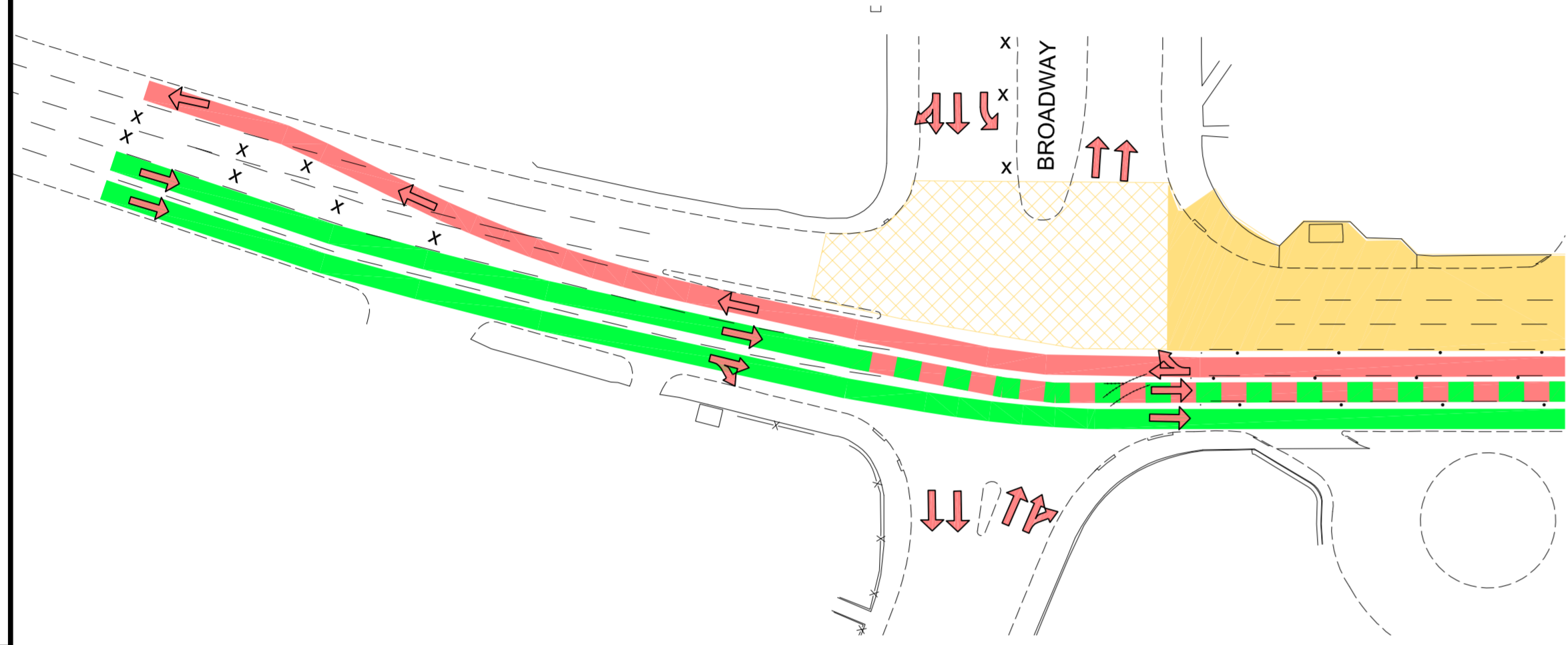

1 PHASE 1B PM

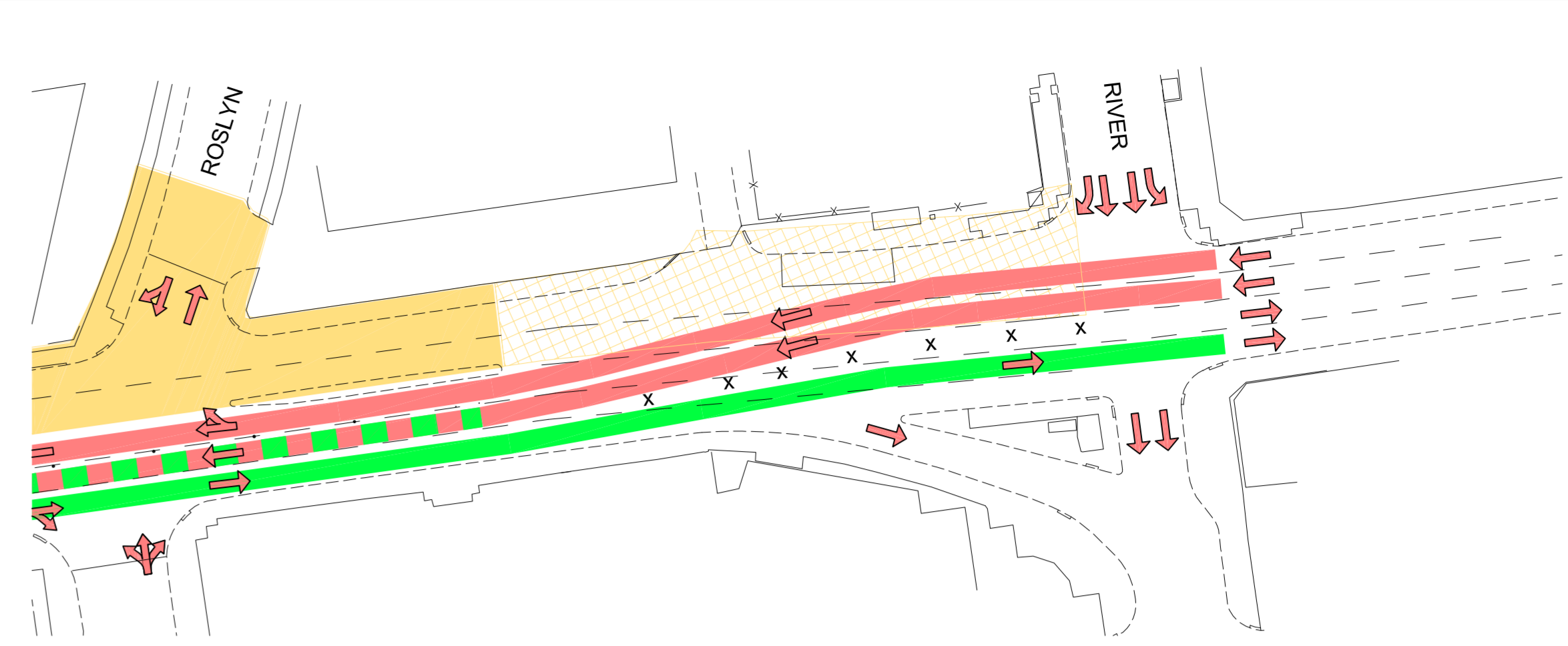

2 PHASE 1B AM

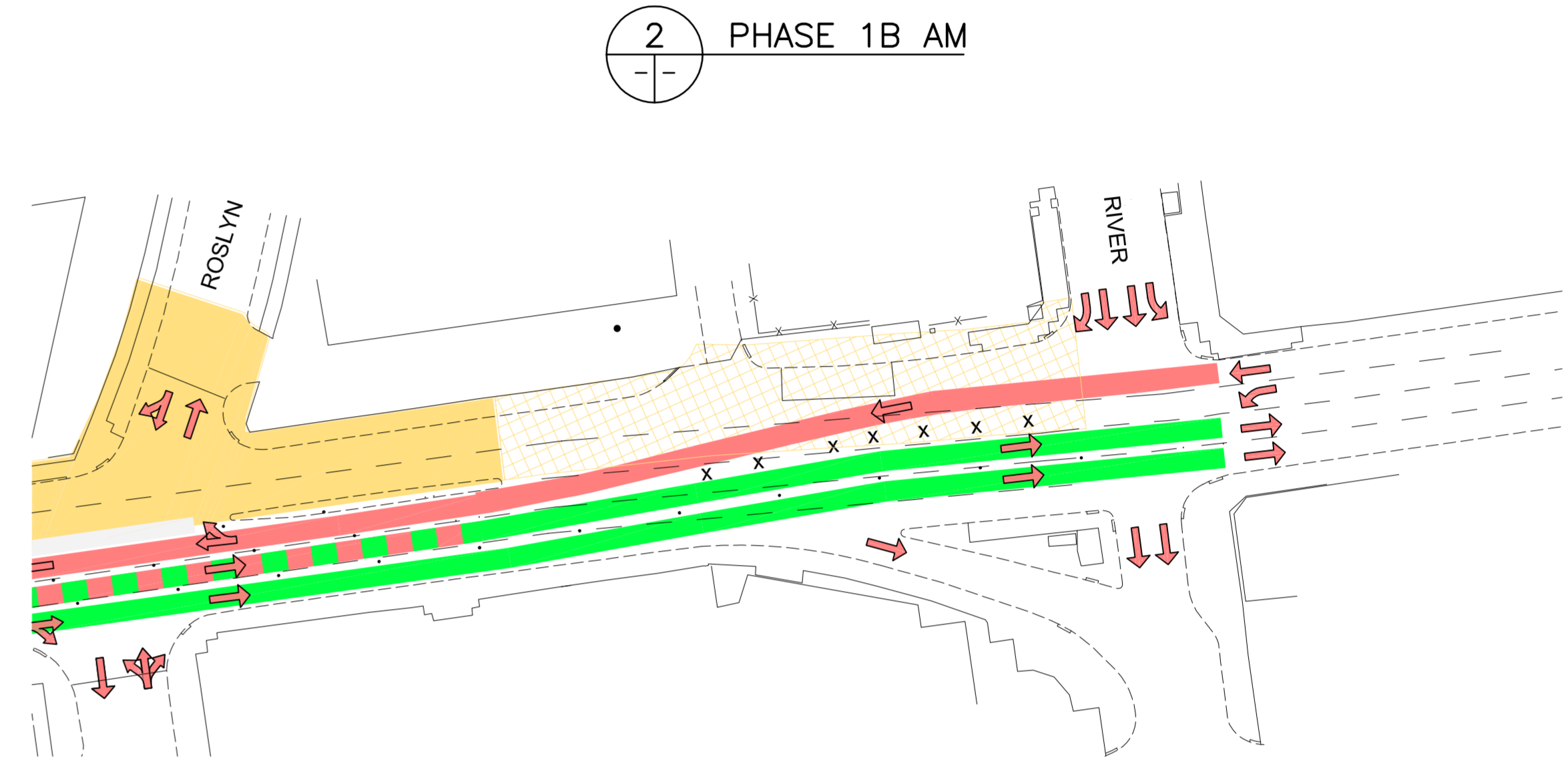

2 PHASE 1B PM

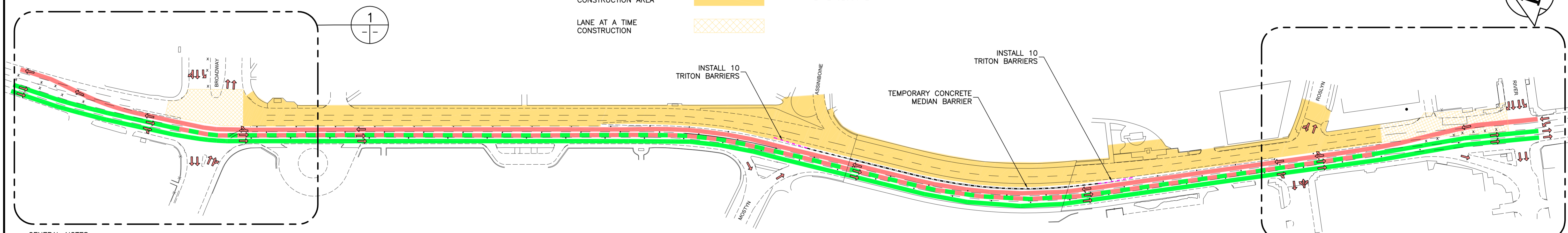

(P.M. CONDITION SHOWN)

GENERAL NOTES

1. CONTRACTOR IS RESPONSIBLE FOR ALL CONSTRUCTION SIGNING AND BARRICADES WITHIN THE AREA UNDER CONSTRUCTION WITH THE EXCEPTION OF ITEMS NOTED IN NOTE 2.
2. THE CITY OF WINNIPEG IS RESPONSIBLE FOR TRAFFIC CONTROL ON OSBORNE STREET WHICH SHALL INCLUDE INSTALLATION OF POLY POST LANE DELINEATION BETWEEN NORTHBOUND AND SOUTHBOUND LANES, CLOSURE OF LANES NORTH OF BROADWAY AND SOUTH OF RIVER, TURNING RESTRICTIONS ON BROADWAY, ROSLYN AND RIVER, ALL REGULATORY SIGNAGE, TRAFFIC SIGNAL MODIFICATIONS (TEMPORARY SIGNAL POLES AND INDICATORS), AND SWITCHING OF REVERSIBLE LANES SIGNAGE AND LANE DELINEATION ON OSBORNE FOR A.M., P.M. RECONFIGURATION.
3. MAINTAIN ACCESS FOR EMERGENCY VEHICLES TO MOSTYN PL.
4. MAINTAIN ACCESS TO ALL BUS STOPS.
5. MAINTAIN AT LEAST ONE PEDESTRIAN CROSSING OF OSBORNE AT EACH SIDE STREET (BROADWAY, ROSLYN AND RIVER).
6. QUADGUARD (MODEL NUMBER CZ 2403P) TO BE SUPPLIED AND INSTALLED BY CONTRACTOR ACCORDING TO MANUFACTURER'S SPECIFICATIONS. THE CONTRACTOR SHALL REMOVE THE QUADGUARD AFTER PHASE 1C AND DELIVER TO CITY OF WINNIPEG YARDS.



B.M. 35-076 (N: 5527196 E: 633022.129) ELEV. 232.401	
DESIGNED BY: RTP	CHECKED BY: DBW
DRAWN BY: PMW	APPROVED BY: DPK
HOR. SCALE: NTS	RELEASED FOR CONSTRUCTION ORIGINAL SIGNED DATE: 11.02.16
VERTICAL: DATE: 2011.02.18	DATE: 11.02.16
NO. REVISIONS	DATE BY
00	ISSUED FOR TENDER 11.02.18 DBW

DILLON CONSULTING

DESIGNED BY: RTP
 CHECKED BY: DBW
 DRAWN BY: PMW
 APPROVED BY: DPK
 HOR. SCALE: NTS
 VERTICAL: DATE: 2011.02.18

PROVINCE OF MANITOBA
 REGISTERED PROFESSIONAL ENGINEER
 D.B. WIEBE
 2011.02.16
 Member 22480

THE CITY OF WINNIPEG
 PUBLIC WORKS DEPARTMENT
 ENGINEERING DIVISION

OSBORNE STREET BRIDGE
 REHABILITATION & RELATED WORKS

CITY DRAWING NUMBER: B109-11-133
 SHEET 128 OF 131

CONSULTANT DRAWING NO. 092530

TRAFFIC STAGING - PHASE 1B

128