

- CONSTRUCTION NOTES FOR ROADWAY:**
1. BASE LINE = SOUTHBOUND (MEDIAN) CONTROL LINE. SEE SHEET 101 FOR CONTROL LINE GEOMETRY.
 2. FINAL CURB HEIGHT TYPICALLY 150 mm.
 3. ALL DIMENSIONS ARE TO BACK OF CURB.
 4. ADJUST OR REPLACE EXISTING DRAINAGE INLETS WITH NEW SD-024 OR SD-023 AS DIRECTED BY THE CONTRACT ADMINISTRATOR.
 5. ISOLATE MISCELLANEOUS ITEMS IN NEW CONCRETE WORKS AS PER SD-228C.
 6. PLANE HEADERS AT ALL INTERSECTING PUBLIC STREETS.
 7. LEGAL PLAN AND UNDERGROUND INFORMATION FROM CITY OF WINNIPEG LBIS.
 8. TRAFFIC SIGNAL POLES, CONTROLLERS AND UNDERGROUND APPURTENANCES IN PROJECT AREA TO BE UPGRADED BY OTHERS.
 9. CONTRACTOR TO TAKE PRECAUTIONARY STEPS TO AVOID DAMAGE FROM CONSTRUCTION ACTIVITIES TO TREES WITHIN THE LIMITS OF CONSTRUCTION.
 10. LOCATION OF EXISTING SERVICES TO BE CONFIRMED IN THE FIELD BY THE CONTRACTOR.
 11. PLANE EXISTING ASPHALT OVERLAY WITHIN CONTRACT LIMITS TO DEPTH INDICATED BY THE CONTRACT ADMINISTRATOR.
 12. LIMITS OF CURB AND GUTTER REPLACEMENT, JOINT AND SLAB REPAIRS, GRANULAR SHOULDER REGRADING, AND TIE INS TO BE FINALIZED IN THE FIELD BY THE CONTRACT ADMINISTRATOR.
 13. ADJUST ALL WATER VALVES AND MANHOLES WITHIN THE CONSTRUCTION LIMITS OF PROJECT.
 14. CONTRACTOR SHALL TAKE PRECAUTIONARY STEPS TO AVOID EXISTING SPRINKLER SYSTEM ON MANITOBA LEGISLATURE AND GREAT WEST LIFE PROPERTIES. CONTRACTOR SHALL BE RESPONSIBLE TO RESTORE AND OR REPAIR SPRINKLER SYSTEM DAMAGED BY CONSTRUCTION.

METRIC
 WHOLE NUMBERS INDICATE MILLIMETRES
 DECIMALIZED NUMBERS INDICATE METRES

WARNING
 IF POWER EQUIPMENT OR EXPLOSIVES ARE TO BE USED FOR EXCAVATION ON THIS PROJECT THE CONTRACTOR MUST:
 1. NOTIFY THE GAS COMPANY OF THE PROPOSED LOCATION OF EXCAVATION.
 2. TAKE PRECAUTION TO AVOID DAMAGE TO GAS COMPANY INSTALLATIONS SEE PROVINCIAL REGULATION 210/72 FOR DETAILS.

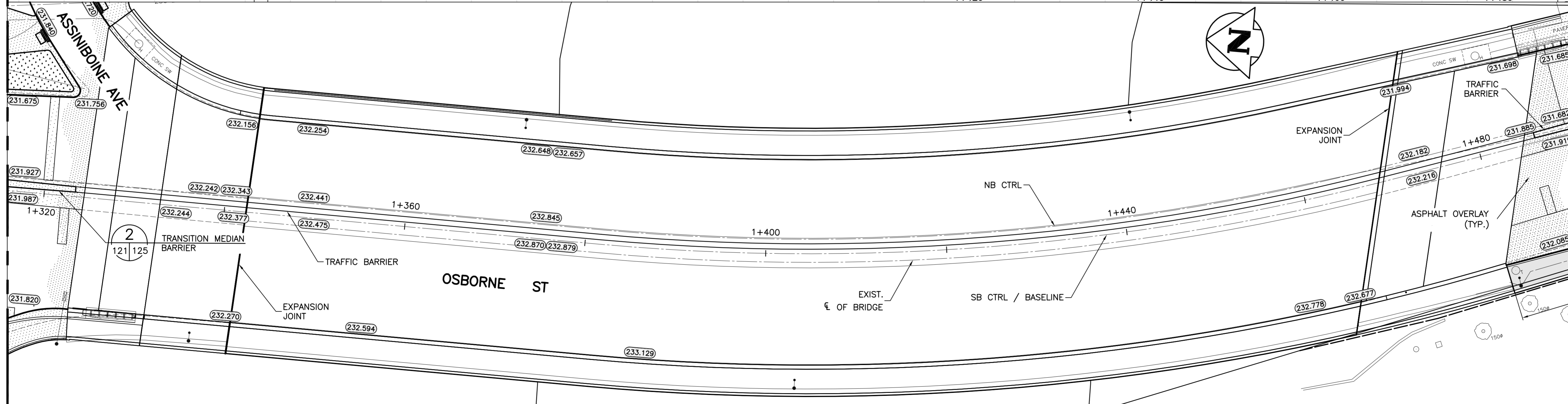

APEGM
 Certificate of Authorization
Dillon Consulting Limited (MB)
 No. 1789 Date: 2011.02.16

B.M. 35-076 (N: 5527196 E: 633022.129) ELEV. 232.401	
00	ISSUED FOR TENDER
NO.	REVISIONS

DESIGNED BY: RTP	CHECKED BY: DBW
DRAWN BY: PMW	APPROVED BY: DPK
HOR. SCALE: 1 : 250	RELEASED FOR CONSTRUCTION ORIGINAL SIGNED DATE
VERTICAL: 1 : 10	11.02.16
DATE: 2011.02.18	DATE: 2011.02.18

CONSULTANT DRAWING NO. 092530

 THE CITY OF WINNIPEG PUBLIC WORKS DEPARTMENT ENGINEERING DIVISION	CITY DRAWING NUMBER B109-11-126 SHEET 121 OF 131
OSBORNE STREET BRIDGE REHABILITATION & RELATED WORKS	
PAVING & GRADING STA: 1+315 TO 1+485	121