

MARION STREET AT DAWSON ROAD NORTH

1:500

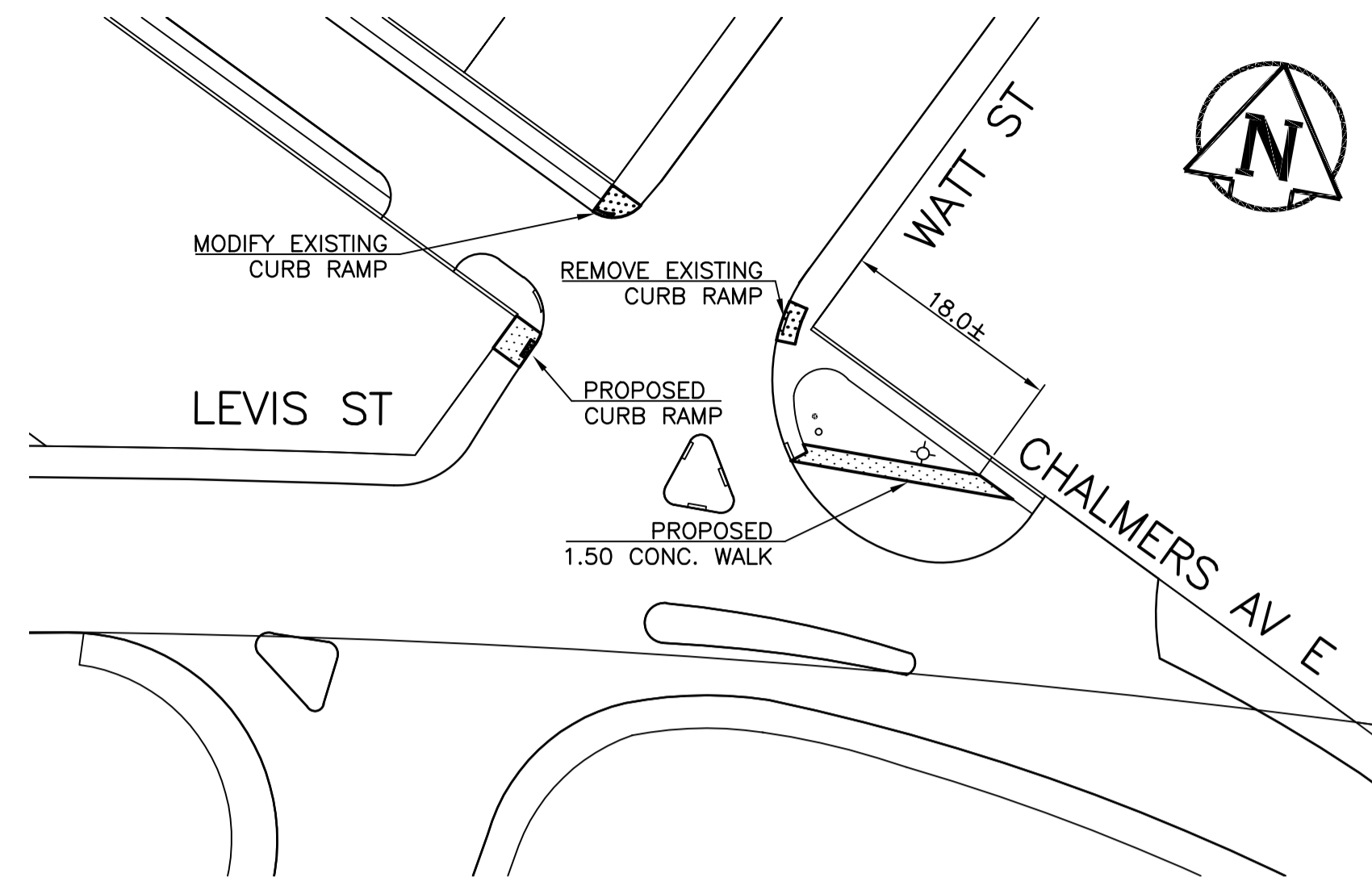

WATT STREET AT LEWIS STREET AT CHALMERS AVENUE EAST

1:500

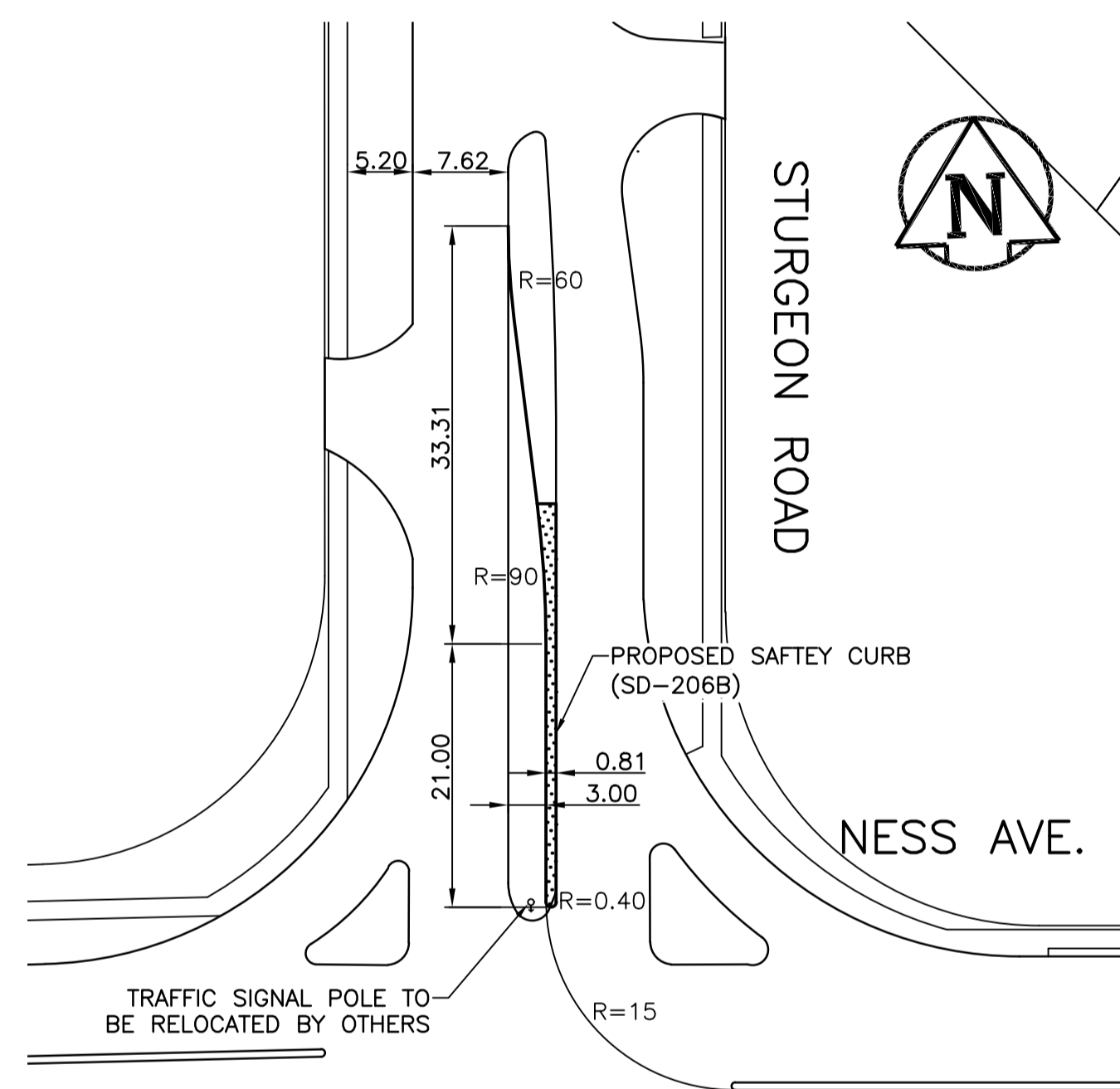

STURGEON ROAD AT NESS AVENUE

1:500

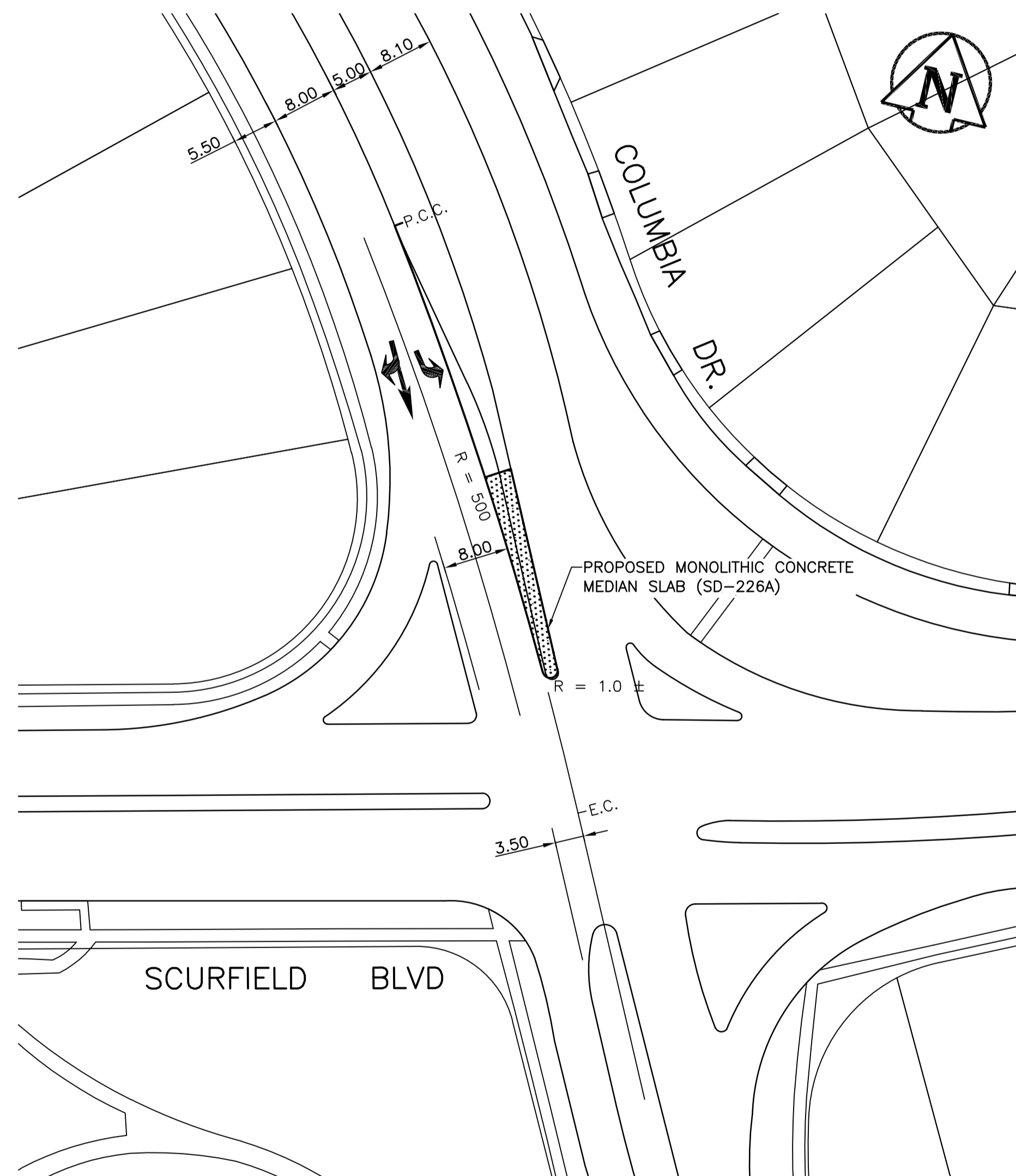

COLUMBIA DRIVE AT SCURFIELD BOULEVARD

1:500

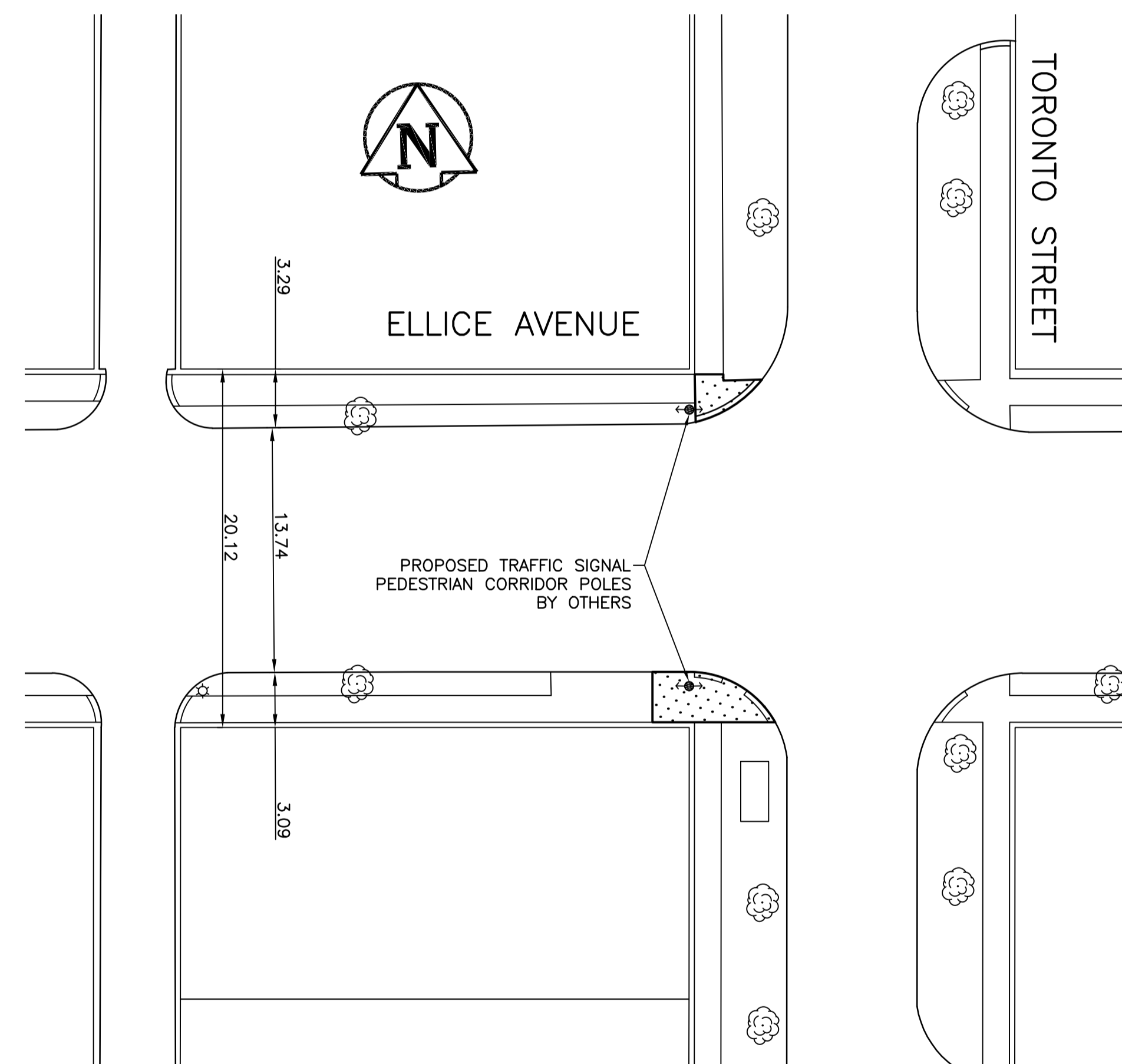

ELLICE AVENUE AT TORONTO STREET

1:250

PRELIMINARY
NOT TO BE USED FOR
CONSTRUCTION

CONSTRUCTION NOTES

- 1) CURB REPLACEMENT AS DIRECTED BY THE CONTRACT ADMINISTRATOR
- 2) ALL STREET RADIUS CURB UNDER 15M RADIUS SHALL BE REPLACED AS MODIFIED OR AS DIRECTED BY THE CONTRACT ADMINISTRATOR
- 3) PAVEMENT REPAIRS SHOWN ARE ONLY A REPRESENTATIVE SAMPLE OF THE TENDERED QUANTITIES
- 4) ASPHALT TIE-INS ON APPROACHES TO BE DETERMINED IN THE FIELD BY THE CONTRACT ADMINISTRATOR.
- 5) ALL BULLNOSES TO HAVE SLOPED FACE.

WARNING

IF POWER EQUIPMENT OR EXPLOSIVES ARE TO BE USED FOR EXCAVATION ON THIS PROJECT THE CONTRACTOR MUST:
1) OBTAIN CLEARANCE FROM THE GAS UTILITY PRIOR TO EXCAVATION.
2) TAKE PRECAUTION TO AVOID DAMAGE TO GAS UTILITY INSTALLATIONS.

SEE PROVINCIAL REGULATION 210/72 FOR DETAILS

BID OPPORTUNITY NO. 789-2011

EXISTING	LEGEND - PLAN	PROPOSED	EXISTING	LEGEND - PLAN	PROPOSED	EXISTING	LEGEND - PROFILE	PROPOSED
⊕	HYDRANT	⊕	---	LDS/WWS	---			
⊙	VALVE	⊙	---	WATERMAIN	---			
⊗	CURB STOP	⊗	---	GAS	---			
▬	CONCRETE SIDEWALK	▬	---	TRAFFIC SIGNALS	---			
○	O.L.S.	○	▨	CONCRETE	▨			
○	MANHOLE	○	▨	CURB RENEWAL	▨			
□	CATCH BASIN	□	231.000	ELEVATIONS	[231.000]			
△	CURB INLET	△	---	PROPERTY LINE	---			
☆	HYDRO POLE	☆	+	SURVEY BAR	+			
⊕	TRAFFIC SIGNAL POLE	⊕	+	GEODETIC BENCH MARK	+			
			▬	RAMP CURB	▬			

LOCATION APPROVED UNDERGROUND STRUCTURES

SUPR. U/G STRUCTURES COMMITTEE DATE

NOTE:
LOCATION OF UNDERGROUND STRUCTURES AS SHOWN ARE BASED ON THE BEST INFORMATION AVAILABLE. BUT NO GUARANTEE IS GIVEN THAT ALL EXISTING UTILITIES ARE SHOWN OR THAT THE GIVEN LOCATIONS ARE EXACT. CONFIRMATION OF EXISTENCE AND EXACT LOCATION OF ALL SERVICES MUST BE OBTAINED FROM THE INDIVIDUAL UTILITIES BEFORE PROCEEDING WITH CONSTRUCTION.

B.M. ELEV.	NO.	REVISIONS	DATE	BY

ENGINEERING DIVISION TECHNOLOGY SERVICES BRANCH 106 - 1155 PACIFIC AVE			
DESIGNED BY	N.M.	CHECKED BY	G.C.
DRAWN BY	R.M.	APPROVED BY	
HOR. SCALE:	VARIES		
VERTICAL:	N.T.S.		
DATE	2011/09/13		

ENGINEER'S SEAL

THE CITY OF WINNIPEG
PUBLIC WORKS DEPARTMENT

2011 INTERSECTION IMPROVEMENTS
VARIOUS LOCATIONS

CITY DRAWING NUMBER SE-11-38
SHEET 3 OF 3
3

METRIC
WHOLE NUMBERS INDICATE MILLIMETRES
DECIMALIZED NUMBERS INDICATE METRES