

ADDRESS & NATURE OF SERVICE		HOUSE WATER SERVICE INFORMATION			REMARKS
NO.	ADDRESS	SIZE (mm) & TYPE	SHORT & LONG MEASUREMENT	CORP LOCATION	
634	Coldstream Ave. Residential	?	?		NO RECORD
636	Coldstream Ave. Residential	?	?		NO RECORD
638	Coldstream Ave. Residential	?	?		NO RECORD

CHAINAGE ALONG NORTH PROPERTY LINE OF COLDSTREAM AVENUE

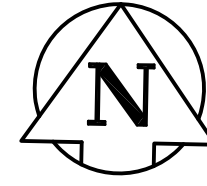

- NOTES:**
1. ALL GATE VALVES ARE COUNTER-CLOCKWISE TO OPEN WITH A BLACK OPERATING NUT. WATERMAIN TO BE INSTALLED BY TRENCHLESS METHODS.
  2. BACKFILL IS CLASS 5 WITHIN BOULEVARD AND CLASS 3 WHEN WITHIN 1.0m OF PAVEMENT OR SIDEWALK.
  3. WATER SERVICES ARE 19mm UNLESS OTHERWISE NOTED.
  4. MINIMUM COVER TO TOP OF WATERMAIN SHALL BE 2.4m.
  5. LOCATION OF ALL SERVICES TO BE CONFIRMED IN FIELD.
  6. EXPOSE EXISTING WATERMAIN TO CONFIRM DEPTH PRIOR TO CONSTRUCTION.
  7. ALL LEAD SERVICES TO BE RENEWED TO PROPERTY LINE.
  8. SERVICES TO BE RENEWED SHALL BE REPLACED FROM WATERMAIN TO PROPERTY LINE. ALL OTHERS TO BE RECONNECTED.

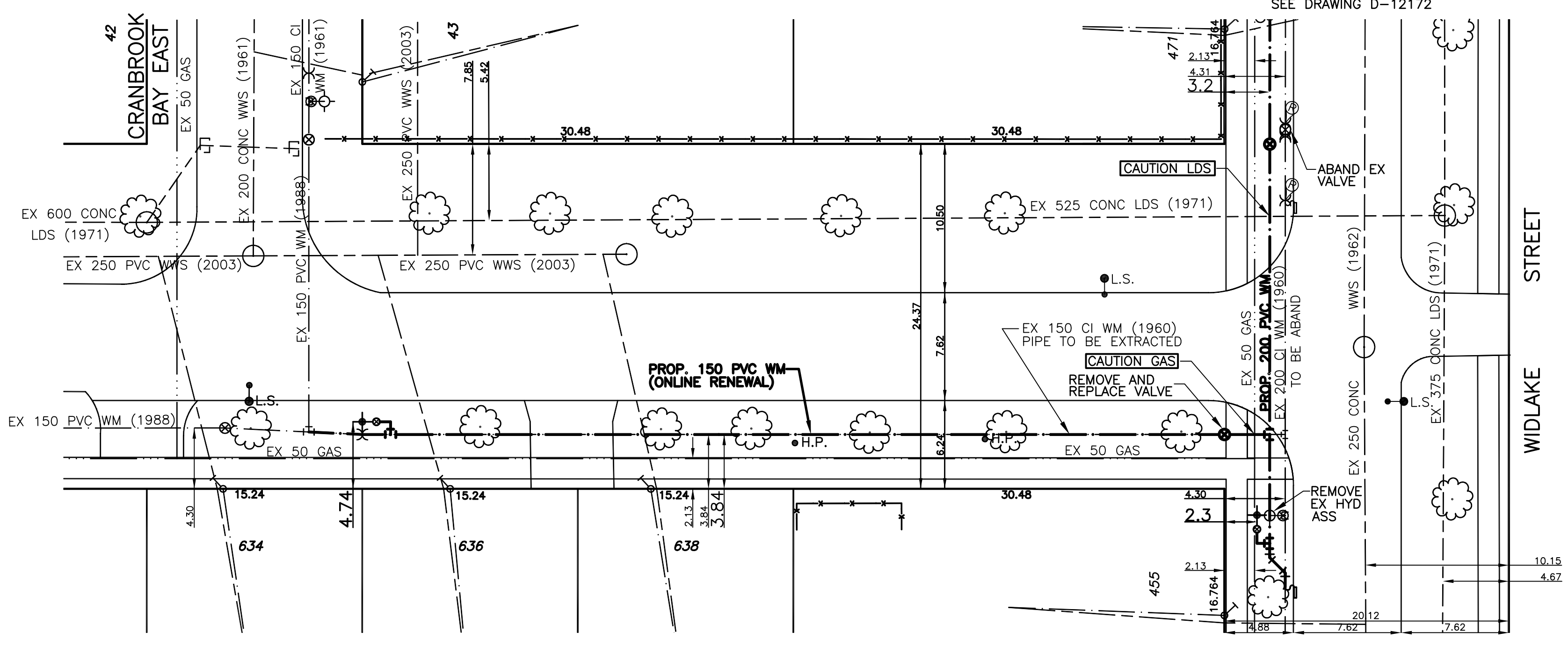

EXISTING	LEGEND - PLAN	PROPOSED	EXISTING	LEGEND - PLAN	PROPOSED	EXISTING	LEGEND - PROFILE	PROPOSED
—	WATERMAIN	—	—	REDUCER	—	—	WATERMAIN VALVE	—
—	HYDRANT	—	—	PLUG	—	—	LAND DRAINAGE SEWER	—
—	VALVE	—	—	TRAFFIC SIGNAL	—	—	WASTE WATER SEWER	—
—	LAND DRAINAGE SEWER	—	—	GAS	—	—	JUNCTIONS	—
—	WASTE WATER SEWER	—	—	HYDRO	—	—	CULVERT	—
—	MANHOLE	—	—	M.T.S.	—	—		
—	CATCH BASIN	—	—	C.B. LEAD	—	—		
—	CURB STOP	—	—	SURVEY BAR	—	—		
—	TEE	—	—	TREE	—	—		
—	BEND	—	—	H.P.P.	—	—		
—	ANODE	—	—	HYDRO POLE	—	—		
—		—	—	LAMP STANDARD	—	—		

**LOCATION APPROVED**

SUPV. U/G STRUCTURES DATE COMMITTEE

NOTE: LOCATION OF UNDERGROUND STRUCTURES AS SHOWN ARE BASED ON THE BEST INFORMATION AVAILABLE BUT NO GUARANTEE IS GIVEN THAT ALL EXISTING UTILITIES ARE SHOWN OR THAT THE GIVEN LOCATIONS ARE EXACT. CONFIRMATION OF EXISTENCE AND EXACT LOCATION OF ALL SERVICES MUST BE OBTAINED FROM THE INDIVIDUAL UTILITIES BEFORE PROCEEDING WITH CONSTRUCTION.

NO.	REVISIONS	DATE	BY

**GENIVAR**  
10 PRADIER WAY WINNIPEG, MANITOBA R2L 3J8  
PH: (204)-477-6650 FAX: (204)-474-2864

DESIGNED BY	PR	CHECKED BY	SM
DRAWN BY	PR	APPROVED BY	IMcK
HOR. SCALE:	1:250	RELEASED FOR CONSTRUCTION	ORIGINALLY SIGNED BY
VERT. SCALE:	1:50	DATE	

ENGINEERS SEAL

**I. G. McKINNON**  
REGISTERED PROFESSIONAL ENGINEER

CONSULTANT DRAWING NO. 010-050-08

METRIC  
WHOLE NUMBERS INDICATE MILLIMETRES  
DECIMALIZED NUMBERS INDICATE METRES

**THE CITY OF WINNIPEG**  
WATER AND WASTE DEPARTMENT

2010 CAPITAL WORKS  
WATERMAIN RENEWALS  
COLDSTREAM AVENUE  
CRANBROOK BAY EAST TO  
WIDLAKE STREET

SHEET 3 OF 3  
CITY DRAWING NO. D-12173

