

NOTE: ALL CONSTRUCTION TO MEET CITY OF WINNIPEG STANDARDS

TOTAL CONCRETE AREA ±2029.39 m²

NOTES:

1. CITY OF WINNIPEG BENCHMARK NO. 1234-C; ELEVATION 232.284m
2. ALL CONSTRUCTION AND MATERIALS TO BE IN ACCORDANCE WITH THE CITY OF WINNIPEG STANDARD CONSTRUCTION SPECIFICATION, LATEST EDITION.
3. CONTRACTOR TO OBTAIN AND PAY FOR ALL PERMITS
4. WHERE CONNECTING TO EXISTING SERVICES, CONTRACTOR TO CONFIRM LOCATION AND ELEVATION PRIOR TO CONSTRUCTION.
5. ALL DIMENSIONS TO BE VERIFIED IN THE FIELD.
6. ALL CONSTRUCTION SAFETY SHALL CONFORM TO APPLICABLE PROVINCIAL AND CITY BY-LAWS.

NOTE: THE PROPOSED WORKS SHALL BE CONSTRUCTED IN ABSOLUTE COMPLIANCE WITH THE OPERATING CONSTRAINTS FOR WORK IN CLOSE PROXIMITY TO THE BRANCH 1 AQUEDUCT WHICH IS ATTACHED TO THIS DRAWING AND WILL BE INCLUDED IN THE BID OPPORTUNITY DOCUMENT.
REVIEWED BY R.A. SOROKOWSKI ON AUGUST 25, 2011

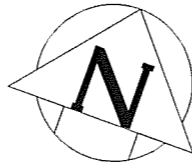

**CITY OF WINNIPEG
WATER AND WASTE DEPARTMENT
ENGINEERING DIVISION**

Reviewed By: *[Signature]*

Date: *Aug. 30/11*

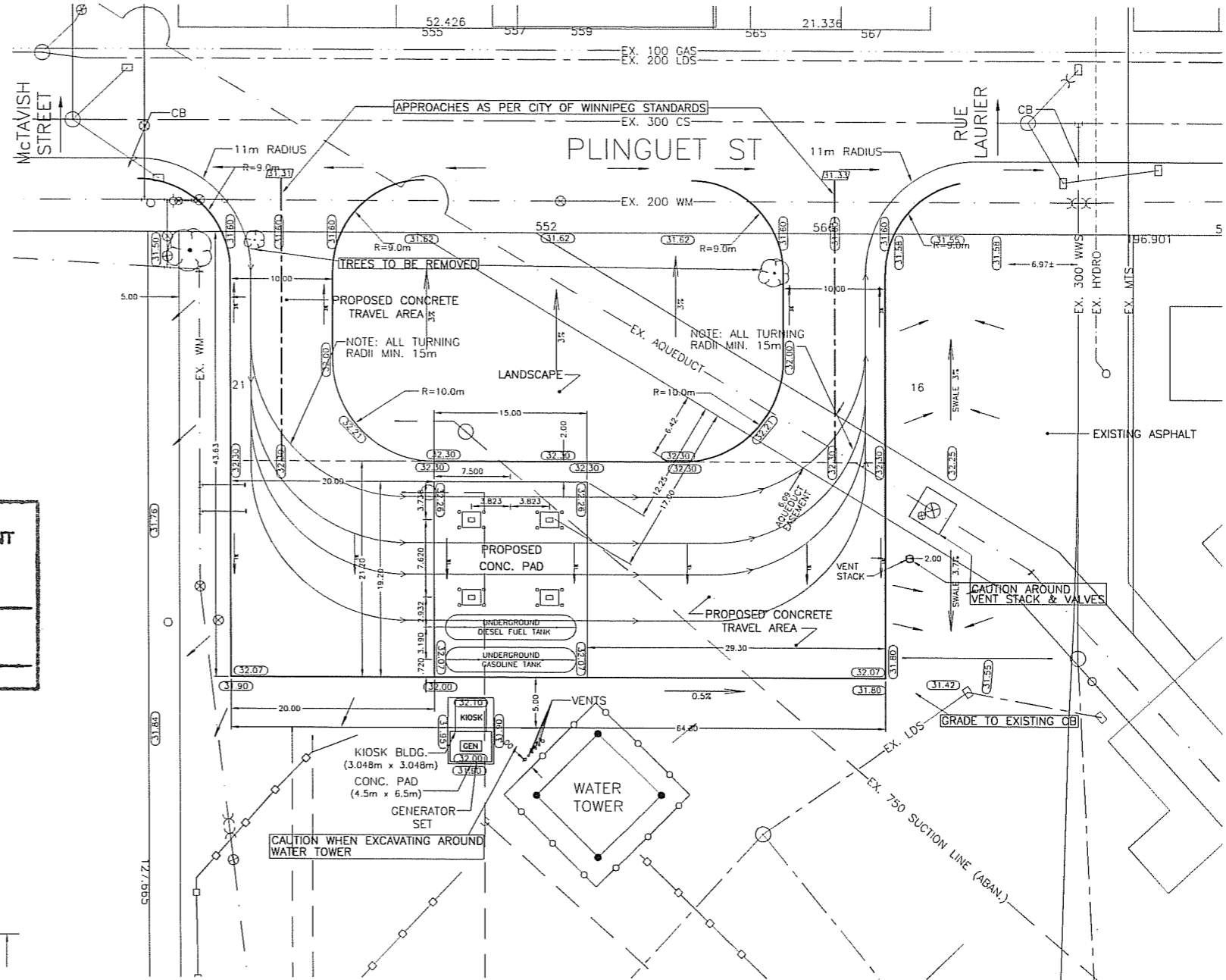

LOCATION PLAN

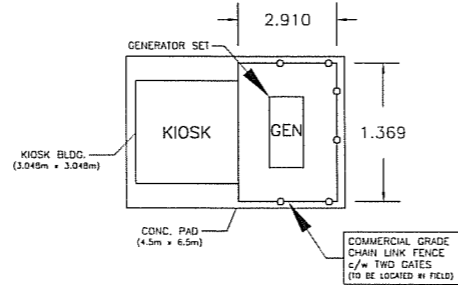
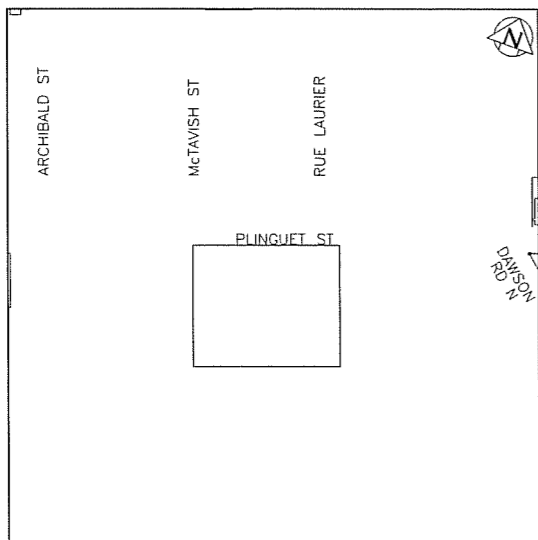

KIOSK & GENERATOR DETAIL
SCALE 1:100

1234-C - Tblt. in S. wall of W. Bldg. Standard Chemical Ltd., 681 Plinguet St., 5.8 m W. of S.E.

EXISTING	LEGEND	PROPOSED	EXISTING	LEGEND	PROPOSED
	HYDRO M.T.S.			SHAW PEDESTAL	
	GAS			HYDRO TRANSFORMER	
	WASTE WATER SEWER			JOINT USE PEDESTAL	
	WATERMAIN			PROPERTY LINE	
	LAND DRAINAGE SEWER			JUNCTIONS	
	SHAW CABLE			CONCRETE	
	MANHOLE			ASPHALT	
	HYDRANT			SIDEWALK	
	GATE VALVE			DITCH	
	SURVEY BAR				
	CATCH BASIN				
	ELEVATION				
	CULVERT				
	GEODETIC MONUMENT				

LOCATION APPROVED UNDERGROUND STRUCTURES

SUPV. 1/2 STRUCTURES COMMITTEE DATE

NOTE: LOCATION OF UNDERGROUND STRUCTURES AS SHOWN ARE BASED ON THE BEST INFORMATION AVAILABLE BUT NO GUARANTEE IS GIVEN THAT ALL EXISTING UTILITIES ARE SHOWN OR THAT THE GIVEN LOCATIONS ARE EXACT. CONFIRMATION OF EXISTENCE AND EXACT LOCATION OF ALL SERVICES MUST BE OBTAINED FROM THE INDIVIDUAL UTILITIES BEFORE PROCEEDING WITH CONSTRUCTION.

NO.	REVISIONS	DATE	BY

B.M. 1234-C
ELEV. 232.284m

FIELD BOOK #: 138/139

LINDAL CONSULTING LTD.

DESIGNED BY: DJL
CHECKED BY: DJL

DRAWN BY: G.O./D.C.
APPROVED BY: DJL

HOR. SCALE 1:250
VERTICAL N/A

RELEASED FOR CONSTRUCTION

DATE: MAY 2011

APEGM
Certificate of Authorization
Lindal Consulting Ltd.
No. 817 Date: AUG 26, 2011

ENGINEER'S SEAL

PROVINCE OF MANITOBA
REGISTERED PROFESSIONAL ENGINEER
D.J. LINDAL
8/26/11

CONSULTANT DRAWING NO.
207-004

THE CITY OF WINNIPEG

Winnipeg

WINNIPEG FLEET AGENCY
SITE PLAN
552 PLINGUET ST

SHEET 1 OF 1