

ENLARGEMENT 1 - CORYDON AVE. AT LILAC ST.
SCALE 1:150

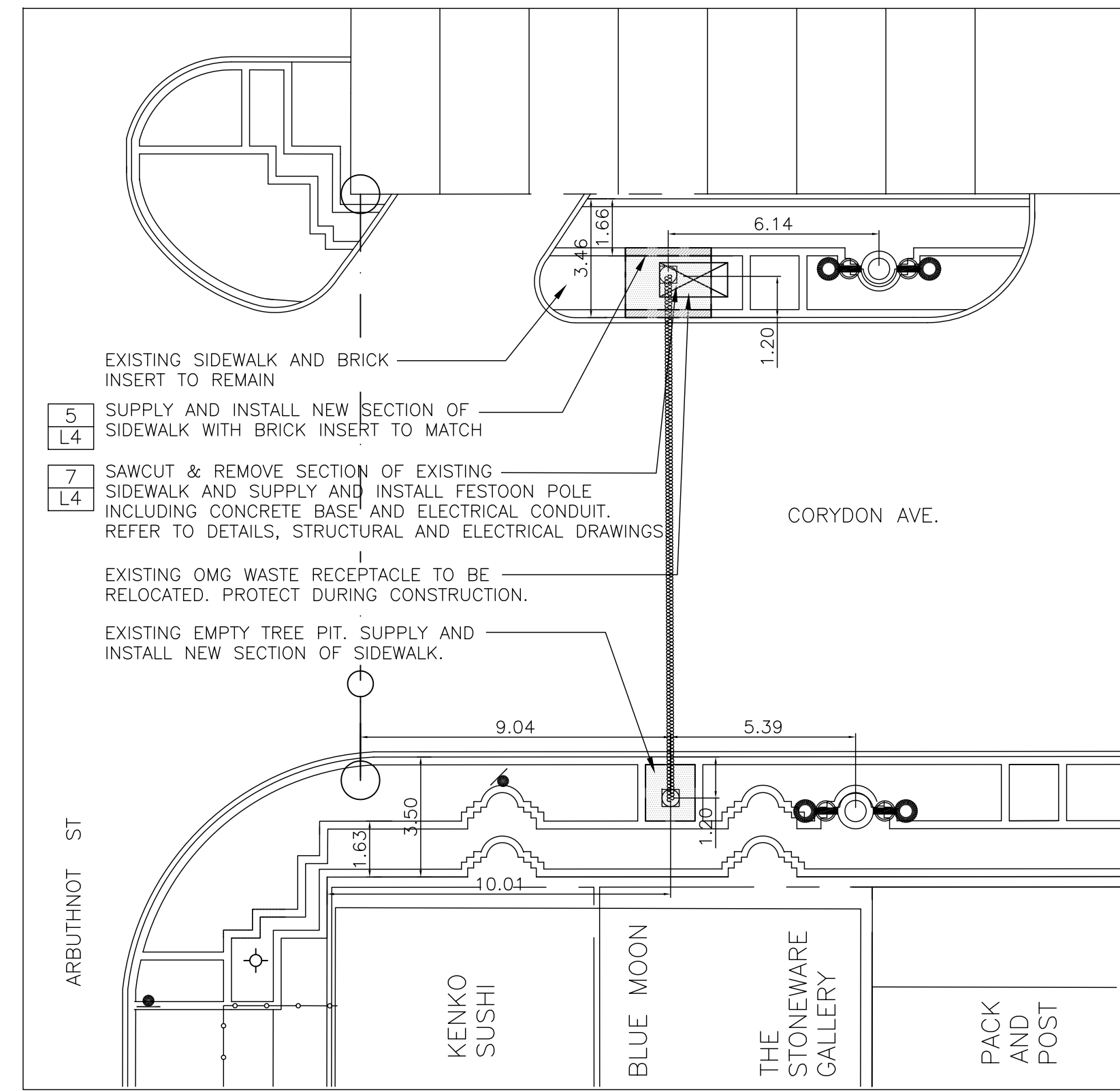

ENLARGEMENT 2 - CORYDON AVE. AT ARBUTHNOT ST.
SCALE 1:150

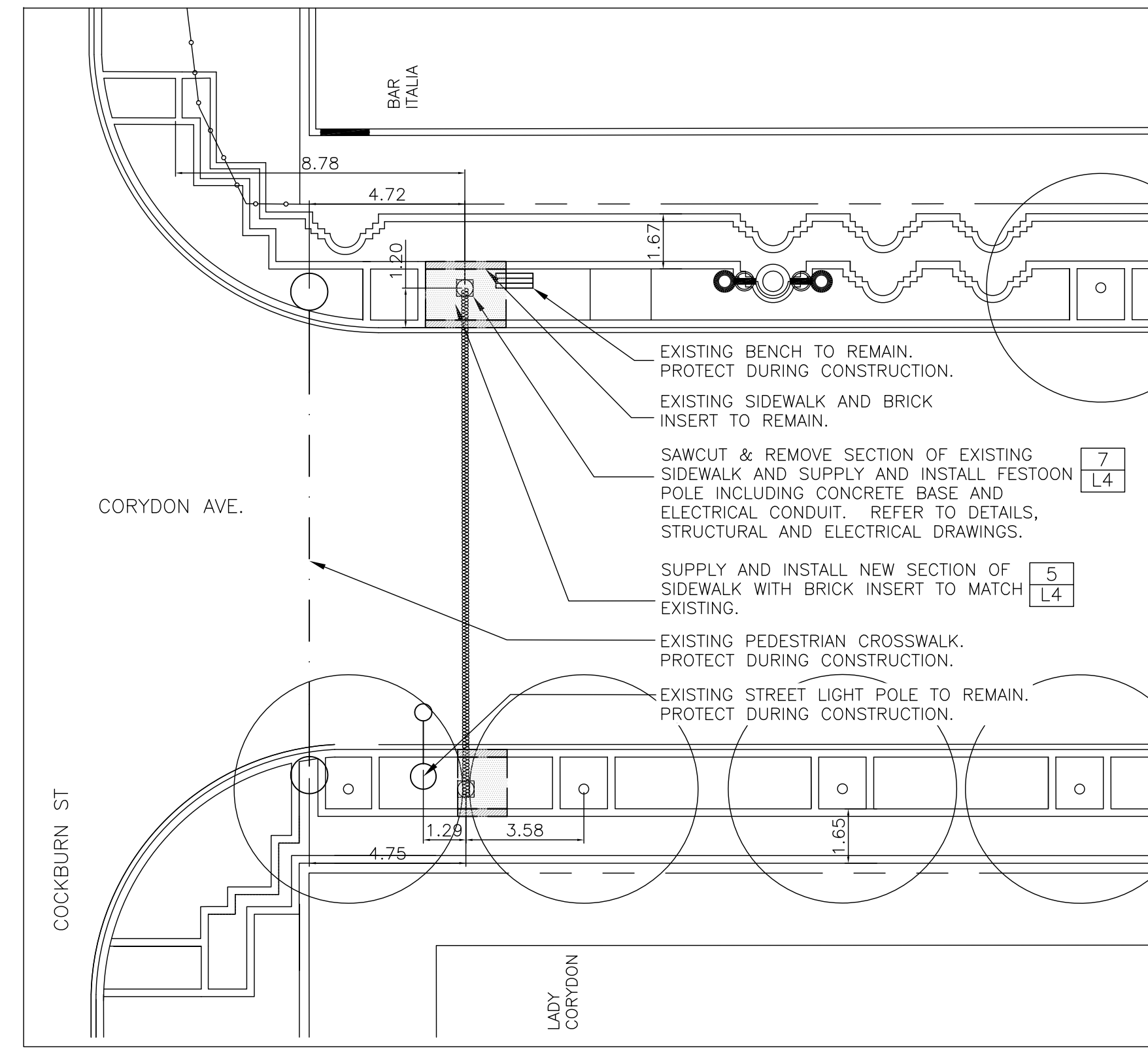

ENLARGEMENT 3 - CORYDON AVE. AT COCKBURN ST.
SCALE 1:150

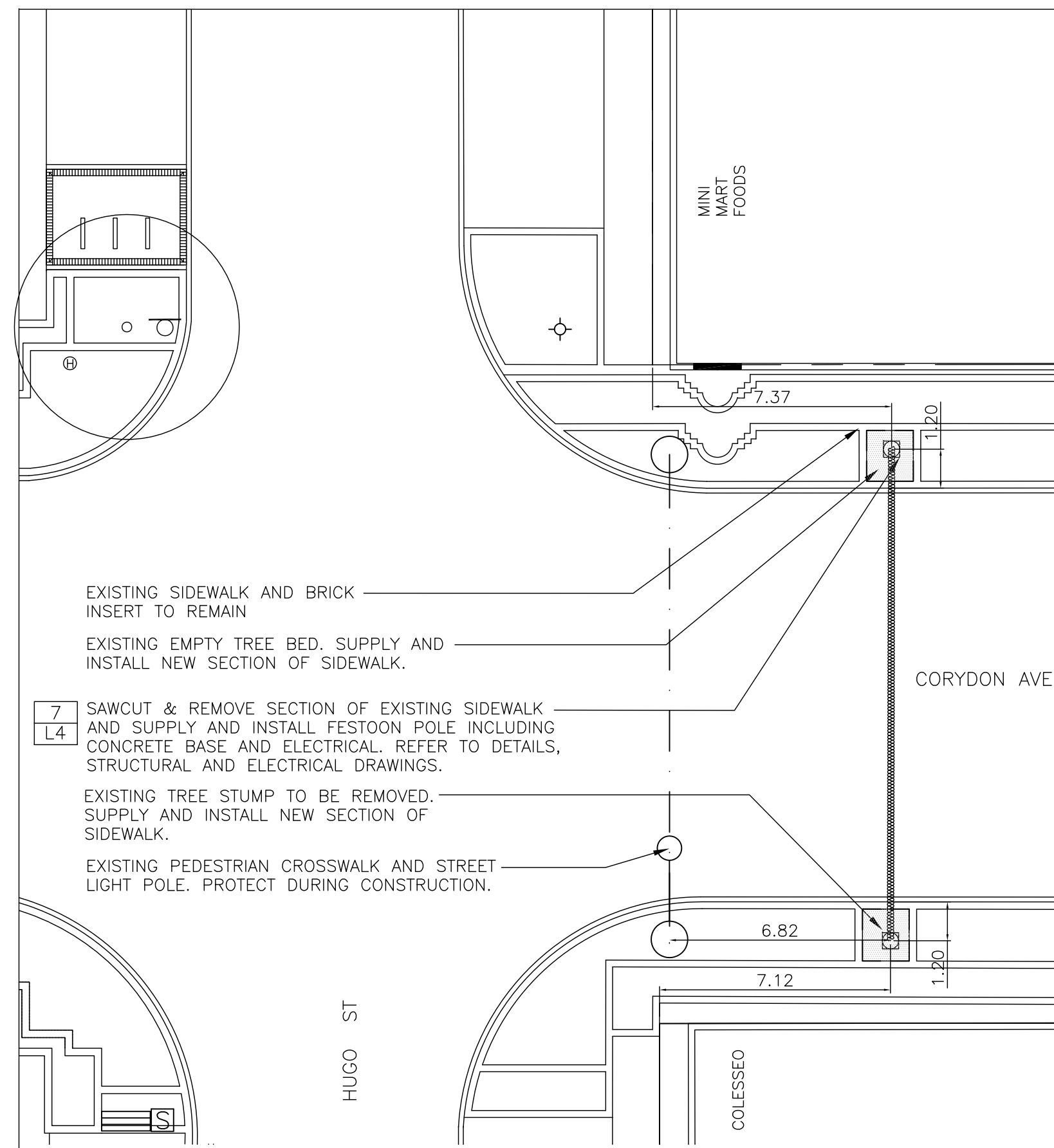

ENLARGEMENT 4 - CORYDON AVE. AT HUGO ST.
SCALE 1:150

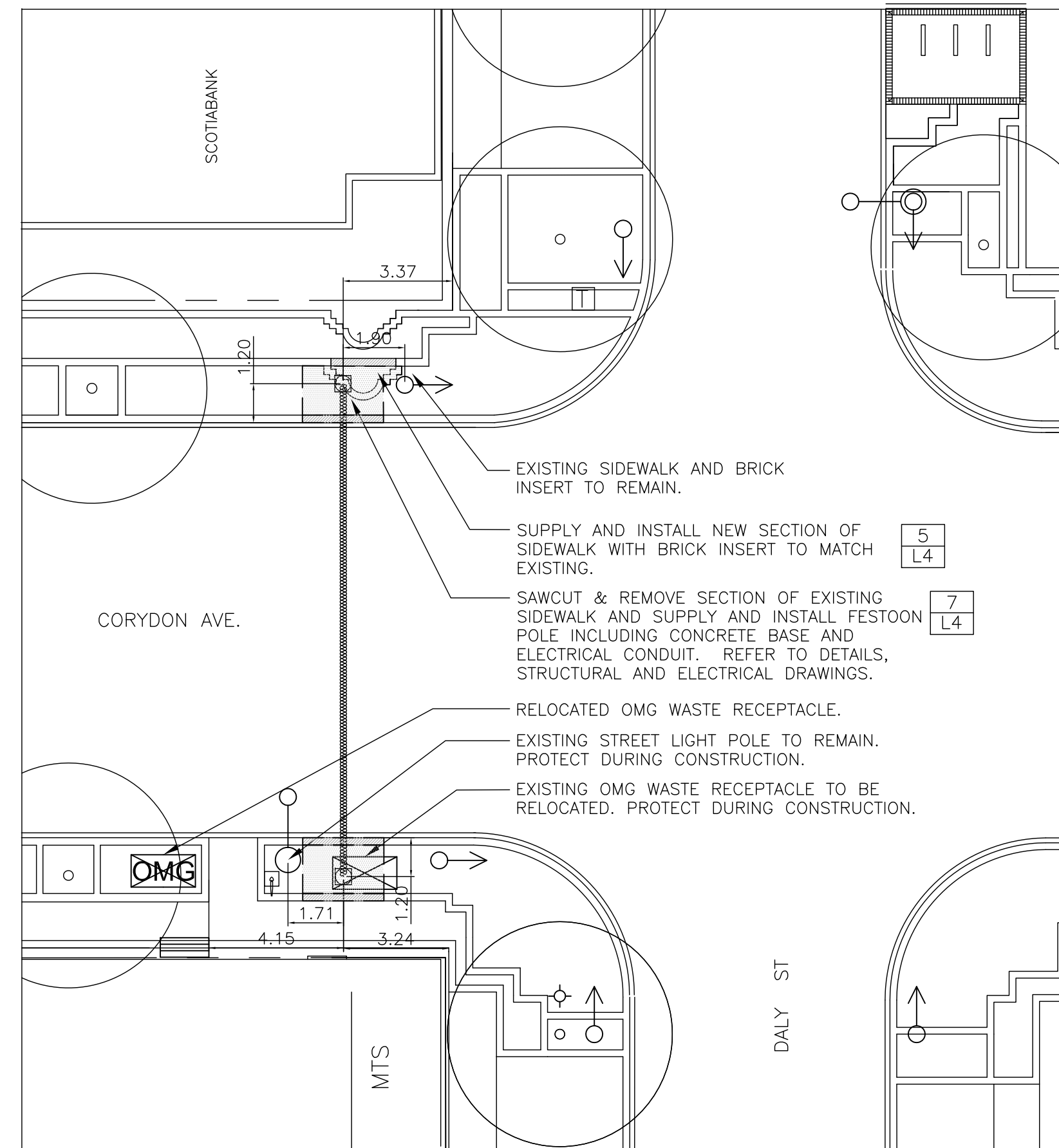

ENLARGEMENT 5 - CORYDON AVE. AT DALY ST.
SCALE 1:150

NOTES

1. ALL DIMENSIONS SHOWN IN METRIC UNITS. NUMBERS WITH DECIMALS INDICATE METERS. WHOLE NUMBERS INDICATE MILLIMETERS.
2. ALL UTILITIES ARE SHOWN AS INFORMATION ONLY. CONTRACTOR TO CONFIRM LOCATION OF ALL UTILITIES ON SITE PRIOR TO CONSTRUCTION.
3. THE CONTRACTOR SHALL PROVIDE A QUALIFIED CREW TO LAYOUT STREETSCLAPING ELEMENTS. THE CREW SHALL BE EQUIPPED WITH ALL THE NECESSARY EQUIPMENT TO PROVIDE HORIZONTAL AND VERTICAL LAYOUT IN ACCORDANCE WITH THE PLANS AND SPECIFICATIONS.
4. CONTRACTOR TO PROTECT ALL TREES, POLES, AREAWAYS ETC. TO REMAIN TO CITY OF WINNIPEG STANDARDS.
5. CONFIRM ALL DIMENSIONS ON SITE AND HAVE ALL PAVING LAYOUTS APPROVED BY CONTRACT ADMINISTRATOR PRIOR TO ANY EXCAVATION OR CONSTRUCTION. REPORT ANY DISCREPANCIES.
6. LAYOUT ALL CONCRETE SAWCUTS FOR REVIEW AND APPROVAL BY CONTRACT ADMINISTRATOR PRIOR TO CONSTRUCTION.
7. MAINTAIN EXISTING GRADES AT ALL BUILDING EDGES AND PROPERTY LINES UNLESS OTHERWISE NOTED. ENSURE POSITIVE DRAINAGE TO ALL CATCH BASINS.
8. ALL PAVING WORKS AND CURB/GUTTER TO BE SUPPLIED AND INSTALLED TO CITY OF WINNIPEG STANDARDS AND SPECIFICATIONS.
9. CONTRACTOR IS RESPONSIBLE FOR ALL REMOVALS AS REQUIRED TO CONSTRUCT ALL WORKS AS SHOWN ON PLANS AND DETAILS. ALL ITEMS TO BE REMOVED MUST BE DISPOSED OF LEGALLY OFF SITE. ALL REUSABLE PAVING STONE TO BE STOCKPILED FOR REINSTALLATION.
10. MIN. CLEARANCE OF 1.0m TO BE PROVIDED BETWEEN THE UNDERSIDE OF ANY EX. WATERMAIN OR SEWERMAIN PIPE AND THE TOP OF THE PROPOSED WORK OR MIN. 0.5m TO BE PROVIDED BETWEEN THE UNDERSIDE OF THE PROPOSED WORK AND THE TOP OF ANY EX. WATERMAIN OR SEWERMAIN PIPE.
11. MAINTAIN MIN. LATERAL CLEARANCE OF 1.0m BETWEEN THE NEAREST EDGE OF THE PROPOSED WORK AND THE NEAREST EDGE OF ANY EX. WATERMAIN OR SEWERMAIN. PREFERRED 2.0m MIN. LATERAL CLEARANCE.
12. CONTACT CUSTOMER TECHNICAL SERVICES BRANCH (986-3322) FOR CLEARANCE OF EX. WATER AND WASTE DEPT. PLANT 48 HOURS PRIOR TO CONSTRUCTION.
13. NO LANE CLOSURES ON CORYDON AVE. DURING 7:00AM-9:00AM, 3:30PM-5:30PM, MON-FRI. ALL TEMPORARY TRAFFIC CONTROL AS PER THE MANUAL OF TEMPORARY TRAFFIC IN WORK ZONES ON CITY STREETS.
14. TRAFFIC SIGNALS CLEARANCE REQUIRED PRIOR TO CONSTRUCTION. CONTRACTOR TO CALL 986-4193 MANUAL OF TEMPORARY TRAFFIC IN WORK ZONES ON CITY STREETS.

ALL DIMENSIONS FOR EXISTING PAVING AND SITE ELEMENTS ARE FIELD MEASURED AND ARE TO BE CONFIRMED ON SITE PRIOR TO CONSTRUCTION

ISSUED FOR TENDER	07/12/11	AH
No.	Revisions	Date
Date	Scale	By
09-06-11	AS NOTED	
Designed By	Drawn By	Checked By
SR	SM	AH

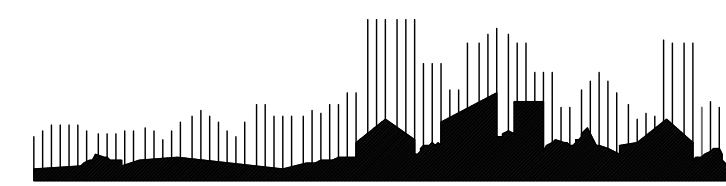

Client
CORYDON AVENUE BIZ

Project Title
**CORYDON AVENUE
STREETSCLAPING
PHASE ONE**

Sheet Title
ENLARGEMENT PLANS