

MATCHLINE 3+50

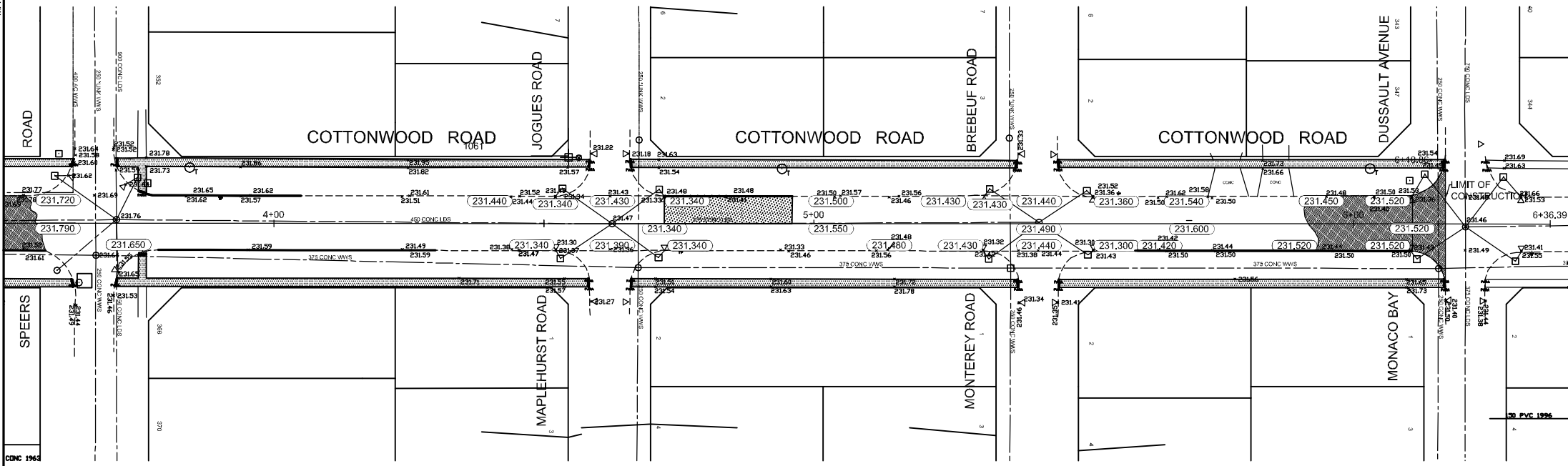

- REFERENCE NOTES**
- A. PAVEMENT DIMENSIONS ARE TO BACK OF CURB
  - B. ADD 200.000 TO DESIGN ELEVATIONS TO OBTAIN GEODETIC DATUM
  - C. BASELINE IS CENTRELINE OF RIGHT-OF-WAY
  - D. PROPERTY LINES OBTAINED FROM THE CITY OF WINNIPEG L.B.I.S., AND NO SCALE FACTOR WAS APPLIED
  - E. REFER TO AECOM FIELD BOOK NO. 4699

**FOR REFERENCE ONLY**

**METRIC**  
WHOLE NUMBERS INDICATE MILLIMETRES  
DECIMALIZED NUMBERS INDICATE METRES

	WATERMAIN		HYDRO				<p><b>LOCATION APPROVED UNDERGROUND STRUCTURES</b></p> <p>SUPV. U/G STRUCTURES COMMITTEE      DATE</p> <p>NOTE: LOCATION OF UNDERGROUND STRUCTURES AS SHOWN ARE BASED ON THE BEST INFORMATION AVAILABLE, BUT NO GUARANTEE IS GIVEN THAT ALL EXISTING UTILITIES ARE SHOWN OR THAT THE GIVEN LOCATIONS ARE EXACT. CONFIRMATION OF EXISTENCE AND EXACT LOCATION OF ALL SERVICES MUST BE OBTAINED FROM THE INDIVIDUAL UTILITIES BEFORE PROCEEDING WITH CONSTRUCTION.</p>
	HYDRANT		M.T.S.				
	VALVE		CONCRETE				
	LAND DRAINAGE SEWER		ASPHALT				
	WASTEWATER SEWER		PROPERTY LINE				
	MANHOLE		SURVEY BAR				
	CATCH BASIN		ELEVATION				
	CURB INLET		TREE				
	JUNCTIONS		SIDEWALK RAMP				
	CULVERT		CONCRETE SIDEWALK				
	GAS		FENCE				
	EXISTING		LEGEND - PLAN				
	LEGEND - PLAN		LEGEND - PROFILE				
	PROPOSED		PROPOSED				
	EXISTING		EXISTING				
	LEGEND - PLAN		LEGEND - PROFILE				
	PROPOSED		LEGEND - PROFILE				
	EXISTING		LEGEND - PROFILE				

**LOCATION APPROVED UNDERGROUND STRUCTURES**

SUPV. U/G STRUCTURES COMMITTEE      DATE

NOTE:  
LOCATION OF UNDERGROUND STRUCTURES AS SHOWN ARE BASED ON THE BEST INFORMATION AVAILABLE, BUT NO GUARANTEE IS GIVEN THAT ALL EXISTING UTILITIES ARE SHOWN OR THAT THE GIVEN LOCATIONS ARE EXACT. CONFIRMATION OF EXISTENCE AND EXACT LOCATION OF ALL SERVICES MUST BE OBTAINED FROM THE INDIVIDUAL UTILITIES BEFORE PROCEEDING WITH CONSTRUCTION.

B.M. 55-009	ELEV. 232.156	<small>NE. Cor. Greenwood Rd. &amp; Argonwood Rd. 114. H.W. Cor. Foundation of Retail No. 13 (S&amp;H) N. 214-100 Argonwood Dr., 0.5m N. &amp; 0.5m E. of back of S.W. Cor. of Bldg.</small>	
NO.	REVISIONS	DATE	BY
0	ISSUED FOR TENDER	2011/06/09	BC
A	ISSUED FOR REVIEW	2011/06/03	BC

<b>AECOM</b>		This drawing has been prepared for the use of AECOM's client and may not be used, reproduced or relied upon by third parties, except as agreed by AECOM and its client, as required by law or for use by governmental reviewing agencies. AECOM accepts no responsibility, and denies any liability whatsoever, to any party that modifies this drawing without AECOM's express written consent. Do not scale this document. All measurements must be obtained from stated dimensions.	
DESIGNED BY	BC	CHECKED BY	TDW
DRAWN BY	BC	APPROVED BY	KWR
HOR. SCALE:	1:500	RELEASED FOR CONSTRUCTION BY:	
VERTICAL:	1:20	DATE	2011/06/08

ENGINEER'S SEAL

CONSULTANT DRAWING NO. RT-09

**THE CITY OF WINNIPEG**  
PUBLIC WORKS DEPARTMENT  
ENGINEERING DIVISION

CITY DRAWING NUMBER

SHEET 2 OF 2

2011 LOCAL STREET RENEWAL PROGRAM

PAVEMENT REHABILITATION

COTTONWOOD ROAD - CANBERRA ROAD TO MONACO BAY WEST

STATION 3+50 TO MONACO BAY WEST PLAN-PROFILE