

PUBLIC LANE

PLANT LIST

KEY	QTY.	COMMON NAME/BOTANICAL NAME	SIZE	REMARKS
DECIDUOUS TREES				
A	8	BRANDON ASCENDING ELM / ULMUS AMERICANA 'BRANDON'	60 - 70mm cal.	SPECIMAN, B&B, MACHINE DUG WITH MIN. 10 BRANCHES IN WELL BRANCHED HEAD, STRAIGHT TRUNK, MIN. HT. 600mm, BRANCHING HT. 1800mm.
CONIFEROUS TREES				
B	4	BLACK HILLS SPRUCE/PICEA GLAUCA 'BLACK HILLS'	2.4m ht.	SPECIMAN, B&B, MACHINE DUG WITH SINGLE UPRIGHT LEADER, STRAIGHT TRUNK, WELL BRANCHED, FULL FORM.
DECIDUOUS SHRUBS				
C	99	DWARF EUROPEAN CRANBERRY / VIBURNUM OPULUS 'NANUM'	#2 POT	SPECIMAN, CONTAINER GROWN, WITH MINIMUM 3 STALKS IN WELL BRANCHED PLANT. MIN PLANT HT. OF 1.0m
CONIFEROUS SHRUBS				
D	35	HUGHES JUNIPER / JUNIPERUS HORIZONTALIS 'HUGHES'	#2 POT	SPECIMAN, CONTAINER GROWN, WITH MINIMUM 3 STALKS IN WELL BRANCHED PLANT. MIN PLANT SPREAD OF 450mm.

19 SUPPLY AND INSTALL PLANTING BED L4.5 AS PER DETAIL.
18 TYPICAL CONIFEROUS TREE PLANTING AS PER DETAIL.

20 TYPICAL DECIDUOUS TREE PLANTING IN TREE VAULT AS PER DETAIL.

19 SUPPLY AND INSTALL PLANTING BED L4.5 FOR ANNUALS (450mm DEPTH SOIL) AS PER DETAIL.

N.I.C SURGE TANK ACCESS

LEGEND

- PROPERTY LINE
- - - EXISTING CURB
- PROPOSED DECIDUOUS TREES
- ⊕ PROPOSED CONIFEROUS TREES
- ☁ PROPOSED DECIDUOUS SHRUBS
- ⊕ PROPOSED CONIFEROUS SHRUBS
- 1 1.5 DETAIL KEY
- 1 1.5 DETAIL NUMBER SHEET NUMBER
- 4 4 PLANT KEY
- 4 A QUANTITY KEY

NOTES

1. ALL DIMENSIONS SHOWN IN METRIC UNITS. NUMBERS WITH DECIMALS INDICATE METERS. WHOLE NUMBERS INDICATE MILLIMETERS.
2. CONTRACTOR TO CONFIRM ALL DIMENSIONS AND REPORT ANY DISCREPANCIES TO CONTRACT ADMINISTRATOR AND CITY OF WINNIPEG PRIOR TO CONSTRUCTION.
3. LAYOUT TO BE APPROVED BY CONTRACT ADMINISTRATOR AND CITY OF WINNIPEG PRIOR TO ANY CONSTRUCTION OR REMOVALS.
4. THE CONTRACTOR IS RESPONSIBLE FOR ALL EXCAVATIONS, REMOVALS, DISPOSALS, AND ROUGH GRADING AS REQUIRED TO CONSTRUCT ALL WORKS AS SHOWN ON ALL PLANS, DETAILS AND SPECIFICATIONS. ALL ITEMS TO BE REMOVED MUST BE DISPOSED OF LEGALLY OFF SITE.
5. REFER ALSO TO WRITTEN SPECIFICATIONS.
6. LOCATION OF ALL UTILITIES SHOWN FOR ILLUSTRATION ONLY. CONTRACTOR MUST CONTACT ALL UTILITIES REGARDING RULES FOR WORKING IN THE AREA OF THE UTILITIES PRIOR TO COMMENCEMENT OF ANY WORK. CONTRACTOR MUST CONFIRM LOCATION OF ALL UTILITIES PRIOR TO CONSTRUCTION.
7. FILL ALL HOLES AND LOW AREAS TO DESIGN SUBGRADE WITH COMPACTED FILL (SUITABLE TO SURFACE FINISH). FOR SODDED/PLANTED AREAS USE COMPACTED CLEAN EARTH FILL SUITABLE FOR PLANT GROWTH. FOR PAVED AREAS USE COMPACTED GRANULAR BASE. REFER TO SPECIFICATIONS.
8. ALL WORK TO BE DONE IN ACCORDANCE WITH CITY OF WINNIPEG STANDARD CONSTRUCTION SPECIFICATIONS UNLESS OTHERWISE NOTED.
9. PLANTING AND SHRUB BED LAYOUT TO BE APPROVED BY CONTRACT ADMINISTRATOR AND CITY OF WINNIPEG PRIOR TO ANY CONSTRUCTION OR REMOVALS.
10. IN GENERAL, SHRUB SPACING IN BEDS AS FOLLOWS:
LARGE DECIDUOUS SHRUBS: 900mm O.C.
SMALL DECIDUOUS SHRUBS: 600mm O.C.
CONIFEROUS SHRUBS: 750mm O.C.
THIS VARIES SLIGHTLY WITH SPECIES, CONTRACTOR TO OBTAIN APPROVAL FROM CONTRACT ADMINISTRATOR AND CITY OF WINNIPEG PRIOR TO PLANTING.
11. ALL SHRUBS TO BE PLANTED A MINIMUM OF 600mm O.C. FROM BACK OF CURB AND 450mm O.C. FROM EDGE OF BED.
12. EXISTING LIMESTONE MUST BE REMOVED AND DISPOSED FULL DEPTH AND REPLACED WITH EARTH FILL SUITABLE FOR PLANT GROWTH FOR ALL PLANTING BED AREAS.

No.	Revisions	Date	By
Date Scale			
11-04-11		1:75	
Designed By	Drawn By	Checked By	
SR/AH	PB	JW	

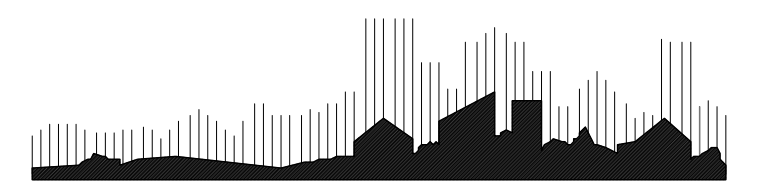
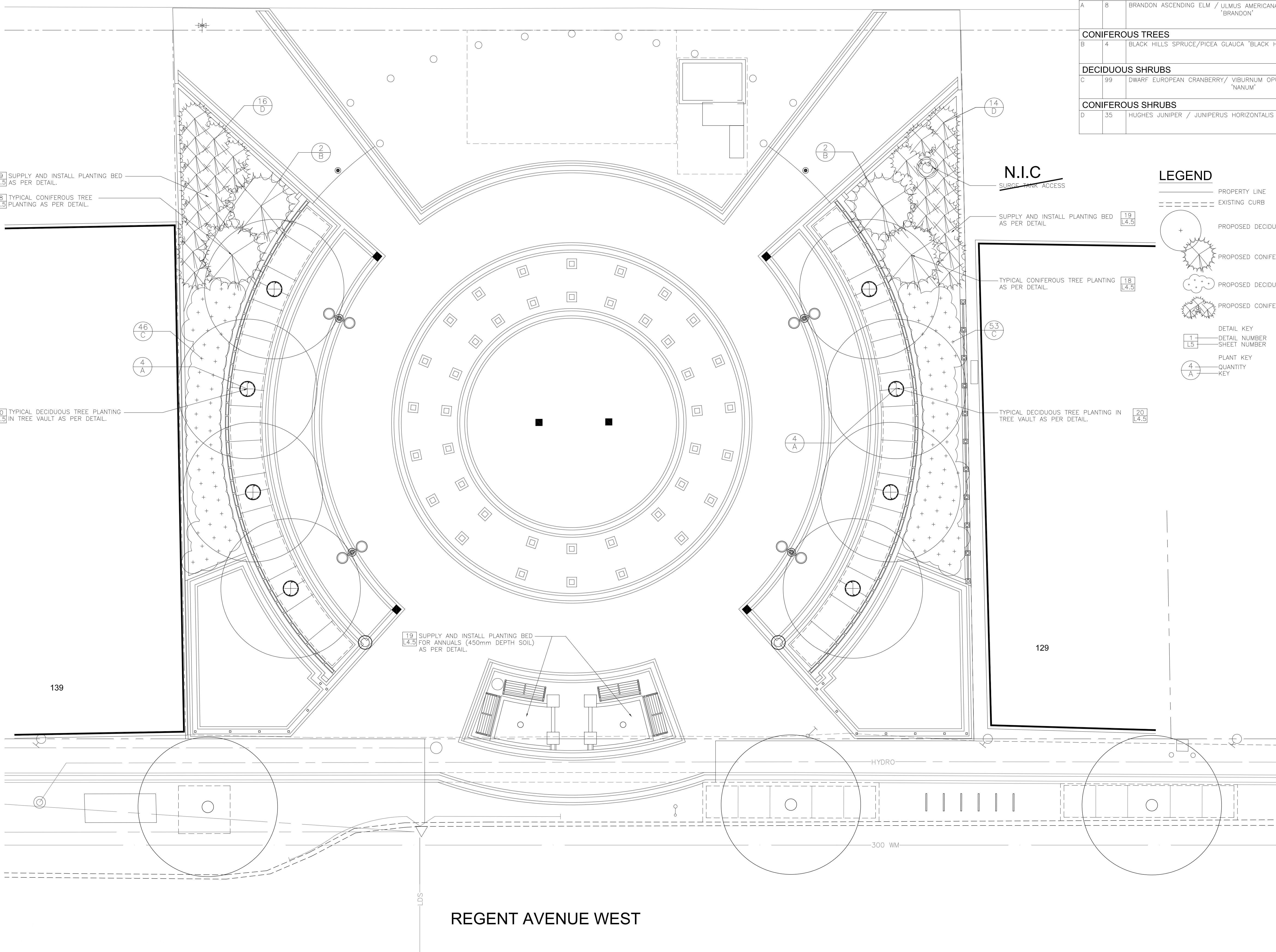

McGOWAN RUSSELL
Client
TRANSCONA BIZ

Project Title
TRANSCONA CENTENNIAL SQUARE
Sheet Title
PLANTING PLAN

Project No. 10-025 Drawing No. L3