

KEYPLAN

LEGEND

	HAZARDOUS CLASS I, ZONE 1, GROUP IIA
	HAZARDOUS CLASS I, ZONE 2, GROUP IIA
	CATEGORY 1 (MOISTURE)
	CATEGORY 2 (CORROSIVE)
	CATEGORY 2 WET (MOISTURE & CORROSIVE)

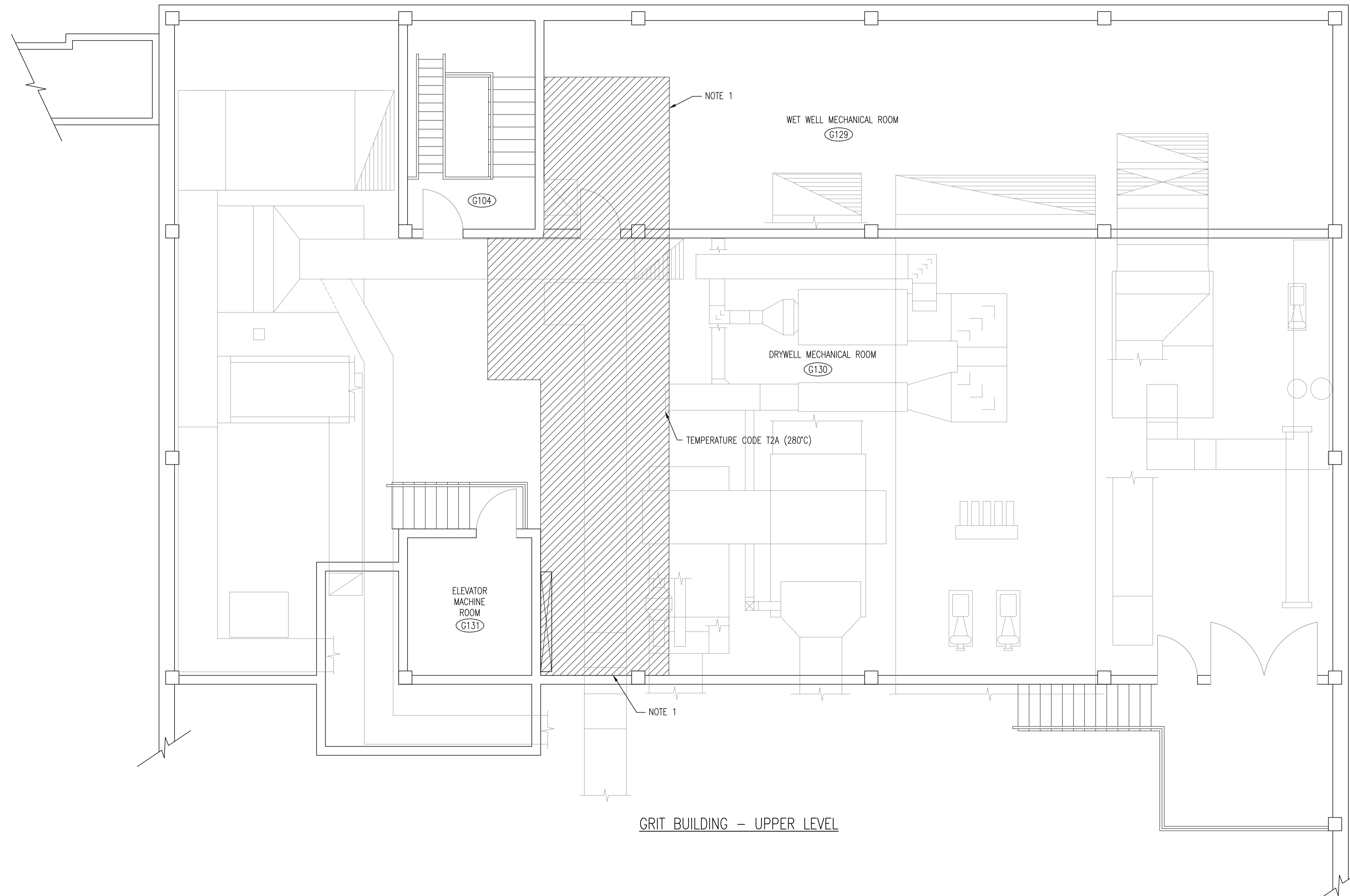

GRIT BUILDING - UPPER LEVEL

- NOTES:**
- AREAS WITHIN 0.9 METERS OF WET WELL EXHAUST FANS, ASSOCIATED DAMPERS AND UNSEALED DUCTWORK ARE TO BE CLASSIFIED AS ZONE 2 LOCATIONS. (NFPA 820)
 - THE INDICATED VENTILATION RATES ARE BASED ON EXISTING DOCUMENTATION AND HAVE NOT BEEN VERIFIED VIA ONSITE TESTING.

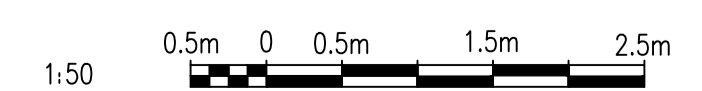

NO.	REVISIONS	DATE	DESIGN	CHECK
00	ISSUED FOR TENDER, BID OPP. 209-2011	2011/03/31	TMC	CJR

SNC-LAVALIN INC.
148 Nature Park Way
Winnipeg, MB, Canada R3P 0X7
204-786-8080

DESIGNED BY: I. CHURCH
DRAWN BY: S. COATES
SCALE: 1:50
DATE: 2009/11/05

CHECKED BY: C. REIMER
APPROVED BY: C. REIMER
RELEASED FOR CONSTRUCTION BY: N. HARRINGTON
DATE: 2011/03/31

CONSULTANT NO.: 112577-0113-47DD-1204

ENGINEER'S SEAL

ORIGINAL DRAWING
SEALED BY:
C. J. REIMER
SNC-LAVALIN
MEMBER #21968
2011/03/31
REV. 00

THE CITY OF WINNIPEG
WATER AND WASTE DEPARTMENT

SOUTH END WATER POLLUTION CONTROL CENTRE
ELECTRICAL CLASSIFICATION UPGRADES
ELECTRICAL CLASSIFICATION PLAN
GRIT BUILDING - UPPER LEVEL

CITY DRAWING NUMBER: 1-0102G-E0016
SHEET: 001
REV: 00
SIZE: A1