

PARTIAL ELEVATION

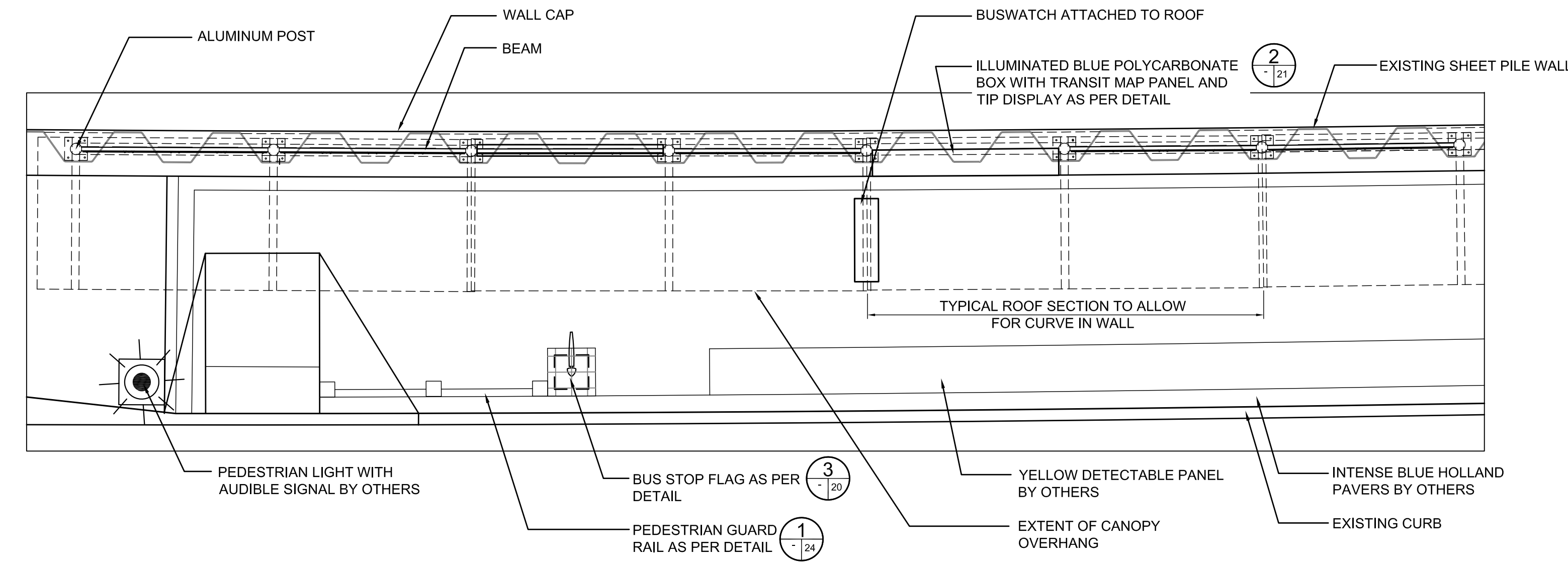

PLAN

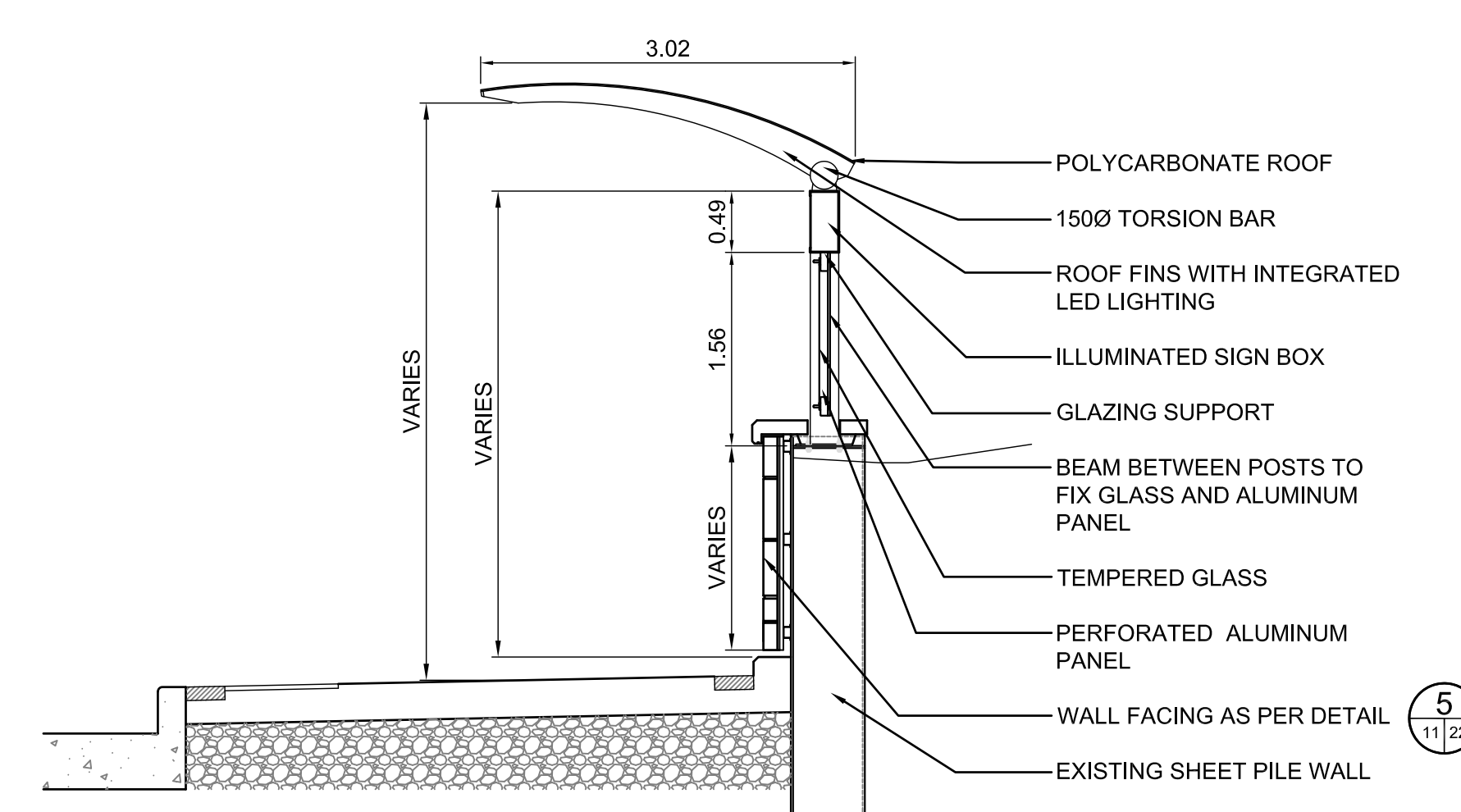

SECTION WITH STONE WALL

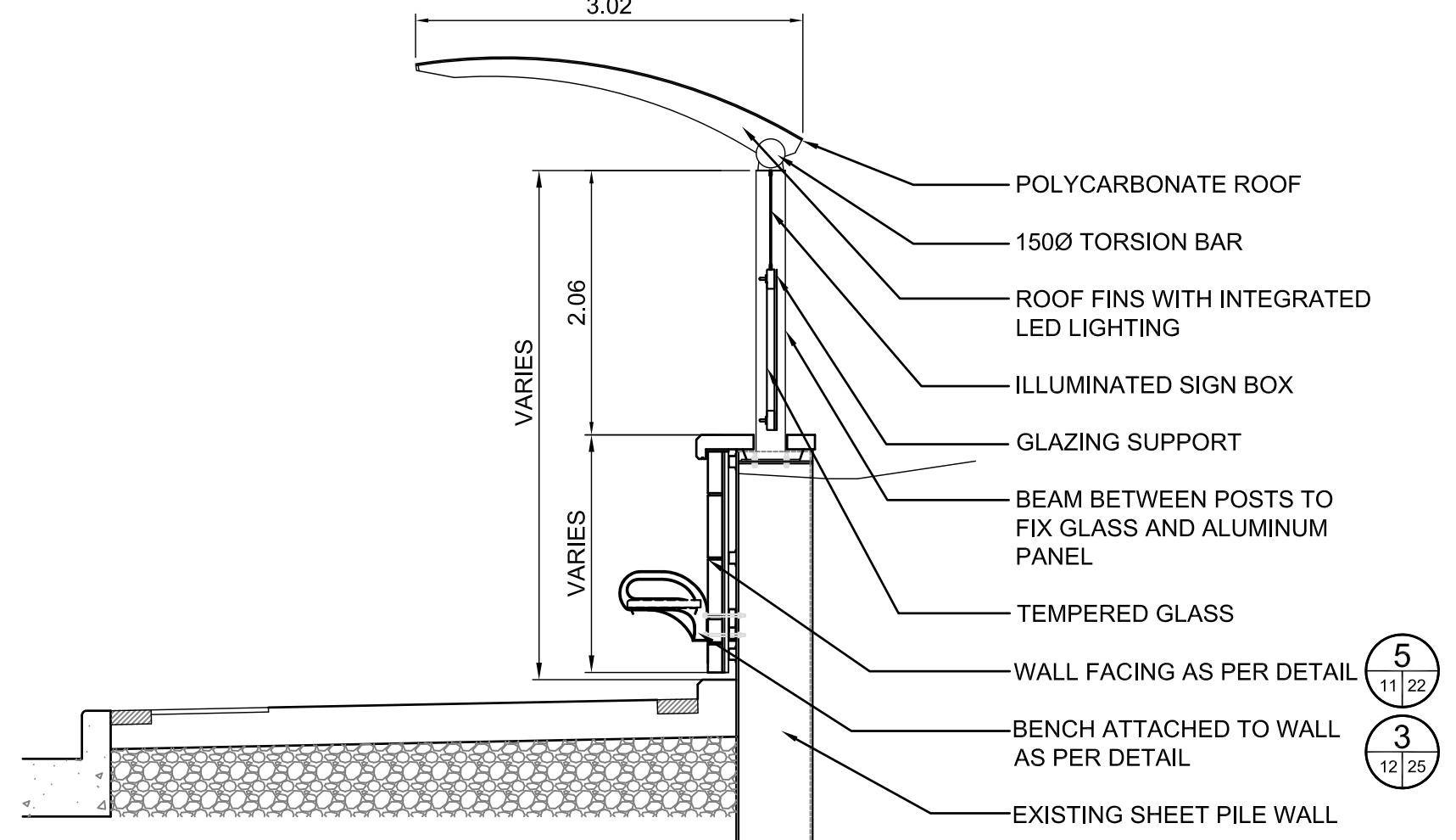

SECTION WITH BENCH ATTACHED TO WALL

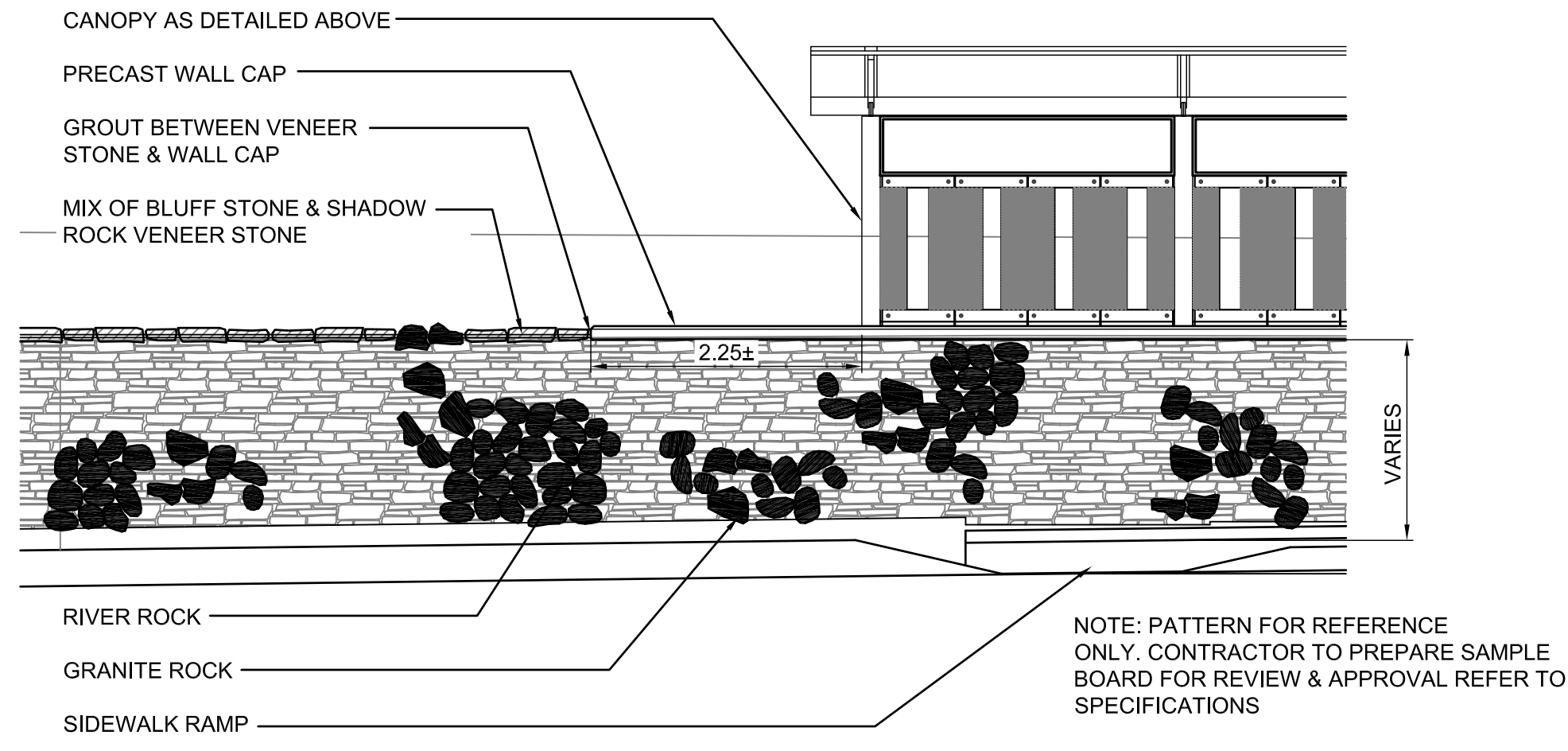

VENEER STONE PATTERN TRANSITION

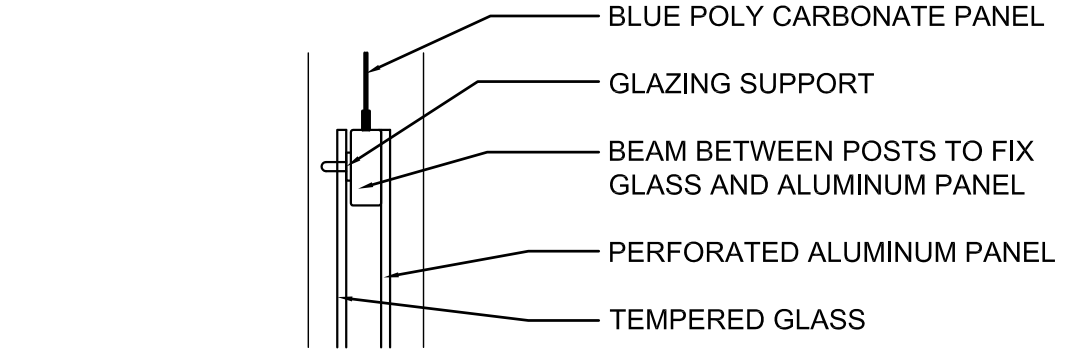

TOP

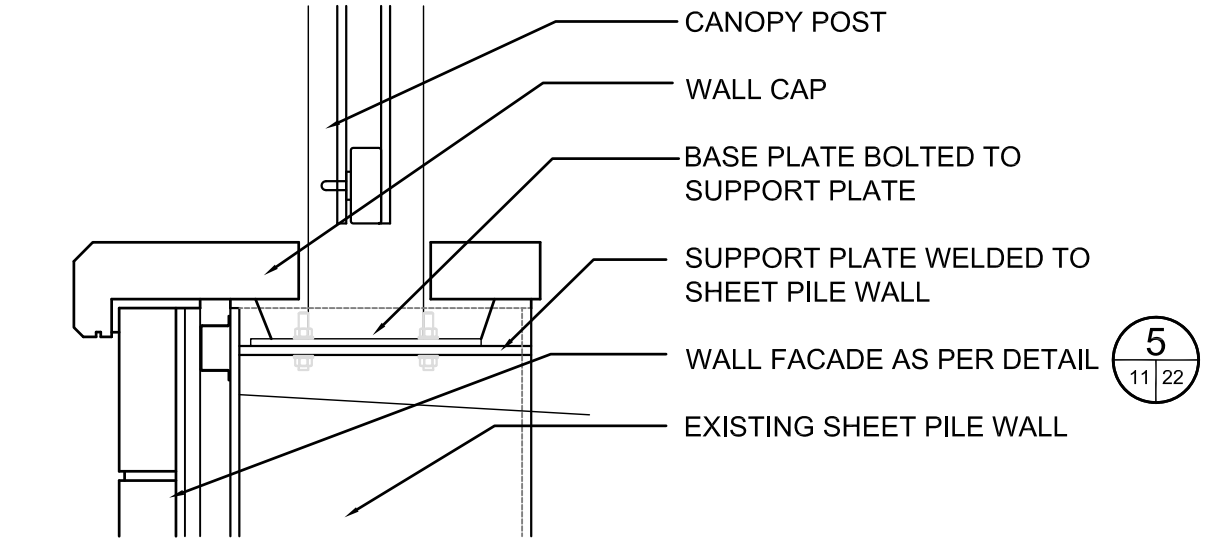

BOTTOM

BEAMS BETWEEN GLASS AND ALUMINUM PANEL

ALL DIMENSIONS PROVIDED FOR INFORMATION ON DESIGN EXTENT.

REFER TO ELECTRICAL DRAWINGS FOR ALL WIRING CONNECTIONS TO ALL SIGNS, CANOPIES AND STRUCTURES.

CONTRACTOR TO SUPPLY SHOP DRAWINGS STAMPED BY A STRUCTURAL ENGINEER LICENSED TO PRACTICE IN THE PROVINCE OF MANITOBA. SHOP DRAWINGS TO INCLUDE WALL THICKNESSES, MATERIALS, ETC. AS LISTED IN THE SPECIFICATIONS

HARKNESS STATION - CANOPY ON SHEET PILE WALL
N.T.S.

1/12/16

LOCATION UNDERGROUND <input checked="" type="checkbox"/>	APPROVED STRUCTURES <input checked="" type="checkbox"/>	B.M. ELEV. 	B.M. ELEV. 	DESIGNED BY SR/JW		LANDSCAPE ARCHITECT'S SEAL 		THE CITY OF WINNIPEG TRANSIT DEPARTMENT	CITY DRAWING NUMBER P-3325 - 17
SUPV. U/G STRUCTURES COMMITTEE	DATE	DRAWN BY JW/MH	CHECKED BY JW/SR	APPROVED BY 					RELEASED FOR CONSTRUCTION ORIGINAL SIGNED BY RANDY FINIGAS
NOTE: LOCATION OF UNDERGROUND STRUCTURES AS SHOWN ARE BASED ON THE BEST INFORMATION AVAILABLE. BUT NO GUARANTEE IS GIVEN THAT ALL EXISTING UTILITIES ARE SHOWN OR THAT THE GIVEN LOCATIONS ARE EXACT. CONFIRMATION OF EXISTENCE AND EXACT LOCATION OF ALL SERVICES MUST BE OBTAINED FROM THE INDIVIDUAL UTILITIES BEFORE PROCEEDING WITH CONSTRUCTION.				HOR. SCALE -		DATE: APRIL 20, 2011	CANOPY ON SHEET PILE WALL	CONSULTANT DRAWING NUMBER C7-L-5006-T	
1 ISSUED FOR TENDER	20/04/11	JW	DATE	2011-04-20					

X:\08-028_Southwestern_BRT_Corridor\dwg\2010\Contract_7\TENDER_SET\shelters_2011-04-11.dwg