

CURVE DATA					
#	R.	$\Delta c$	$T_c$	L.	L.C.
C1	496.500	5°03'30"	21.930	43.832	43.818
C2	18.500	86°44'31"	17.477	28.008	25.409

WARSAW AVENUE						
SEGMENT	STATION (START)	STATION (END)	NORTHING (START)	EASTING (START)	NORTHING (END)	EASTING (END)
L1	0+100.000	0+187.196	5526019.228	633325.035	5526062.008	633401.015
L2	0+187.196	0+245.420	5526062.008	633401.015	5526088.499	633452.864
C1	0+245.420	0+289.253	5526088.499	633452.864	5526110.137	633490.967
L3	0+289.253	0+333.725	5526110.137	633490.967	5526133.784	633528.631
C2	0+333.725	0+361.733	5526133.784	633528.631	5526158.382	633534.996
L4	0+361.733	0+450.437	5526158.382	633534.996	5526236.067	633492.177

PEMBINA HIGHWAY						
SEGMENT	STATION (START)	STATION (END)	NORTHING (START)	EASTING (START)	NORTHING (END)	EASTING (END)
L5	11+907.725	12+012.501	5526052.164	633376.057	5526154.387	633399.046

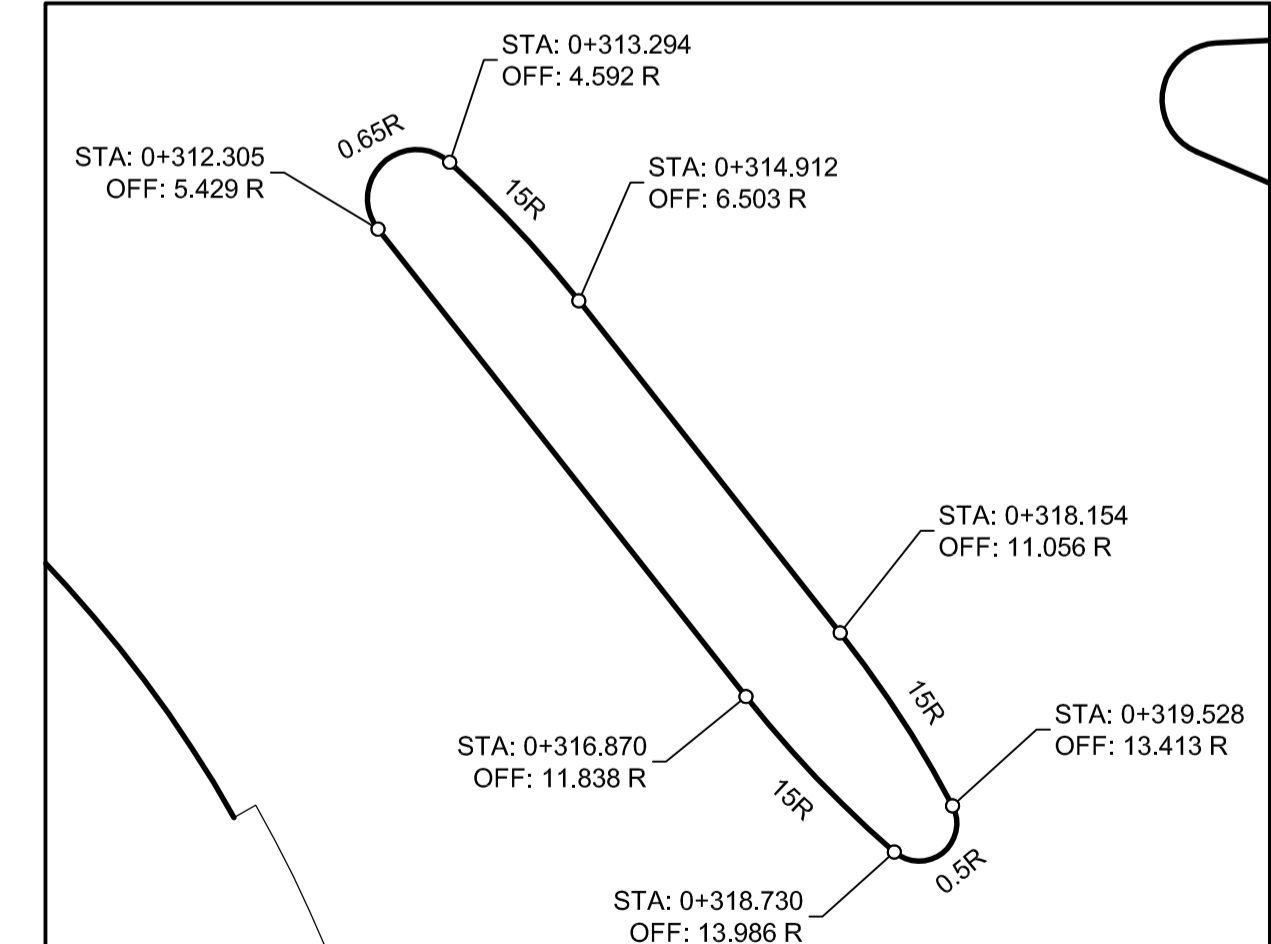
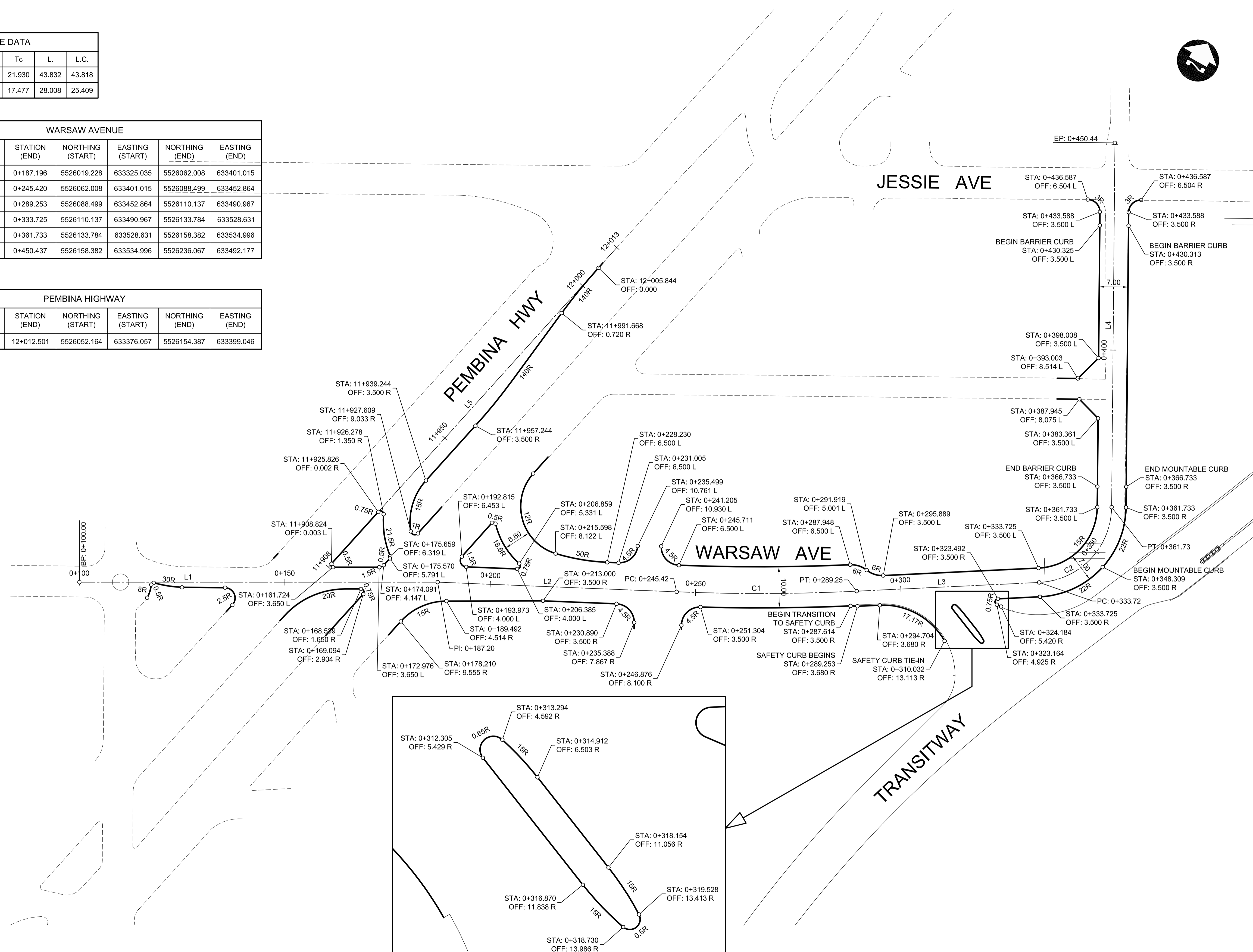

SCALE 1:100



<b>LOCATION UNDERGROUND STRUCTURES</b> SUPV. U/G STRUCTURES COMMITTEE DATE	<b>APPROVED STRUCTURES</b> DATE	B.M. ELEV.	DESIGNED BY RTP DRAWN BY TJH CHECKED BY ORIGINAL SIGNED BY TARAN J. PETERS APPROVED BY ORIGINAL SIGNED BY DAVE P. KRAHN		ENGINEER'S SEAL 		CITY DRAWING NUMBER P-3325-05 SHEET 05 OF 28
NOTE: LOCATION OF UNDERGROUND STRUCTURES AS SHOWN ARE BASED ON THE BEST INFORMATION AVAILABLE, BUT NO GUARANTEE IS GIVEN THAT ALL EXISTING UTILITIES ARE SHOWN OR THAT THE GIVEN LOCATIONS ARE EXACT. CONFIRMATION OF EXISTENCE AND EXACT LOCATION OF ALL SERVICES MUST BE OBTAINED FROM THE INDIVIDUAL UTILITIES BEFORE PROCEEDING WITH CONSTRUCTION.			HOR. SCALE 1 : 500 VERTICAL	RELEASED FOR CONSTRUCTION ORIGINAL SIGNED BY RANDY FINGAS DATE 04/20/11	CONSULTANT PROJECT NO. 088813	<b>SOUTHWEST RAPID TRANSIT CORRIDOR - STAGE 1</b> <b>STATION CONSTRUCTION, WARSAW RECONSTRUCTION &amp; ASSOCIATED WORKS</b>	CONSULTANT DRAWING NUMBER C7-C3001-T
<b>HORIZONTAL GEOMETRY</b>							

G:\CAD\088813\Contract\Roadway\C7-Control-Line-Geometry.dwg