

WATER SERVICE INFORMATION					
ADDRESS	SIZE(mm) & TYPE (STREET)	SIZE(mm) & TYPE (PROP.)	SHORT & LONG MEASUREMENT	CORP. LOCATION	REMARKS
540 ST ANNE'S ST COMMERCIAL	50 COPPER	50 COPPER	4.16 WEL BLDG 59.32 WWL ST ANNE'S	OPP S/C	SERV. OFF STERLING

* SERVICES TO BE RENEWED TO R UPON CONFIRMATION BY THE CONTRACTOR OF EXISTING LEAD SERVICE.

NOTE: CHAINAGES SHOWN ARE ALONG W. R. OF ST ANNE'S RD

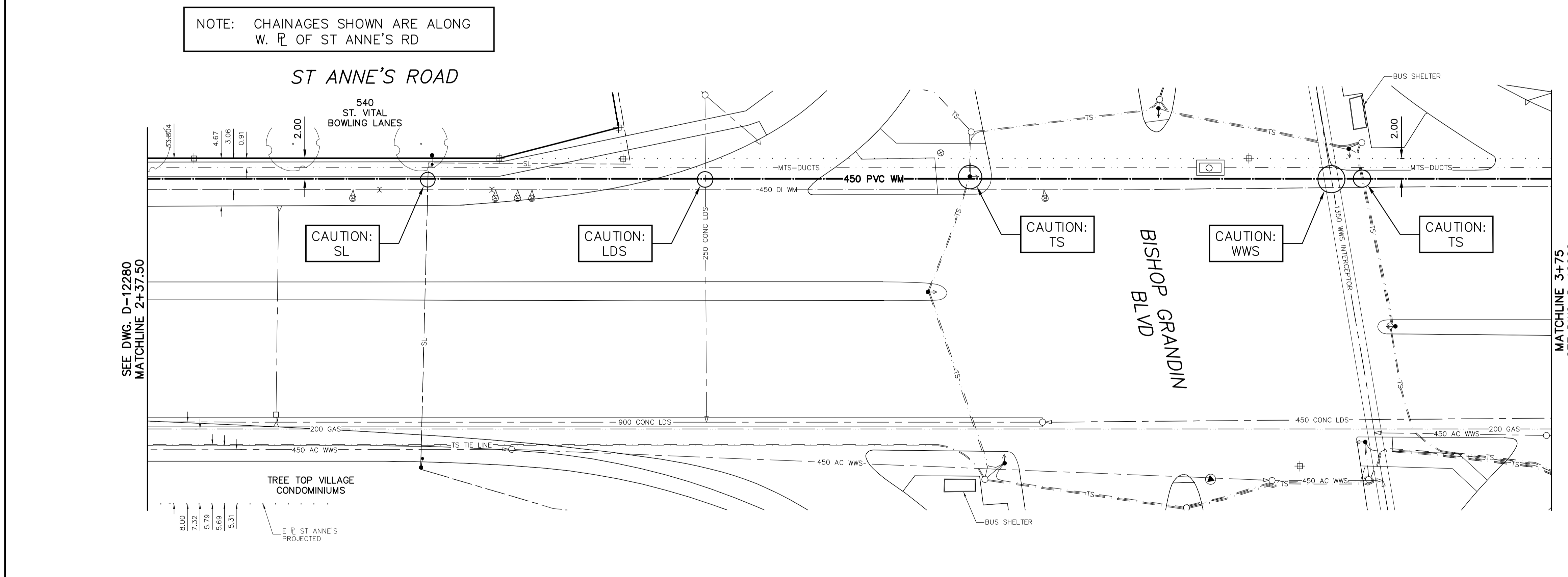

- CONSTRUCTION NOTES**
- EXPOSE EXISTING WATERMAIN & CONFIRM INVERTS PRIOR TO CONSTRUCTION.
 - LOCATION OF ALL SERVICES TO BE CONFIRMED IN THE FIELD.
 - INSTALL WATERMAIN BY TRENCHLESS METHODS.
 - TRENCHES AND EXCAVATIONS WITHIN 1 METRE OF A PAVED AREA INCLUDING SIDEWALKS SHALL BE CLASS 3 BACKFILL.
 - ALL MATERIALS SHALL CONFORM TO THE CITY OF WINNIPEG STANDARD CONSTRUCTION SPECIFICATIONS.
 - MINIMUM COVER TO TOP OF WATERMAIN SHALL BE 2.4 m.
 - REPLACE ALL EXISTING LEAD SERVICES FROM PROPOSED WATERMAIN TO R.
 - NOTIFY ALL AFFECTED RESIDENTS AND BUSINESSES 24 HOURS IN ADVANCE OF ANY WATER SHUTDOWNS OR DISRUPTION OF SERVICE.

NOTE: ALL VALVES TO BE INSTALLED CLOCKWISE TO CLOSE

WARNING

IF POWER EQUIPMENT OR EXPLOSIVES ARE TO BE USED FOR EXCAVATION ON THIS PROJECT THE CONTRACTOR MUST:

- NOTIFY THE GAS COMPANY OF THE PROPOSED LOCATION OF EXCAVATION.
- TAKE PRECAUTION TO AVOID DAMAGE TO GAS COMPANY INSTALLATIONS.

SEE PROVINCIAL REGULATION 210/72 FOR DETAILS

METRIC
WHOLE NUMBERS INDICATE MILLIMETRES
DECIMALIZED NUMBERS INDICATE METRES

200 WM	WATERMAIN	200 WM	SL, HYDRO	150 WM	WATERMAIN	150 WM
⊕	HYDRANT	⊕	MTS	⊕	HYDRANT	⊕
⊙	VALVE	⊙	TRAFFIC SIGNALS	⊕	VALVE	⊕
⊖	LAND DRAINAGE SEWER	⊖	GAS	⊖	LAND DRAINAGE SEWER	⊖
⊗	WASTEWATER SEWER	⊗	SURVEY BAR	⊗	WASTEWATER SEWER	⊗
○	MANHOLE	○	FENCE	⊕	PROFILE	⊕
□	CATCH BASIN	■	POLE - HYDRO, MTS	⊕	GROUND ABOVE PIPE	⊕
▽	CURB INLET	▽	CURB STOP	⊕	DITCH (NORTH & WEST)	⊕
∇	REDUCER	∇	GUY ANCHOR	⊕	DITCH (SOUTH & EAST)	⊕
×	COUPLER	×	LIGHT STANDARD	⊕	GUTTER (NORTH & WEST)	⊕
⊕	ANODE	⊕	TREE	⊕	GUTTER (SOUTH & EAST)	⊕
EXISTING	LEGEND-PLAN	PROPOSED	EXISTING	LEGEND-PLAN	PROPOSED	EXISTING

LOCATION APPROVED UNDERGROUND STRUCTURES		B.M. ELEV.	FIELD BOOK #:
NO.	REVISIONS		

CITY OF WINNIPEG WATER AND WASTE ENGINEERING DIVISION

DESIGNED BY: RC
CHECKED BY: SC

DRAWN BY: CJH
APPROVED BY: SC

HOR. SCALE: 1:250
VERTICAL: 1:50

RELEASED FOR CONSTRUCTION
KAS ZUREK
DATE: 2011 02 11
DATE: 03-03-11

ENGINEER'S SEAL

ORIGINAL SIGNED BY
R.W. CARROLL
02-14-11

BID OPPORTUNITY: 12-2011
FILENAME: D-12281.dwg
PLOT DATE: 2011 03 03

THE CITY OF WINNIPEG WATER AND WASTE DEPARTMENT

2011 WATERMAIN RENEWALS CONTRACT 7
ST ANNE'S ROAD
45 S OF BISHOP GRANDIN BOULEVARD TO BISHOP GRANDIN BOULEVARD

SHEET 4 OF 6
CITY DRAWING NUMBER
D-12281