

- CONSTRUCTION NOTES**
1. EXPOSE EXISTING WATERMAIN & CONFIRM INVERTS PRIOR TO CONSTRUCTION.
 2. LOCATION OF ALL SERVICES TO BE CONFIRMED IN THE FIELD.
 3. INSTALL WATERMAIN BY TRENCHLESS METHODS.
 4. TRENCHES AND EXCAVATIONS WITHIN 1 METRE OF A PAVED AREA INCLUDING SIDEWALKS SHALL BE CLASS 3 BACKFILL.
 5. ALL MATERIALS SHALL CONFORM TO THE CITY OF WINNIPEG STANDARD CONSTRUCTION SPECIFICATIONS.
 6. MINIMUM COVER TO TOP OF WATERMAIN SHALL BE 2.4 m.
 7. REPLACE ALL EXISTING LEAD SERVICES FROM PROPOSED WATERMAIN TO R.
 8. NOTIFY ALL AFFECTED RESIDENTS AND BUSINESSES 24 HOURS IN ADVANCE OF ANY WATER SHUTDOWNS OR DISRUPTION OF SERVICE.

WATER SERVICE INFORMATION

ADDRESS	SIZE(mm) & TYPE (STREET)	SIZE(mm) & TYPE (PROP.)	SHORT & LONG MEASUREMENT	CORP. LOCATION	REMARKS
404 QU'APPELLE AV COMMERCIAL	25 COPPER	25 COPPER	25.71 EEWL	0.6 W OF S/C	
404 QU'APPELLE AV COMMERCIAL	25 COPPER	25 COPPER	25.91 EEWL	0.6 W OF S/C	
393 KENNEDY ST COMMERCIAL	150 PVC	150 PVC	18.08 NNBL	OPP VALVE	
393 KENNEDY ST COMMERCIAL	150 PVC	150 PVC	17.70 NNBL	QU'APPELLE	OPP VALVE
374 EDMONTON ST COMMERCIAL	25 COPPER	25 COPPER	9.44 WEWL	OPP S/C	SERVICED OFF QU'APPELLE
374 EDMONTON ST COMMERCIAL	150 COPPER	150 COPPER	12.98 WWL EDMONTON	OPP VALVE	SERVICED OFF QU'APPELLE
374 EDMONTON ST SPRINKLER	50 PVC	50 PVC	14.11 WEWL	OPP VALVE	SERVICED OFF QU'APPELLE
400 EDMONTON ST COMMERCIAL	50 COPPER	50 COPPER	27.30 NNBL	OPP S/C	

* SERVICES TO BE RENEWED TO R UPON CONFIRMATION BY THE CONTRACTOR OF EXISTING LEAD SERVICE. OBTAIN APPROVAL FROM CONTRACT ADMINISTRATOR PRIOR TO RENEWAL.

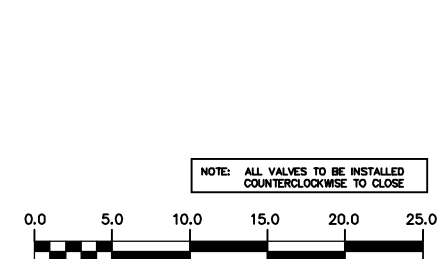
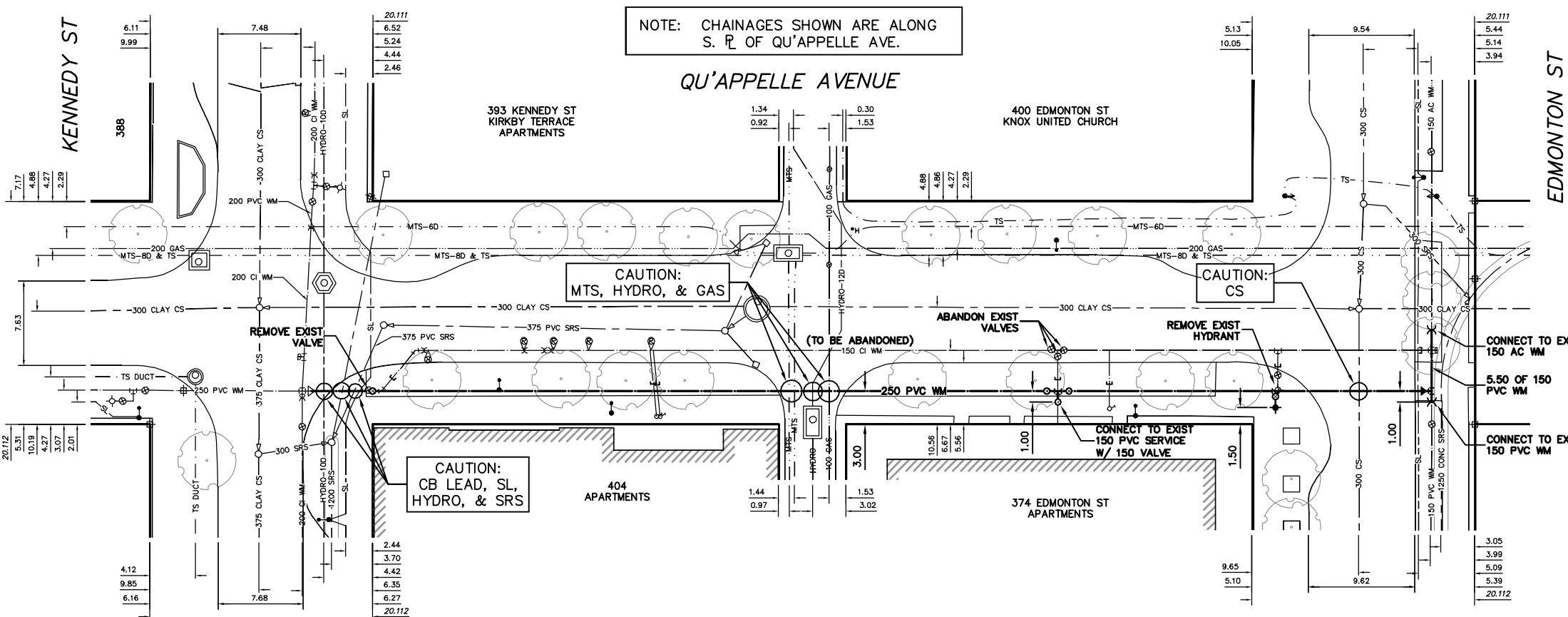

METRIC
WHOLE NUMBERS INDICATE MILLIMETRES
DECIMALIZED NUMBERS INDICATE METRES

WARNING
IF POWER EQUIPMENT OR EXPLOSIVES ARE TO BE USED FOR EXCAVATION ON THIS PROJECT THE CONTRACTOR MUST:
1) NOTIFY THE GAS COMPANY OF THE PROPOSED LOCATION OF EXCAVATION.
2) TAKE PRECAUTION TO AVOID DAMAGE TO GAS COMPANY INSTALLATIONS.
SEE PROVINCIAL REGULATION 210/72 FOR DETAILS

200 WM	WATERMAIN	200 WM	SL, HYDRO	150 WM	WATERMAIN	150 WM	LOCATION APPROVED UNDERGROUND STRUCTURES	B.M. ELEV.	FIELD BOOK #	DESIGNED BY: RC CHECKED BY: SC	ENGINEER'S SEAL ORIGINAL SIGNED BY R.W. CARROL 11/01/18	THE CITY OF WINNIPEG WATER AND WASTE DEPARTMENT 2011 WATERMAIN RENEWALS CONTRACT 2 QU'APPELLE AVENUE KENNEDY STREET TO EDMONTON STREET	SHEET 10 OF 12 CITY DRAWING NUMBER D-12292
525 LDS	LAND DRAINAGE SEWER	525 LDS	50 GAS	300 LDS	LAND DRAINAGE SEWER	300 LDS	SUPV. U/G STRUCTURES COMMITTEE	POSTED TO LBS					
375 WWS	WASTEWATER SEWER	375 WWS	375 WWS	250 WWS	WASTEWATER SEWER	250 WWS	NOTE: LOCATION OF UNDERGROUND STRUCTURES AS SHOWN ARE BASED ON THE BEST INFORMATION AVAILABLE BUT NO GUARANTEE IS GIVEN THAT ALL EXISTING UTILITIES ARE SHOWN OR THAT THE GIVEN LOCATIONS ARE EXACT. CONFIRMATION OF EXISTENCE AND EXACT LOCATION OF ALL SERVICES MUST BE OBTAINED FROM THE INDIVIDUAL UTILITIES BEFORE PROCEEDING WITH CONSTRUCTION.	NO.	REVISIONS	DATE	2011 01 17		
○	MANHOLE	●	★	○	○	○							
□	CATCH BASIN	■	●	○	○	○							
▽	CURB INLET	▽	○	○	○	○							
∠	REDUCER	∠	∠	∠	∠	∠							
X	COUPLER	X	X	X	X	X							
⊕	ANODE	⊕	⊕	⊕	⊕	⊕							
○	EXISTING	○	○	○	○	○							
○	LEGEND-PLAN	○	○	○	○	○							
○	PROPOSED	○	○	○	○	○							
○	EXISTING	○	○	○	○	○							
○	LEGEND-PLAN	○	○	○	○	○							
○	PROPOSED	○	○	○	○	○							
○	EXISTING	○	○	○	○	○							
○	LEGEND-PROFILE	○	○	○	○	○							
○	PROPOSED	○	○	○	○	○							
○	EXISTING	○	○	○	○	○							
○	LEGEND-PROFILE	○	○	○	○	○							
○	PROPOSED	○	○	○	○	○							
○	EXISTING	○	○	○	○	○							