

DEMOLITION/REMOVAL NOTES:

- REMOVE ALL GRAVEL, ASPHALT AND CONCRETE PAVEMENT WITHIN THE SHOWN PROPOSED LIMITS OF WORK.
- REMOVE AND SALVAGE ALL PAVING STONE WITHIN THE PROPOSED LIMITS OF WORK FOR RE-INSTALLATION. DELIVER REMAINING SALVAGED PAVING STONES TO COMMUNITY CENTRE FACILITY MANAGER FOR FUTURE RE-USE.
- REMOVE AND SALVAGE ALL LANDSCAPE RAIL TIES, BENCHES, AND GARBAGE BINS AND DELIVER TO COMMUNITY CENTRE FACILITY MANAGER FOR FUTURE RE-USE.
- ALL REMOVAL AND SALVAGE WORK SHALL BE DONE IN A CAREFUL, WORKMANLIKE MANNER. THE USE OF EQUIPMENT WHICH MIGHT DAMAGE PORTIONS OF THE MATERIALS TO BE SALVAGED WILL NOT BE PERMITTED. SALVAGEABLE MATERIALS SHALL BE CLEANED, SORTED AND STORED AS DIRECTED BY THE CONTRACT ADMINISTRATOR.

EXISTING SITE PLAN
1:100

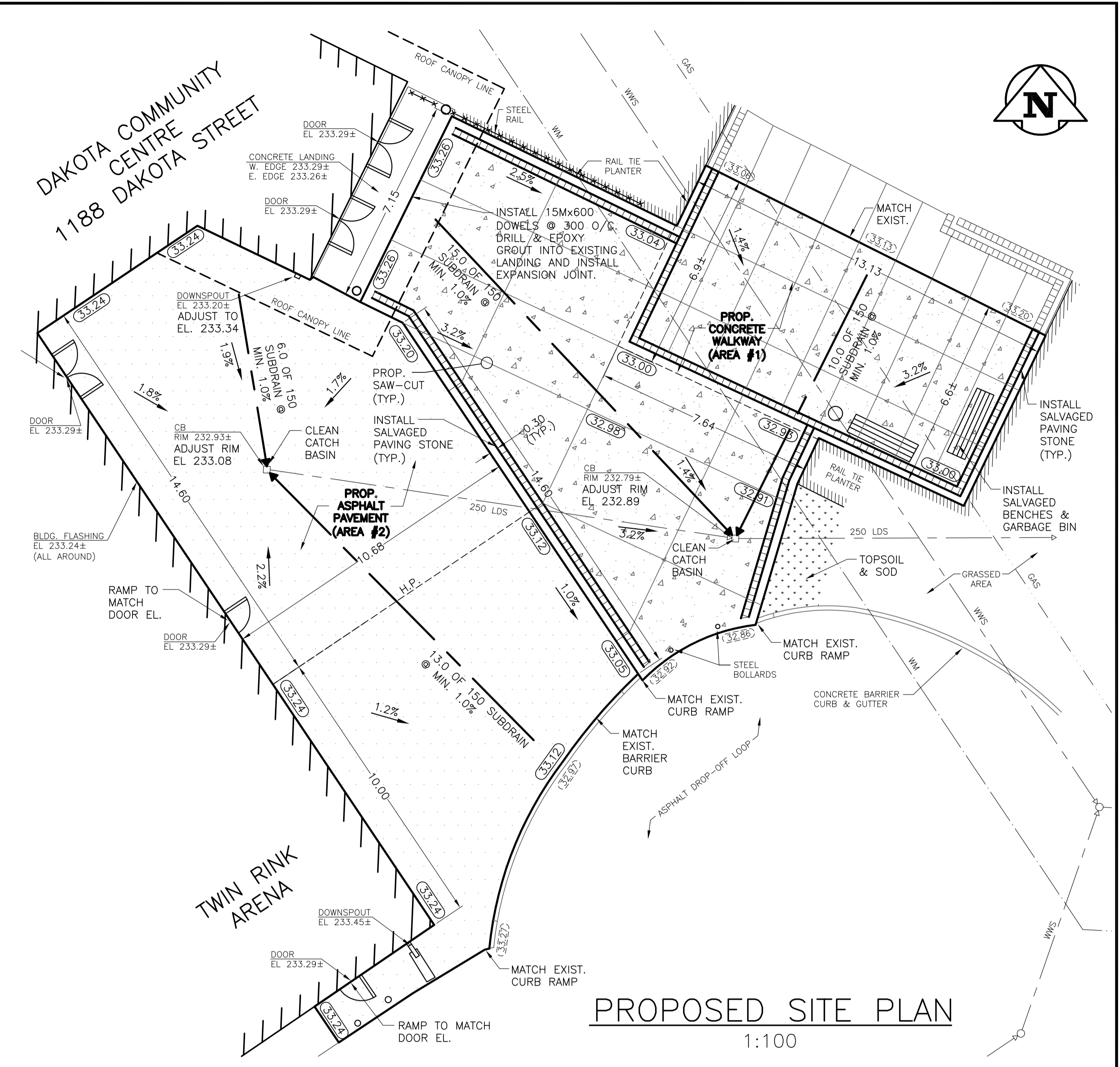

PROPOSED SITE PLAN
1:100

GENERAL CONSTRUCTION NOTES:

- ALL PRODUCTS INCORPORATED IN THE WORK SHALL CONFORM TO THE CITY WINNIPEG "STANDARD CONSTRUCTION SPECIFICATIONS" AND BE REGISTERED IN THE CITY OF WINNIPEG LISTING OF APPROVED PRODUCTS OR AS SPECIFIED ON THIS DRAWING. ALL CONSTRUCTION SHALL CONFORM TO THE CITY OF WINNIPEG "STANDARD CONSTRUCTION SPECIFICATIONS", LATEST EDITION.
- IT IS THE RESPONSIBILITY OF THE CONTRACTOR TO VERIFY THE LOCATIONS OF ALL UTILITIES, PIPES, SURVEY MARKERS, OR STRUCTURES, AND TO NOTIFY ALL RELEVANT UTILITIES PRIOR TO COMMENCEMENT OF CONSTRUCTION. THE CONTRACTOR SHALL NOTIFY THE CONTRACT ADMINISTRATOR OF ANY ERROR OR OMISSION PRIOR TO CONSTRUCTION.
- IN ACCORDANCE TO THE CITY OF WINNIPEG SURVEY INFRASTRUCTURE PROTECTION PROGRAM, THE CONTRACTOR SHALL NOTIFY THE GEOMATICS BRANCH A MINIMUM 3 DAYS PRIOR TO START OF CONSTRUCTION.
- DESCRIPTION OF PROPERTY LIMITS, AND EXISTING AND/OR PROPOSED FEATURES RELATIVE TO THESE LIMITS AS SHOWN ON THIS DRAWING DO NOT REPRESENT A LEGAL SURVEY. GENIVAR MAKES NO REPRESENTATION OR GUARANTEE THAT THE PROPERTY LIMIT INFORMATION IS ACCURATE. GENIVAR ACCEPTS NO RESPONSIBILITY FOR DAMAGES, IF ANY, SUFFERED BY ANY THIRD PARTY AS A RESULT OF DECISIONS OR ACTIONS BASED ON THIS DRAWING.
- ALL AREAS AFFECTED BY CONSTRUCTION TO BE RESTORED TO THE ORIGINAL CONDITION OR BETTER UNLESS NOTED OTHERWISE ON THE DRAWING. ALL REGRADED/DISTURBED SOA AREAS TO RECEIVE TOPSOIL AND SOD UNLESS NOTED OTHERWISE.

CAST-IN-PLACE CONCRETE

- ALL CONCRETE WORK SHALL BE PERFORMED IN ACCORDANCE WITH CAN/CSA-A23.1, A23.3-M77 INCLUDING COLD WEATHER PROTECTION REQUIREMENTS WHEN THE AMBIENT AIR TEMPERATURE FALLS BELOW 5 DEGREE CELSIUS.
 - CONCRETE STRENGTH AT 28 DAYS SHALL BE AS FOLLOWS UNLESS NOTED OTHERWISE:

LOCATION	MIN. f'c	SLUMP	MAX. AGG.	AIR CONTENT
WALKWAY:	30 MPa	80 ± 20 mm	20 mm	5-8%
 - CONTRACTOR SHALL REVIEW SAW-CUT PATTERNS WITH CONTRACT ADMINISTRATOR PRIOR TO CUTTING. SAW-CUTS SHALL BE 1/4 SLAB DEPTH AND CUTTING TO BE DONE NOT SOONER THAN 12 HOURS, AND NOT LATER THAN 24 HOURS AFTER THE SLAB IS CAST.
 - CONTRACTOR TO ARRANGE AND PROVIDE WATCHMAN ON SITE FOR MIN. 18 HOURS FOLLOWING COMPLETION OF ANY CONCRETE POUR FOR ANY DAY OF WORK.
- ANY CONCRETE DAMAGED OR DEFACED PRIOR TO SUITABLE CURING SHALL BE REPLACED AT THE CONTRACTOR'S EXPENSE.

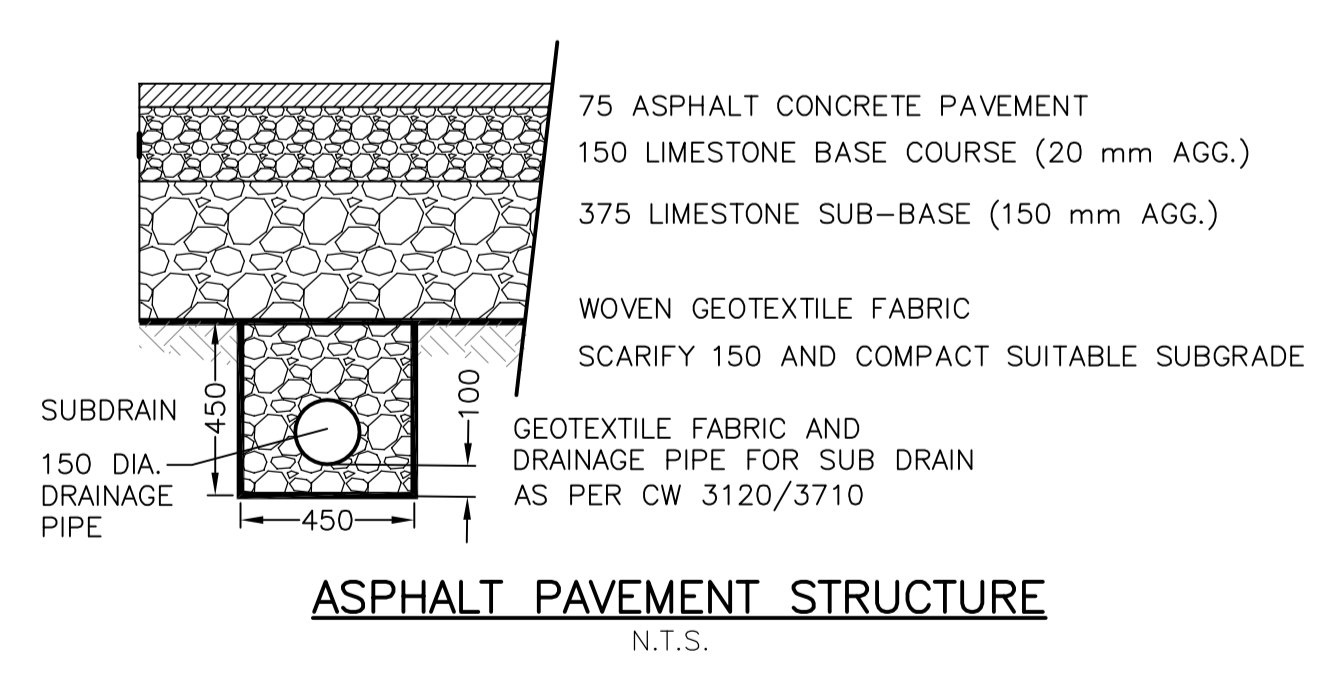
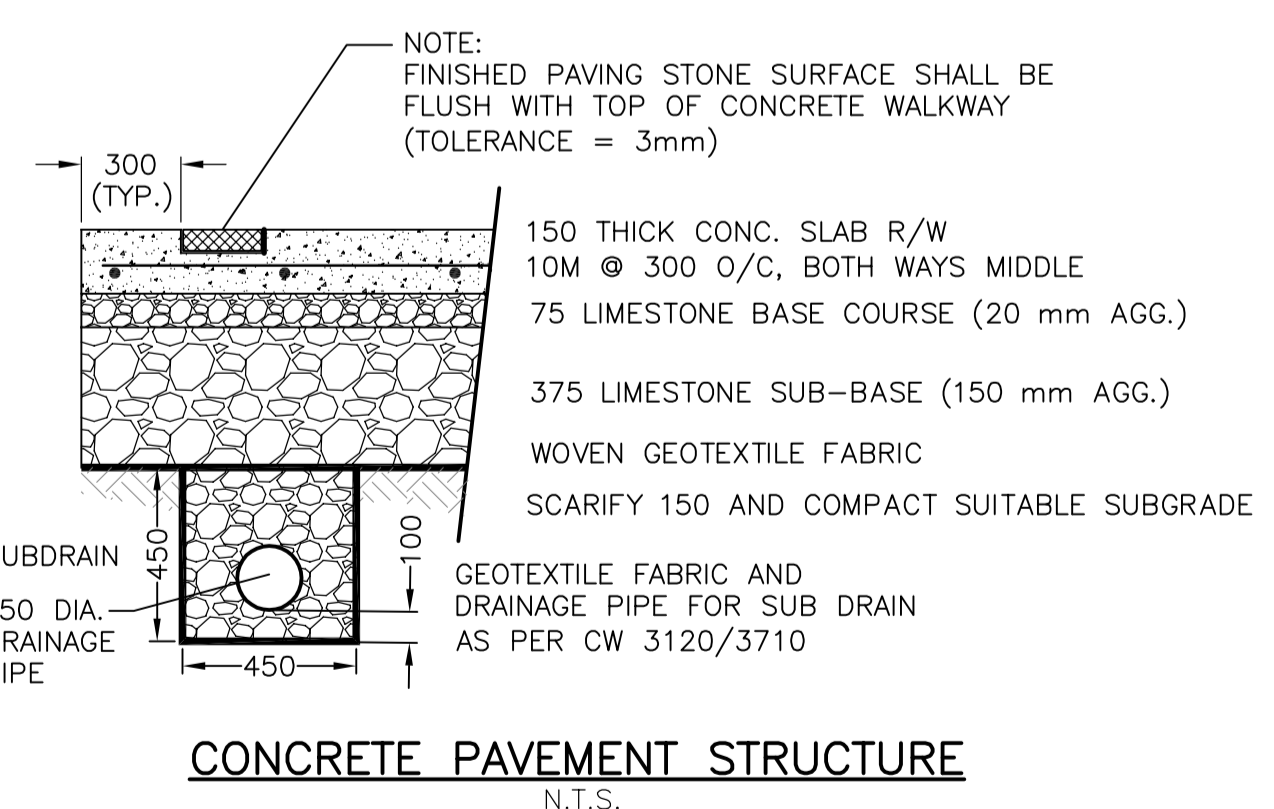

150 WWS	WATERMAIN	150 WWS	---	---	GAS	---	---
○	HYDRANT	●	---	---	HYDRO	---	---
⊗	VALVE	⊕	---	---	M.T.S.	---	---
300 LDS	LAND DRAINAGE SEWER	300 LDS	⊗	---	PEDESTAL	---	---
250 WWS	WASTE WATER SEWER	250 WWS	⊗	230.000	GROUND ELEVATION	30.00	---
○	MANHOLE	●	⊗	---	PAVEMENT ELEVATION	(30.00)	---
□	CATCH BASIN	■	---	---	PROPERTY LINE	---	---
△	CURB INLET	▲	⊕	---	SURVEY BAR	---	---
▽	SIGN	⊕	⊕	---	CURB STOP	---	---
○	LAMP STANDARD	●	⊕	---	TESTHOLE	---	---
•	UTILITY POLE	•	---	---	---	---	---
EXISTING	LEGEND - PLAN	PROPOSED	EXISTING	LEGEND - PLAN	PROPOSED	EXISTING	LEGEND - PROFILE

LOCATION APPROVED
UNDERGROUND STRUCTURES

SUPV. U/G STRUCTURES COMMITTEE	DATE

NOTE:
LOCATION OF UNDERGROUND STRUCTURES AS SHOWN ARE BASED ON THE BEST INFORMATION AVAILABLE BUT NO GUARANTEE IS GIVEN THAT ALL EXISTING UTILITIES ARE SHOWN OR THAT THE GIVEN LOCATIONS ARE EXACT. CONFIRMATION OF EXISTENCE AND EXACT LOCATION OF ALL SERVICES MUST BE OBTAINED FROM THE INDIVIDUAL UTILITIES BEFORE PROCEEDING WITH CONSTRUCTION.

C.W.B.M. 78-022 232.982m
84R671 - W. SIDE DAKOTA ST. ON CURVE N. OF PADDINGTON RD., TBLT. ON TOP OF 0.05m DIA. X 2.4m IRON PIPE, 1.5m W. OF W. CURB OF DAKOTA ST. & 24m N. OF 5th LAMP STANDARD FROM PADDINGTON RD.

NO.	ISSUED FOR REVIEW	DATE	BY
0	ISSUED FOR REVIEW	11/01/25	R.C.

GENIVAR
10 PRAIRIE WAY WINNIPEG, MANITOBA R2J 3J8
PH: (204)-477-6553 FAX: (204)-474-2864

DESIGNED BY	R.C.	CHECKED BY	D.T.B.
DRAWN BY	R.C.	APPROVED BY	B.D.E.

HOR. SCALE: 1:100
VERT. SCALE:

RELEASSED FOR CONSTRUCTION
DATE:

ENGINEER'S SEAL
PROVINCE OF MANITOBA
REGISTERED PROFESSIONAL ENGINEER
R. CABICHTING
Member 24617

THE CITY OF WINNIPEG
Winnipeg
PLANNING, PROPERTY & DEVELOPMENT

IMPROVEMENTS TO SITE DRAINAGE FOR THE DAKOTA COMMUNITY CENTRE
SITE PLAN - MAIN ENTRANCE

CITY DRAWING NO. 10-2011-C01
SHEET 1 OF 2
REV. 1 0

CONSULTANT DRAWING NO. 08173-C01-RO

APEGM
Certificate of Authorization
GENIVAR Inc.
No. 5079 Date/January 25, 2011

METRIC
WHOLE NUMBERS INDICATE MILLIMETRES
DECIMALIZED NUMBERS INDICATE METRES