

SEDIMENT CONTROL MEASURES

1. PROTECT ALL EXPOSED SURFACES AND CONTROL ALL RUNOFF DURING CONSTRUCTION.
2. ALL EROSION CONTROL MEASURES TO BE IN PLACE BEFORE STARTING CONSTRUCTION AND REMAIN IN PLACE UNTIL RESTORATION IS COMPLETED.
3. MAINTAIN EROSION CONTROL MEASURES DURING CONSTRUCTION.
4. ALL COLLECTED SEDIMENT TO BE DISPOSED OF AT AN APPROVED LOCATION.
5. MINIMIZE AREA DISTURBED DURING CONSTRUCTION.
6. ALL DEWATERING TO BE DISPOSED OF IN AN APPROVED SEDIMENTATION BASIN.
7. PROTECT ALL CATCH BASINS, MANHOLES AND PIPE ENDS FROM SEDIMENT INTRUSION WITH GEOTEXTILE (TERRAFIX 270 R).
8. KEEP ALL SLUMPS CLEAN DURING CONSTRUCTION.
9. PREVENT WIND-BLOWN DUST.
10. STRAW BALES TO BE USED IN LOCALIZED AREAS AS DIRECTED BY THE ENGINEER DURING CONSTRUCTION FOR WORKS WHICH ARE IN OR ADJACENT TO FLOOD LINES, FILL LINES AND HAZARDOUS SLOPES.
11. STRAW BALES TO BE TERMINATED BY ROUNDING BALES TO CONTAIN AND FILTER RUNOFF.
12. OBTAIN APPROVAL FROM CITY OF WINNIPEG PRIOR TO CONSTRUCTION FOR WORKS WHICH ARE IN, OR ADJACENT TO FLOOD LINES, FILL LINES AND HAZARDOUS SLOPES.
13. ALL SILT FENCING AND DETAILS ARE AT THE MINIMUM TO BE CONSTRUCTED IN ACCORDANCE WITH THE MINISTRY OF NATURAL RESOURCES GUIDELINES ON EROSION AND SEDIMENT CONTROL FOR URBAN CONSTRUCTION SITES.
14. ALL OF THE ABOVE NOTES AND ANY SEDIMENT & EROSION CONTROL MEASURES ARE AT THE MINIMUM TO BE IN ACCORDANCE WITH THE MINISTRY OF NATURAL RESOURCES GUIDELINES ON EROSION AND SEDIMENT CONTROL FOR URBAN CONSTRUCTION SITES.

STORM WATER MANAGEMENT

PRE-DEVELOPMENT AREAS:
 TOTAL AREA OF SITE = 4969 m²
 TOTAL AREA OF BUILDINGS = 0 m² (0%)
 TOTAL AREA OF ASPHALT/CONCRETE/PARKING AREAS (HARD SURFACE) = 0 m² (0%)
 TOTAL AREA OF LANDSCAPING = 4969 m² (100%)

POST-DEVELOPMENT AREAS:
 TOTAL AREA OF SITE = 4969 m²
 TOTAL AREA OF BUILDINGS = 690 m²
 TOTAL AREA OF ASPHALT/CONCRETE/PARKING AREAS (HARD SURFACE) = 1694 m²
 TOTAL AREA OF LANDSCAPING = 2585 m²

LOT GRADING CERTIFICATE

I HEREBY CERTIFY THAT THE PROPOSED GRADING AND APPURTENANT DRAINAGE WORKS COMPLY WITH SOUND ENGINEERING DESIGN AND THAT THE PROPOSED GRADING IS IN GENERAL CONFORMITY FOR DRAINAGE AND RELATIVE ELEVATIONS, WITH THE ADJACENT PROPERTIES.

R. C. STEVENSON, P.ENG.

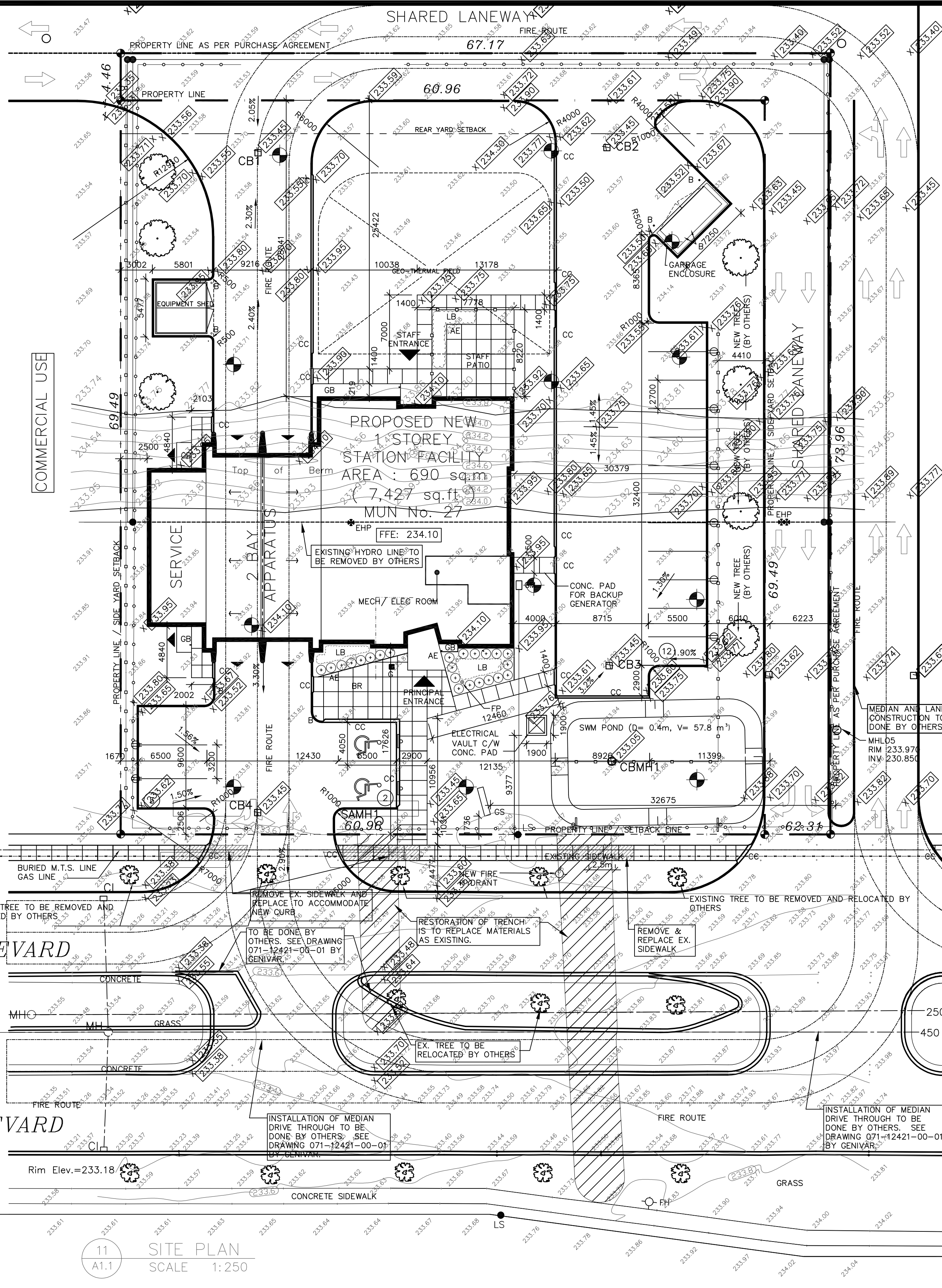
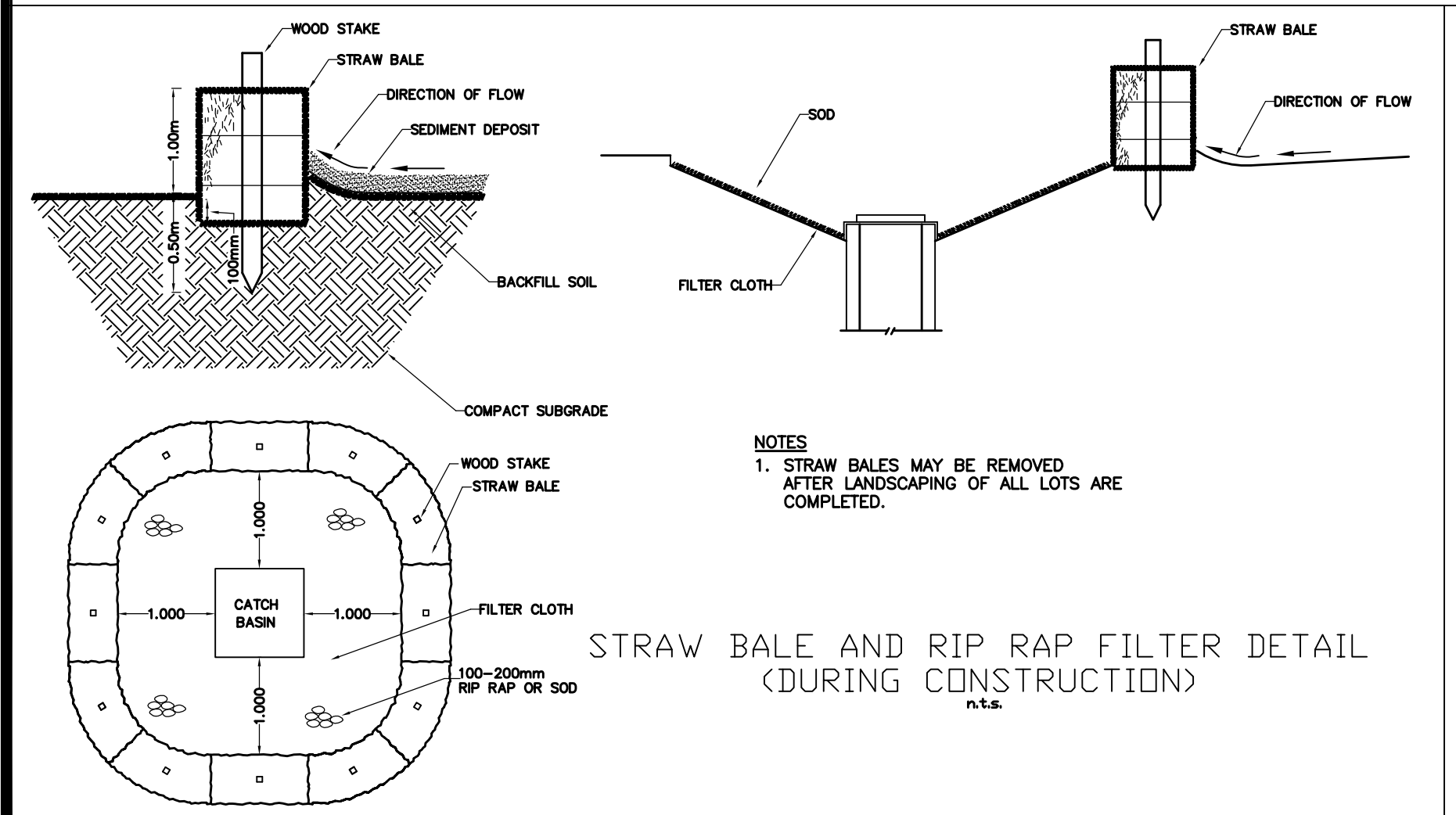
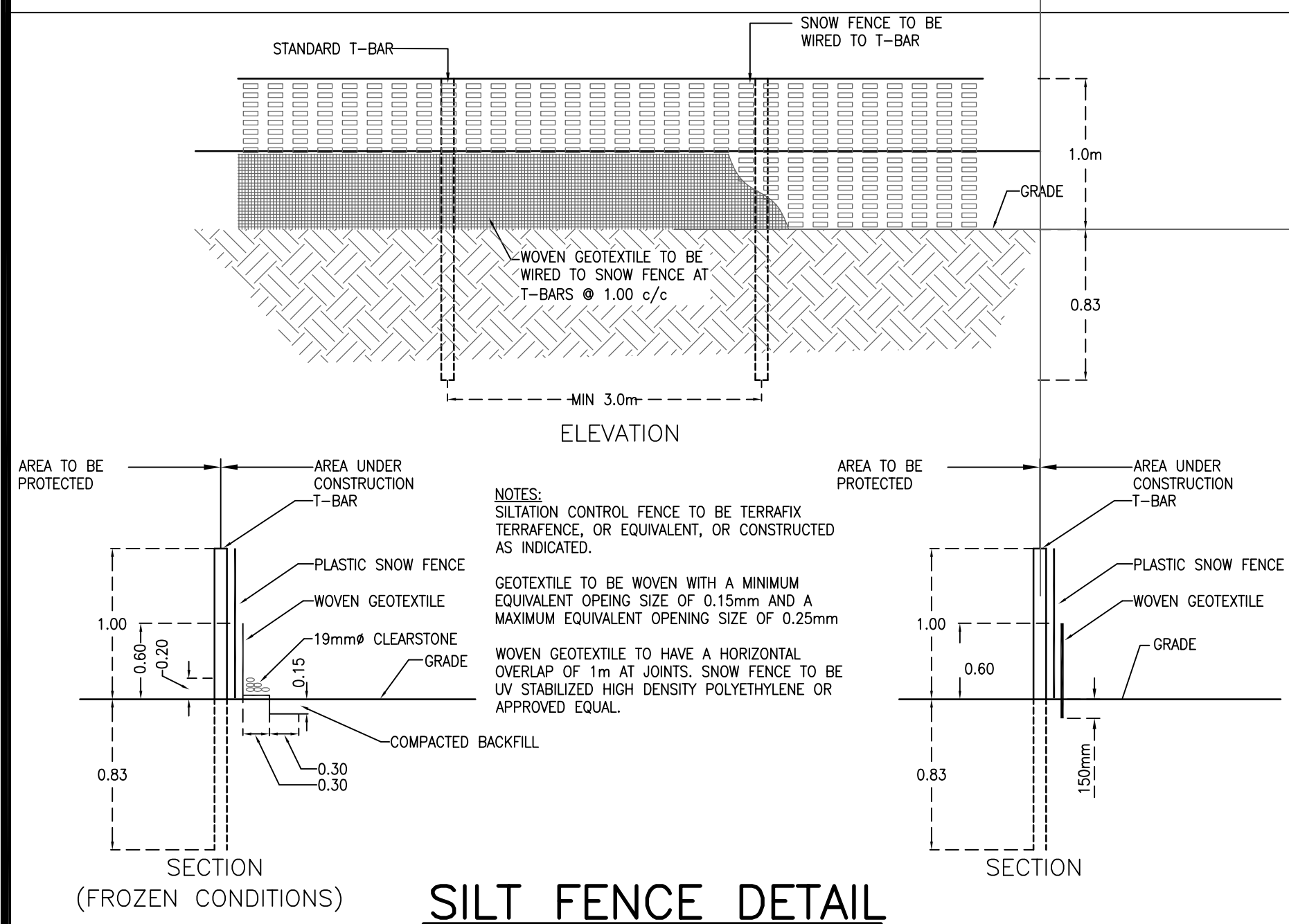

ISSUES:

1	23 SEPT 10	BUILDING PERMIT APPLICATION
2	28 NOV 10	COMPATIBILITY WITH GENIVAR
3		

KEY PLAN

N.T.S.

STEVENSON ENGINEERING LIMITED
 1035 HYDE PARK ROAD LONDON ONTARIO N6H 5L4
 TEL: (519) 433-5161 FAX: (519) 433-5162

PROJECT No. 2010-08 APDM LICENSE # 4851

© COPYRIGHT MURPHY & MURPHY ARCHITECT 2009
 NOT TO BE REPRODUCED WITHOUT CONSENT OF ARCHITECT.

ENGINEER'S STAMP: ARCHITECT'S STAMP:

STEVENSON R.C.
 Member
 33483

APDM
 Certificate of Authorization
 Stevenson Engineering Limited
 No. 4851 Date: 23 Sept 2010

MURPHY & MURPHY ARCHITECT INC.
 775 WATERLOO STREET, LONDON, ONTARIO N6A 3W5
 PH: (519) 433-5161 FAX: (519) 433-5162

A A. Detail Number
B B. Drawing Number - Where Detail Found

CONTRACTOR SHALL CHECK ALL DIMENSIONS ON THE DRAWINGS AND REPORT ANY DISCREPANCIES TO THE ARCHITECT BEFORE PROCEEDING. ALL DRAWINGS AND SPECIFICATIONS ARE PROPERTY OF THE ARCHITECT AND MUST BE RETURNED AT THE COMPLETION OF THE WORK. DRAWINGS ARE NOT TO BE SCALED. USE ONLY THE LATEST REVISED DRAWINGS OR THOSE THAT ARE MARKED 'ISSUED FOR CONSTRUCTION'. ANY UNAUTHORIZED USE IS PROHIBITED. AREA CALCULATIONS ARE APPROXIMATE.

PROJECT NAME:
 NEW WINNIPEG STATION No. 27 PROJECT

SAGE CREEK, WINNIPEG, MANITOBA

DRAWING TITLE:
 LOT GRADING PLAN AND STORM WATER MANAGEMENT

PROJECT NORTH:

SCALE: AS NOTED

DATE: MARCH 2010

ISSUED: MAY 21, 2010

DRAWN BY: JES

CHECKED BY: RCS

PROJECT NO.: 2261

FILE NAME:

DRAWING NO.: LG-1