

ISSUES:		
NO	DATE	DESCRIPTION
1	MAY 14, 2010	ISSUED FOR CLIENT REVIEW
2	MAY 19, 2010	ISSUED FOR CLIENT REVIEW
3	SEPT. 24, 2010	ISSUED FOR BUILDING PERMIT
4	DEC. 10, 2010	ISSUED FOR TENDER

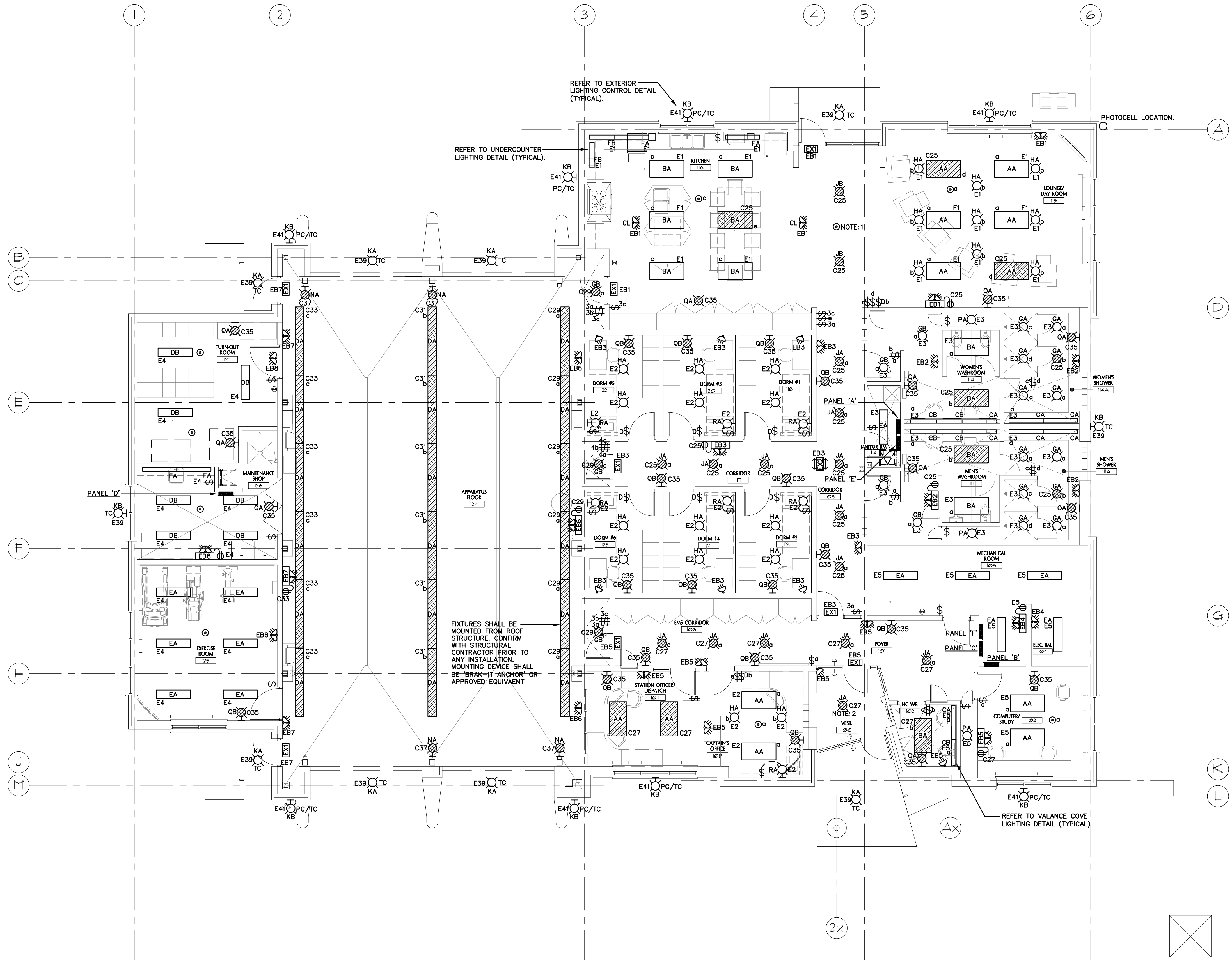

- NOTES:**
1. SENSOR LOCATED BETWEEN LOUNGE/DAY ROOM 115 & KITCHEN 116 SHALL CONTROL THE 2 TYPE 'JB' FIXTURES.
 2. FIXTURE TYPE 'JA' LOCATED WITHIN VESTIBULE 100 SHALL BE ON 24 HOURS, 7 DAYS A WEEK.
 3. LIGHTING SWITCHES LOCATED IN ENCLOSED ROOMS CONTROL THE LIGHTING FIXTURES IN THAT ROOM.

NOTE:
 ALL ELECTRICAL WIRING, CONDUITS AND COMMUNICATIONS RACEWAYS RUNNING IN AREAS OF EXPOSED CONCRETE BLOCK, POURED CONCRETE AND ALL EXPOSED CORE SLAB CEILING SHALL BE RUN CONCEALED. NO EXPOSED RUNS OF CONDUIT OR WIRING WILL BE ACCEPTED.



REVIEW ALL DRAWINGS AND VERIFY ALL DIMENSIONS AT THE SITE. DO NOT SCALE THE DRAWINGS. REPORT ALL DISCREPANCIES TO THE ENGINEER BEFORE PROCEEDING WITH ANY CONSTRUCTION OR SHOP FABRICATION. ALL DRAWINGS, SPECIFICATIONS AND RELATED DOCUMENTS ARE THE COPYRIGHT PROPERTY OF 'VANDERWESTEN RUTHERFORD MANTECON' AND MUST BE RETURNED UPON REQUEST. REPRODUCTION OF DRAWINGS, SPECIFICATIONS AND RELATED DOCUMENTS IN PART OR WHOLE IS FORBIDDEN WITHOUT THE CONSULTANT'S WRITTEN PERMISSION.

PROJECT NAME:
NEW WINNIPEG STATION No. 27 PROJECT
 SAGE CREEK, WINNIPEG, MANITOBA

DRAWING TITLE:
FLOOR PLAN LIGHTING

PROJECT NORTH: 	STAMP: VRM #10-013
SCALE: 1:15	PROJECT NO.: 2261
DATE: DECEMBER 10, 2010	FILE NAME:
ISSUED: DECEMBER 10, 2010	DRAWING NO.: E2.1
DRAWN BY: PDL	
CHECKED BY: ELC	