

**C** AREA U - S680 - PART PLAN  
UM1.1 SCALE 1:50

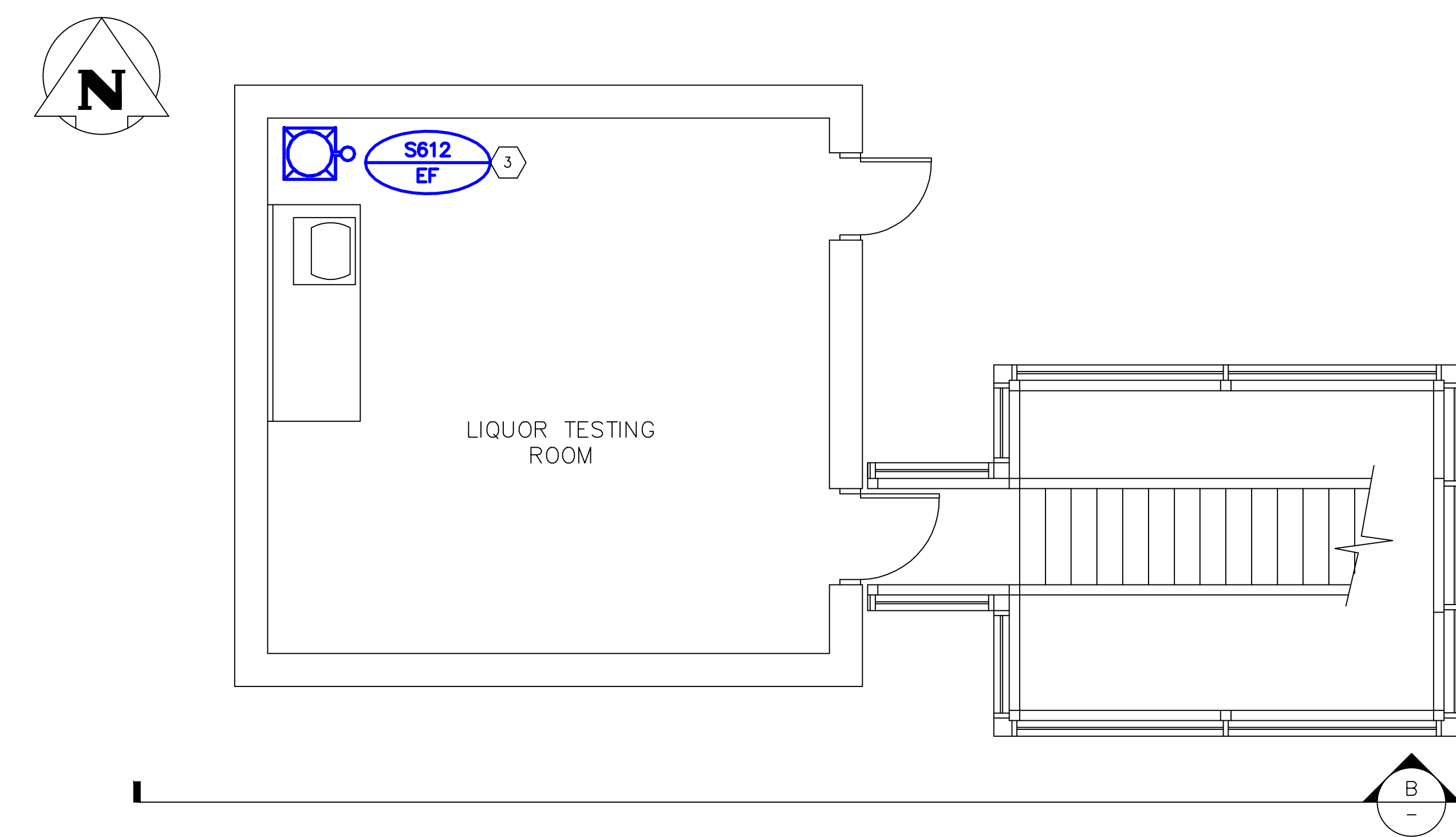

**D** AREA U - S612 - PART PLAN  
UM1.1 SCALE 1:50

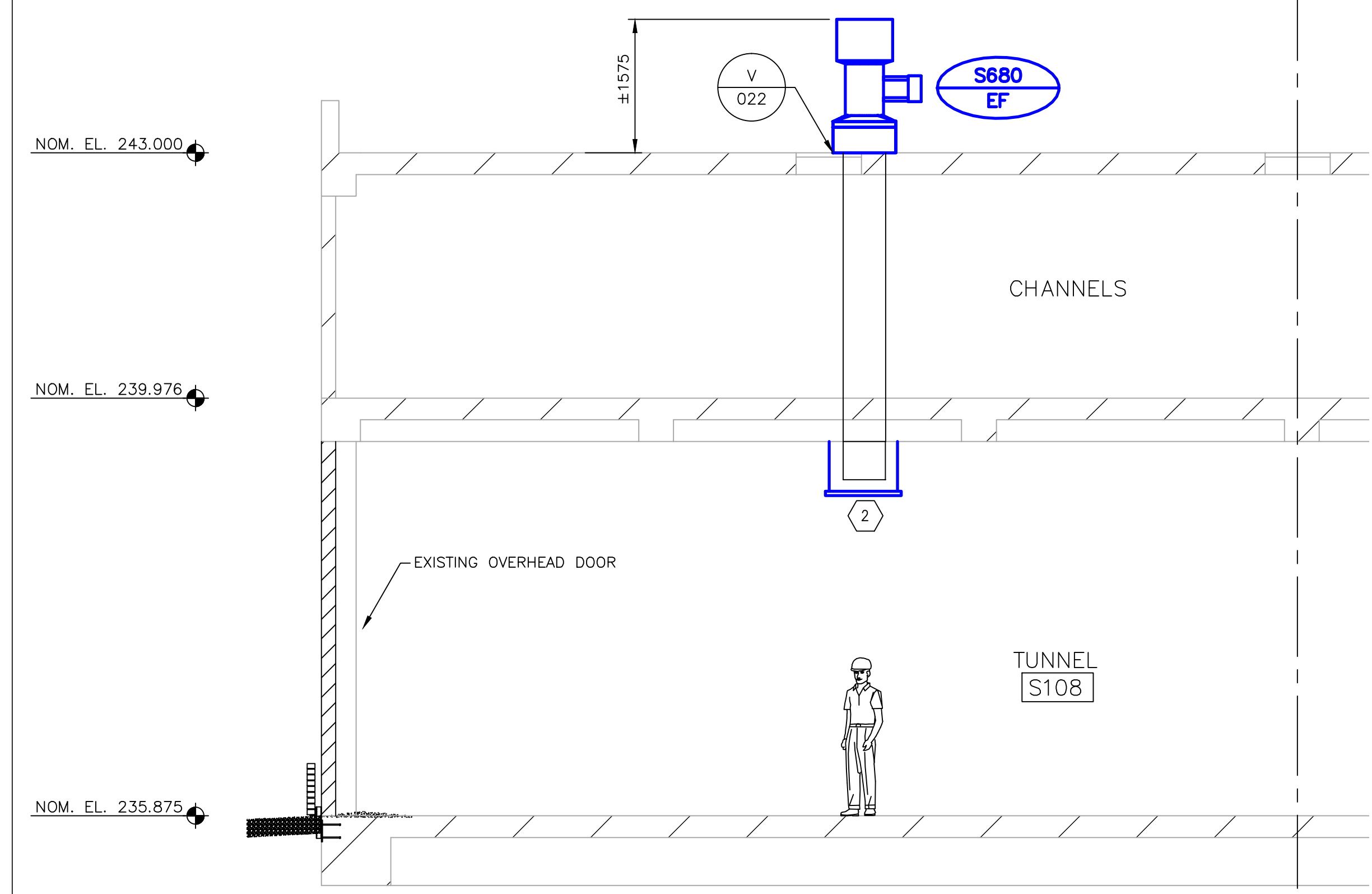

**A** AREA U - S680 - SECTION  
SCALE 1:50

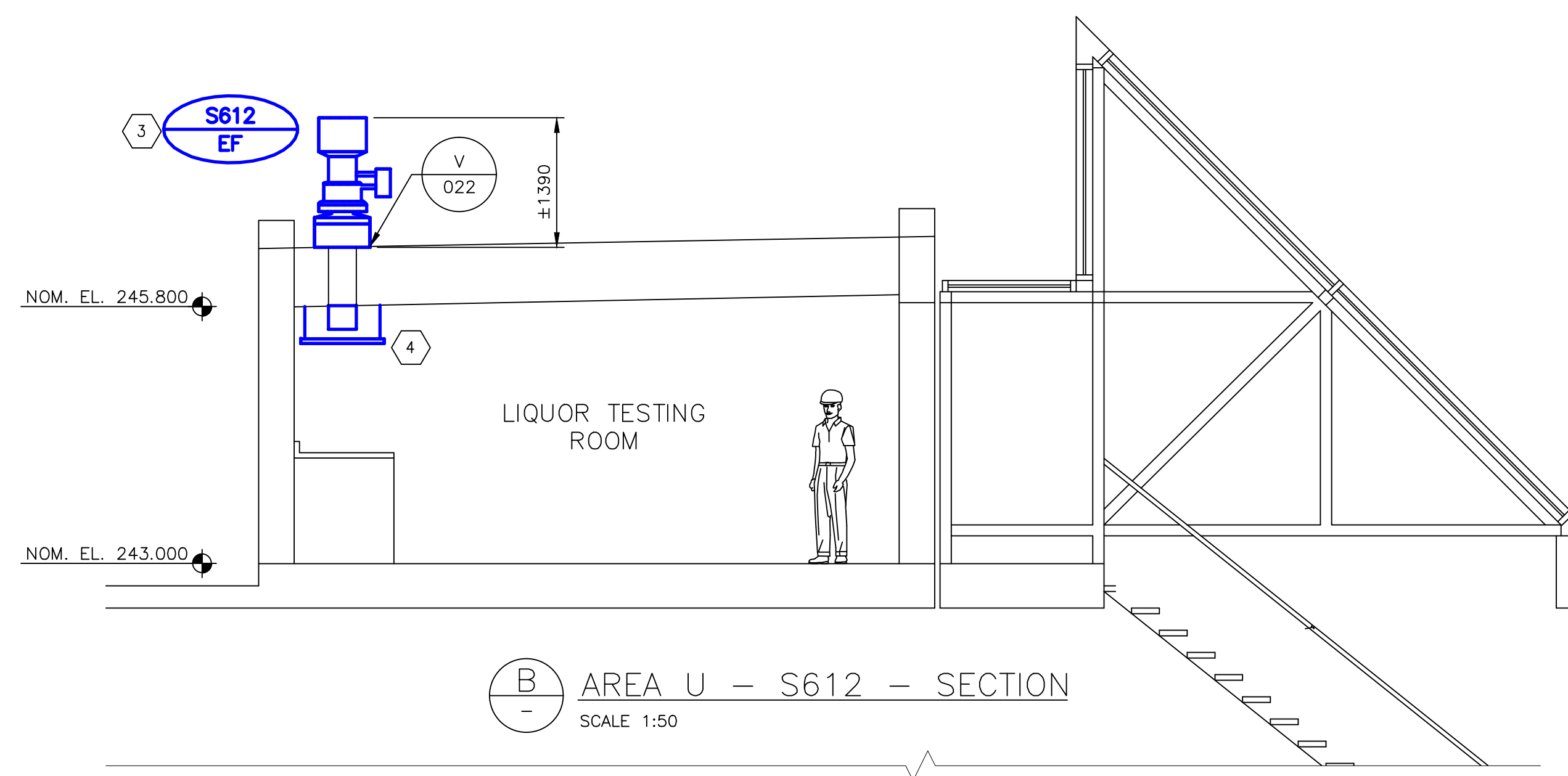

**B** AREA U - S612 - SECTION  
SCALE 1:50

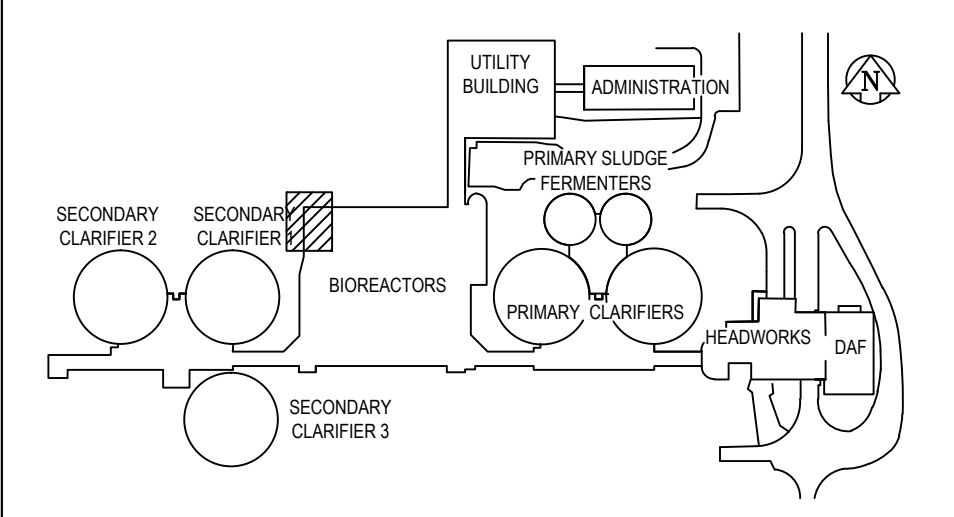

KEY PLAN

- KEY NOTES**
- 1 NEW P625-EF, UPBLAST, BELT DRIVEN ROOF MOUNTED EXHAUST FAN. PROVIDE NECESSARY CONTROLS TO INTERLOCK TO NEW MAKE-UP AIR UNIT U600 AND NEW ROOF CURB TO SUIT NEW INSTALLATION; SEE DETAIL V022. SEE SPECIFICATIONS FOR DETAILS.
  - 2 NEW STAINLESS STEEL DRIP PAN SUPPORTED FROM CEILING. 20mm PVC DRAIN PIPING ROUTED TO EXISTING FLOOR DRAIN.
  - 3 NEW S612-EF UPBLAST, BELT DRIVEN ROOF MOUNTED EXHAUST FAN. PROVIDE NECESSARY CONTROLS TO INTERLOCK TO NEW MAKE-UP AIR UNIT U600 AND NEW ROOF CURB TO SUIT NEW INSTALLATION; SEE DETAIL. SEE SPECIFICATIONS FOR DETAILS.
  - 4 NEW STAINLESS STEEL DRIP PAN SUPPORTED FROM CEILING. 20mm PVC DRAIN PIPING ROUTED TO EXISTING FLOOR DRAIN.

- GENERAL NOTES**
1. PERFORM ALL WORK IN ACCORDANCE WITH ALL APPLICABLE CODES, STANDARDS AND PROVINCIAL MECHANICAL ENGINEERING & INSPECTIONS BRANCH REQUIREMENTS.
  2. COORDINATE WORKS WITH OTHER SUB-TRADES. REFER TO SPECIFIC DETAILS FOR CUTTING AND SEALING PENETRATIONS THROUGH OPENINGS & FIRE SEPARATIONS.
  3. REFER TO TECHNICAL SPECIFICATIONS FOR EQUIPMENT AND MATERIAL SPECIFICATIONS AND INSTALLATION CONSTRUCTION AND PHASING REQUIREMENTS.
  4. INSULATE DUCTWORK WHERE INDICATED AND SPECIFIED.
  5. SUPPORT ALL DUCTWORK TO MEET CODE REQUIREMENTS & ESTABLISHED INDUSTRY TRADE PRACTICES, (SMACNA, ASHRAE).
  6. INVESTIGATE SITE PRIOR TO CONSTRUCTION TO CONFIRM ALL DIMENSIONS AND INSTALLATION REQ'S.
  7. PERFORM ALL CUTTING & PATCHING NECESSARY FOR ANY REQUIRED OPENINGS.
  8. PROVIDE TAB TO ENSURE AIR DISTRIBUTION TO VOLUMES INDICATED.
  9. NOT ALL EQUIPMENT/PIPING, ETC. IS SHOWN.

**APEGN**  
Certificate of Authorization  
Alliance Engineering Services Inc.  
No.2906 Date: \_\_\_\_\_

B.M. ELEV.	FIELD BOOK #:
POSTED TO LBIS	
DESIGNED BY	JC
CHECKED BY	AFG
DRAWN BY	JC
APPROVED BY	
HOR. SCALE	1:50
VERTICAL SCALE	1:50
00 ISSUED FOR TENDER	2010-12-21 AFG
NO. REVISIONS	DATE BY
	2010-08-10

**ALLIANCE**  
Engineering Services Inc.

ENGINEER'S SEAL  
PROVINCE OF MANITOBA  
A.F.G. GOSSSEN  
REGISTERED PROFESSIONAL ENGINEER

CONSULTANT DRAWING NO.  
UM2.2

**THE CITY OF WINNIPEG**  
WATER AND WASTE DEPARTMENT

2010 HVAC REPLACEMENT  
AND ASSOCIATED WORKS  
WEWPCC

AREA U - TUNNEL VENTILATION  
S612 & S680 NEW CONDITIONS - PLAN & SECTION

SHEET 1 OF 1  
CITY DRAWING NUMBER  
1-0103V-M0006-001