

David Wagner Associates Inc.
4 - 430 River Avenue Winnipeg, Manitoba R3L 0C6 (204) 452-2426

LANDSCAPE ARCHITECTURE • URBAN DESIGN • GOLF COURSE ARCHITECTURE

NOTE:
LOCATION OF UNDERGROUND STRUCTURES AS SHOWN ARE BASED ON THE BEST INFORMATION AVAILABLE BUT NO GUARANTEE IS GIVEN THAT ALL EXISTING UTILITIES ARE SHOWN OR THAT THE GIVEN LOCATIONS ARE EXACT. CONFIRMATION OF EXISTENCE AND EXACT LOCATION OF ALL SERVICES MUST BE OBTAINED FROM THE INDIVIDUAL UTILITIES BEFORE PROCEEDING WITH CONSTRUCTION.



DO NOT SCALE DRAWINGS

5		
4		
3		
2		
1		
0	Revision Note	DD-MM-YY
revisions	description	date

project title
**NORBERRY-GLENLEE C.C.
SITE REDEVELOPMENT
WINNIPEG, MANITOBA**

approved by
designed by DW scale 1:500 METRIC
drawn by LLW date 28.01.2011

Client
**BCI II :
ST VITAL WARD**

drawing title
**SITE REDEVELOPMENT
AND LAYOUT PLAN**

project no.	sheet	revision no.
1015_NB	L2	0

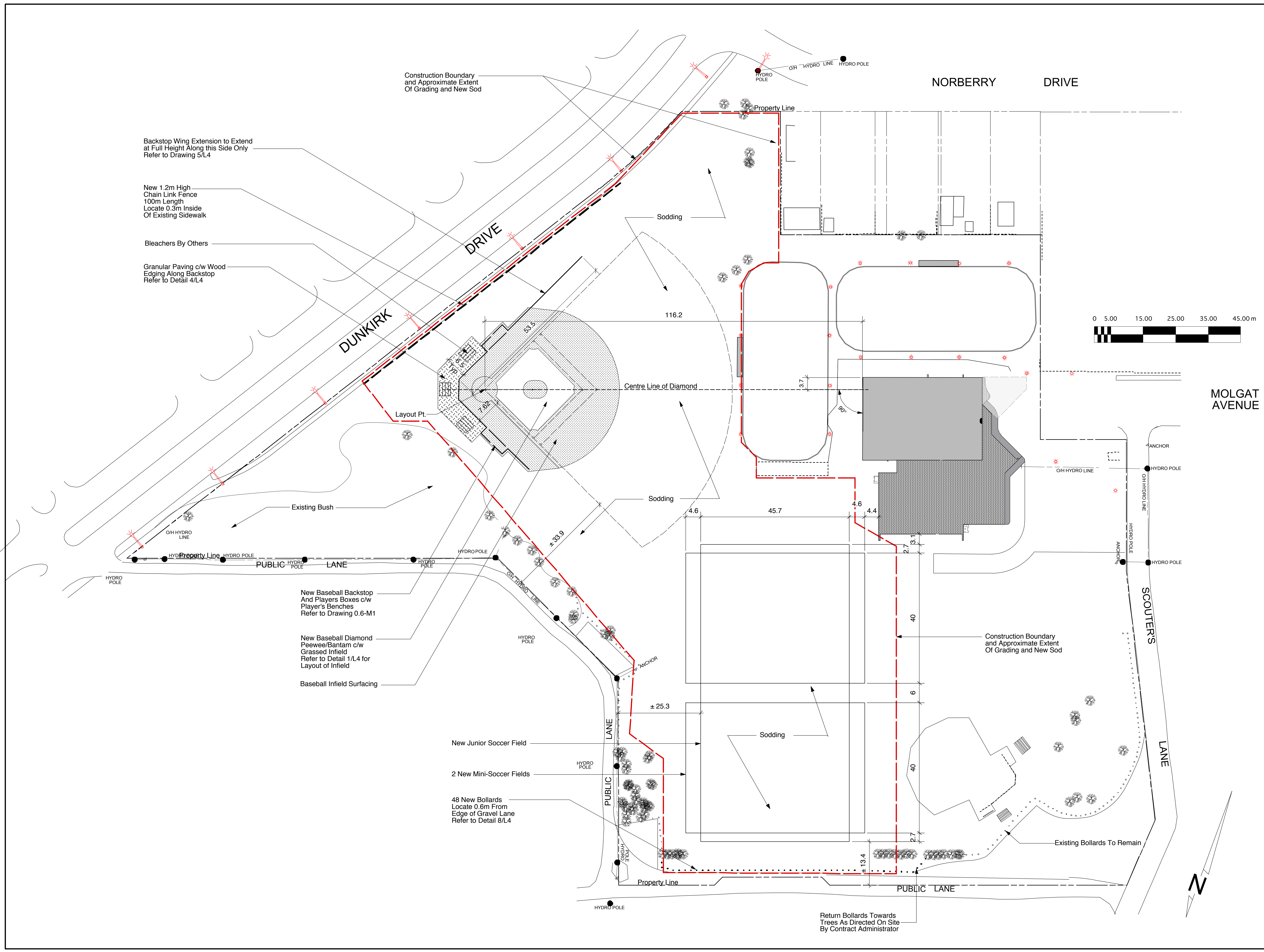

Backstop Wing Extension to Extend at Full Height Along this Side Only Refer to Drawing 5/L4

New 1.2m High Chain Link Fence 100m Length Locate 0.3m Inside Of Existing Sidewalk

Bleachers By Others

Granular Paving c/w Wood Edging Along Backstop Refer to Detail 4/L4

New Baseball Backstop And Players Boxes c/w Player's Benches Refer to Drawing 0.6-M1

New Baseball Diamond Pee wee/Bantam c/w Grassed Infield Refer to Detail 1/L4 for Layout of Infield

Baseball Infield Surfacing

New Junior Soccer Field

2 New Mini-Soccer Fields

48 New Bollards Locate 0.6m From Edge of Gravel Lane Refer to Detail 8/L4

Return Bollards Towards Trees As Directed On Site By Contract Administrator