



ASBESTOS INVENTORY CONTROL

Building Name:	Sargent Park Pool
Building Code:	PI-09
Building Address:	999 Sargent Ave
Inspection Date:	June 8/2010
Inspected By:	Bill Hickey & Nic DeMelo
Construction Date:	

Application Type:	AF- Fabric	C- Ceiling Tile	D- Ducting	F- Flooring	HB - Hardboard
	PL - Plaster	PW- Pipe Wrap	SO - Spray On	TI- Tank Insulation	
Condition:	TP- Transite Pipe	V-Vermiculite	G - Good	NR - Needs Repair	R - Removed

Asbestos Location	Description	Application Type	Estimated %	Condition	Area Tested	
					Yes	No
All Stucco Ceilings Contain Asbestos (1-2%)						
<u>Basement</u>						
Electrical Room	Pipe Elbows	PW	0%	G	X	
	Duct Insulation	D	0%	G	X	
Pool Engineers Office	Pipe Elbows	PW	0%	G	X	
	Duct Insulation	D	0%	G	X	
	12x12 Floor Tile	F		G	.	X
Electrical Tool Storage Room	Pipe Elbows	PW	0%	G		X
Electrical Chemical Storage Room	Pipe Elbows	PW	0%	G		X
Hot Water Storage Tank Room	Pipe Elbows	PW	0%	NR	X	
	Tank Insulation	TI	0%	G	X	
	East Tank Insulation Tested - 0% Asbestos	TI	0%	G	X	
South Track	Pipe Elbows	PW	0%	G		X
Filtration & Pump Room/Pit	Pipe Elbows	PW	0%	G	X	
North Track	Pipe Elbows	PW	0%	G		X
West Crawlspace	Pipe Elbows	PW	0%	G	X	
<u>Garage</u>						
Corridor Along Track To Garage	Pipe Elbows	PW		G		X
Garage Bathroom	12x12 Floor Tile	F	0%	G	X	
Parks Office	12x12 ceiling Tile	C	0%	NR	X	
Garage Mezzanine	Pipe Elbows	PW	0%	G	X	
<u>Main Floor</u>						
All Return/Exhaust Ducts	Contain Asbestos Sheet Fire Dampers	AF		G		X
All Stucco Ceilings Contain Asbestos		PL	1-2%	G	X	
East Side Gym Ceiling	Ceiling Tile	C	0%	G	X	
Room # 2 Closet	Sheet Flooring	FS		G		X

Asbestos Location	Description	Application Type	Estimated %	Condition	Area Tested	
					Yes	No
Multipurpose room	Scratch Coat Ceiling (Above Metal Ceiling Panels)	C	0%	G	X	
<u>Mezzanine Floor</u>						
All Stucco Ceilings Contain Asbestos		PL	1-2%	G	X	
North Air Handling Room	Spray on Ceiling Ductwork	SO DW	0% 0 %		X X	
North Mezz Lobby & Offices	Ceiling Tile	C	0%	G	X	
North Mezz Above Ceiling Tile	Pipe Elbows & Roof Drains	PW				X
South Mezz Above Ceiling Tile	Pipe Elbows & Roof Drains	PW				X
South Mezz Air Handling Room	Pipe Elbows			R		
North Pool Deck Ceiling	Roof Drains			R		
South Pool Deck Ceiling	Roof Drains			R		
<u>Exterior</u>						
Outside Walls (Behind Insulation)	Mastic	EN	10-20%	G	X	
<ul style="list-style-type: none"> - All vinyl floor tile installed before 1990 may contain asbestos and therefore must be treated as an asbestos containing material - Vermiculite insulation may contain pockets of asbestos, therefore all vermiculite must be treated as an asbestos containing material - There may be asbestos containing materials present that were not located during building inspections - For handling procedures call Central Control 986-2382 						

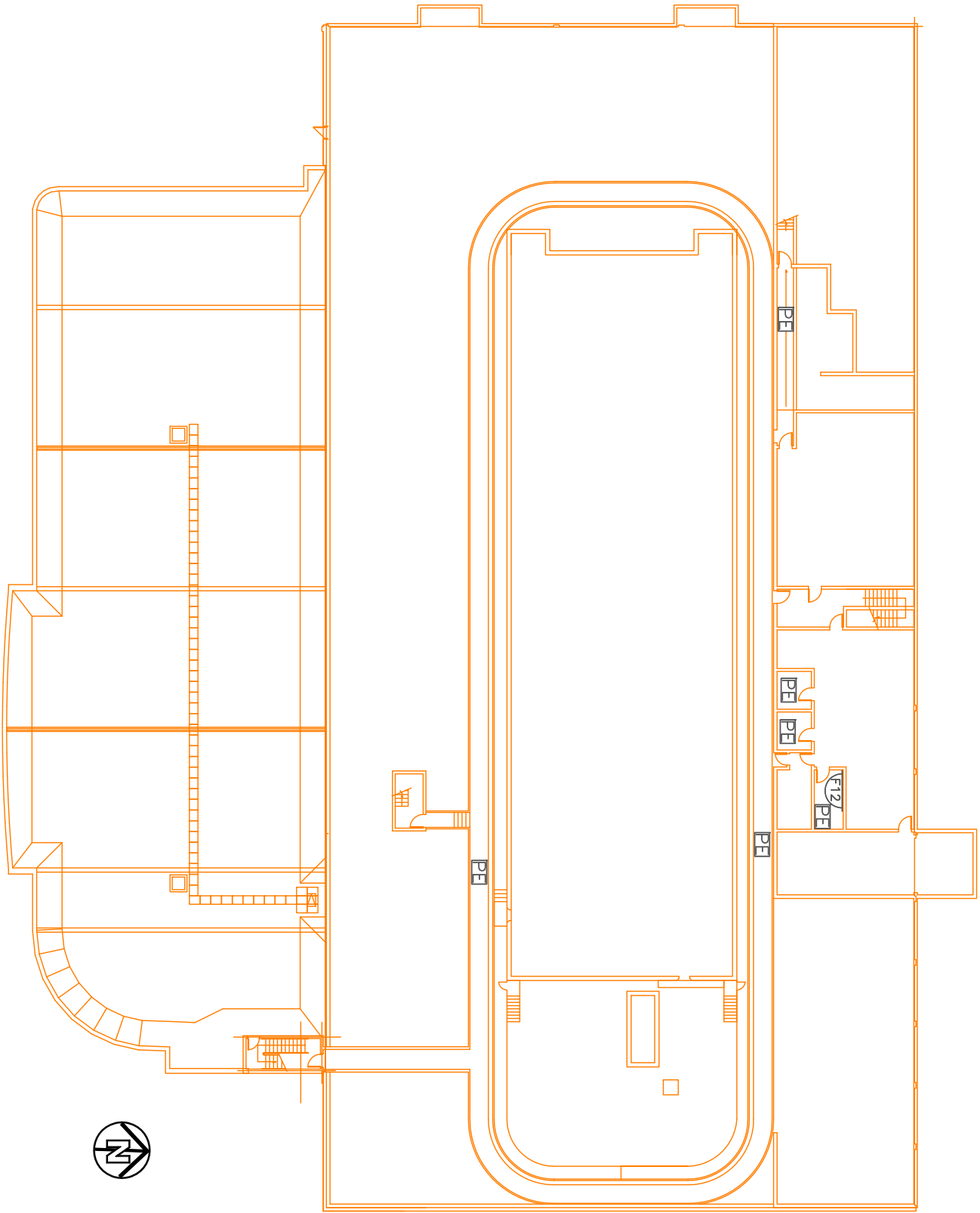

BASEMENT

ASBESTOS LOCATIONS

ASBESTOS LEGEND	
 WALL	 CEILING FLOOR
 AF: ASBESTOS FABRIC	 FS: SHEET FLOORING
 C1: CEILING TILE 12x12	 F9: FLOOR TILE 9x9
 C2: CEILING TILE 24x24	 FI: PIPE INSULATION
 DI: DUCT INSULATION	 PEI: PIPE ELBOW INSULATION
 HB: HARDBOARD	 PL: PIPE PLASTER
 SO: SPRAY ON	 TI: TANK INSULATION
 TP: TRANSITE PIPE	 FBC: FLOORING BELOW CARPET
 V: VERMICULITE	 OTHERS

NOTES:
 1. THERE MAY BE ASBESTOS CONTAINING MATERIALS PRESENT THAT WERE NOT LOCATED DURING BUILDING INSPECTIONS.
 2. REFER TO THE ASBESTOS MONITORING SHEET FOR MORE INFORMATION.
 3. SO NOT SHOWN ASBESTOS FOR INSULATION PROCESSED SINCE 2001. CONTACT: 998-2382

LOCATION: CINDY KLASSEN REC CENTER
 999 SARGENT
 Winnipeg, Manitoba
 Date: JUNE 2010
 REVISION: Not To Scale

THE CITY OF WINNIPEG
 PLANNING, PROPERTY AND
 DEVELOPMENT DEPARTMENT
 MUNICIPAL ACCOMMODATIONS DIVISION
 4th FLOOR - 185 KING STREET
 WINNIPEG, MANITOBA R3B 1Y1
 PHONE: (204) 986-7286
 FAX: (204) 986-7311

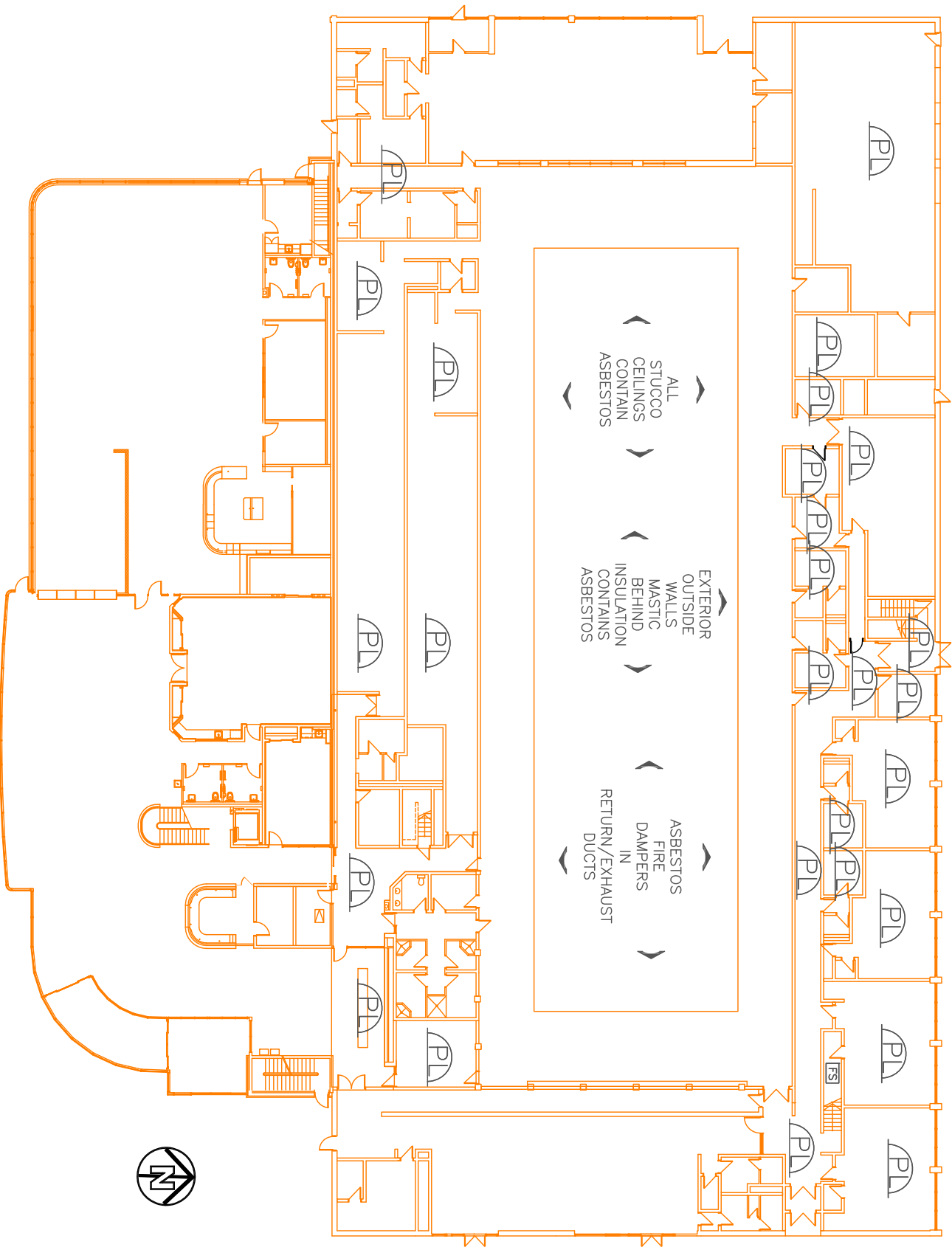

MAIN FLOOR

ASBESTOS LOCATIONS

ASBESTOS LEGEND

	OTHERS
	TI: TANK INSULATION
	TP: TRANSITE PIPE
	FCG: FLOORING BELOW CARPET
	V: VERMICULITE
	SO: SPRAY ON
	PL: PIPE INSULATION
	PE: PIPE ELBOW INSULATION
	PI: PIPE INSULATION
	FS: SHEET FLOORING
	F9: FLOOR TILE 9x9
	FB: FLOOR TILE 24x24
	HB: HARDBOARD
	DU: DUCT INSULATION
	C2: CEILING TILE 24x24
	C1: CEILING TILE 12x12
	AF: ASBESTOS FABRIC

- NOTES:
1. THERE MAY BE ASBESTOS CONTAINING MATERIALS PRESENT THAT WERE NOT LOCATED DURING BUILDING INSPECTIONS.
 2. REFER TO THE ASBESTOS MONITORING SHEET FOR MORE INFORMATION.
 3. DO NOT REMOVE ASBESTOS. FOR REMOVAL PROCEDURES SEE: OSHA, 29 CFR, 1910.1001.

LOCATION: CINDY KLASSEN REC CENTER
 999 SARGENT
 Winnipeg, Manitoba
 Date: JUNE 2010
 REVISION BY: W.K.H.
 Scale: Not To Scale

THE CITY OF WINNIPEG
 PLANNING, PROPERTY AND
 DEVELOPMENT DEPARTMENT
 MUNICIPAL ACCOMMODATIONS DIVISION
 4th FLOOR - 185 KING STREET
 WINNIPEG, MANITOBA R3B 1Y1
 PHONE: (204) 986-7266
 FAX: (204) 986-7311

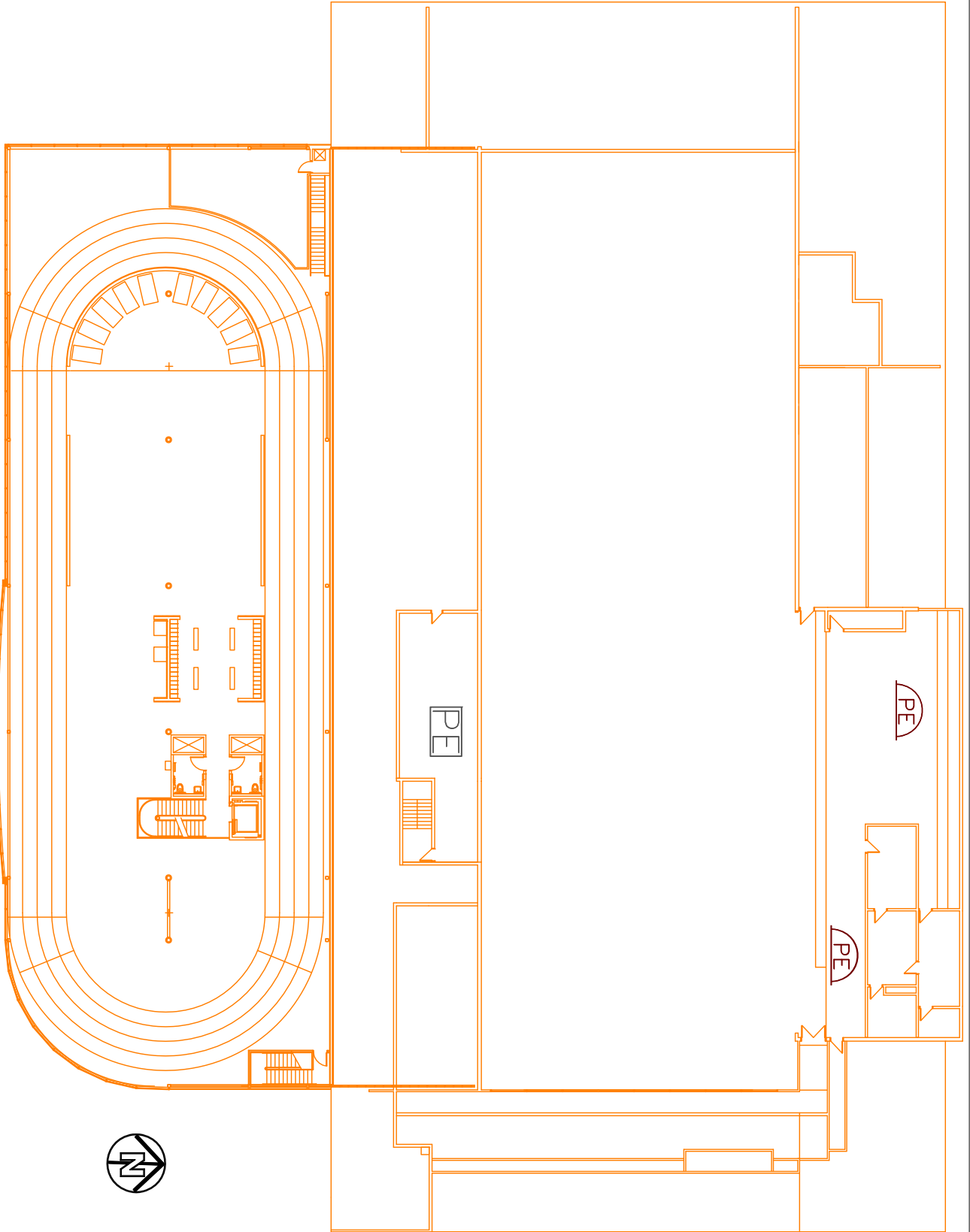

MEZZANINE LEVEL

ASBESTOS LOCATIONS

ASBESTOS LEGEND

WALL AF: ASBESTOS FABRIC C1: CEILING TILE 12X12 C2: CEILING TILE 24X24 DI: DUCT INSULATION	CEILING FLOOR FS: SHEET FLOORING F9: FLOOR TILE 9x9 FT2: FLOOR TILE 12x12 HB: HARDBOARD PE: PIPE ELBOW INSULATION PI: PIPE INSULATION PL: PLASTER SO: SPRAY ON	OTHERS TI: TANK INSULATION TP: TRANSITE PIPE FBC: FLOORING BELOW V: VERMICULITE

NOTES:
 1. THERE MAY BE ASBESTOS CONTAINING MATERIALS PRESENT THAT WERE NOT LOCATED DURING BUILDING INSPECTIONS.
 2. REFER TO THE ASBESTOS MONITORING SCHEMATIC SHEET FOR MORE INFORMATION.
 3. DO NOT REMOVE ASBESTOS. FOR REMOVAL PROCEDURES SEE: OSHA, 29 CFR, 1910.1001 & 1915.1001

LOCATION: CINDY KLASSEN REC CENTER
 999 SARGENT
 Winnipeg, Manitoba
 REVISION BY: W.K.H.
 DATE: JUNE 2010
 SCALE: Not To Scale

THE CITY OF WINNIPEG
 PLANNING, PROPERTY AND
 DEVELOPMENT DEPARTMENT
 MUNICIPAL ACCOMMODATIONS DIVISION
 4th FLOOR - 185 KING STREET
 WINNIPEG, MANITOBA R3B 1Y1
 PHONE: (204) 986-7286
 FAX: (204) 986-7319