

DAKOTA STREET

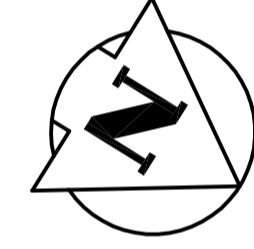
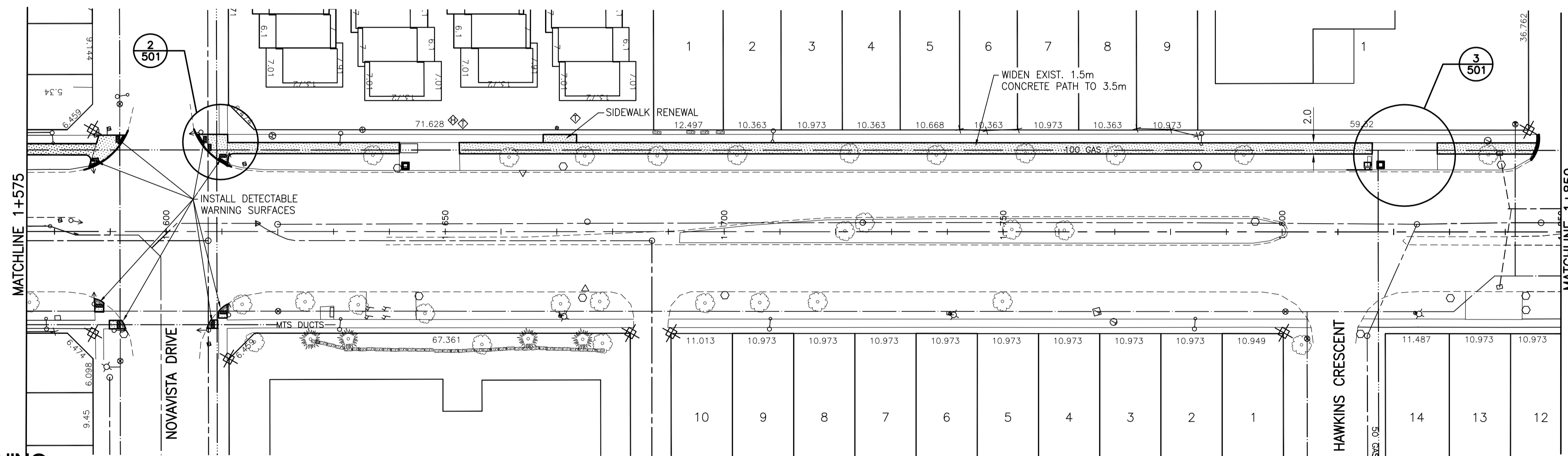

WARNING

IF POWER EQUIPMENT OR EXPLOSIVES ARE TO BE USED FOR EXCAVATION ON THIS PROJECT THE CONTRACTOR MUST:
 1) NOTIFY THE GAS COMPANY OF THE PROPOSED LOCATION OF EXCAVATION.
 2) TAKE PRECAUTION TO AVOID DAMAGE TO GAS COMPANY INSTALLATIONS.
 SEE PROVINCIAL REGULATION 140/92 FOR DETAILS

METRIC

WHOLE NUMBERS INDICATE MILLIMETRES
 DECIMALIZED NUMBERS INDICATE METRES

150 WM	WATERMAIN	150 WM	HYDRO	150 WM	WATERMAIN	150 WM	WATERMAIN
+	HYDRANT	+	M.T.S.	+	HYDRANT, VALVE	+	HYDRANT, VALVE
○	VALVE	○	CONCRETE	○	LAND DRAINAGE SEWER	○	LAND DRAINAGE SEWER
---	LAND DRAINAGE SEWER	---	SIDEWALK - ASPHALT	---	WASTE WATER SEWER	---	WASTE WATER SEWER
---	WASTE WATER SEWER	---	SIDEWALK - CONCRETE	---	○ PROFILE	---	○ PROFILE
○	MANHOLE	○	SIDEWALK - REMOVAL	○	NORTH OR WEST GUTTER	○	NORTH OR WEST GUTTER
□	CATCH BASIN	□	PROPERTY LINE	□	SOUTH OR WEST GUTTER	□	SOUTH OR WEST GUTTER
▽	CURB INLET	▽	SURVEY BAR	▽	NORTH OR WEST DITCH	▽	NORTH OR WEST DITCH
+	JUNCTIONS	+	DITCH	+	SOUTH OR EAST DITCH	+	SOUTH OR EAST DITCH
---	CULVERT	---	ELEVATION	---	NORTH OR WEST DITCH	---	NORTH OR WEST DITCH
---	GAS	---	SIDEWALK RAMP	---	SOUTH OR EAST DITCH	---	SOUTH OR EAST DITCH
---	LEGEND-PLAN	---	LEGEND-PLAN	---	LEGEND-PROFILE	---	LEGEND-PROFILE

LOCATION APPROVED UNDERGROUND STRUCTURES

SUPV. U/G STRUCTURES DATE COMMITTEE
 NOTE:
 LOCATION OF UNDERGROUND STRUCTURES AS SHOWN ARE BASED ON THE BEST INFORMATION AVAILABLE BUT NO GUARANTEE IS GIVEN THAT ALL EXISTING UTILITIES ARE SHOWN OR THAT THE GIVEN LOCATIONS ARE EXACT. CONFIRMATION OF EXISTENCE AND EXACT LOCATION OF ALL SERVICES MUST BE OBTAINED FROM THE INDIVIDUAL UTILITIES BEFORE PROCEEDING WITH CONSTRUCTION.

B.M. ELEV.	NO.	REVISIONS	DATE	BY
	1	ISSUED FOR TENDER	10.06.02	S.R.S.
	0	ISSUED FOR REVIEW	10.05.28	S.R.S.

Stantec Consulting Ltd.
 905 Waverley Street, Winnipeg, Manitoba
 Tel 204-489-5900 Fax 204-453-9012

DESIGNED BY	S.R.S.	CHECKED BY	V.M.M.
DRAWN BY	T.G.	APPROVED BY	S.R.S.
HOR. SCALE:	1:500	RELEASED FOR CONSTRUCTION:	
VERTICAL:	1:20	DATE	10.04.22

ENGINEER'S SEAL
 PROVINCE OF MANITOBA
 S.R. SUDERMAN
 MEMBER 23997
 REGISTERED PROFESSIONAL ENGINEER
 CONSULTANT DRAWING NO.
 C-215

THE CITY OF WINNIPEG
 PUBLIC WORKS DEPARTMENT
 ENGINEERING DIVISION

DAKOTA/DUNKIRK PATHWAY-PHASE I
 WARDE AVENUE TO BISHOP GRANDIN BOULEVARD
 STA. 1+575 TO STA. 1+850
 2010 ACTIVE TRANSPORTATION
 INFRASTRUCTURE STIMULUS PROGRAM

SHEET 7 OF 12
 CAD FILE DRAWING NUMBER 05260c-210-xxx.dwg
 CITY DRAWING NUMBER W-376-07