

1 BASEMENT PLAN- PLUMBING DEMOLITION LAYOUT
 M1.1 SCALE: 1:100

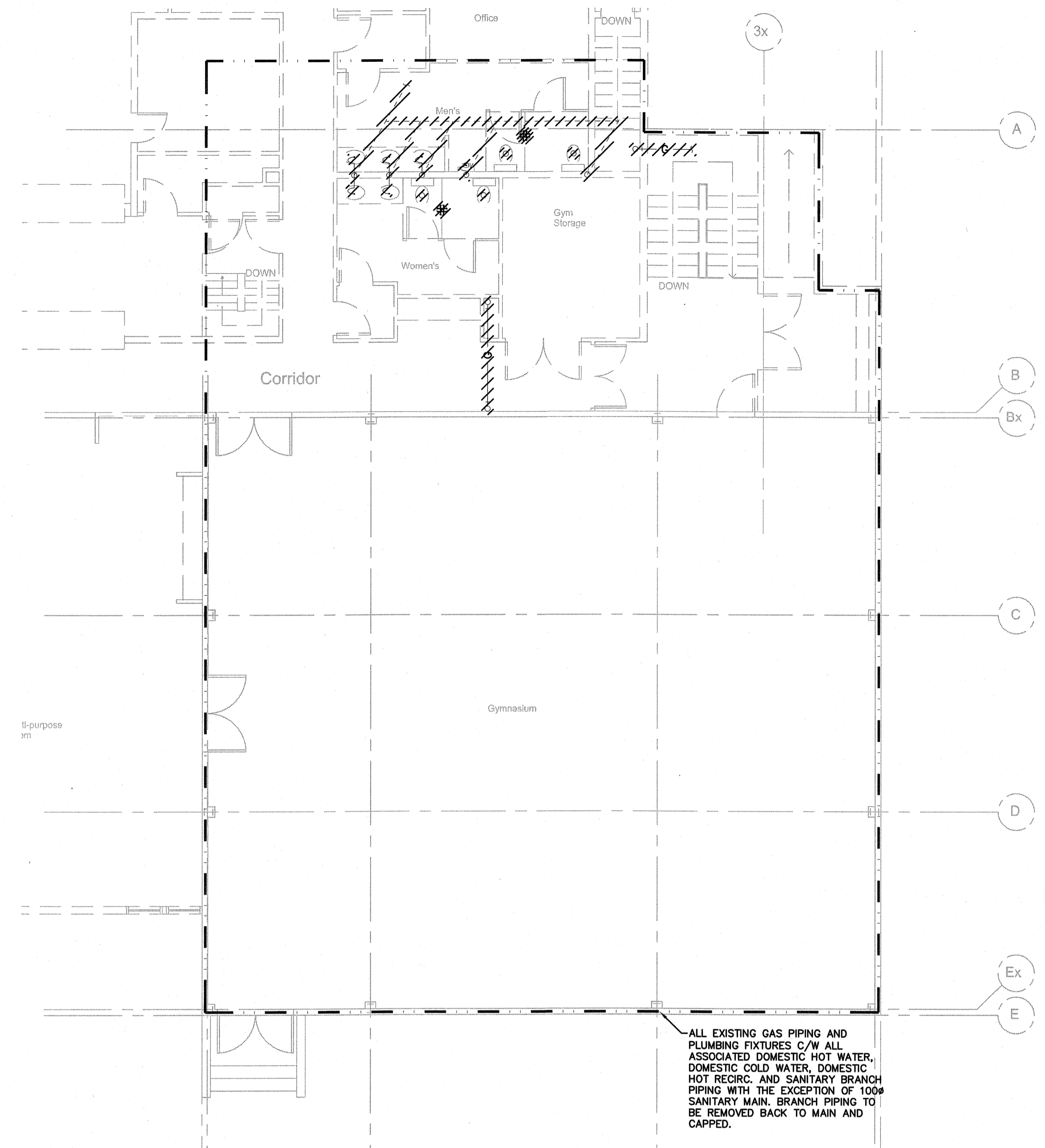

2 MAIN FLOOR PLAN- PLUMBING DEMOLITION LAYOUT
 M1.1 SCALE: 1:100

GENERAL NOTES:
 1. THIS DRAWING IS DIAGRAMMATIC ONLY. DO NOT SCALE.
 2. CONTRACTOR TO CONFIRM EXACT LOCATION AND SIZES OF EXISTING EQUIPMENT ON SITE PRIOR TO TENDER.

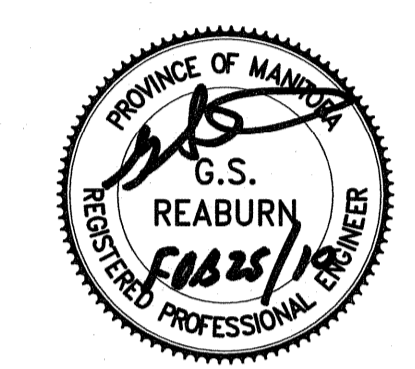

APEGM
 Certificate of Authorization
 MCW/AGE Consulting Professional Engineers
 No. 589 Expiry: April 30, 2010

D ISSUED FOR TENDER	FEB 26, 2010
C ISSUED FOR 99% REVIEW	FEB 10, 2010
B ISSUED FOR 90% REVIEW	JAN 08, 2010
A ISSUED FOR 60% REVIEW	DEC 02, 2009

This drawing must not be scaled.
 The general Contractor must verify all dimensions, datums and levels prior to commencement of work. All errors and omissions must be reported immediately to the Architect.

Variations and modifications to work shown on this drawing shall not be carried out without written permission from the Architect.

This drawing is the exclusive property of the Architect and cannot be reproduced without written permission of the Architect. Reproduction must bear the name of the Architect. Copyright © 2009.

MCW / AGE
 Consulting Professional Engineers
 210-1821 Wellington Avenue
 Winnipeg, Manitoba, R2N 0G4
 Phone: (204) 779-7900 Fax: (204) 779-1119
 E-Mail: mcw_age@mcw.com
 5878

harold funk architect inc.
 Harold Funk Architect Inc.
 Architecture and Urban Design
 401-55 Donald Street, Winnipeg, Manitoba R3C 1L8
 T (204) 943-5087 info@funkarchitect.com
 F (204) 949-9231 funkarchitect.com

project
SINCLAIR COMMUNITY CENTRE
ADDITION & RENOVATIONS
 490 Sinclair Street, Winnipeg

sheet title
BASEMENT AND MAIN FLOOR PLAN- PLUMBING DEMOLITION LAYOUT

project number: 5878 drawing number:
 scale: N.T.S. **M1.1**
 drawn by: KLG
 approved by: GSR
 date: 2010-02-26