

KNOWLES AVENUE

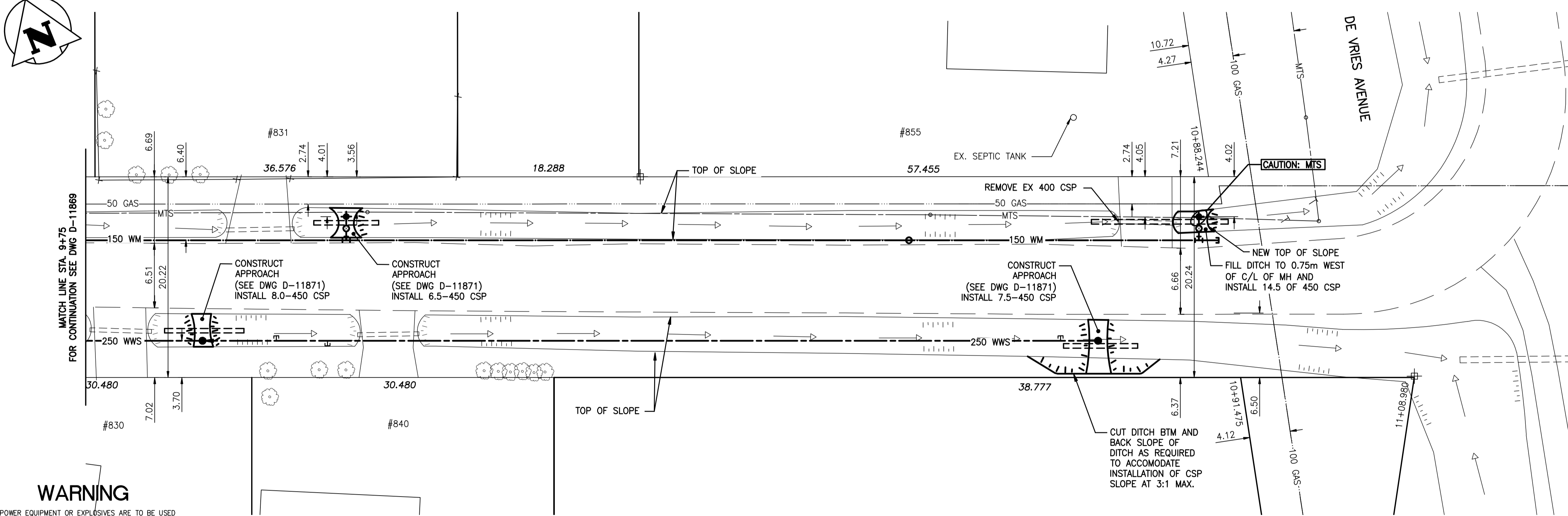

WARNING

IF POWER EQUIPMENT OR EXPLOSIVES ARE TO BE USED FOR EXCAVATION ON THIS PROJECT THE CONTRACTOR MUST:  
 1) NOTIFY THE GAS COMPANY OF THE PROPOSED LOCATION OF EXCAVATION.  
 2) TAKE PRECAUTION TO AVOID DAMAGE TO GAS COMPANY INSTALLATIONS.  
 SEE PROVINCIAL REGULATION 140/92 FOR DETAILS

METRIC

WHOLE NUMBERS INDICATE MILLIMETRES  
 DECIMALIZED NUMBERS INDICATE METRES

BENCH MARK: 86R347 - N.E. Knowles Ave. & Gateway Rd. Tblt. on top of 0.05m dia. x 2.4 ron pipe, 8m S. of S. wall No.451 Knowles Ave. & 33.4m E. of most Ely. rail of railway tracks on C.P.R. Loc Du Bonnet Subd. R.O.W. or 1.1m W. of E.L. Gateway Rd. & 0.9m S. of N.L. of Knowles Ave.

NOTE:  
 STATIONING IS ALONG S. P/L OF KNOWLES AVE.  
 BID OPPORTUNITY 678-2009



150 WM		150 WM		HYDRO		150 WM		150 WM			
+	WATERMAIN	+	WATERMAIN	---	HYDRO	---	WATERMAIN	+	WATERMAIN		
+	HYDRANT	+	HYDRANT	---	M.T.S.	---	HYDRANT, VALVE	+	HYDRANT, VALVE		
+	VALVE	+	VALVE	---	CONCRETE	---	LAND DRAINAGE SEWER	+	LAND DRAINAGE SEWER		
---	300 LDS. LAND DRAINAGE SEWER	---	300 LDS. LAND DRAINAGE SEWER	---	ASPHALT	---	250 WWS	---	250 WWS		
---	250 WWS. WASTE WATER SEWER	---	250 WWS. WASTE WATER SEWER	---	SIDEWALK	---	Q PROFILE	---	Q PROFILE		
○	MANHOLE	○	MANHOLE	---	PROPERTY LINE	---	□	NORTH OR WEST GUTTER	□	NORTH OR WEST GUTTER	
□	CATCH BASIN	□	CATCH BASIN	---	SURVEY BAR	---	○	SOUTH OR EAST GUTTER	○	SOUTH OR EAST GUTTER	
▽	CURB INLET	▽	CURB INLET	---	DITCH	---	◇	NORTH OR WEST DITCH	◇	NORTH OR WEST DITCH	
+	JUNCTIONS	+	JUNCTIONS	---	ELEVATION	---	○	SOUTH OR EAST DITCH	○	SOUTH OR EAST DITCH	
---	CULVERT	---	CULVERT	---	DITCH ELEVATION	---	△	NORTH OR WEST DITCH	△	NORTH OR WEST DITCH	
---	GAS	---	GAS	---	DITCH SLOPE	---	▽	SOUTH OR EAST DITCH	▽	SOUTH OR EAST DITCH	
---	EXISTING	---	LEGEND-PLAN	---	PROPOSED	---	EXISTING	---	LEGEND-PROFILE	---	PROPOSED

LOCATION APPROVED UNDERGROUND STRUCTURES	
SUPV. U/G STRUCTURES COMMITTEE	DATE
NOTE: LOCATION OF UNDERGROUND STRUCTURES AS SHOWN ARE BASED ON THE BEST INFORMATION AVAILABLE BUT NO GUARANTEE IS GIVEN THAT ALL EXISTING UTILITIES ARE SHOWN OR THAT THE GIVEN LOCATIONS ARE EXACT. CONFIRMATION OF EXISTENCE AND EXACT LOCATION OF ALL SERVICES MUST BE OBTAINED FROM THE INDIVIDUAL UTILITIES BEFORE PROCEEDING WITH CONSTRUCTION.	
NO.	REVISIONS
	DATE
	BY

**Stantec Consulting Ltd.**  
 905 Waverley Street, Winnipeg, Manitoba  
 Tel 204-489-5900 Fax 204-453-9012

DESIGNED BY: J.K.H.	CHECKED BY: H.A.K.
DRAWN BY: B.K.W.	APPROVED BY: H.A.K.
HOR. SCALE: 1:250	RELEASED FOR CONSTRUCTION:
VERTICAL: 1:50	DATE

DATE 09.08.07

ENGINEER'S SEAL  
 CONSULTANT DRAWING NO. C-207

**THE CITY OF WINNIPEG**  
 WATER AND WASTE DEPARTMENT  
 ENGINEERING DIVISION

**KNOWLES AVENUE LOCAL IMPROVEMENT**  
 RALEIGH STREET TO DE VRIES AVENUE  
 49.0m E OF EL OF CINDY KLASSEN WAY  
 TO DE VRIES AVE.  
 WATERMAIN, LAND DRAINAGE AND WASTEWATER SEWER

SHEET 7 OF 8  
 CAD FILE DRAWING NUMBER I1730c-201-712.dwg  
 CITY DRAWING NUMBER D-I1870